

INDEX OF SHEETS

1. COVER SHEET AND INDEX OF SHEETS
2. GENERAL NOTES
- 3-6. SUMMARY OF QUANTITIES
7. SCHEDULE OF QUANTITIES
8. EXISTING AND REMOVAL
9. PROPOSED PLAN
- 10-12. STAGING DETAILS S.N. 072-0162
- 13-16. STRUCTURE DETAILS S.N. 072-0162
17. GUARDRAIL DETAILS
- 18-24. DISTRICT CADD STANDARDS

HIGHWAY STANDARDS

001001-02	701311-03
630001-12	701321-18
630301-09	701901-08
631031-18	704001-08
701001-02	725001-01
701006-05	780001-05
701201-05	782006-01
701301-04	

ADT = 2150 (2021)
 SU = 2.8%
 MU = 0.8%

**IL 8 OVER
 WALNUT CREEK
 (S.N. 072-0162)**

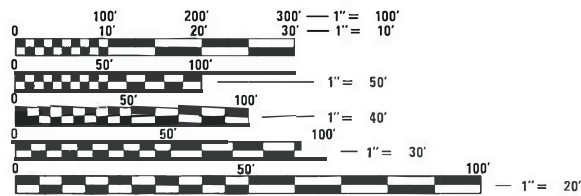

FULL SIZE PLANS HAVE BEEN PREPARED USING STANDARD ENGINEERING SCALES. REDUCED SIZED PLANS WILL NOT CONFORM TO STANDARD SCALES. IN MAKING MEASUREMENTS ON REDUCED PLANS, THE ABOVE SCALES MAY BE USED.

J.U.L.I.E.
 JOINT UTILITY LOCATION INFORMATION FOR EXCAVATORS
 1-800-892-0123
 OR 811

PROJECT ENGINEER: RICH DOTSON (309)671-3455
 PROJECT MANAGER: GERARDO COVARRUBIAS (309)671-3473

CONTRACT NO. 68G40

STATE OF ILLINOIS
 DEPARTMENT OF TRANSPORTATION

**PROPOSED
 HIGHWAY PLANS**

FAS 1388 (IL ROUTE 8)
 SECTION [(Z-4B-15D)BR]BDR,SCR
 PROJECT HBFP-SH8T(617)
 BRIDGE PRESERVATION
 PEORIA COUNTY

C-94-061-21
 R5E

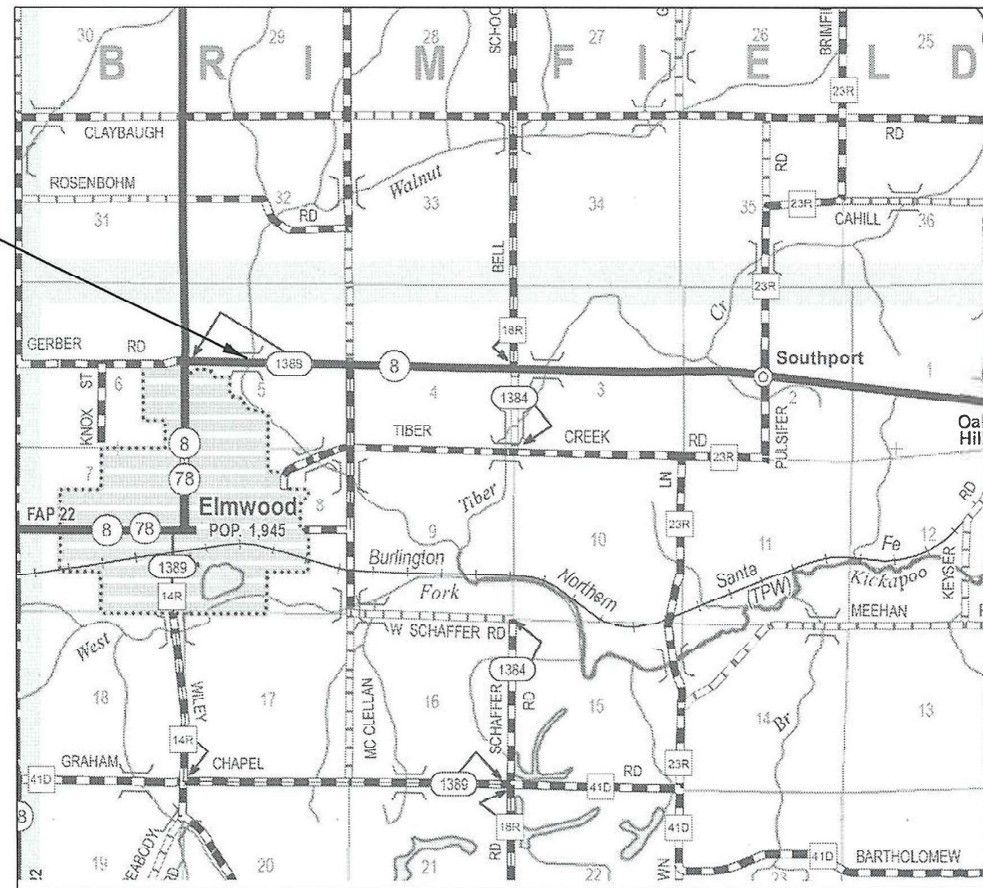

GROSS LENGTH = 308.00 FT. = 0.058 MILE
 NET LENGTH = 308.00 FT. = 0.058 MILE

F.A.S. RTE.	SECTION	COUNTY	TOTAL SHEETS	SHEET NO.
1388	[(Z-4B-15D)BR]BDR,SCR	PEORIA	24	1
		ILLINOIS	CONTRACT NO. 68G40	

D-94-042-21

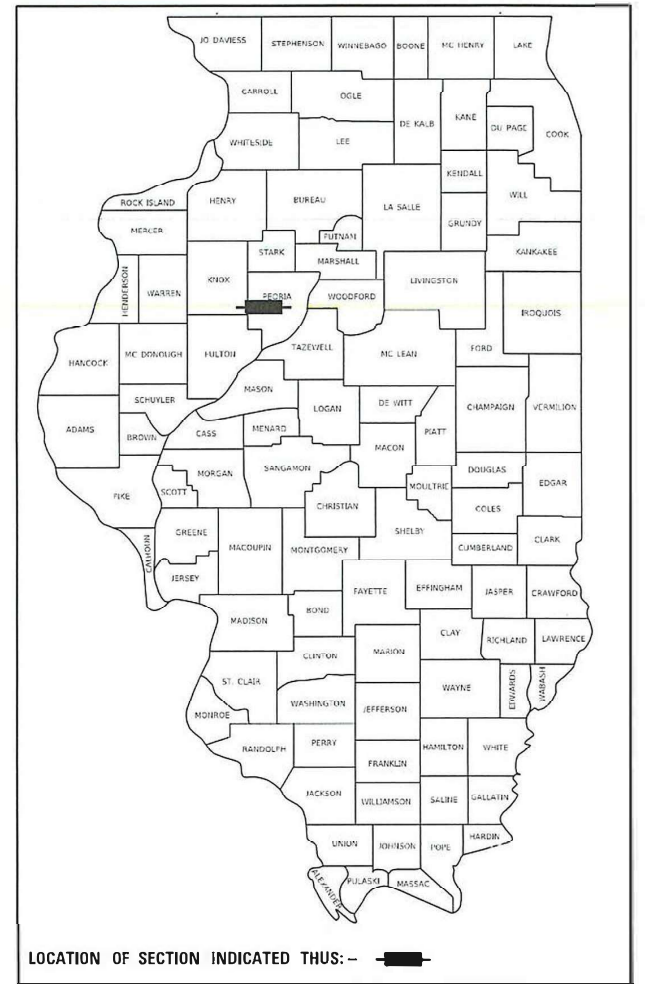

PROJECT DESCRIPTION:

Work includes scarification and microsilica overlay on bridge deck, approach pavements, and connector pavements; inlet adjustments; rip rap swales; minor scour mitigation work; and replacement of existing guardrail.

STATE OF ILLINOIS
 DEPARTMENT OF TRANSPORTATION

SUBMITTED Dec 14 2022
Kennel A Garnett RSO
 REGIONAL ENGINEER

February 3, 2023
[Signature]
 ENGINEER OF DESIGN AND ENVIRONMENT

February 3, 2023
[Signature]
 DIRECTOR OF HIGHWAYS PROJECT IMPLEMENTATION

**PRINTED BY THE AUTHORITY
 OF THE STATE OF ILLINOIS**

COMMITMENTS

Commitments are not to be altered without the written approval of all parties to which the commitment was made.

No commitments have been made on this contract.

ENVIRONMENTAL REVIEWS

Prior to the use of any proposed borrow areas, use areas (temporary access roads, detours, run-arounds, etc.) and/or waste areas, the Contractor shall file the required environmental resource request surveys according to Section 107.22 of the Standard Specifications. These surveys are required in order for the Department to conduct cultural and biological resource surveys for the proposed site.

The required environmental resource documentation shall include the following:

- * BDE Form 2289 (Borrow Site Review)
- * BDE Form 2290 (Waste/Use Area Review)
- * A location map showing the size limits and location of the use area
- * Color photographs depicting the use area
- * Borrow Area Entry Agreement form – D4 PI0101

Prior to any waste materials being removed from the construction site the required environmental resource surveys shall be obtained and filed by the Contractor. Excess waste products removed from the construction site shall be disposed of as required in Section 202.03 of the Standard Specifications.

Any protruding metal bars shall be removed prior to the disposal of broken concrete at approved disposal sites.

Please note that a minimum of four weeks shall be allowed for the District to obtain the required waste site environmental clearances and six weeks for the required borrow site environmental clearances.

BRIDGE OVERLAY NOTIFICATION

After placement of the bridge deck overlay, the Resident Engineer shall notify the District Bridge Maintenance Engineer of the "as constructed" milling depth and overlay thickness for updating the Illinois Highway Information System.

POLYMERIZED BITUMINOUS MATERIALS (TACK COAT) RATES

Surface Type	Residual Rate
Milled (HMA or PCC)	0.08 lb /sq ft
Existing Pavement	0.08 lb /sq ft
Fog Coat (between lifts)	0.08 lb /sq ft

BUTT JOINT CUTTING TIME RESTRICTION

Butt joints shall not be milled more than three (3) days prior to placement of the HMA surface course.

HOT-MIX ASPHALT MIXTURE REQUIREMENTS

Mixture Use(s):	Surface 1.5"	Binder and Partial Depth Patching	Shoulders (All Lifts)
AC/PC:	PG 58-28	PG 58-28	PG 58-28
Design Air Voids:	4.0% @ N=50	4.0% @ N=50	4.0% @ N=50
Mixture Composition: (Gradation Mixture)	IL 9.5	IL 9.5	IL 9.5
Friction Aggregate:	Mix D	N.A.	Mix C
Quality Management:	QCQA	QCQA	QCQA
MTD (YES OR NO):	No	No	No

Notes:

- 1) Individual lift thickness of each mix type will be no less than 3 times nominal maximum aggregate size and no more than 6 times nominal maximum aggregate size, unless otherwise approved by the Engineer.
- 2) For design purposes, mixture weight for all mixes is determined to be 112.0 lb/s.y/in., unless otherwise noted.
- 3) Sublot size for PFP and QCP mixes will be 600 tons, unless otherwise agreed to by the Engineer and the paving contractor.

PAVING SURFACE COURSE

Continuous paving operations on the main roadway shall be maintained at all times during the construction of the hot-mix asphalt surface. No interruptions for side roads, entrances, turn lanes, etc. will be allowed.

SECURING DRAINAGE STRUCTURE GRATES

Prior to routing traffic onto the shoulders as shown in the staging plans, the Contractor shall secure gratings on shoulder inlets as directed by the Engineer. This work will not be paid for separately, but shall be included in the cost of the traffic control pay item.

NO PASSING ZONE VERIFICATION

The resident shall contact Operations to verify the location of no passing zones prior to placement of centerline striping.

PROJECT SPECIFIC NOTES

The Engineer shall determine any profile adjustments required on the approach pavements and approach roadways to address settled approach pavements. Estimated Butt Joints and HMA overlay limits are provided in these plans.

The bridge's structure number shall be painted on the face of each concrete parapet. The number shall be stenciled onto the leading right-hand corner (traffic approach end) of the bridge parapet. The number shall be 2" tall. The structure is in format of XXX-XXXX. The number shall be painted in black on a painted white or grey background. The background shall be sized to provide a 2" border around the structure number. The paint material for the background and the number is allowed to be paint cans obtained from any home improvemet store. The paint shall be advertised as a proffesional enamel spray that is suitable for exterior concrete and metal surface. The background shall allowed to dry sufficiently to prevent bleed-thru when stenciling on the back number. This work will not be paid for separately, but it shall be considered included in the cost of the various structure pay items in the plans.

MODEL SHEETS
FILE NAME: S:\GEN\W\03\STDE\PLUS\5\5\03\11_8\W\HMA_Creek_Bridge_Presentation\CADD\11_8\W\HMA_Cr_Plan.dgn

USER NAME = Gerardo.Covarrubias	DESIGNED -	REVISED -
	DRAWN -	REVISED -
PLOT SCALE = 100,0000 ' / in.	CHECKED -	REVISED -
PLOT DATE = 12/14/2022	DATE -	REVISED -

**STATE OF ILLINOIS
DEPARTMENT OF TRANSPORTATION**

GENERAL NOTES AND PROJECT SPECIFIC NOTES			
SCALE:	SHEET 1	OF 1 SHEETS	STA. TO STA.

F.A.S RTE.	SECTION	COUNTY	TOTAL SHEETS	SHEET NO.
1388	[(Z-4B-15D)BR]BDR,SCR	PEORIA	24	2
CONTRACT NO. 68G40			ILLINOIS FED. AID PROJECT	

CONST. CODE
80% FED 20% STATE
BRIDGE
0047

CODE NO.	ITEM	UNIT	TOTAL QUANTITY	SN 072-0162
20200100	EARTH EXCAVATION	CU YD	57	57
28100209	STONE RIPRAP, CLASS A5	TON	58	58
28200200	FILTER FABRIC	SQ YD	42	42
40600295	POLYMERIZED BITUMINOUS MATERIALS (TACK COAT)	POUND	349	349
40600982	HOT - MIX ASPHALT SURFACE REMOVAL - BUTT JOINT	SQ YD	484	484
40600990	TEMPORARY RAMP	SQ YD	202	202
40602978	HOT-MIX ASPHALT BINDER COURSE, IL-9.5, N50	TON	36	36
40604060	HOT-MIX ASPHALT SURFACE COURSE, IL-9.5, MIX "D", N50	TON	27	27
48203100	HOT - MIX ASPHALT SHOULDERS	TON	40	40
50102400	CONCRETE REMOVAL	CU YD	0.3	0.3
50300260	BRIDGE DECK GROOVING	5Q YD	857	857
50300300	PROTECTIVE COAT	SQ YD	873	873
50301350	CONCRETE SUPERSTRUCTURE (APPROACH SLAB)	CU YD	1.3	1.3
50800205	REINFORCEMENT BARS, EPOXY COATED	POUND	50	50

MODEL: \\nas01\share\GIS\ENR\WORK\STDS\PLANS\50400300\0310 & Walnut Creek Bridge Presentation\CADD\0310 & Walnut Cr Plan.dgn
 FILE NAME: \\nas01\share\GIS\ENR\WORK\STDS\PLANS\50400300\0310 & Walnut Creek Bridge Presentation\CADD\0310 & Walnut Cr Plan.dgn

USER NAME = Gerardo.Covarrubias	DESIGNED - _____	REVISED - _____
	DRAWN - _____	REVISED - _____
PLOT SCALE = 100.0000' / in.	CHECKED - _____	REVISED - _____
PLOT DATE = 12/15/2022	DATE - _____	REVISED - _____

**STATE OF ILLINOIS
DEPARTMENT OF TRANSPORTATION**

**SUMMARY OF QUANTITIES
S.N. 072-0162**

SCALE: _____ SHEET 1 OF 4 SHEETS STA. _____ TO STA. _____

F.A.S. RTE.	SECTION	COUNTY	TOTAL SHEETS	SHEET NO.
1388	[(Z-4B-15D)BR]BDR,SCR	PEORIA	24	3
			CONTRACT NO. 68G40	
ILLINOIS FED. AID PROJECT				

CONST. CODE
80% FED
20% STATE
BRIDGE
0047

CODE NO.	ITEM	UNIT	TOTAL QUANTITY	SN 072-0162
60300105	FRAMES AND GRATES TO BE ADJUSTED	EACH	2	2
* 63000001	STEEL PLATE BEAM GUARD RAIL, TYPE A, 6 FOOT POSTS	FOOT	763	763
* 63100085	TRAFFIC BARRIER TERMINAL, TYPE 6	EACH	4	4
* 63100167	TRAFFIC BARRIER TERMINAL, TYPE 1 (SPECIAL) TANGENT	EACH	4	4
63200310	GUARDRAIL REMOVAL	FOOT	648	648
67100100	MOBILIZATION	L SUM	1	1
70100405	TRAFFIC CONTROL AND PROTECTION, STANDARD 701321	EACH	1	1
70100450	TRAFFIC CONTROL AND PROTECTION, STANDARD 701201	L SUM	1	1
70106500	TEMPORARY BRIDGE TRAFFIC SIGNALS	EACH	1	1
70106700	TEMPORARY RUMBLE STRIP	EACH	6	6
70107025	CHANGEABLE MESSAGE SIGN	CAL DA	14	14
70300100	SHORT-TERM PAVEMENT MARKING	FOOT	529	529
70300150	SHORT TERM PAVEMENT MARKING REMOVAL	SQ FT	1007	1007
70307120	TEMPORARY PAVEMENT MARKING - LINE 4" - TYPE IV TAPE	FOOT	2744	2744

*= SPECIALTY ITEM

MODEL: \\nashe: S:\CEN\WORK\BDR\STDS\PLANS\50400310 & Walnut Creek Bridge Presentation\CADD\31 & Walnut Cr Plan.dgn

USER NAME = Gerardo.Covarrubias	DESIGNED - _____	REVISED - _____
	DRAWN - _____	REVISED - _____
PLOT SCALE = 100.0000' / in.	CHECKED - _____	REVISED - _____
PLOT DATE = 12/15/2022	DATE - _____	REVISED - _____

**STATE OF ILLINOIS
DEPARTMENT OF TRANSPORTATION**

**SUMMARY OF QUANTITIES
S.N. 072-0162**

SCALE: _____ SHEET 2 OF 4 SHEETS STA. _____ TO STA. _____

F.A.S. RTE.	SECTION	COUNTY	TOTAL SHEETS	SHEET NO.
1388	[(Z-4B-15D)BR]BDR,SCR	PEORIA	24	4
			CONTRACT NO. 68G40	
ILLINOIS FED. AID PROJECT				

RESURFACING SCHEDULE												
LOCATION		40600295 POLYMERIZED BITUMINOUS MATERIALS (TACK COAT)	40604060 HOT-MIX ASPHALT SURFACE COURSE, IL-9.5, MIX "D", N50	40602978 HOT-MIX ASPHALT BINDER COURSE, IL-9.5, N50	40600990 TEMPORARY RAMP	40600982 HOT-MIX ASPHALT SURFACE REMOVAL - BUTT JOINT	X4421000 PARTIAL DEPTH PATCHING	X0556100 PARTIAL DEPTH PATCHING (SPECIAL)	48203100 HOT-MIX ASPHALT SHOULDERS			
IL 8		POUND	TON	TON	SQ YD	SQ YD	TON	SQ YD	TON			
S.N. 072-0162 Pavement												
STA	193+12.00	TO	193+71.00	LT/RT								
STA	195+56.00	TO	196+20.00	LT/RT	114.5	13.4	17.8	62.2	159.0	4.9	43.5	
STA	193+12.00	TO	193+73.00	LT/RT	118.3	13.8	18.4	62.2	164.3	5.5	48.7	
S.N. 072-0162 Shoulder												
STA	193+12.00	TO	193+73.00	LT/RT							15.5	
STA	195+53.00	TO	196+20.00	LT/RT	56.9			38.9	79.0		16.1	
STA	191+67.72	TO	191+96.10	LT/RT	59.1			38.9	82.1		8.7	
TOTALS					349	27	36	202	484	10	92	40

GUARDRAIL SCHEDULE												
LOCATION		63100085 TRAFFIC BARRIER TERMINAL, TYPE 6	63000001 STEEL PLATE BEAM GUARDRAIL, TYPE A, 6 FOOT POSTS	63100167 TRAFFIC BARRIER TERMINAL, TYPE 1 (SPECIAL) TANGENT	63200310 GUARDRAIL REMOVAL	72501000 TERMINAL MARKER - DIRECT APPLIED	X0327809 LINEAR DELINEATOR PANELS, 4 INCH	Z0001002 GUARDRAIL AGGREGATE EROSION CONTROL	20200100 EARTH EXCAVATION			
IL 8		EACH	FOOT	EACH	FT	EACH	EACH	TON	CU YD			
S.N. 072-0162												
STA	190+48.00	TO	193+99.00	RT	1	262.5	1	196.7	1	4	42	16.9
STA	195+13.00	TO	197+15.00	RT	1	112.5	1	121.3	1	2	24	9.6
STA	192+69.00	TO	194+21.00	LT	1	62.5	1	117.8	1	2	15	4.9
STA	195+35.00	TO	199+49.00	LT	1	325.0	1	211.9	1	5	52	21.6
SHOULDERS PRE-STAGE												
STA	191+67.72	TO	191+96.10	LT/RT								4.3
TOTALS		4	763	4	648	4	13	133	57			

TEMPORARY PAVEMENT MARKING SCHEDULE									
LOCATION		78300202 PAVEMENT MARKING REMOVAL - WATER BLASTING	70307120 TEMPORARY PAVEMENT MARKING - LINE 4" - TYPE IV TAPE	70307210 TEMPORARY PAVEMENT MARKING - LINE 24" - TYPE IV TAPE	70300150 SHORT TERM PAVEMENT MARKING REMOVAL	70300100 SHORT TERM PAVEMENT MARKING			
IL 8		EDGE/CL	LT/RT	FT	SQ FT	FT	FT	SQ FT	FT
S.N. 072-0162									
STAGE I									
STA	190+12.00	TO	192+38.00	CL					
STA	196+88.00	TO	199+14.00	CL	226.0	48.2			
STA	191+90.00	TO	197+36.00	EDGE	546.0	182.0	546.0	182.0	
STA	190+22.00	TO	198+48.00	RT/LT	826.0		826.0	275.3	
STAGE II									
STA	191+90.00	TO	197+36.00	EDGE	546.0	182.0	546.0	182.0	
STA	190+78.00	TO	199+04.00	RT/LT	826.00		826.0	275.3	
POST-STAGE II									
STA	190+12.00	TO	199+14.00	CL	902.0			30.1	360.8
STA	191+90.00	TO	197+36.00	EDGE	21.0			7.0	84.0
STA	191+90.00	TO	197+36.00	EDGE	21.0			7.0	84.0
TOTALS					506	2,744	24	1007	529

RIPRAP SCHEDULE							
LOCATION		X0322584 REVETMENT MAT REMOVAL	28100209 STONE RIPRAP, CLASS A5	282002005 FILTER FABRIC			
IL 8		LT/RT	SQ YD	TON	SQ YD		
S.N. 072-0162							
STA	194+00.00	TO	194+50.00	RT	18.9	58.0	42.0
TOTALS			19	58	42		

TEMPORARY CONCRETE BARRIER SCHEDULE					
LOCATION		70400100 TEMPORARY CONCRETE BARRIER	70400200 RELOCATE TEMPORARY CONCRETE BARRIER		
IL 8		LT/RT	FOOT	FOOT	
S.N. 072-0162					
STAGE I					
STA	191+88.4	TO	197+37.7	RT/LT	550.0
STAGE II					
STA	191+88.4	TO	197+37.7	RT/LT	550
TOTALS			550	550	

PAVEMENT MARKING SCHEDULE					
LOCATION		78009004 MODIFIED URETHANE PAVEMENT MARKING - LINE 4"			
IL 8		EDGE/CL	LT/RT	FT	FT
S.N. 072-0162					
STA	190+12.00	TO	199+14.00	CL	
STA	191+90.00	TO	197+36.00	EDGE	546.0
STA	191+90.00	TO	197+36.00	EDGE	546.0
TOTALS			1,092	990	
TOTAL				2,082	

TEMPORARY IMPACT ATTENUATOR SCHEDULE				
STATION		70600251 IMPACT ATTENUATORS, TEMPORARY (NON- REDIRECTIVE, NARROW), TEST LEVEL 3	70600352 IMPACT ATTENUATORS, RELOCATE (NON- REDIRECTIVE, NARROW) TEST LEVEL 3	
IL 8		LT/RT	EACH	EACH
S.N. 072-0162				
STAGE I				
STA	191+88.4	RT	1	
STA	197+37.7	RT	1	
STAGE II				
STA	191+88.4	LT		1
STA	197+37.7	LT		1
TOTALS			2	2

70106700 TEMPORARY RUMBLE STRIPS	
LOCATION	EACH
S.N. 072-0162	6
TOTAL	6

70107025 CHANGEABLE MESSAGE SIGN	
LOCATION	CAL DA
S.N. 072-0162 (2 SIGNS/ 7 DAYS EACH)	14
TOTAL	14

70106500 TEMPORARY BRIDGE TRAFFIC SIGNALS	
LOCATION	EACH
S.N. 072-0162	1
TOTAL	1

MODEL SHEET
FILE NAME: S:\GEN\W\W03\STDE\PLS\Sus030311_8\W\W03_Creek_Bridge_Presentation\CADD\11_8\W\W03_Cr_Rbar.dgn

USER NAME = Gerardo.Covarrubias	DESIGNED - _____	REVISED - _____
DRAWN - _____	REVISIONS - _____	
PLOT SCALE = 100,0000' / in.	CHECKED - _____	REVISED - _____
PLOT DATE = 12/15/2022	DATE - _____	REVISED - _____



**STATE OF ILLINOIS
DEPARTMENT OF TRANSPORTATION**

**SCHEDULE OF QUANTITIES
S.N. 072-0162**

SCALE: _____ SHEET 1 OF 1 SHEETS STA. _____ TO STA. _____

F.A.S RTE.	SECTION	COUNTY	TOTAL SHEETS	SHEET NO.
1388	[(Z-4B-15D)BR]BDR,SCR	PEORIA	24	7
CONTRACT NO. 68G40				
ILLINOIS FED. AID PROJECT				

LEGEND

-  HOT-MIX ASPHALT SURFACE REMOVAL - BUT JOINT
-  PARTIAL DEPTH PATCHING SPECIAL AND HOT-MIX ASPHALT SURFACE REMOVAL - BUT JOINT
-  REVETMENT MAT REMOVAL

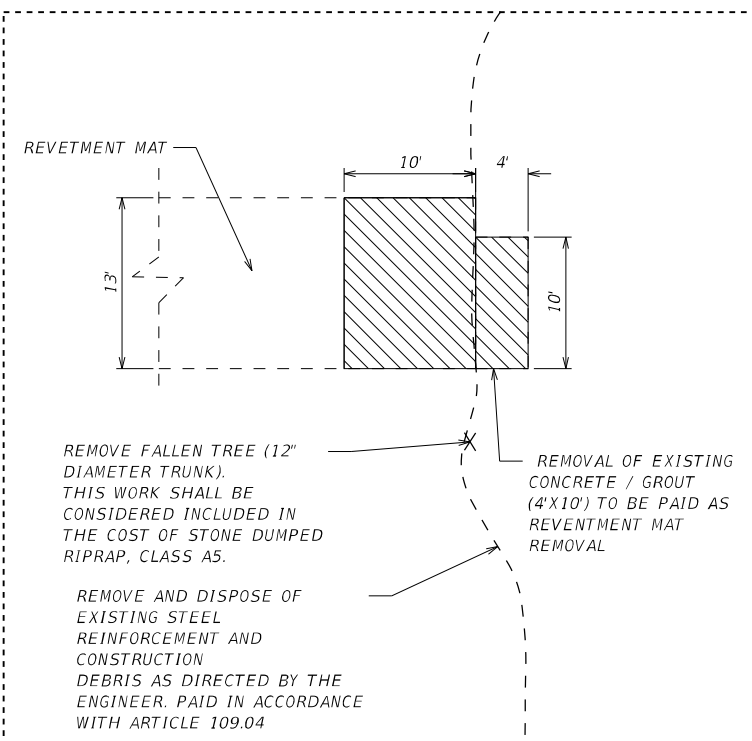
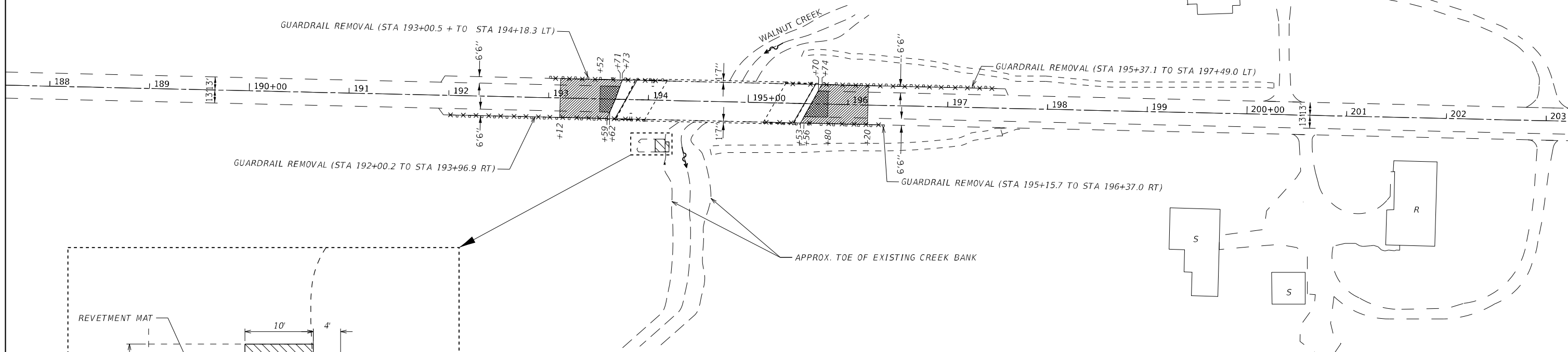

NOTE: SEE STRUCTURE DETAIL FOR PROPOSED REMOVAL ITEMS ON THE STRUCTURE, APPROACH PAVEMENTS, AND CONNECTOR PAVEMENTS. BUTT JOINTS SHALL BE 3 1/2" DEEP TO ALLOW FOR 1 1/2" SURFACE COURSE AND 2" BINDER COURSE.



MODEL: sheets; FILE NAME: S:\CEN\W\ORD\STDEP\US\Staus003\1_8 Walnut Creek Bridge Presentation\CADD\11_8 Walnut Cr Plan.dwg

USER NAME = Gerardo.Covarrubias	DESIGNED - _____	REVISED - _____
PLOT SCALE = 100,0000' / in.	DRAWN - _____	REVISED - _____
PLOT DATE = 12/15/2022	CHECKED - _____	REVISED - _____
	DATE - _____	REVISED - _____



**STATE OF ILLINOIS
DEPARTMENT OF TRANSPORTATION**

**EXISTING AND REMOVAL
S.N. 072-0162**

SCALE: _____ SHEET 1 OF 1 SHEETS STA. _____ TO STA. _____

F.A.S RTE.	SECTION	COUNTY	TOTAL SHEETS	SHEET NO.
1388	[(Z-4B-15D)BR]BDR.SCR	PEORIA	24	8
CONTRACT NO. 68G40			ILLINOIS FED. AID PROJECT	

LEGEND

-  HOT-MIX ASPHALT SHOULDERS
-  HOT-MIX ASPHALT SURFACE COURSE, IL-9.5, MIX "D", N50 (1.5")
HOT-MIX ASPHALT BINDER COURSE, IL- 9.5, N50 (2" AND VARIES)
-  HOT-MIX ASPHALT SURFACE COURSE, IL-9.5, MIX "D", N50 (1.5")
HOT-MIX ASPHALT BINDER COURSE, IL- 9.5, N50 (2" AND VARIES)
AND PARTIAL DEPTH PATCHING SPECIAL

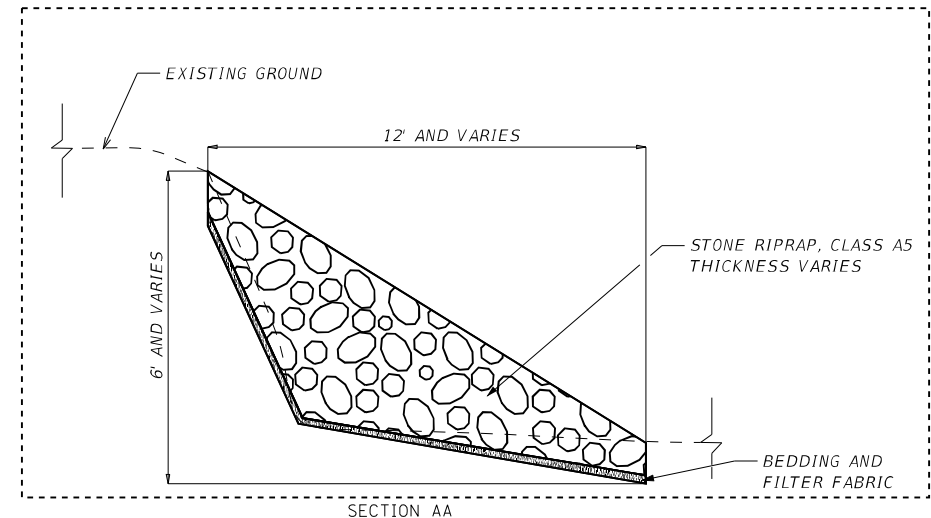
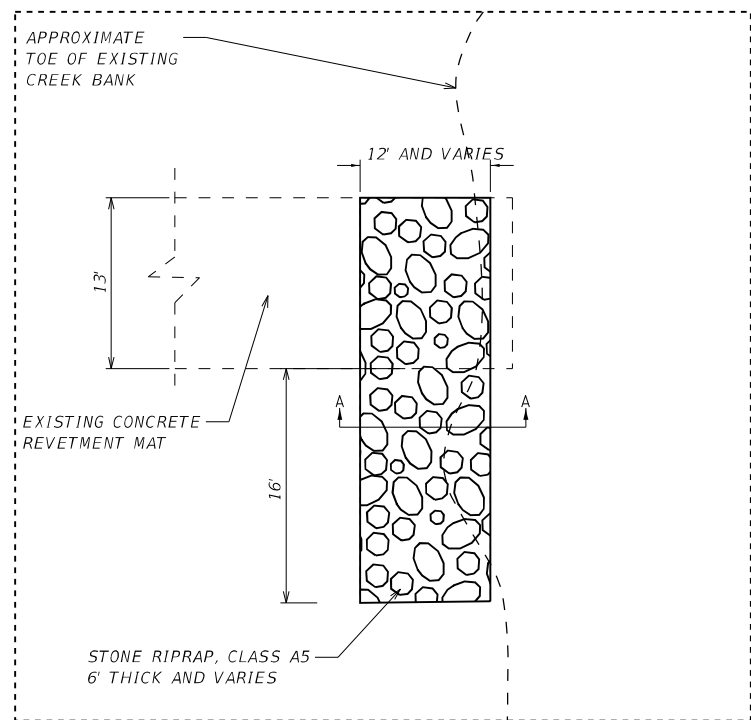
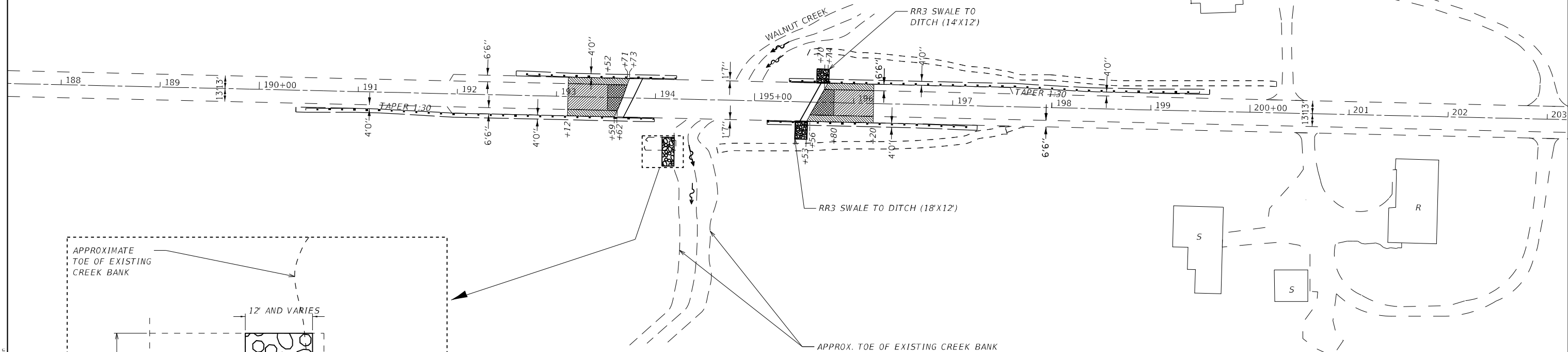

NOTES: SEE STRUCTURE DETAILS FOR PROPOSED WORK ON THE STRUCTURE, APPROACH PAVEMENTS, AND CONECTOR PAVEMENTS.
SEE GUARDRAIL DETAILS FOR MORE INFORMATION ON PROPOSED GUARDRAIL.
THE RIPRAP LAYOUT SHALL BE AS DETAILED HERE AND AS DIRECTED BY THE ENGINEER TO REESTABLISH THE ORIGINAL CREEK BANK.



MODEL SHEETS
FILE NAME: S:\CEN\W\03\STDP\US\S\03\11_3 Walnut Creek Bridge Presentation\CADD\11_3 Walnut Cr. Plan.dwg

USER NAME = Gerardo.Covarrubias	DESIGNED - _____	REVISED - _____
PLOT SCALE = 100,0000' / in.	CHECKED - _____	REVISED - _____
PLOT DATE = 12/15/2022	DATE - _____	REVISED - _____

**STATE OF ILLINOIS
DEPARTMENT OF TRANSPORTATION**

**PROPOSED PLAN
S.N. 072-0162**

SCALE: _____ SHEET 1 OF 1 SHEETS STA. _____ TO STA. _____

F.A.S. RTE.	SECTION	COUNTY	TOTAL SHEETS	SHEET NO.
1388	[(Z-4B-15D)BR]BDR.SCR	PEORIA	24	9
CONTRACT NO. 68G40				
ILLINOIS FED. AID PROJECT				

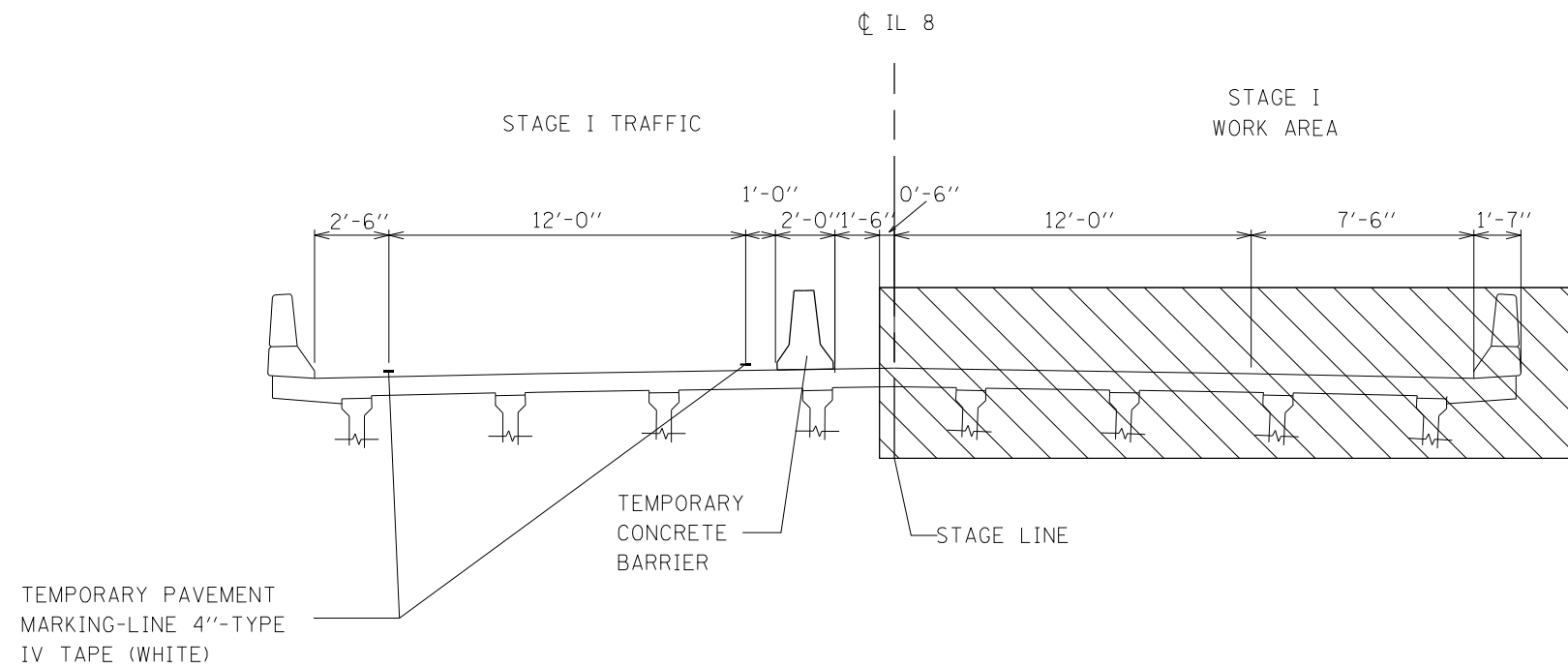

TYPICAL SECTION
STAGE I
(looking East)

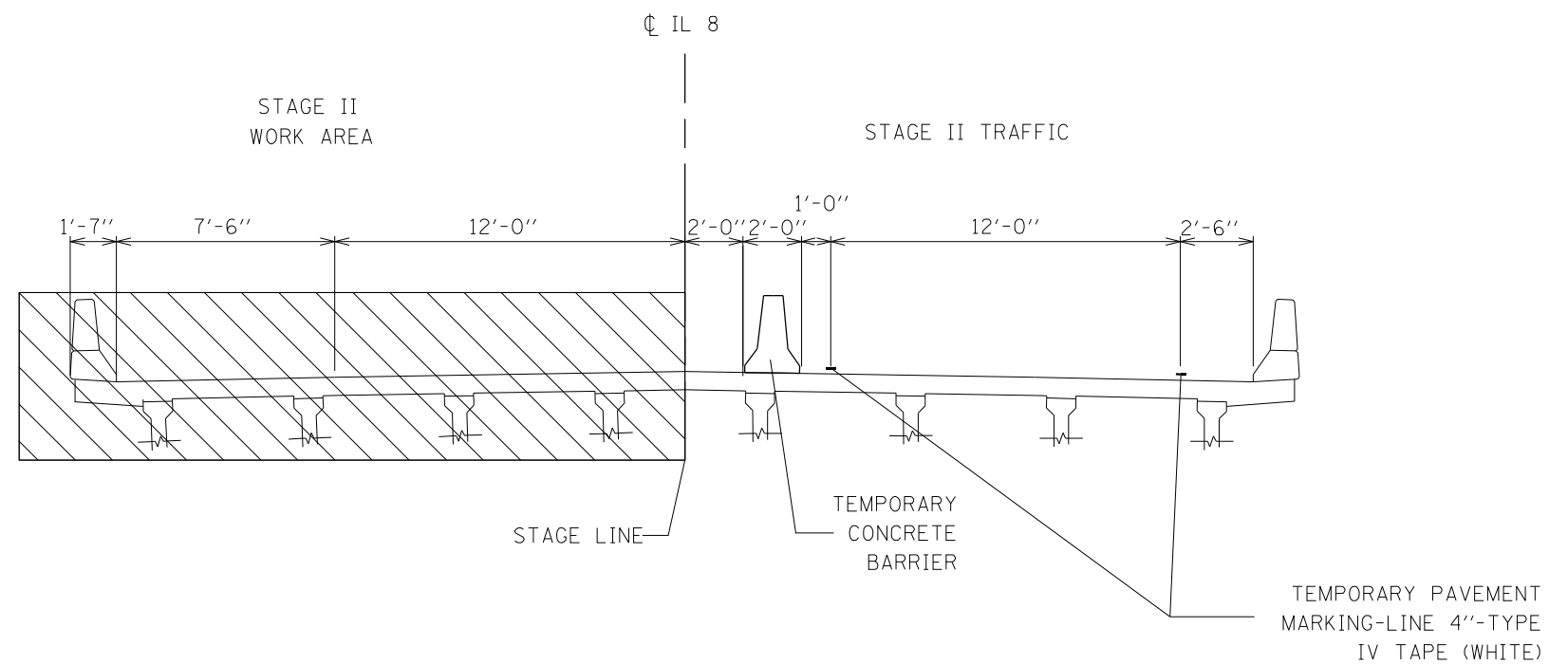

TYPICAL SECTION
STAGE II
(looking East)

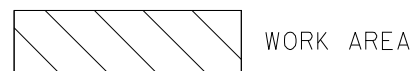

MODEL SHEETS
FILE NAME: S:\GEN\WORK\ORD\STDR\PLUS\Staus03\11_3\Wd\Int_Creek_Bridge_Presentation\CADD\11_3\Wd\Int_Cr_Typical.dgn

USER NAME = Gerardo.Covarrubias	DESIGNED - _____	REVISED - _____
PLOT SCALE = 100,0000' / in.	DRAWN - _____	REVISED - _____
PLOT DATE = 12/14/2022	CHECKED - _____	REVISED - _____
	DATE - _____	REVISED - _____

STATE OF ILLINOIS
DEPARTMENT OF TRANSPORTATION

STAGING TYPICAL SECTIONS
S.N. 072-0162

SCALE: _____ SHEET 2 OF 3 SHEETS STA. _____ TO STA. _____

F.A.S. RTE.	SECTION	COUNTY	TOTAL SHEETS	SHEET NO.
1388	[(Z-4B-15D)BR]BDR.SCR	PEORIA	24	11
ILLINOIS FED. AID PROJECT			CONTRACT NO. 68G40	

STAGE I

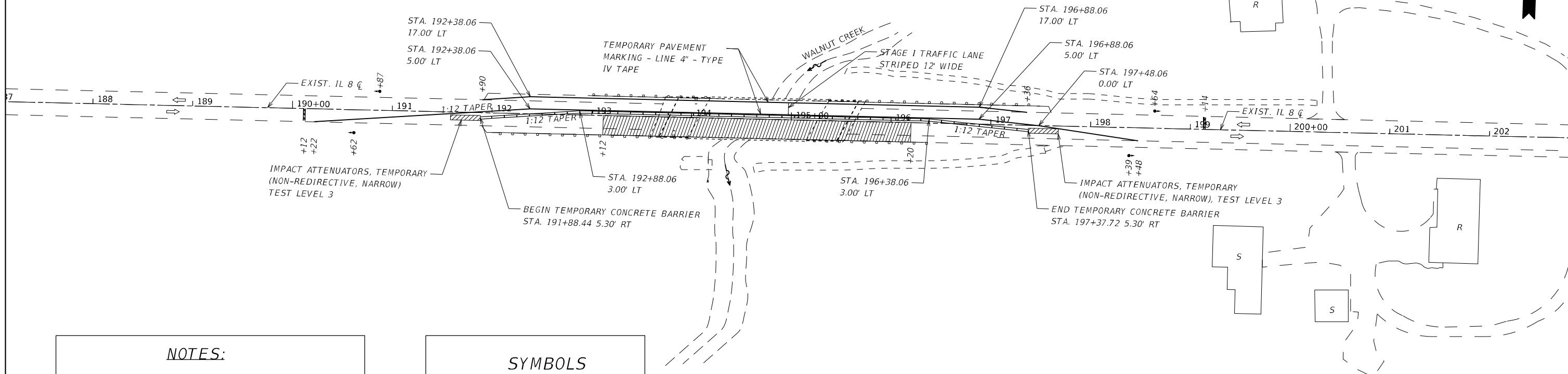

NOTES:

TEMPORARY CONCRETE BARRIER OFFSETS ARE PROVIDED TO THE CENTER LINE OF THE BARRIER. APPLICABLE PROPOSED GUARDRAIL SHALL BE INSTALLED IN EACH STAGE (SEE PROPOSED PLAN FOR GUARDRAIL DETAILS).

SYMBOLS

-  WORK AREA
-  TRAFFIC SIGNAL
-  STOP BAR

STAGE II

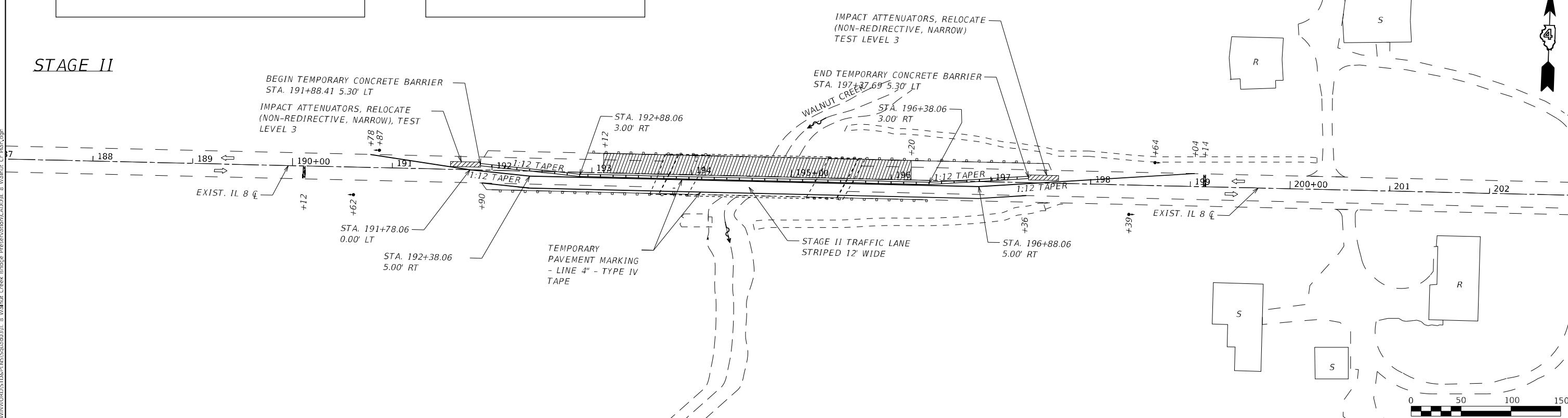

MODEL: sheets; FILE NAME: S:\GEN\WORK\ORD\STDEP\PLUS\Staus003\11_8 Walnut Creek Bridge Presentation\CADD\11_8 Walnut Creek Bridge.dwg

USER NAME = Gerardo.Covarrubias	DESIGNED - _____	REVISED - _____
DRAWN - _____	REVISED - _____	REVISED - _____
PLOT SCALE = 100,0000' / in.	CHECKED - _____	REVISED - _____
PLOT DATE = 12/15/2022	DATE - _____	REVISED - _____

**STATE OF ILLINOIS
DEPARTMENT OF TRANSPORTATION**

**STAGE I AND STAGE II
S.N. 072-0162**

SCALE: _____ SHEET 3 OF 3 SHEETS STA. _____ TO STA. _____

F.A.S. RTE.	SECTION	COUNTY	TOTAL SHEETS	SHEET NO.
1388	[(Z-48-15D)BR]BDR.SCR	PEORIA	24	12
CONTRACT NO. 68G40				
ILLINOIS FED. AID PROJECT				

Existing Structure: SN 072-0162, originally built in 1995 as IL 8, Section (7-4B-15D)BR. The superstructure consists of 3 span continuous composite 36" P.P.C. I-Beams with a cast in place 7 1/2" concrete deck. The substructure consists of integral abutments and concrete encased pile bent piers.

Stage construction will be utilized

SCOPE OF WORK

1. Scarify deck, approach slab and connector pavement and add 2 1/4" Microsilica Concrete Overlay
2. Apply protective coat on overlay
3. Remove and replace approach curbs

INDEX OF SHEETS

1. General Plan and Elevation
2. Stage Construction Details
3. Superstructure Details
4. Inlet Drain Adjustment

GENERAL NOTES

Plan dimensions and details relative to existing plans are subject to nominal construction variations. The Contractor shall field verify existing dimensions and details affecting new construction and make necessary approved adjustments prior to construction or ordering of materials. Such variations shall not be cause for additional compensation for a change in scope of the work, however, the Contractor will be paid for the quantity actually furnished at the unit price bid for the work.

Reinforcement Bars designated (E) shall be epoxy coated.
Protective Coat shall be applied to the concrete wearing surface.

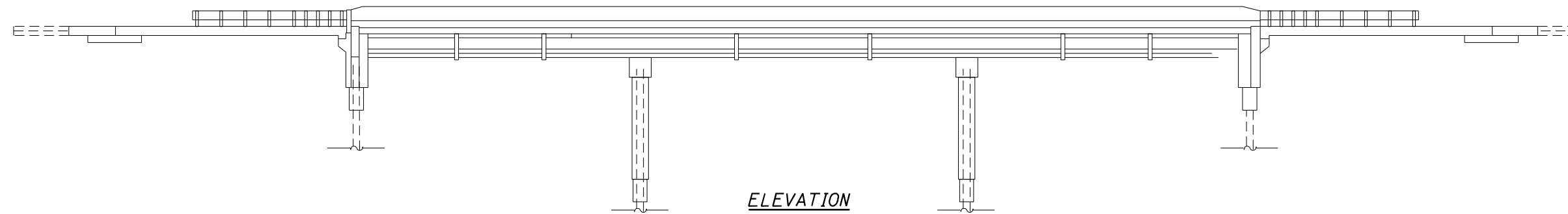

ELEVATION

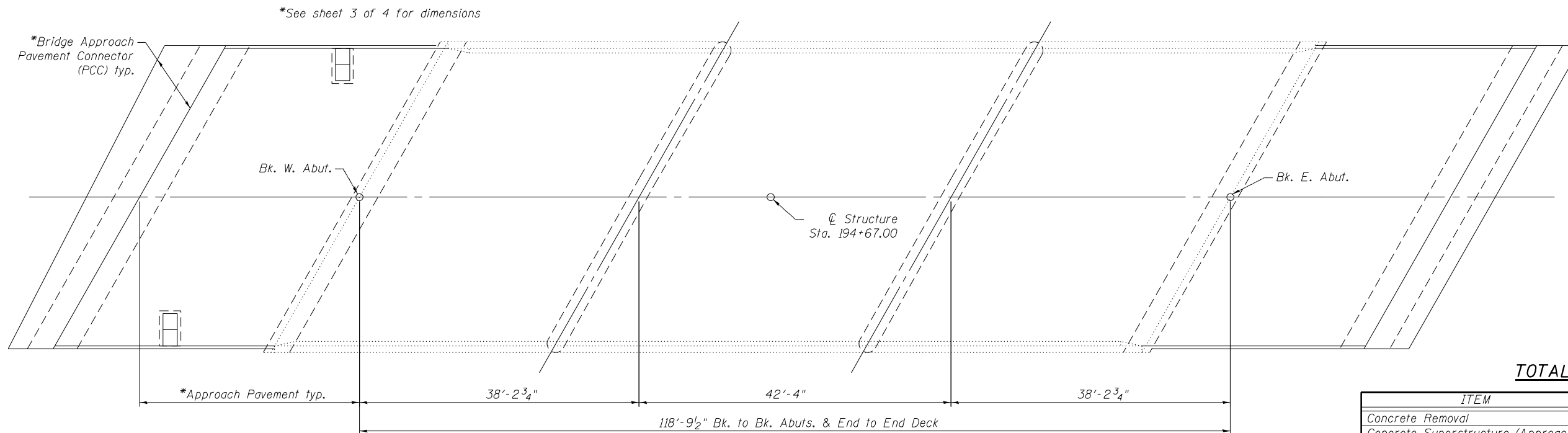

PLAN VIEW

TOTAL BILL OF MATERIAL

ITEM	UNIT	SUPER	SUB	TOTAL
Concrete Removal	Cu. Yd.	0.3		0.3
Concrete Superstructure (Approach Slab)	Cu. Yd.	1.3		1.3
Protective Coat	Sq. Yd.	873		873
Reinforcement Bars, Epoxy Coated	Pound	50		50
Frames and Grates to be Adjusted	Each	2		2
Bridge Deck Grooving	Sq. Yd.	857		857
Bridge Deck Scarification 3/4"	Sq. Yd.	867		867
Bridge Deck Microsilica Concrete Overlay 2 1/4"	Sq. Yd.	867		867
Polymer Concrete	Cu. Ft.	10.0		10.0

DESIGN STRESSES

Proposed
 $f'_c = 4,000$ psi
 $f_y = 60,000$ psi (reinforcement)

From Existing Plans
 $f'_c = 3,500$ psi (Cast-in-place Concrete)
 $f_y = 60,000$ psi (Reinforcement)
 $f'_c = 6,000$ psi (Precast Concrete)
 $f_s = 270,000$ psi (Prestressing Strands)
 $f_{ci} = 4,800$ psi (Precast Concrete)
 $f_{si} = 202,500$ psi (Prestressing Strands)

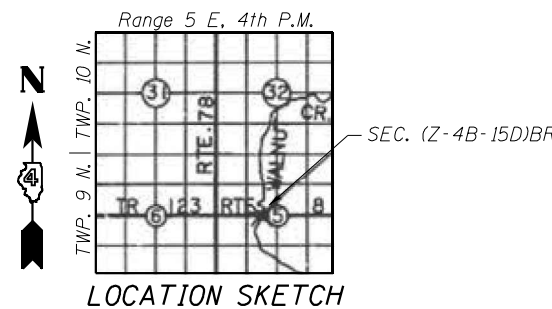

LOCATION SKETCH

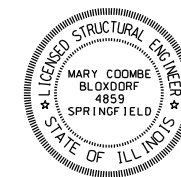

Mary Coombe Bloxdorf

ILLINOIS STRUCTURAL NO. 4859
 EXPIRES 11/30/24
 DATE: 02/01/23

GENERAL PLAN AND ELEVATION
FAS 1388 (IL 8)
OVER WALNUT CREEK
SECTION [(Z-4B-15D)BR]BDR.SCR
PEORIA COUNTY
STA 194+67.00
STRUCTURE NUMBER 072-0162

MODEL: Default
FILE NAME: C:\micrsoft\brm\15-1016N072-0162 - GPE.dwg
FEHR GRAHAM PROJECT NUMBER: 15-1016N

FEHR GRAHAM
 ENGINEERING & ENVIRONMENTAL
 ILLINOIS DESIGN FIRM NO. IB4-003525

USER NAME = mescalel	DESIGNED -	REVISED -
PLOT SCALE = N/A	DRAWN MCE	REVISED -
PLOT DATE = 09/20/2022	CHECKED MCB	REVISED -
	DATE -	REVISED -

STATE OF ILLINOIS
 DEPARTMENT OF TRANSPORTATION

GENERAL PLAN AND ELEVATION
 SN 072-0162

SCALE: N/A SHEET 1 OF 4 SHEETS STA. TO STA.

F.A.P. RTE.	SECTION	COUNTY	TOTAL SHEETS	SHEET NO.
1388	[(Z-4B-15D)BR]BDR.SCR	PEORIA	24	13
			CONTRACT NO. 68G40	
ILLINOIS FED. AID PROJECT				

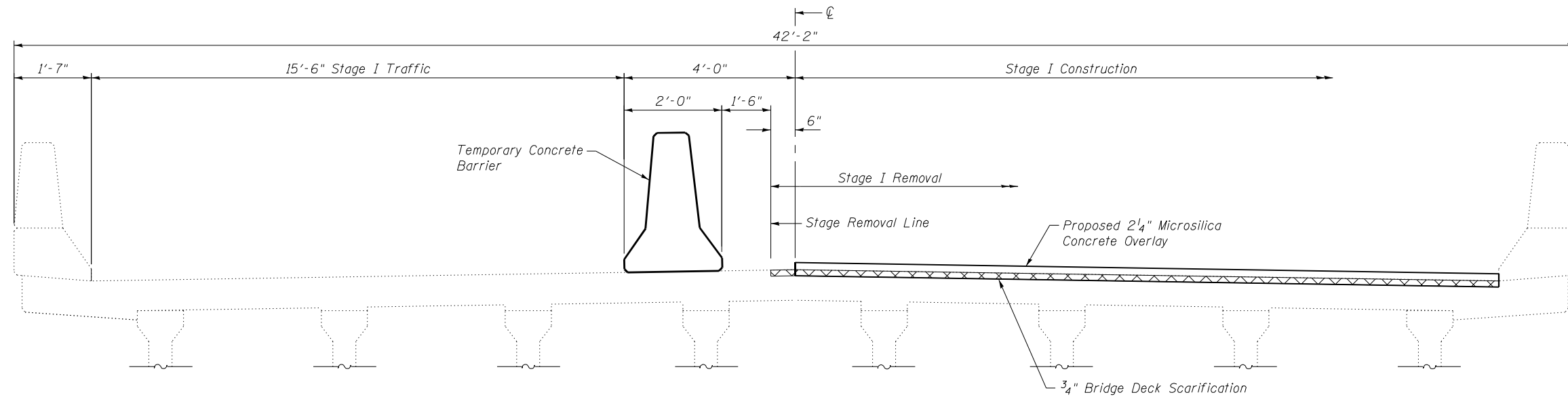

STAGE I CONSTRUCTION
(Looking East)

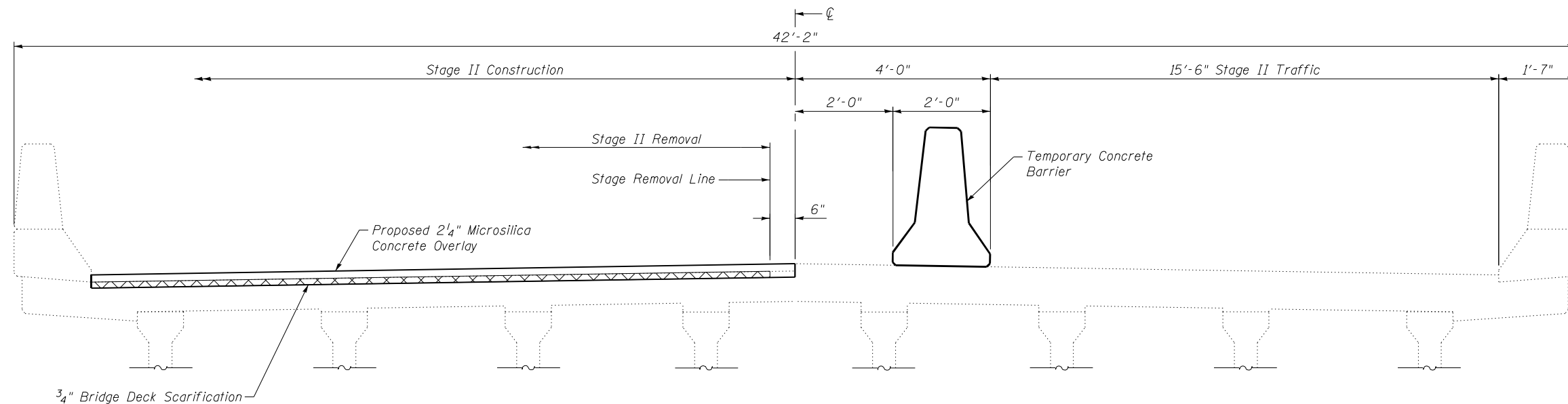

STAGE II CONSTRUCTION
(Looking East)

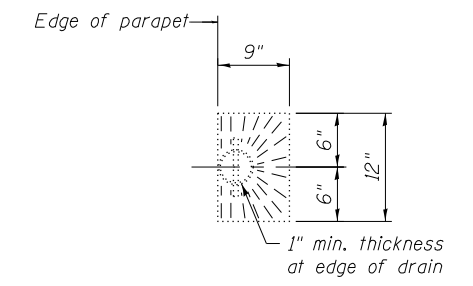

TOP PLAN AT OPEN DECK DRAINS

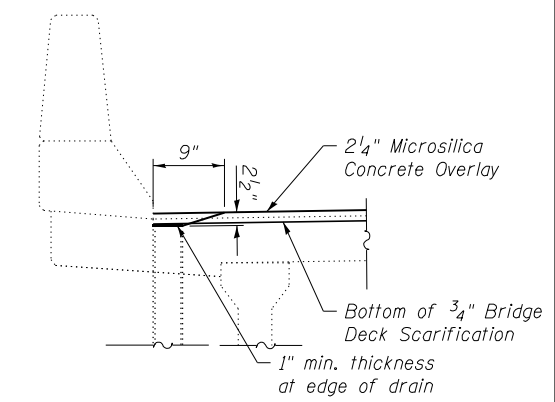

SECTION AT OPEN DECK DRAINS
(Showing overlay taper)

Notes:
See Roadway Plans for Maintenance of Traffic Details.
The limits for the proposed Bridge Deck Scarification and Bridge Deck Overlay extend from the end of the west connector pavement to the end of the east connector pavement including the approach shoulders to the face of curbs or edge of pavement where there is no curb. The depth of overlay on the approaches may be adjusted in the field as directed by the Engineer & proposed curb heights adjusted accordingly to maintain 4" height above the top of the proposed overlay.

MODEL: Default
FILE NAME: C:\licent\brdm\15-15-1016\072-0162 - Stage.dgn

FEHR GRAHAM
ENGINEERING & ENVIRONMENTAL
ILLINOIS DESIGN FIRM NO. 184-003525

USER NAME = mesca1	DESIGNED -	REVISED -
PLOT SCALE = N/A	DRAWN MCE	REVISED -
PLOT DATE = 09/20/2022	CHECKED MCB	REVISED -
	DATE -	REVISED -

STATE OF ILLINOIS
DEPARTMENT OF TRANSPORTATION

STAGE CONSTRUCTION
SN 072-0162

SCALE: N/A SHEET 2 OF 4 SHEETS STA. TO STA.

F.A. RTE.	SECTION	COUNTY	TOTAL SHEETS	SHEET NO.
1388	((Z-4B-15D)BR)BDR.SCR	PEORIA	24	14
CONTRACT NO. 68G40			ILLINOIS FED. AID PROJECT	

FEHR GRAHAM PROJECT NUMBER: 15-1016N

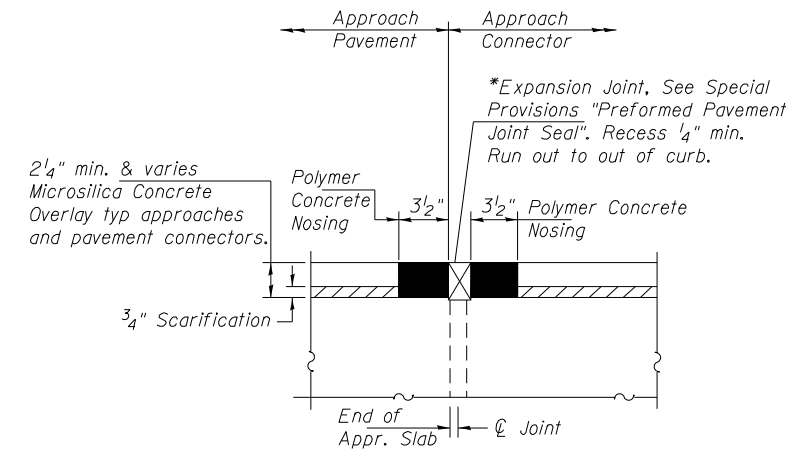
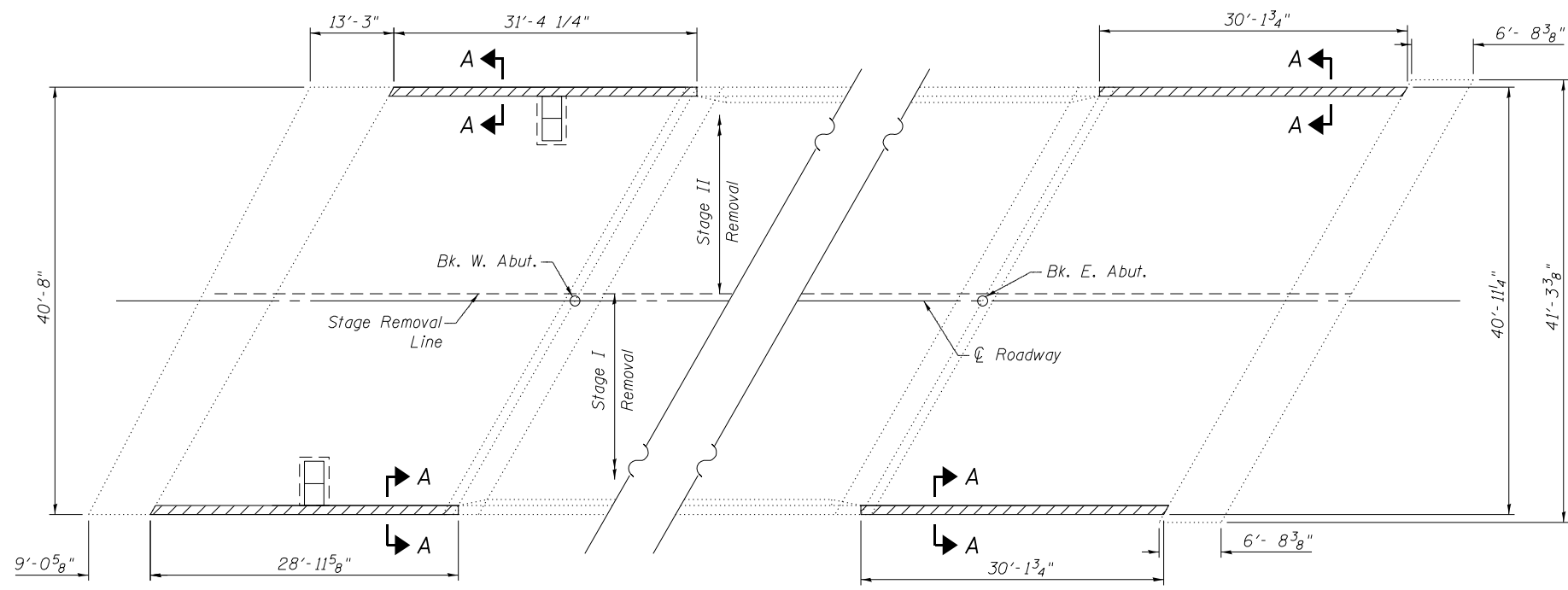

* Cost included with Polymer Concrete

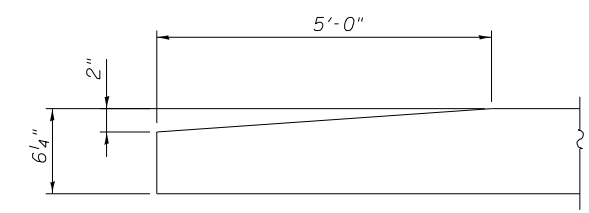

Remove the existing joint seal at the end of the approach pavement and replace as shown in Detail A, typ. The removal of the existing joint seal is included with Polymer Concrete.

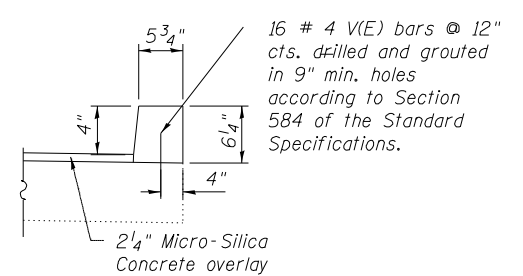
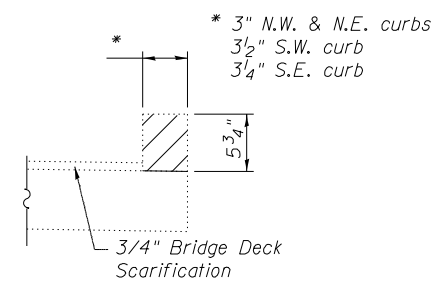
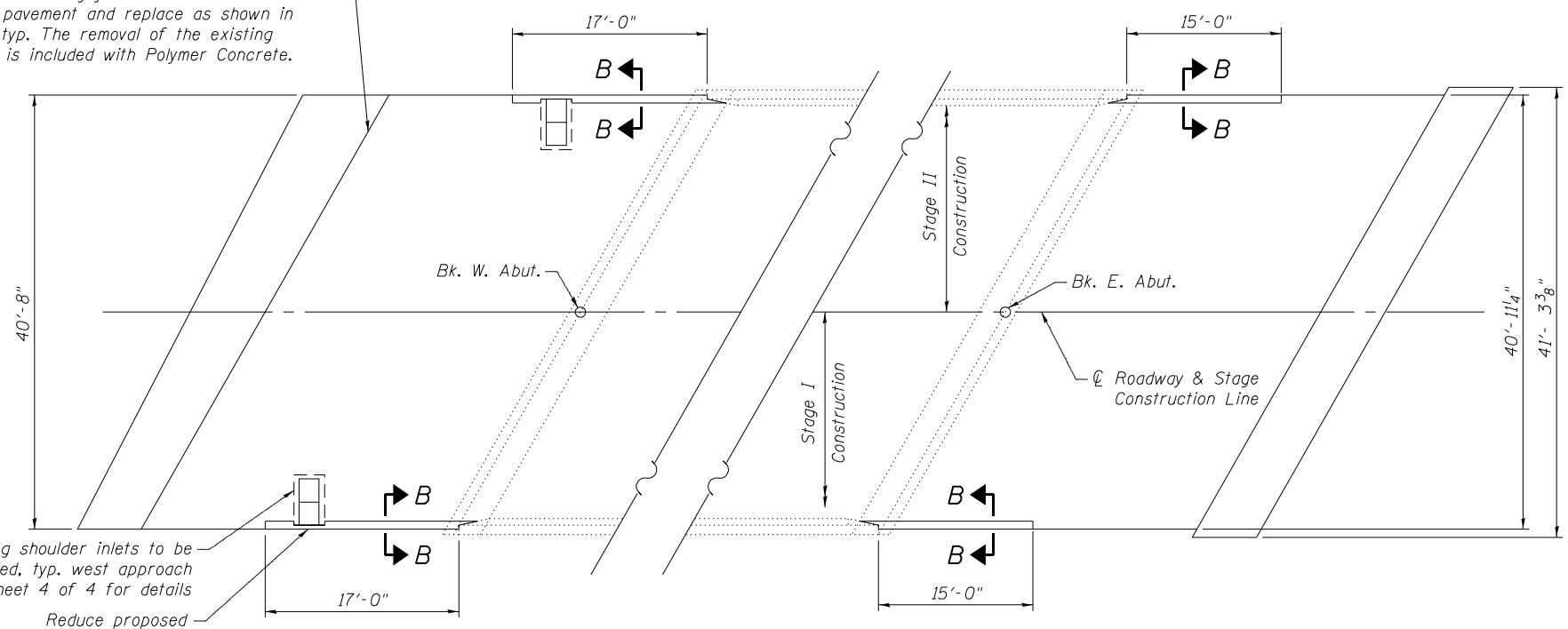

BILL OF MATERIAL

Bar	No.	Size	Length	Shape
V(E)	64	#4	1'-1"	
Concrete Removal			Cu. Yd.	0.3
Concrete Superstructure (Approach Slab)			Cu. Yd.	0.6
Reinforcement Bars, Epoxy Coated			Pound	50
Polymer Concrete			Cu. Ft.	10.0

MODEL: Default
FILE NAME: C:\licent\pdm\15-15-1016\072-0162 - CRB.dwg
FEHR GRAHAM PROJECT NUMBER: 15-1016N

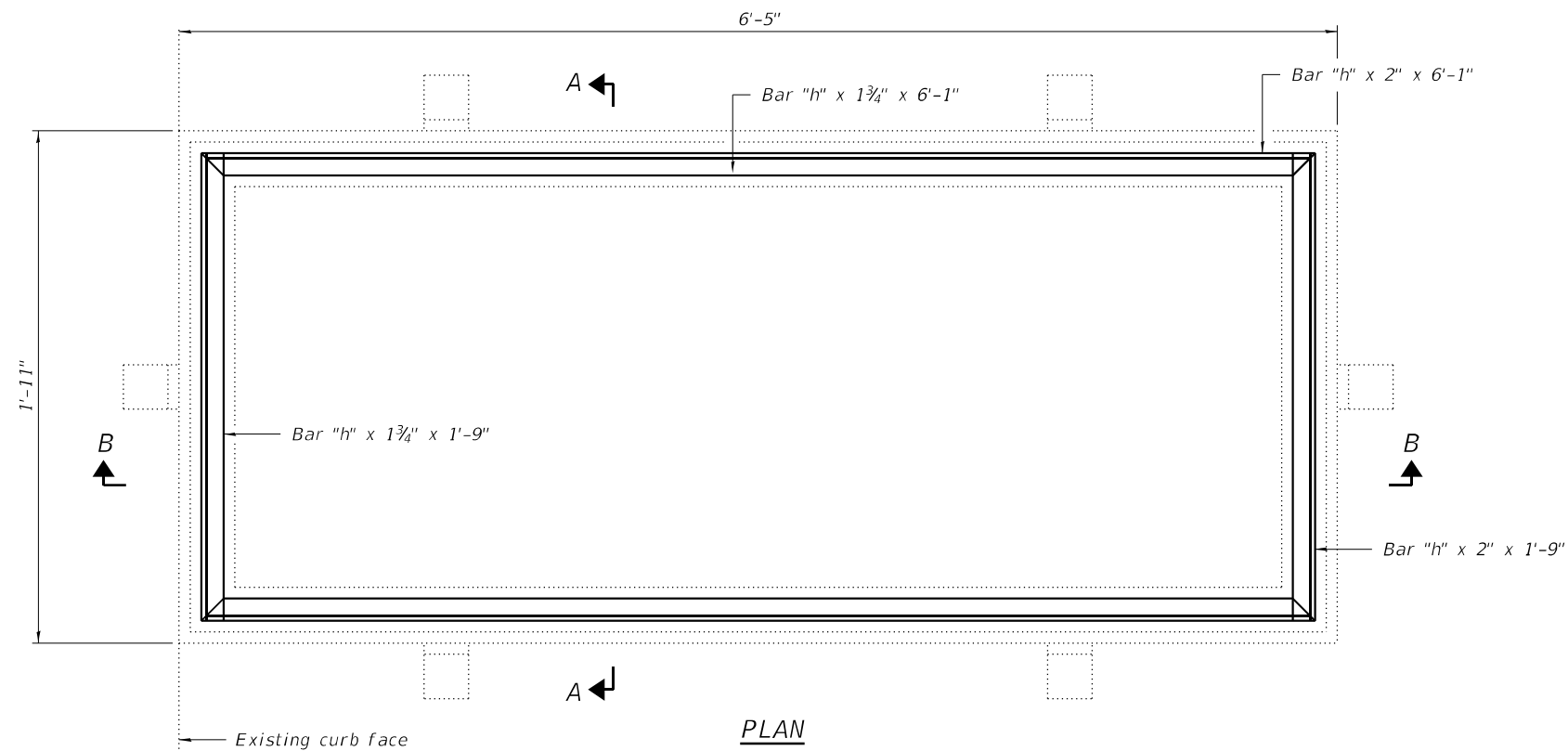

Notes:

The contractor shall ensure that no damage is done to existing grates to be reused. Shop plans for proposed adjusting scupper ring shall be submitted for approval prior to fabrication.

Cost of all labor and materials necessary to remove existing grates, clean existing scuppers, install adjusting scupper rings and reinstalling grates is included in the cost per unit each for Frames and Grates to be Adjusted.

All structural steel shall conform to AASHTO Classification M-270 Gr. 36. The adjusting scupper ring shall be galvanized.

Bolts shall be 1/2"Ø, AASHTO M164 Type 1, mechanically galvanized. Contractor shall be responsible for field verification of dimensions.

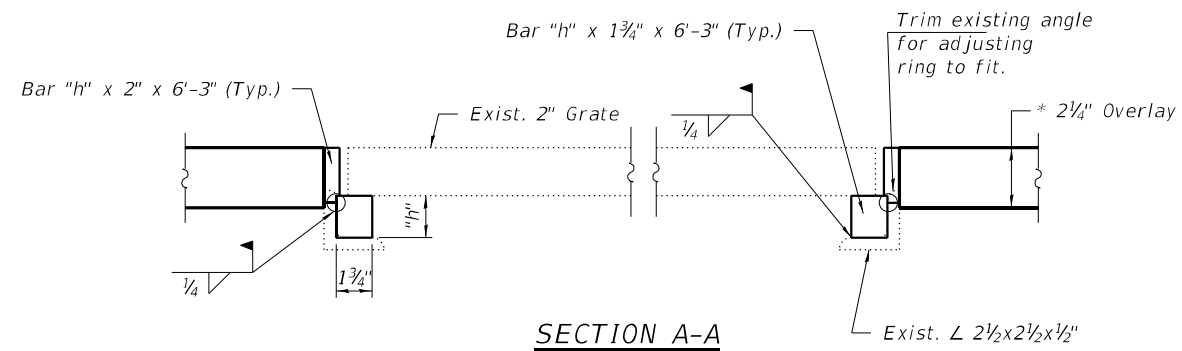

"h" : Height is determined by the engineer in the field to allow for the variable thickness of Microsilica Concrete Overlay.

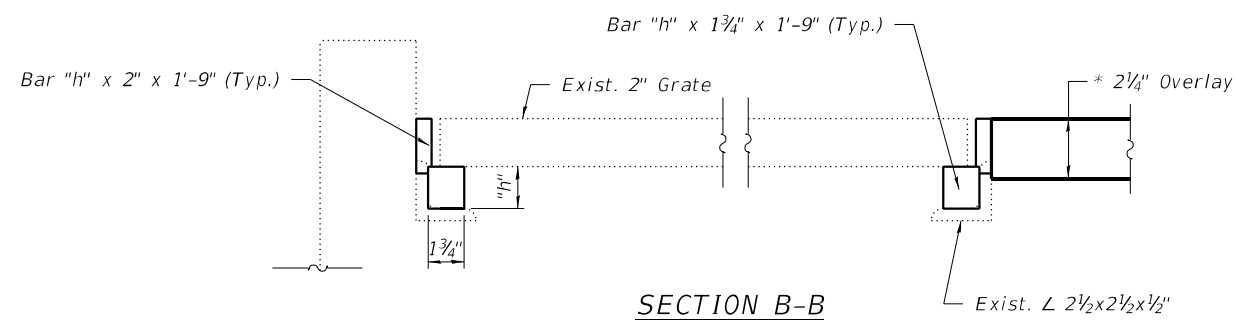

BILL OF MATERIAL

Item	Unit	Total
Frames and Grates to be Adjusted	Each	2

MODEL: 001
FILE NAME: C:\micrsoft\pdm\15-15-101\68072-0162 - Inlet Adjustments.dgn

FEHR GRAHAM
ENGINEERING & ENVIRONMENTAL
ILLINOIS DESIGN FIRM NO. 184-003525

USER NAME = mesca1	DESIGNED - _____	REVISED - _____
PLOT SCALE = N/A	DRAWN MCE	REVISED - _____
PLOT DATE = 11/01/2022	CHECKED MCB	REVISED - _____
	DATE - _____	REVISED - _____

STATE OF ILLINOIS
DEPARTMENT OF TRANSPORTATION

INLET DRAIN ADJUSTMENT
SN 072-0162

SCALE: N/A SHEET 4 OF 4 SHEETS STA. TO STA.

F.A.P. RTE.	SECTION	COUNTY	TOTAL SHEETS	SHEET NO.
1388	(Z-4B-15D)BR BDR.SCR	PEORIA	24	16
ILLINOIS FED. AID PROJECT			CONTRACT NO. 68G40	

FEHR GRAHAM PROJECT NUMBER: 15-1016N

LEGEND

- GUARDRAIL AGGREGATE EROSION CONTROL
- ① TRAFFIC BARRIER TERMINAL, TYPE 1 (SPECIAL) TANGENT
- ② STEEL PLATE BEAM GUARDRAIL, TYPE A, 6 FOOT POSTS
- ③ TRAFFIC BARRIER TERMINAL, TYPE 6

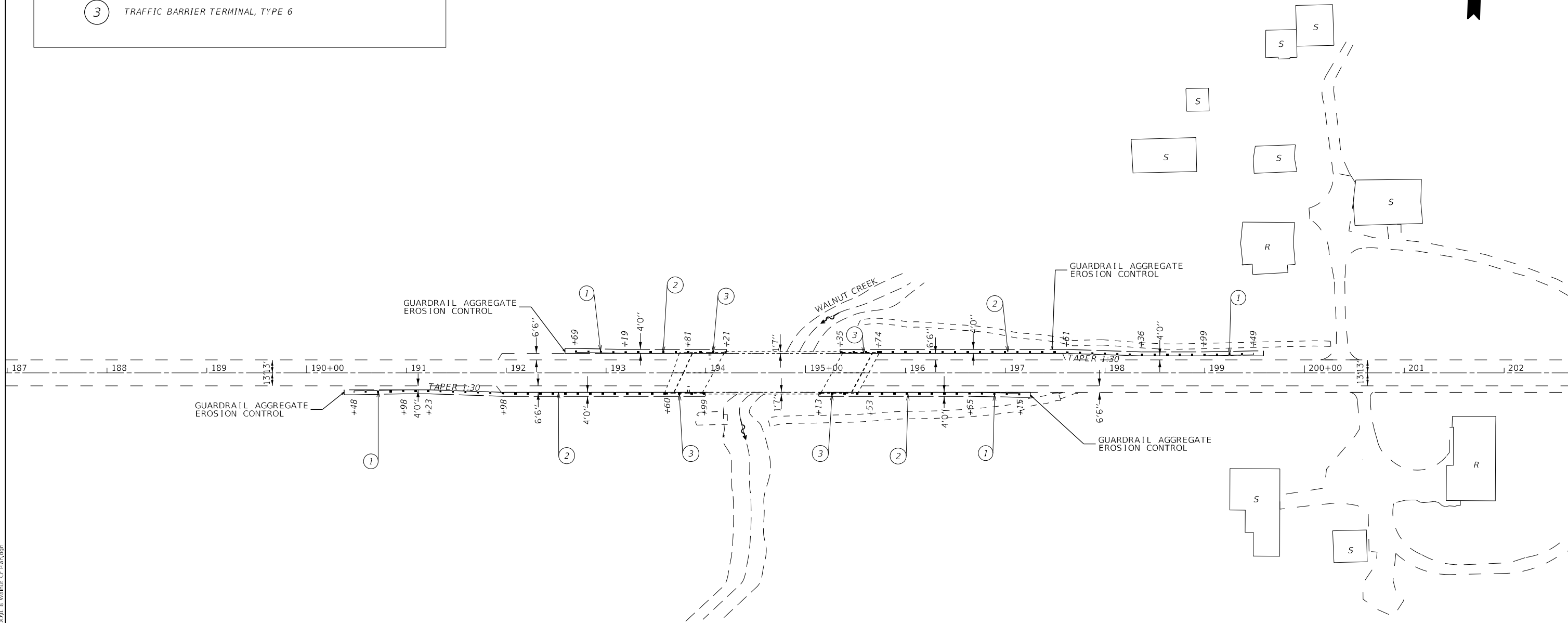

MODEL SHEETS
 FILE NAME: S:\GEN\W\W02\STDEP\US\Sus03\11_8 Walnut Creek Bridge Presentation\CADD\11_8 Walnut Cr Plan.dwg

USER NAME = Gerardo.Covarrubias	DESIGNED - _____	REVISED - _____
PLOT SCALE = 100,0000' / in.	CHECKED - _____	REVISED - _____
PLOT DATE = 12/15/2022	DATE - _____	REVISED - _____

**STATE OF ILLINOIS
DEPARTMENT OF TRANSPORTATION**

**GUARDRAIL DETAILS
S.N. 072-0162**

SCALE: _____ SHEET 1 OF 1 SHEETS STA. _____ TO STA. _____

F.A.S. RTE.	SECTION	COUNTY	TOTAL SHEETS	SHEET NO.
1388	[(Z-4B-15D)BR]BDR,SCR	PEORIA	24	17
CONTRACT NO. 68G40			ILLINOIS FED. AID PROJECT	

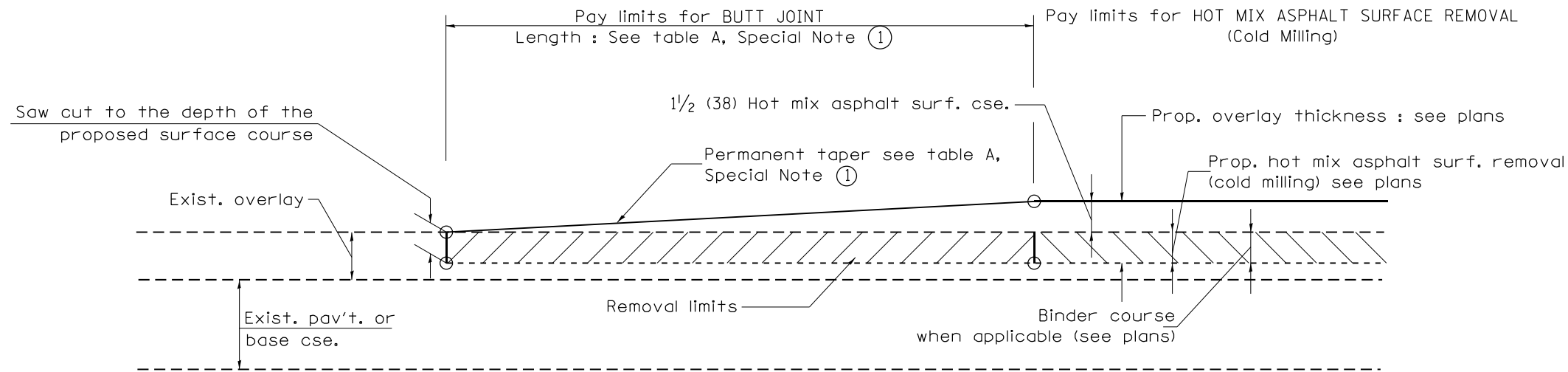

CASE 1 : WITH HOT MIX ASPHALT SURFACE REMOVAL (COLD MILLING)

**TABLE A
TAPER RATES**

SPECIAL NOTE NUMBER	ELEMENT	MAINLINE INTERSTATES & 4-LANE EXPRESSWAYS	ALL OTHERS
①	BUTT JOINT TAPER RATE	1:480	1:240
②	TEMPORARY RAMP TAPER RATE	1:80	1:40

GENERAL NOTES

1. The work shall be done in accordance with Article 406.08 and the Special Provision for Butt Joints.
2. The pavement surface to be removed may be either bituminous or P.C. concrete. The work shall be performed in accordance with Article 440.04 and the Special Provisions for Butt Joints.
3. The saw cut joints shall be primed just prior to the placing of bituminous material. The work will be in accordance with the applicable portions of Article 406.05.
4. The length of butt joint is based on the taper rate times change in cold milling depth within the butt joint pay limits, unless otherwise indicated.
5. Temporary ramps are paid for separately and not included in the cost of the butt joints.

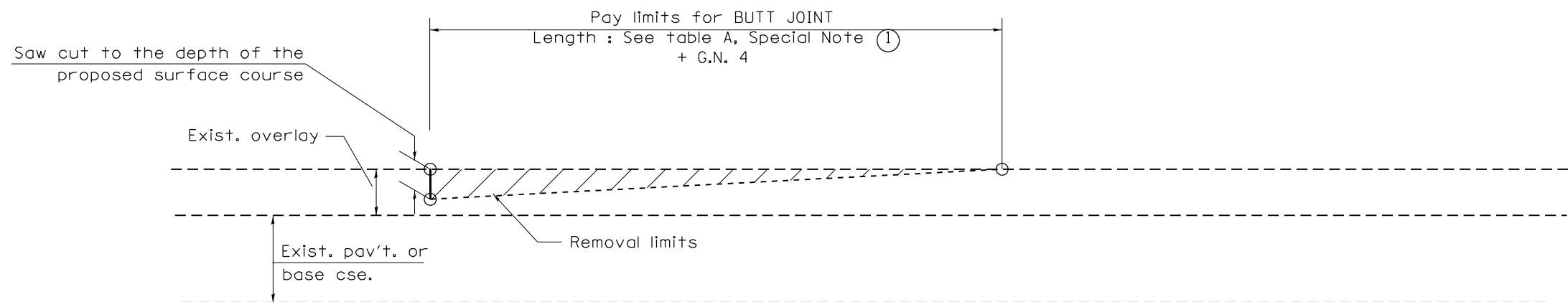

CASE 2 : NO HOT MIX ASPHALT SURFACE REMOVAL (COLD MILLING)

All dimensions are in inches (millimeters) unless otherwise noted.

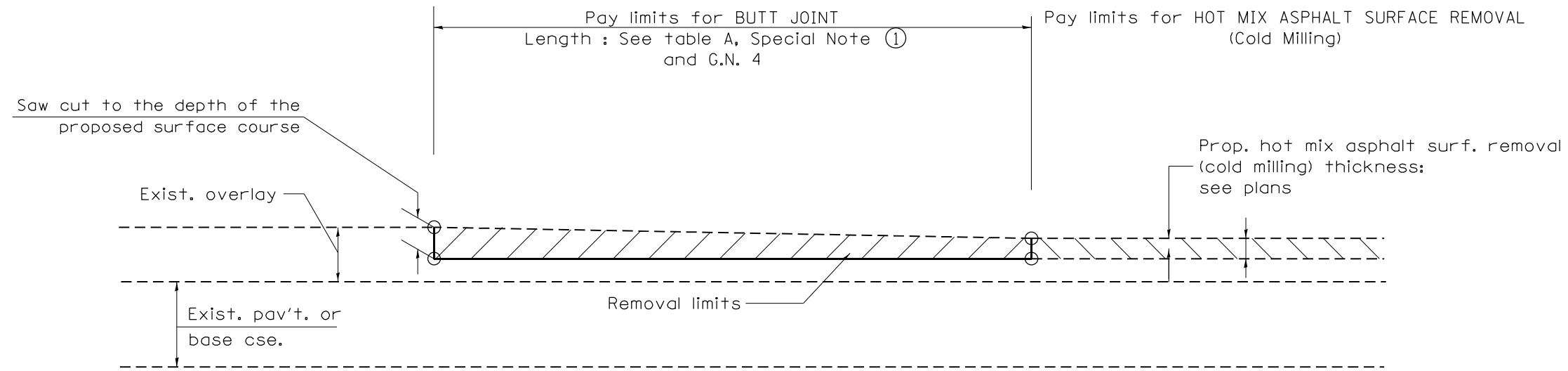

**CASE 3 : HOT MIX ASPHALT SURFACE REMOVAL (COLD MILLING)
TIE-IN TO EXISTING BITUMINOUS TAPER**

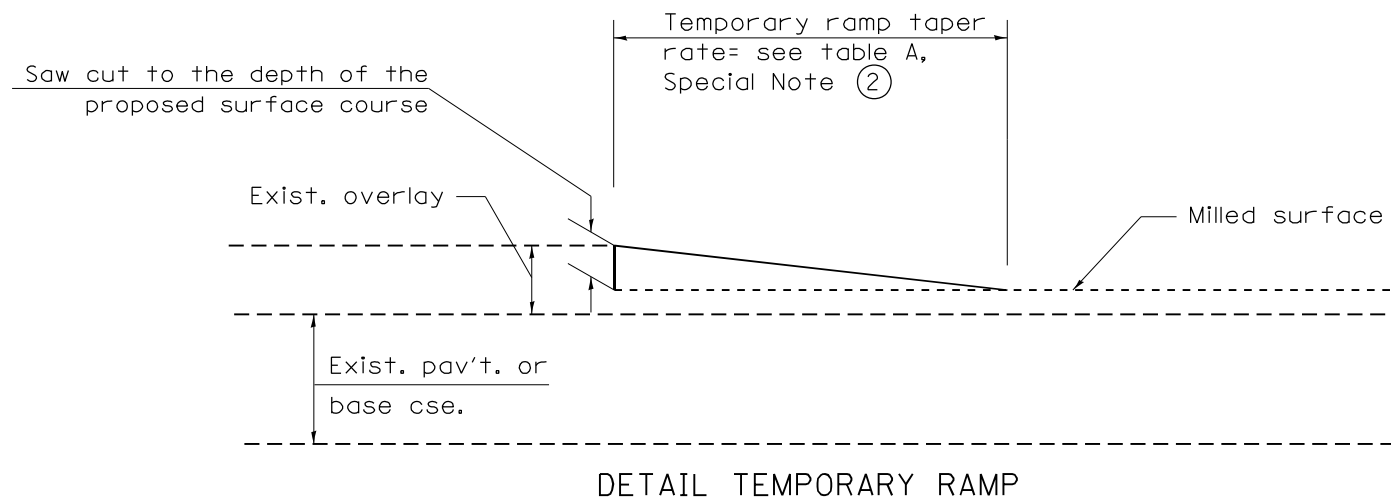

All dimensions are in inches (millimeters) unless otherwise noted.

				STATE OF ILLINOIS DEPARTMENT OF TRANSPORTATION		BUTT JOINTS		SHT. 2 OF 3 CADD STD. 406101-D4	
				NOT TO SCALE				CONTRACT NO. 68G40	
F.A.S RTE.	SECTION	COUNTY	TOTAL SHEETS	SHEET NO.					
1388	[Z-4B-15D]BRJBDR,SCR	PEORIA	24	19					
FED. ROAD DIST. NO.		ILLINOIS FED. AID PROJECT							

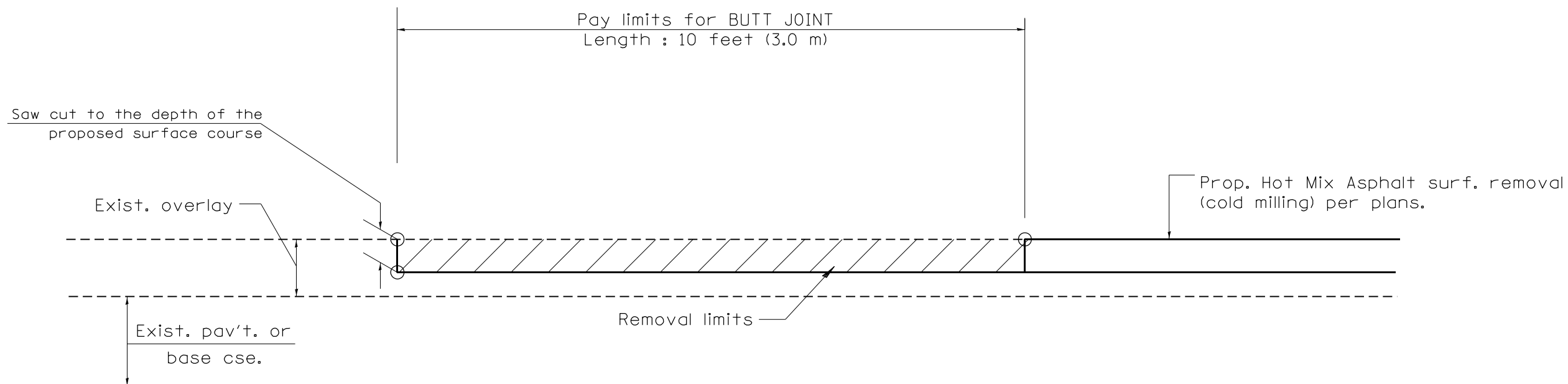

CASE 4 : SINGLE LIFT OVERLAY WITH EQUIVALENT DEPTH
HOT MIX ASPHALT SURFACE REMOVAL (COLD MILLING)
TIE-IN TO EXISTING BITUMINOUS TAPER

All dimensions are in inches (millimeters) unless otherwise noted.

				STATE OF ILLINOIS DEPARTMENT OF TRANSPORTATION		BUTT JOINTS		SHT. 3 OF 3 CADD STD. 406101-D4		<table border="1"> <tr> <th>F.A.S. RTE.</th> <th>SECTION</th> <th>COUNTY</th> <th>TOTAL SHEETS</th> <th>SHEET NO.</th> </tr> <tr> <td>1388</td> <td>[Z-4B-15D]BRJBDOR,SCR</td> <td>PEORIA</td> <td>24</td> <td>20</td> </tr> <tr> <td colspan="3"></td> <td colspan="2" style="text-align: center;">68C40</td> </tr> </table>		F.A.S. RTE.	SECTION	COUNTY	TOTAL SHEETS	SHEET NO.	1388	[Z-4B-15D]BRJBDOR,SCR	PEORIA	24	20				68C40	
F.A.S. RTE.	SECTION	COUNTY	TOTAL SHEETS	SHEET NO.																						
1388	[Z-4B-15D]BRJBDOR,SCR	PEORIA	24	20																						
			68C40																							
						NOT TO SCALE				<table border="1"> <tr> <td>FED. ROAD DIST. NO.</td> <td>ILLINOIS FED. AID PROJECT</td> </tr> </table>		FED. ROAD DIST. NO.	ILLINOIS FED. AID PROJECT													
FED. ROAD DIST. NO.	ILLINOIS FED. AID PROJECT																									

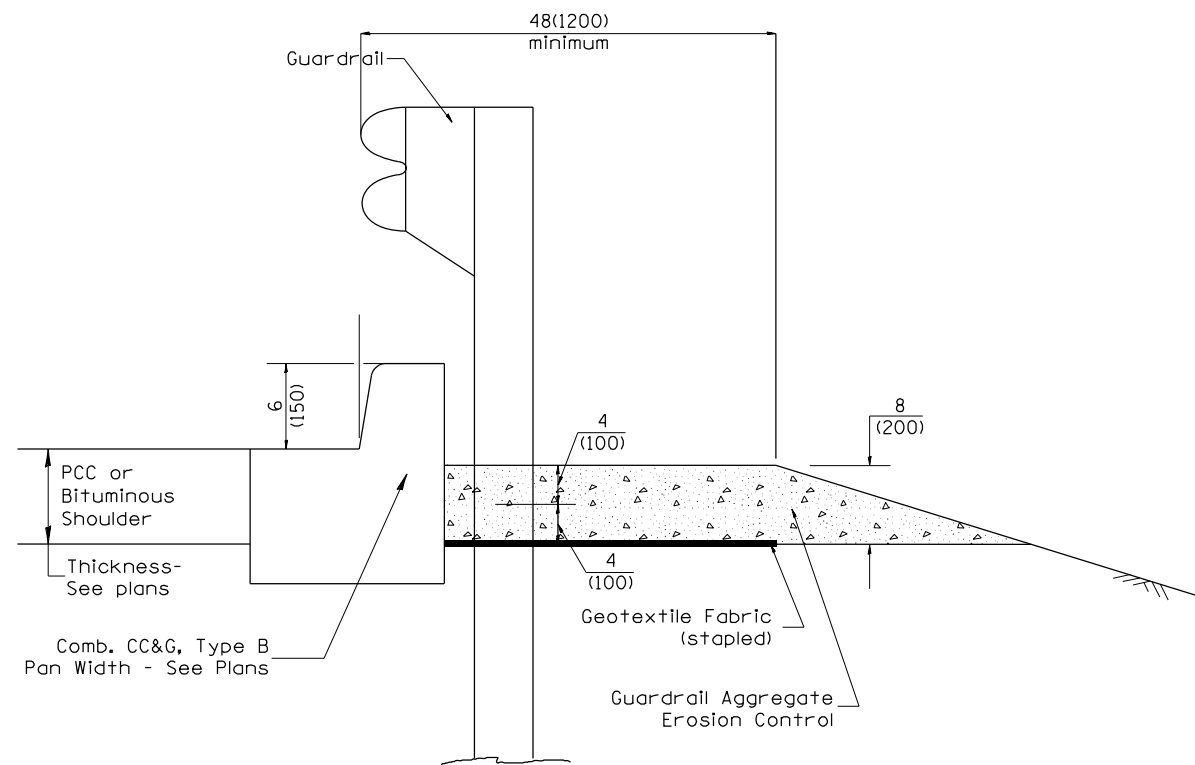

TYPICAL SECTION WITH COMBINATION CONCRETE CURB & GUTTER

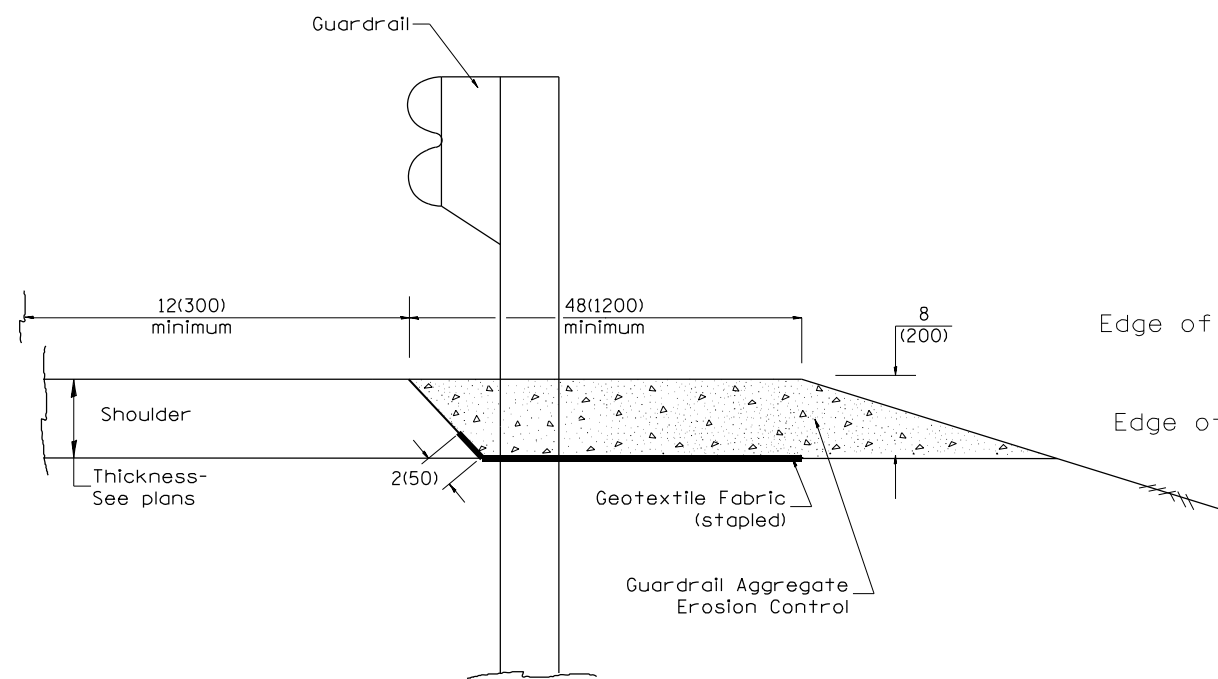

TYPICAL SECTION WITHOUT EROSION CONTROL CURB

GENERAL NOTES: GUARDRAIL AGGREGATE EROSION CONTROL

1. This work shall consist of grading as needed, furnishing and installing geotextile fabric and staples, and furnishing, placing and shaping crushed aggregate around and behind Steel Plate Beam Guardrail posts in accordance with Plan Details.
2. Before placing the aggregate and the Geotextile Fabric, weeds and grass shall be removed from the area to be covered.
3. After the area has been prepared, and in a dry condition, the Geotextile fabric shall be placed with a 12(300) minimum overlap. A knife cut for guardrail post installation is necessary.
4. The aggregate shall be deposited, compacted and shaped by either mechanical or hand methods, in a manner reasonably true to line and grade.
5. The Contractor shall have the option of placing the guardrail before or after the Geotextile Fabric and Aggregate are in place. If the guardrail is placed after the Geotextile Fabric and Aggregate, then any voids must be filled and the aggregate returned to line and grade.
6. Materials shall meet the following requirements:
 - A. The crushed aggregate shall be CA1 gradation in accordance with Article 1004.01(c) of the Standard Specifications.
 - B. The Geotextile Fabric shall be nonwoven fabric in accordance with Article 1080.02 of the Standard Specifications.

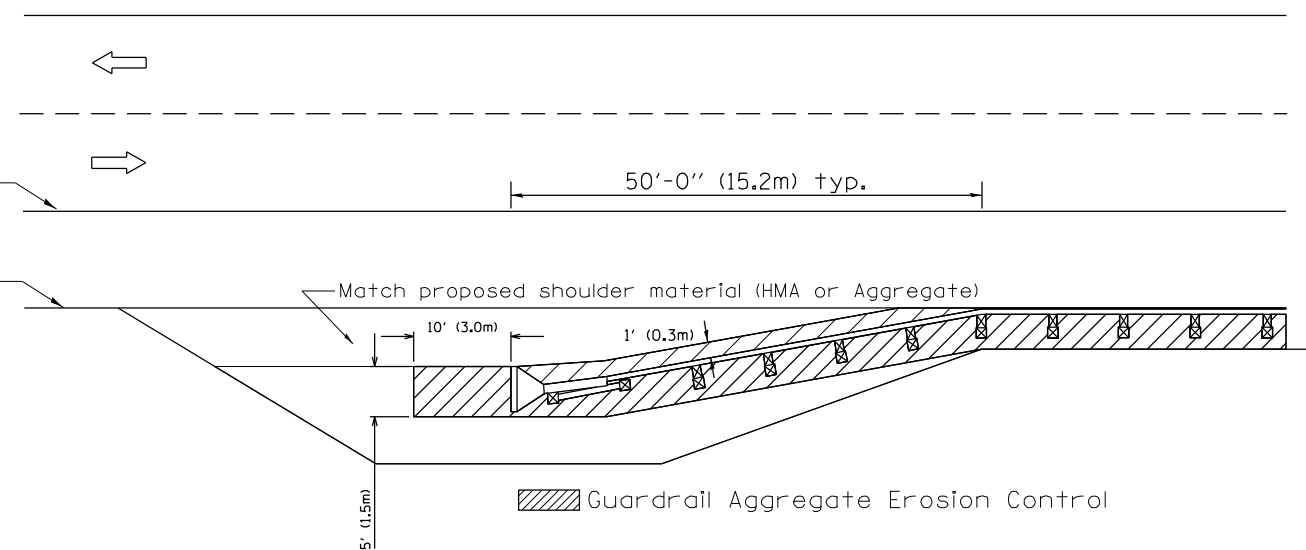

All dimensions are in inches (millimeters) unless otherwise noted.

03-07-11	ADDED DETAIL SHOWING PLAN VIEW	R.D.	5-30-18	CHANGE B CURB TO CC&G	R.D.
08-10-12	REVISED CURB "B" AND AGGREGATE	R.D.	07-16-19	SPELLING CORRECTIONS	R.D.
07-15-15	ADDRESSED SHOULDER INLET CURB	R.D.			
01-26-17	REVISED	R.D.			

**STATE OF ILLINOIS
DEPARTMENT OF TRANSPORTATION**

NOT TO SCALE

GUARDRAIL EROSION CONTROL TREATMENTS

SHI, 1 OF 2
CADD STD. 630101-04

F.A.S. RTE.	SECTION	COUNTY	TOTAL SHEETS	SHEET NO.
1388	[I-4B-15D]BRJBD,SCR	PEORIA	24	21
CONTRACT NO. 68G40				

FED. ROAD DIST. NO. [ILLINOIS] FED. AID PROJECT

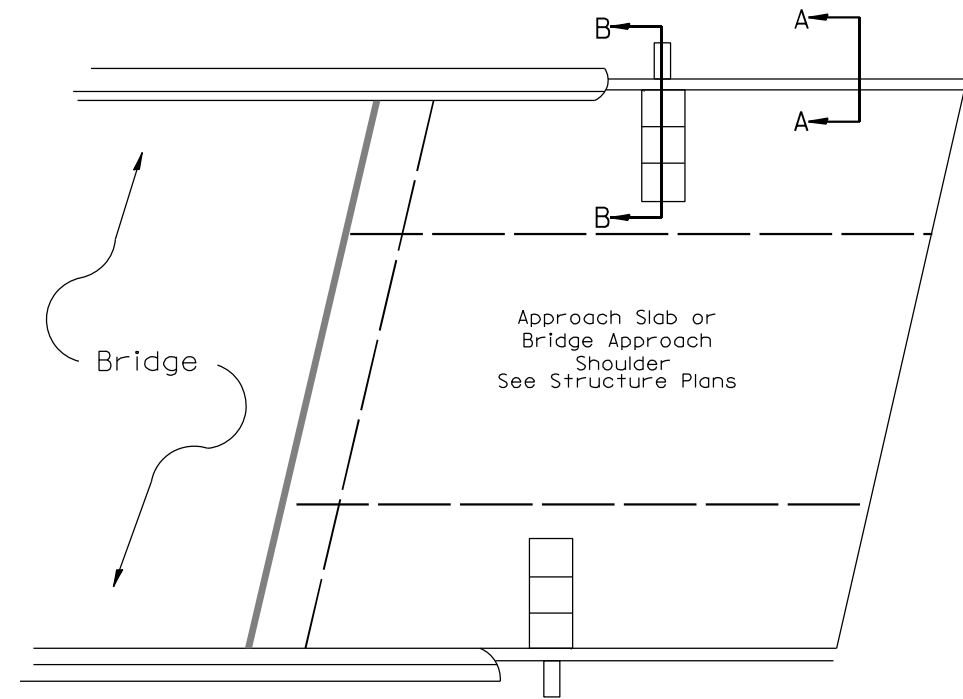
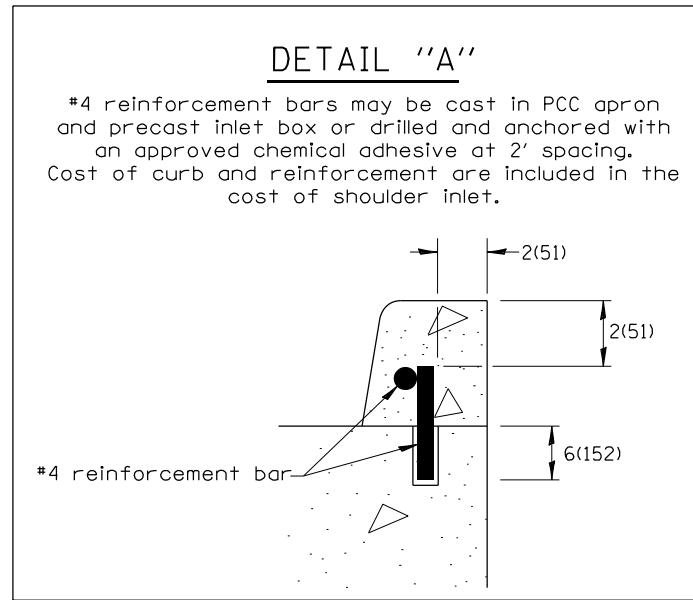

PLAN VIEW
APPROACH SLAB OR SHOULDER PLACEMENT

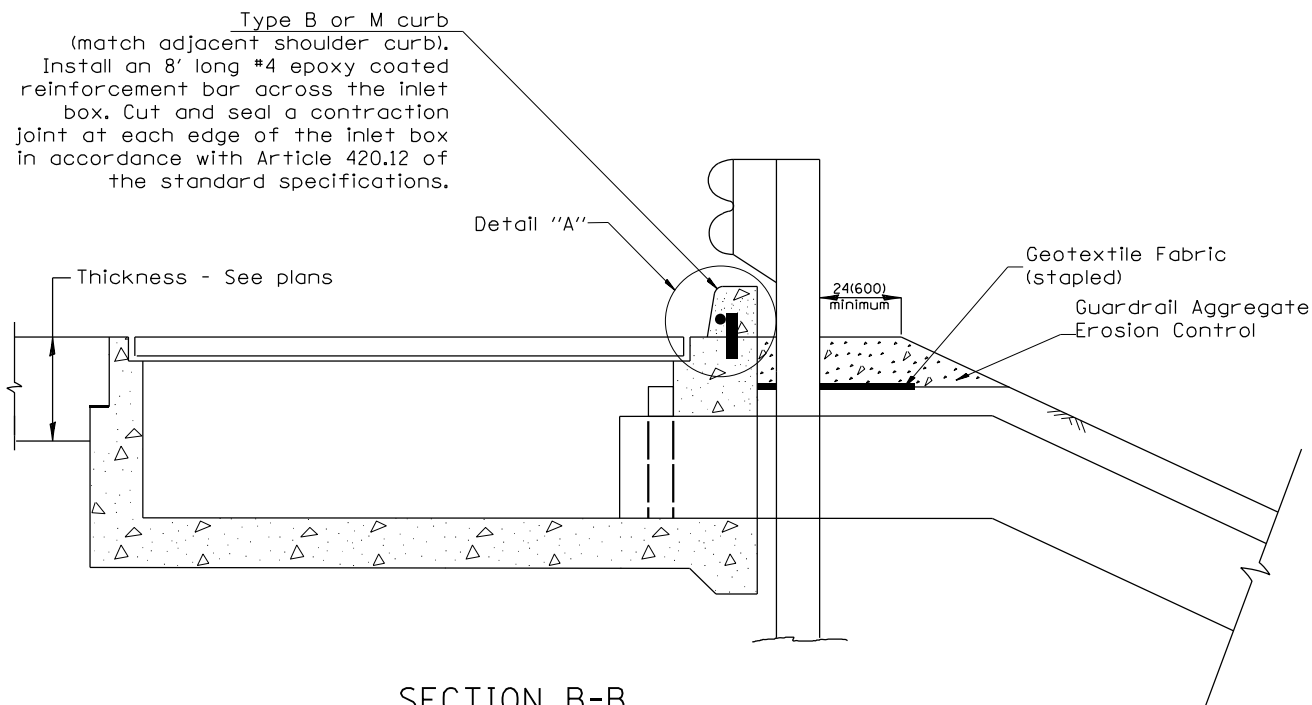

SECTION B-B
TYPICAL SECTION AT INLETS
TYPE E, F & G (HIGHWAY STANDARD 610001)

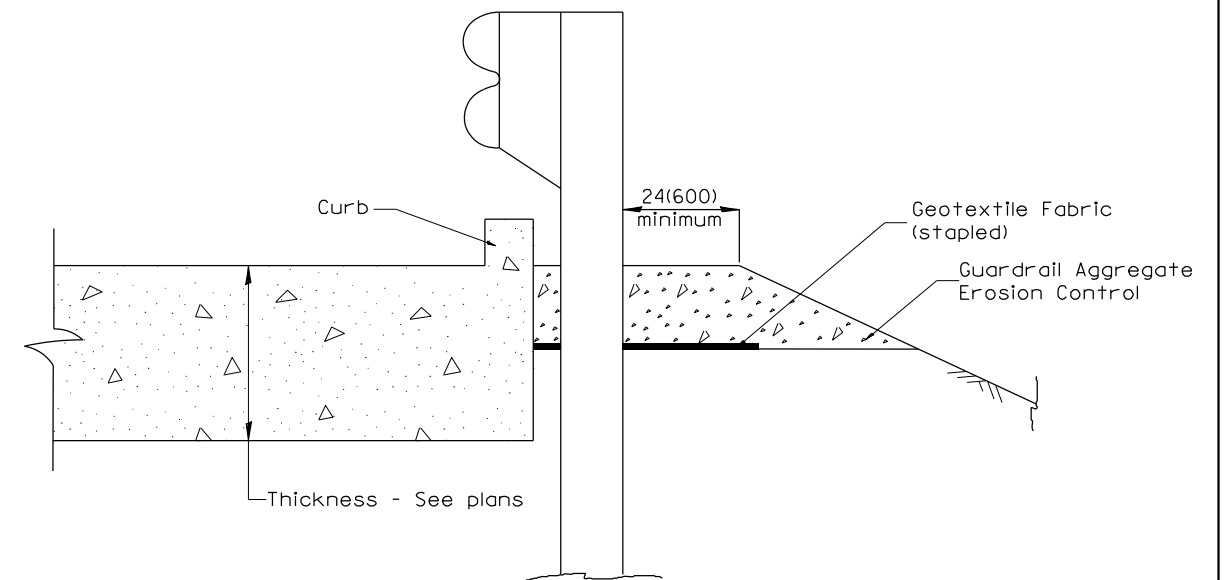

SECTION A-A
TYPICAL SECTION WITH BRIDGE APPROACH CURB

All dimensions are in inches (millimeters) unless otherwise noted.

STATE OF ILLINOIS				GUARDRAIL EROSION CONTROL TREATMENTS				SHT. 2 OF 2	
DEPARTMENT OF TRANSPORTATION				NOT TO SCALE				CADD STD. 630101-D4	
F.A.S RTE.	SECTION	COUNTY	TOTAL SHEETS	SHEET NO.					
1388	[I-4B-15D]BRJBDOR,SCR	PEORIA	24	22	CONTRACT NO. 68G40				
FED. ROAD DIST. NO.		ILLINOIS FED. AID PROJECT							

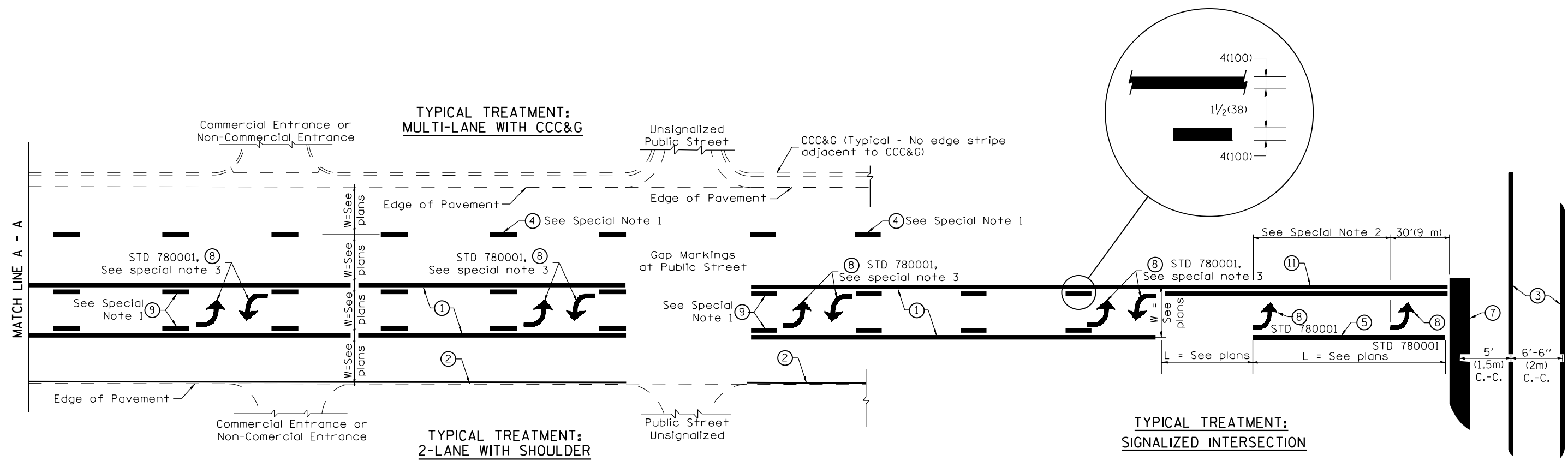

FLUSH PAVED MEDIAN: TWO-WAY LEFT TURN LANE WITH ONE-WAY LEFT TURN LANE AT SIGNALIZED INTERSECTION

TYPICAL PAVEMENT MARKING LEGEND
 (Note: This is a District Standard Legend. Some elements may not apply to specific project.)

- ① 4(100) Solid (Yellow)
- ② 4(100) Solid (White)
- ③ 2-6(150) Crosswalk @ 6'-6" (2m)min C.-C. (White)
2-8(200) Crosswalk @ 6'-6" (2m)min C.-C. (White) (When traffic signals are present.)
- ④ 6(150) Skip-Dash (White) (See Special Note 1)
- ⑤ 8(200) Solid (White)
- ⑥ 12(300) Diagonal (White) (Item ⑥ is shown on Std. 780001)
- ⑦ 24(600) Stop Bar (White)
- ⑧ Letters & Arrows (See Std. 780001 and Special Notes 2 & 3)
- ⑨ 4(100) Skip-Dash (Yellow) (See Special Note 1)
- ⑩ 12(300) Diagonal (Yellow) (See Table A) ⑩
- ⑪ 4(100) Double Solid (Yellow) ⑪

SPECIAL NOTES

1. Skip-Dash markings will be centered between both ends of city blocks and shall be placed in alignment transversely across the pavement.
2. The following shall apply to arrows located in one-way left turn lanes:
 - A. A minimum of two (2) arrows is required.
 - B. The maximum spacing between arrows is 80' (24 m).
 - C. Arrows shall be evenly spaced if three (3) or more are required.
3. The following shall apply to arrow pairs located in two-way left turn lanes:
 - A. A minimum of two (2) arrow pairs is required.
 - B. The maximum spacing between arrow pairs is 200' (61 m).
 - C. Arrow pairs shall be evenly spaced if three (3) or more are required.
 - D. The spacing between Bi Directional Left Turn Arrows is 33' (10 m).

GENERAL NOTES

1. Refer to State Standard 780001 for additional Pavement Markings including letters & arrows.
2. See Plans for Pavement Markings adjacent to curbed islands and medians, and through lane reductions.
3. Refer to Article 780.13 for letter, number and symbol areas (sq. ft.)
4. Areas are grooved 1" beyond each edge for the following symbols:
 Through Arrow= 14.8 sq. ft.
 Large Left or Right Arrow= 21.9 sq. ft.
 2 Arrow Combination Left (or Right) and Through= 34.9 sq. ft.
 Wrong Way Arrow= 29.5 sq. ft.
 Railroad Crossing Symbol= 69.8 sq. ft.
 (For further information, refer to BDE Special Provision: Grooving for Recessed Pavement Markings)

01-01-97	RENUM. F-8.03, NEW REVISION BOX	J.P.	10-16-06	REVISED TO 2007 SPEC.	
02-07-97	ADD BI DIRECTIONAL DIMENSION	J.A.	2/29/16	ADDED GROOVING AREAS	R.D.
10-97	CORRECT BI DIRECTIONAL DIMENSION	J.A.	07-16-19	SPELLING CORRECTIONS	R.D.
08-02	ADD CROSSWALK DIMS. WITH T.S.	M.A.			

**STATE OF ILLINOIS
DEPARTMENT OF TRANSPORTATION**

TYPICAL PAVEMENT MARKINGS

NOT TO SCALE

SHI. 1 OF 2
CADD STD. 780001-04

F.A.S. RTE.	SECTION	COUNTY	TOTAL SHEETS	SHEET NO.
1388	[Z-4B-15D]BRJBDOR,SCR	PEORIA	24	23
CONTRACT NO. 68G40			FED. ROAD DIST. NO. [ILLINOIS] FED. AID PROJECT	

