

F.A. RTE.	SECTION	COUNTY	TOTAL SHEETS	SHEET NO.
VAR.	D5 SWZT 2023-1	VARIOUS	4	1
		ILLINOIS	CONTRACT NO. 70G44	

03-10-2023 LETTING ITEM 045

STATE OF ILLINOIS
DEPARTMENT OF TRANSPORTATION

FOR INDEX OF SHEETS, SEE SHEET NO. 2
FOR SUMMARY OF QUANTITIES, SEE SHEET NO. 3

PROPOSED HIGHWAY PLANS

VARIOUS ROUTES
SECTION D5 SWZT 2023-1
MISC TRAFFIC CONTROL
PROJECT: HSIP-TVN1(098)
VARIOUS COUNTIES

C-95-039-23

DISTRICTWIDE SMART WORK ZONE TECHNOLOGY

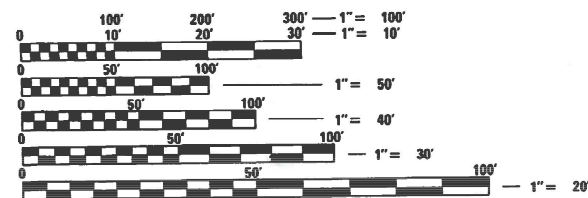
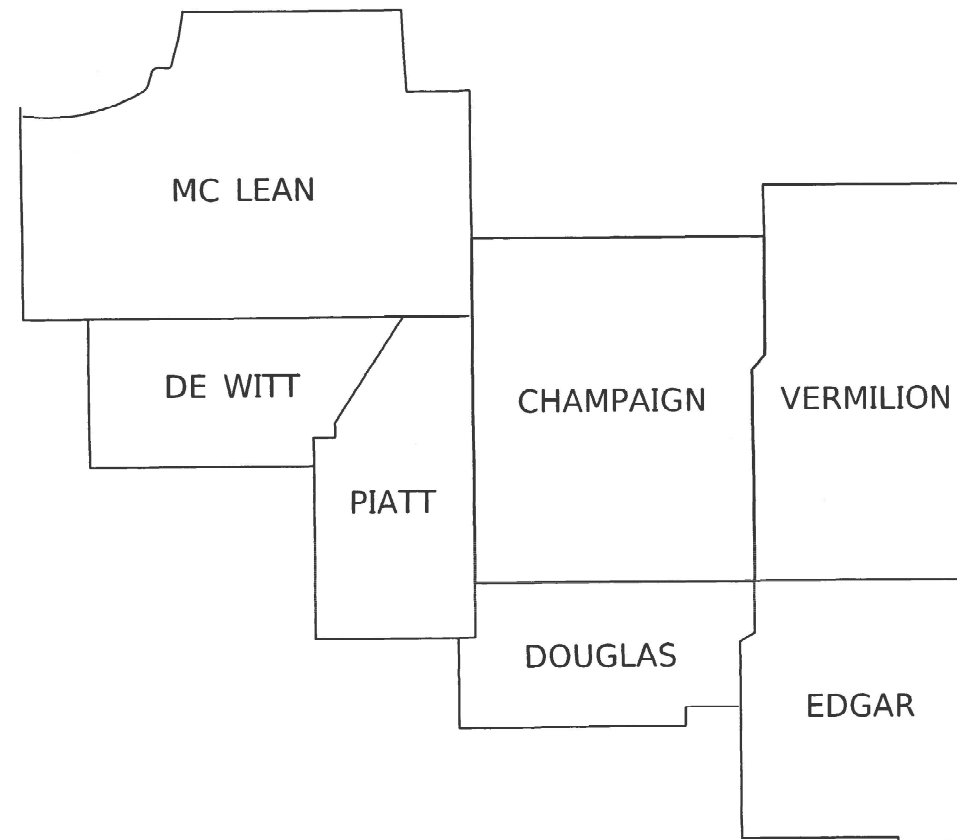
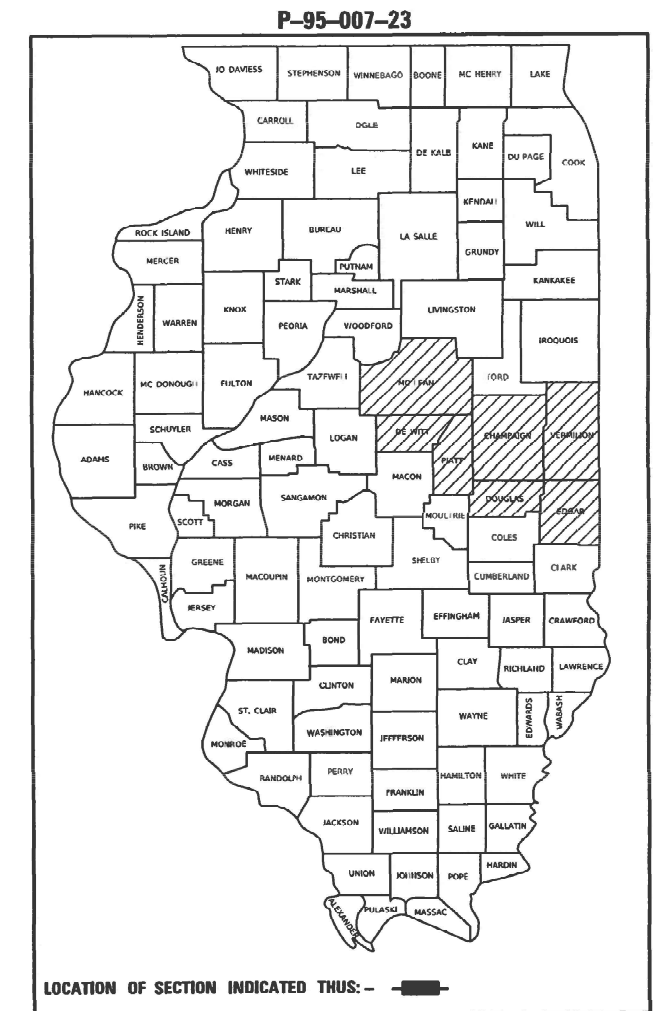

FULL SIZE PLANS HAVE BEEN PREPARED USING STANDARD ENGINEERING SCALES. REDUCED SIZED PLANS WILL NOT CONFORM TO STANDARD SCALES. IN MAKING MEASUREMENTS ON REDUCED PLANS, THE ABOVE SCALES MAY BE USED.

J.U.L.I.E.
JOINT UTILITY LOCATION INFORMATION FOR EXCAVATORS
1-800-892-0123
OR 811

PROJECT ENGINEER: JASON W. STULTS, P.E.
DESIGNER: MATTHEW W. MURPHY
PHONE: 217-465-4181
CONTRACT NO. 70G44

STATE OF ILLINOIS
DEPARTMENT OF TRANSPORTATION

SUBMITTED 12/13 2022
Kensil A. Barnett swm
REGIONAL ENGINEER

February 3, 2023
Steph A. Etk
ENGINEER OF DESIGN AND ENVIRONMENT

February 3, 2023
Stephen M. Smith
DIRECTOR OF HIGHWAYS PROJECT IMPLEMENTATION

PRINTED BY THE AUTHORITY
OF THE STATE OF ILLINOIS

INDEX OF SHEETS

<u>DESCRIPTION</u>	<u>SHEET NO.</u>
COVER	1
INDEX OF SHEETS, LIST OF HIGHWAY STANDARDS, COMMITMENTS	2
SUMMARY OF QUANTITIES	3
REAL-TIME TRAFFIC CONTROL SYSTEM	4

GENERAL NOTES

THERE ARE NO GENERAL NOTES FOR THIS CONTRACT

LIST OF STANDARDS

<u>STANDARD NO.</u>	
000001-08	STANDARD SYMBOLS, ABBREVIATIONS AND PATTERNS
001006	DECIMAL OF AN INCH AND OF A FOOT
701101-05	OFF-ROAD OPERATIONS, MULTILANE, 15' (4.5 M) TO 24" (600 MM) FROM PAVEMENT
701106-02	OFF-ROAD OPERATIONS, MULTILANE, MORE THAN 15' (4.5 M) AWAY
701400-11	APPROACH TO LANE CLOSURE, FREEWAY/EXPRESSWAY
701428-01	TRAFFIC CONTROL, SETUP AND REMOVAL, FREEWAY/EXPRESSWAY
701901-08	TRAFFIC CONTROL DEVICES

COMMITMENTS

THERE ARE NO COMMITMENTS FOR THIS CONTRACT

MODEL: I:\MODEL\MHMF
 FILE: MHMF_Plan\IUCR\Plan\beadefy.com\FW\DOT\Documents\DOT\Office\Dir\dr. S\Project\0570G44\UCR\Plan\CAD\Sheet\0570G44-1h-GenNotes.dgn

USER NAME = Jason.Goble	DESIGNED - MWM	REVISED -
	DRAWN - JRG	REVISED -
PLOT SCALE = 40,0000 * / in.	CHECKED -	REVISED -
PLOT DATE = 12/7/2022	DATE -	REVISED -

**STATE OF ILLINOIS
DEPARTMENT OF TRANSPORTATION**

**INDEX OF SHEETS, LIST OF STANDARDS,
GENERAL NOTES, AND COMMITMENTS**

SCALE: SHEET 1 OF 1 SHEETS STA. TO STA.

F.A. RTE.	SECTION	COUNTY	TOTAL SHEETS	SHEET NO.
VAR	D5 SWZT 2023-1	VARIOUS	4	2
			CONTRACT NO. 70G44	
			ILLINOIS FED. AID PROJECT	

SUMMARY OF QUANTITIES

LOCATION OF WORK: VARIOUS , DISTRICT-WIDE

FUNDING BREAKOUT: 90% FEDERAL / 10% STATE

CONSTRUCTION TYPE CODE: 0021

ITEM NO.	DESCRIPTION	UNIT	QUANTITY	TOTAL QUANTITY
X0327640	REAL - TIME TRAFFIC CONTROL CENTRAL BASE UNIT	CAL MO	7.00	7.00
X0328005	REAL - TIME TRAFFIC MONITORING SENSOR UNIT	CAL MO	75.00	75.00
X0328006	REAL - TIME TRAFFIC CONTROL WARNING SIGN	CAL MO	20.00	20.00
Z0008759	CALL OUT	EACH	7.00	7.00
Z0008760	EMERGENCY WORK CALL OUT	EACH	2.00	2.00
Z0013798	CONSTRUCTION LAYOUT	L SUM	1.00	1.00
* DENOTES SPECIALTY ITEMS				

MODEL: I:\MODEL\MMFE
 FILE: MMFE_Plan\IUSC-Pax-beadby.com\FW\DOT\Documents\DOT Office\Dir\dir: S:\Project\0570G44\CAD\DATA\CAD\Sheet\0570G44-11-S00.dgn

USER NAME = Jason.Goble	DESIGNED - MWM	REVISED -
	DRAWN - JRG	REVISED -
PLOT SCALE = 40,0000 * / in.	CHECKED -	REVISED -
PLOT DATE = 12/13/2022	DATE -	REVISED -

**STATE OF ILLINOIS
DEPARTMENT OF TRANSPORTATION**

SUMMARY OF QUANTITIES

SCALE: SHEET 1 OF 1 SHEETS STA. TO STA.

F.A. RTE.	SECTION	COUNTY	TOTAL SHEETS	SHEET NO.
VAR	D5 SWZT 2023-1	VARIOUS	4	3
			CONTRACT NO. 70G44	
		ILLINOIS FED. AID PROJECT		

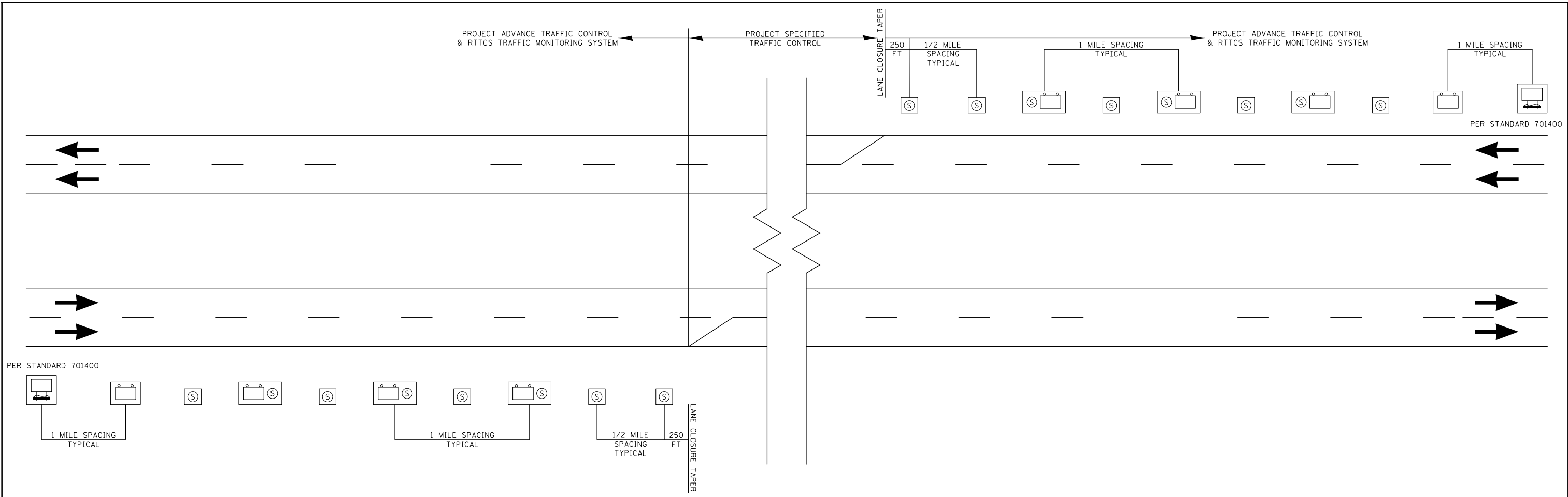

LEGEND

REAL-TIME TRAFFIC CONTROL WARNING SIGN
PROJECT SIGN SHALL BE A 48" X 96" (1200MM X 2400MM)
SIGN THAT SAYS
"STOPPED TRAFFIC NEXT MILE WHEN FLASHING".

SINGLE PORTABLE CHANGEABLE MESSAGE SIGN PLACED 1 MILE
IN ADVANCE OF THE REAL-TIME TRAFFIC CONTROL WARNING SIGN.
IT SHALL READ: "RIGHT/LEFT LANE CLOSED // X MILES AHEAD"
THIS PORTABLE CHANGEABLE MESSAGE SIGN IS INCLUDED IN STANDARD 701400

REAL-TIME TRAFFIC MONITORING SENSOR UNIT

NOTE:

1. THE NUMBER OF REAL-TIME TRAFFIC CONTROL WARNINGS SIGNS MAY BE CHANGED AS DIRECTED BY THE ENGINEER. RELOCATION OF REAL-TIME TRAFFIC CONTROL STATIC WARNING SIGNS IS INCLUDED IN THE REAL-TIME TRAFFIC CONTROL PAY ITEMS.
2. REAL-TIME TRAFFIC CONTROL MONITORING SENSOR UNITS SPACED APPROXIMATELY EVERY 1/2 MILE AND REAL-TIME TRAFFIC CONTROL WARNING SIGNS SPACED EVERY 1 MILE OR AS DIRECTED BY THE ENGINEER.
3. THE FIRST REAL-TIME TRAFFIC MONITORING SENSORS UNIT IS TO BE PLACED 250 FOOT UPSTREAM OF THE TAPER.
4. THE SECOND REAL-TIME SPEED TRAFFIC MONITORING SENSOR UNIT IS TO BE PLACED 250 FOOT IN ADVANCE OF THE RIGHT LANE/LEFT LANE CLOSED 1/2 MILE SIGN (STD. 701400).
5. THE FIRST REAL-TIME TRAFFIC CONTROL WARNINGS SIGN SHOULD BE PLACED 500 FOOT IN ADVANCE OF THE RIGHT/LEFT LANE CLOSED 1 MILE SIGN (STD. 701400)
6. THE NUMBER OF RTTCS DEVICES MAY BE REDUCED BASED ON THE LOCATION OF THE PORTABLE CHANGEABLE MESSAGE SIGN PER (STD. 701400) AS DIRECTED BY THE ENGINEER.

**STOPPED TRAFFIC
NEXT MILE
WHEN FLASHING**

MODEL: I:\MODELS\MRFS
 FILE NAME: P:\Public\paw_benefy.com\PIV\DOT\Documents\DOT_Offices\Dir\ref: S:\Project\0570G44\CAD\Drawings\CAD\References\0570G44-rt-ctrl.kgm

USER NAME = Jason.Goble	DESIGNED - MWM	REVISED -
	DRAWN - JRG	REVISED -
PLOT SCALE = 100,0000' / in.	CHECKED -	REVISED -
PLOT DATE = 12/7/2022	DATE -	REVISED -

**STATE OF ILLINOIS
DEPARTMENT OF TRANSPORTATION**

REAL-TIME TRAFFIC CONTROL SYSTEM			
SCALE: NTS	SHEET 1	OF 1 SHEETS	STA. TO STA.

F.A. RTE.	SECTION	COUNTY	TOTAL SHEETS	SHEET NO.
VAR	D5 SWZT 2023-1	VARIOUS	4	4
			CONTRACT NO. 70G44	
ILLINOIS FED. AID PROJECT				