

FAI RTE.	SECTION	COUNTY	TOTAL SHEET SHEETS NO.
90	1314B	COOK	160 28
FED. ROAD DIST. NO.	ILLINOIS FED. AID PROJECT		CONTRACT 60293

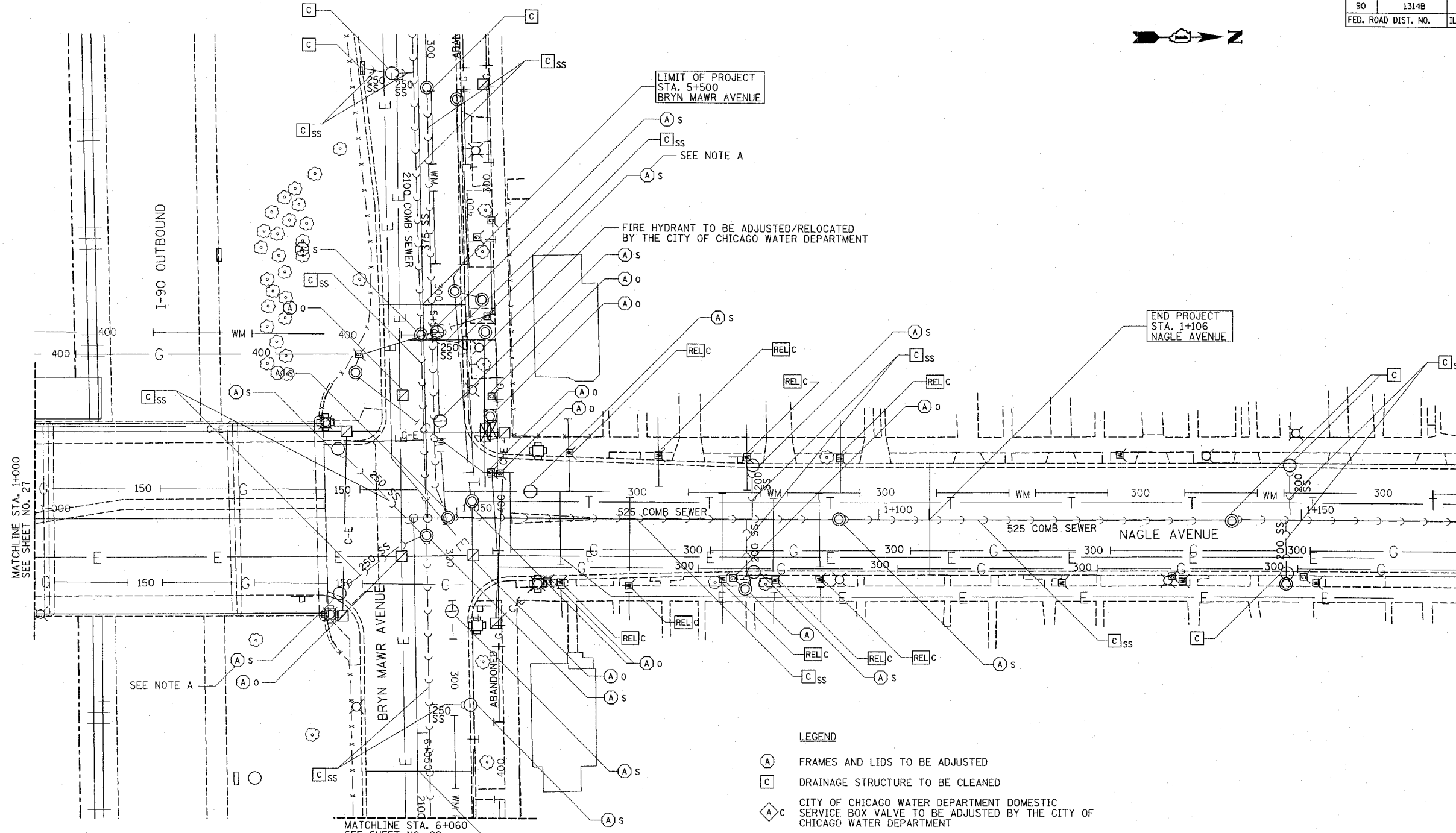

LIMIT OF PROJECT
STA. 5+500
BRYN MAWR AVENUE

END PROJECT
STA. 1+106
NAGLE AVENUE

MATCHLINE STA. 6+060
SEE SHEET NO. 29

MATCHLINE STA. 1+000
SEE SHEET NO. 27

LEGEND

- (A) FRAMES AND LIDS TO BE ADJUSTED
- (C) DRAINAGE STRUCTURE TO BE CLEANED
- (A) c CITY OF CHICAGO WATER DEPARTMENT DOMESTIC SERVICE BOX VALVE TO BE ADJUSTED BY THE CITY OF CHICAGO WATER DEPARTMENT
- (REL) c CITY OF CHICAGO WATER DEPARTMENT ITEM TO BE RELOCATED BY THE CITY OF CHICAGO WATER DEPARTMENT
- (A) o UTILITY STRUCTURES TO BE ADJUSTED BY OTHERS
- (A) s FRAMES AND LIDS TO BE ADJUSTED (SPECIAL)
- (C) ss STORM SEWER TO BE CLEANED

NOTE A:
EXISTING FRAME AND GRATE SHALL BE REMOVED AS PART OF THE WORK OF FRAMES AND LIDS TO BE ADJUSTED SPECIAL. NEW CITY OF CHICAGO TYPE 1 F&G TO BE INSTALLED AND ADJUSTED ACCORDINGLY. THE REMOVAL OF THE FRAME AND GRATE WILL BE INCLUDED IN THE COST OF FRAMES AND LIDS TO BE ADJUSTED (SPECIAL).

NOTE:
FOR NOTES SEE SHEET NO 27.

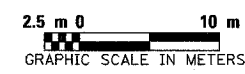

COLLINS ENGINEERS
123 N. WACKER DR., SUITE 300
CHICAGO, IL 60606
(312) 704-9300
ILLINOIS PROFESSIONAL DESIGN FIRM
LICENSE NO. 184-000993

REVISIONS	
NAME	DATE

ILLINOIS DEPARTMENT OF TRANSPORTATION

EXISTING DRAINAGE AND UTILITIES PLAN
NAGLE AVENUE
STA. 1+000 TO STA. 1+170

DATE: DECEMBER 2004
DRAWN BY: ML, DR, FD
CHECKED BY: JMH, MDK