



FBI RTE.	SECTION	COUNTY	TOTAL SHEETS	SHEET NO.
90	1314B	COOK	160	30
FED. ROAD DIST. NO.	ILLINOIS FED. AID PROJECT		CONTRACT 60293	

LEGEND:

-  BITUMINOUS REMOVAL OVER PATCHES, CLASS C PATCHES, TYPE II, 225 AND BITUMINOUS REPLACEMENT OVER PATCHES
-  DRAINAGE STRUCTURE NUMBER. REFER TO DRAINAGE STRUCTURE SCHEDULE FOR ADDITIONAL INFORMATION.

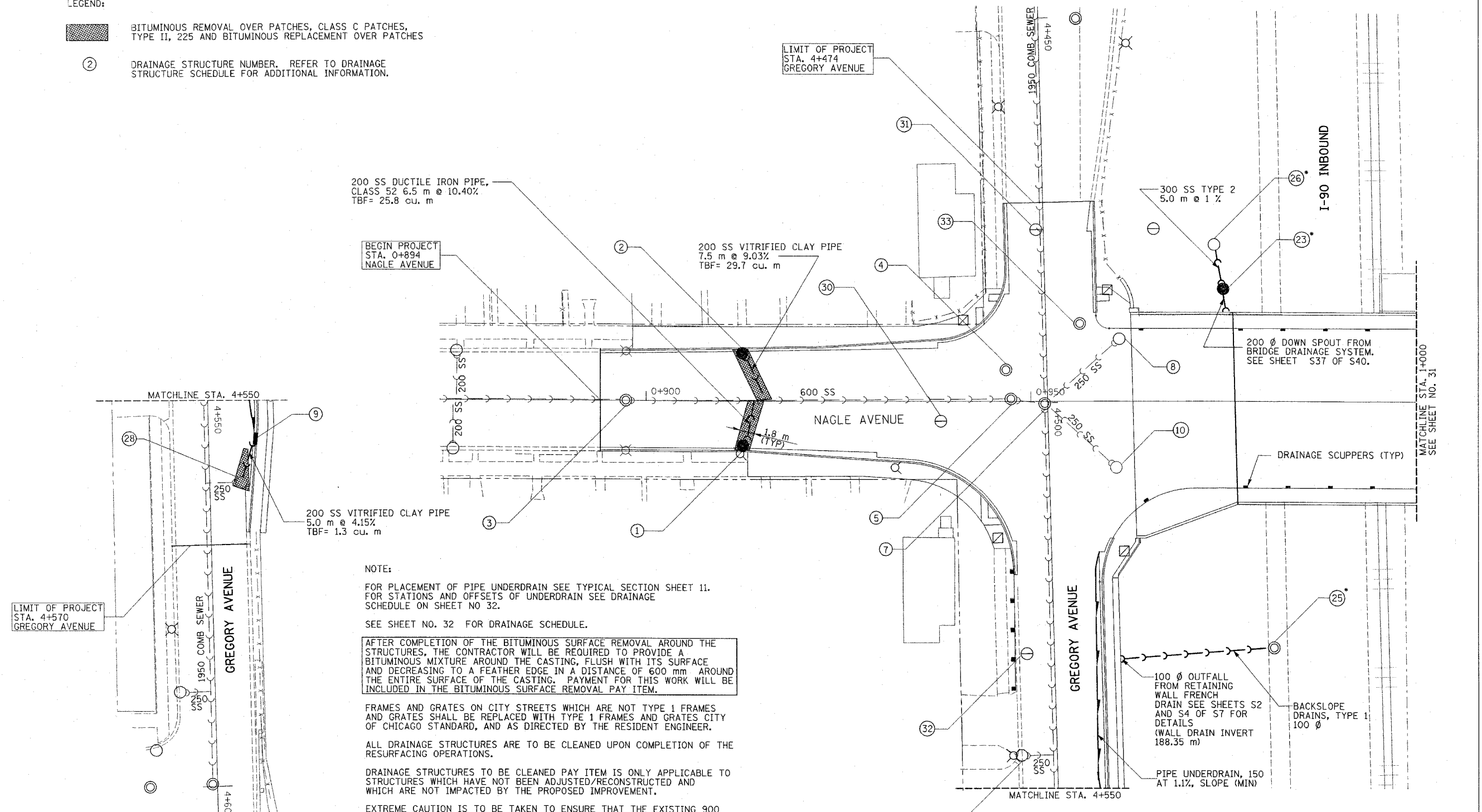

NOTE:  
 FOR PLACEMENT OF PIPE UNDERDRAIN SEE TYPICAL SECTION SHEET 11.  
 FOR STATIONS AND OFFSETS OF UNDERDRAIN SEE DRAINAGE SCHEDULE ON SHEET NO 32.  
 SEE SHEET NO. 32 FOR DRAINAGE SCHEDULE.

AFTER COMPLETION OF THE BITUMINOUS SURFACE REMOVAL AROUND THE STRUCTURES, THE CONTRACTOR WILL BE REQUIRED TO PROVIDE A BITUMINOUS MIXTURE AROUND THE CASTING, FLUSH WITH ITS SURFACE AND DECREASING TO A FEATHER EDGE IN A DISTANCE OF 600 mm AROUND THE ENTIRE SURFACE OF THE CASTING. PAYMENT FOR THIS WORK WILL BE INCLUDED IN THE BITUMINOUS SURFACE REMOVAL PAY ITEM.

FRAMES AND GRATES ON CITY STREETS WHICH ARE NOT TYPE 1 FRAMES AND GRATES SHALL BE REPLACED WITH TYPE 1 FRAMES AND GRATES CITY OF CHICAGO STANDARD, AND AS DIRECTED BY THE RESIDENT ENGINEER.

ALL DRAINAGE STRUCTURES ARE TO BE CLEANED UPON COMPLETION OF THE RESURFACING OPERATIONS.

DRAINAGE STRUCTURES TO BE CLEANED PAY ITEM IS ONLY APPLICABLE TO STRUCTURES WHICH HAVE NOT BEEN ADJUSTED/RECONSTRUCTED AND WHICH ARE NOT IMPACTED BY THE PROPOSED IMPROVEMENT.

EXTREME CAUTION IS TO BE TAKEN TO ENSURE THAT THE EXISTING 900 WATERMAIN AT THE INTERSECTION OF NAGLE AVENUE AND GREGORY AVENUE AND OTHER EXISTING WATER FACILITIES WITHIN THE LIMITS OF THIS PROJECT ARE NOT DAMAGED DURING CONSTRUCTION. IF ANY DAMAGE OCCURS TO CITY WATER FACILITIES, THE CONTRACTOR WILL BE HELD RESPONSIBLE FOR THE COST OF REPAIRING OR REPLACING THEM.

\* STRUCTURE IS LOCATED ALONG SHOULDER OF I-90.

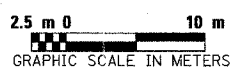

**COLLINS ENGINEERS**  
 123 N. WACKER DR., SUITE 300  
 CHICAGO, IL 60606  
 (312) 704-9300  
 ILLINOIS PROFESSIONAL DESIGN FIRM  
 LICENSE NO. 184-006993

REVISIONS	
NAME	DATE

ILLINOIS DEPARTMENT OF TRANSPORTATION  
 PROPOSED DRAINAGE AND UTILITIES PLAN  
 NAGLE AVENUE  
 STA. 0+875 TO STA. 1+000  
 DATE: DECEMBER 2004  
 DRAWN BY: ML, DR, FD  
 CHECKED BY: JMH, MDK

FILE: G:\2724\CIVIL\EXHIBIT\NAGLE\2724029.dgn