

FAI RTE.	SECTION	COUNTY	TOTAL SHEETS	SHEET NO.
90	1314B	COOK	160	65
FED. ROAD DIST. NO.	ILLINOIS FED. AID PROJECT			

EXISTING LIGHTING SYSTEM

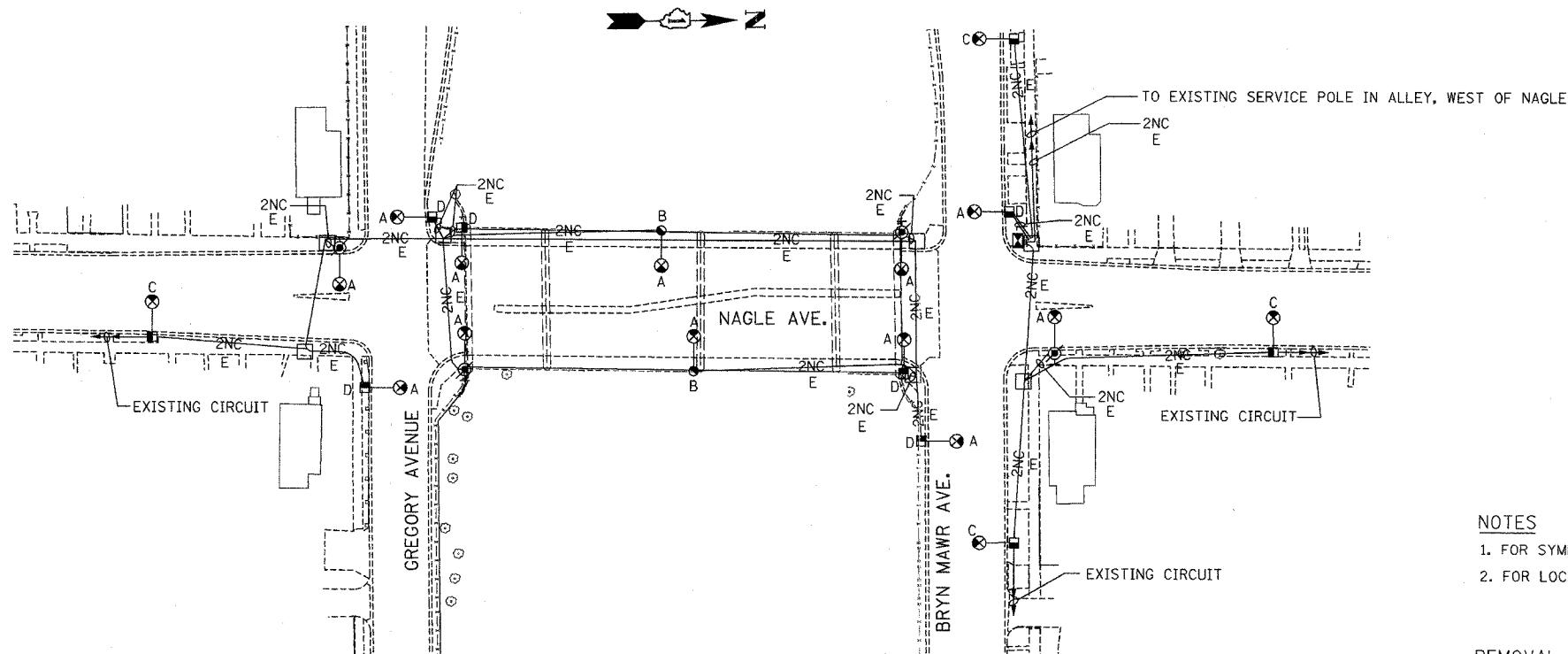

NOTES

1. FOR SYMBOLS, GENERAL NOTES AND LEGEND SEE SHEET E-01.
2. FOR LOCATION, QUANTITY AND TYPE REFER TO TRAFFIC SIGNAL PLANS.

REMOVAL NOTES

- A - REMOVE H.P.S.V. LUMINAIRE AND MAST ARM
- B - REMOVE POLE, CITY STEEL, ANCHOR BASE, 9.9 m, MOUNTED ON EXISTING PARAPET
- C - EXISTING POLE TO REMAIN
- D - EXISTING POLE TO BE REMOVED
- E - EXISTING CABLE AND CONDUIT TO BE REMOVED

INSTALLATION NOTES

- F - INSTALL 400W H.P.S.V. LUMINAIRE AND 3.66 m MAST ARM
- G - INSTALL POLE, CITY STEEL, ANCHOR BASE, SIZE AS INDICATED

PROPOSED LIGHTING SYSTEM

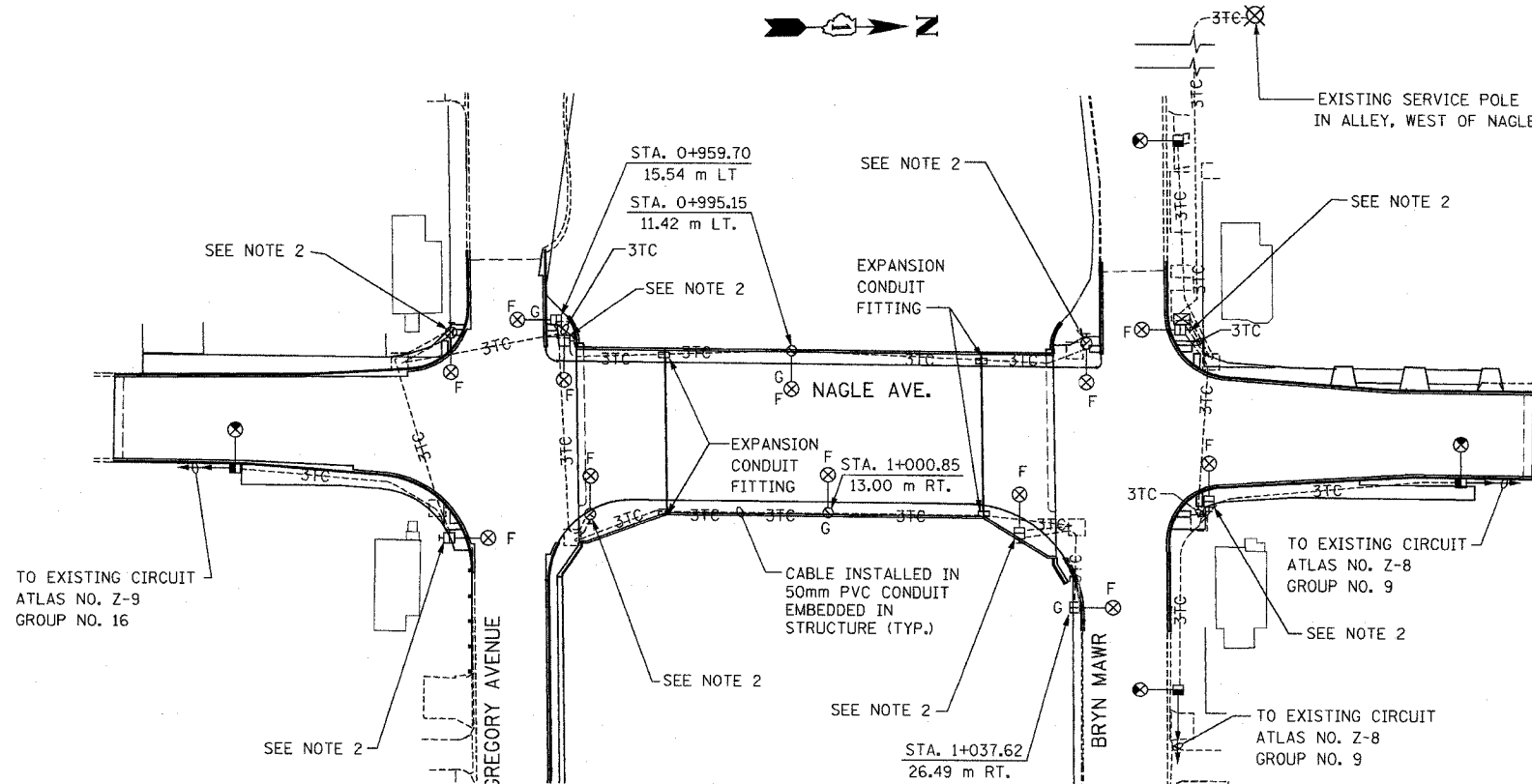

REVISIONS		ILLINOIS DEPARTMENT OF TRANSPORTATION
NAME	DATE	
		NAGLE AVE. OVER FAI-90 (KENNEDY EXPY) CITY OF CHICAGO LIGHTING PLAN

**K&E** KAM ENGINEERING, INC.  
 CONSULTING ENGINEERS  
 707A Davis Road, Suite 205  
 Elgin, Illinois 60123-1369

SCALE: 1:500  
 DATE: DEC 2004  
 DRAWN BY: CBR  
 CHECKED BY: SM