

| | | | | |
|-----------------------|----------|------------------|--------------|-----------|
| F. A. NO. | SECTION | COUNTY | TOTAL SHEETS | SHEET NO. |
| | | | 160 | 142 |
| STA. | TO STA. | | | |
| FED. ROAD DIST. NO. 1 | ILLINOIS | FED. AID PROJECT | | |

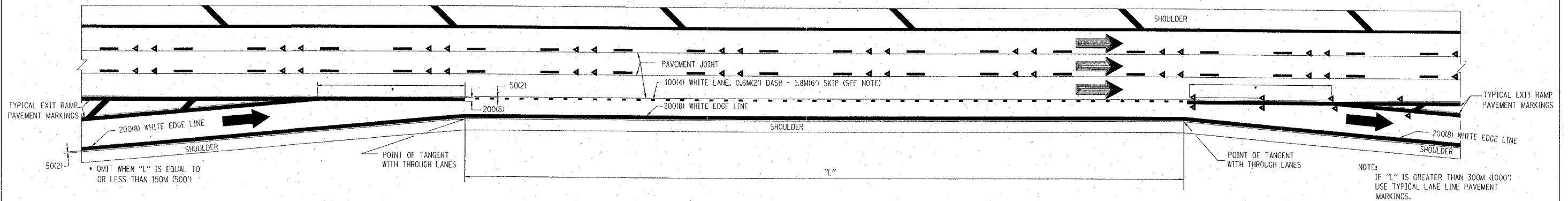

TYPICAL ENTRANCE/EXIT RAMP COMBINATION PAVEMENT MARKINGS

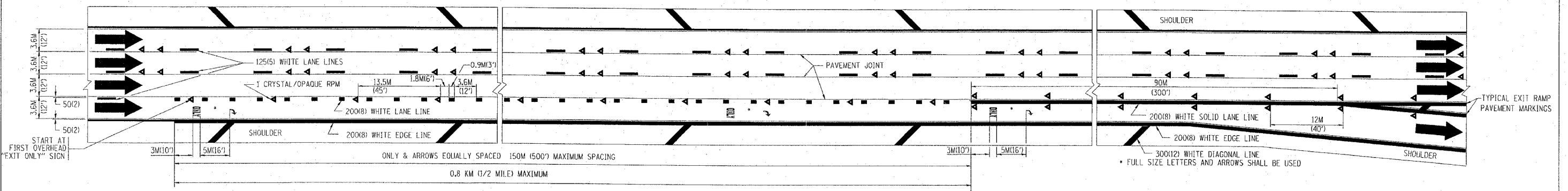

TYPICAL EXIT ONLY LANE PAVEMENT MARKINGS

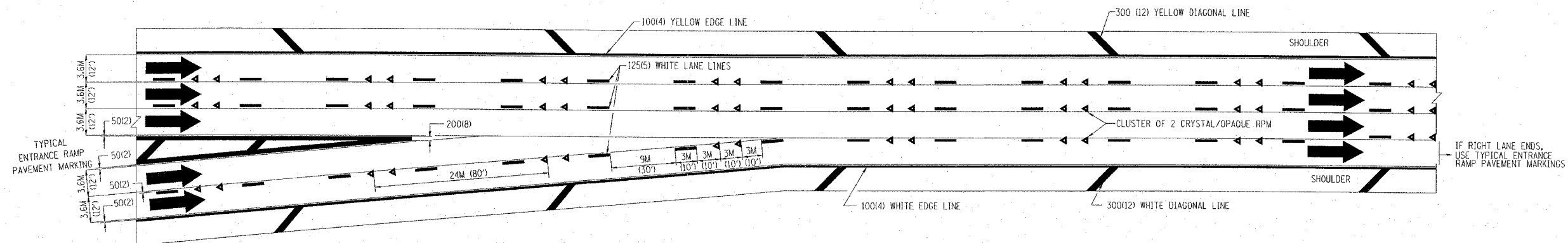

TYPICAL TWO LANE ENTRANCE RAMP PAVEMENT MARKINGS

| REVISIONS | |
|-----------|------|
| NAME | DATE |
| DWS | 1/90 |
| DWS | 5/91 |
| | |
| | |
| | |
| | |

ILLINOIS DEPARTMENT OF TRANSPORTATION

**MULTI-LANE FREEWAY
PAVEMENT MARKING
DETAILS**

SCALE: NONE
DATE: 10/18/2002

DRAWN BY C.A.D.D.
CHECKED BY
TC12 SHEET 2 OF 2
REVISION DATE: 01/01/96

*DATE-TIME
*DGN-SPEC
*VINTG2