

**STAGE 2A & 2B**  
(STA. 8+900 TO OLD RAND ROAD)

\* ONE LANE - TWO WAY FLAGGER TRAFFIC OPERATION DURING DAYTIME CONSTRUCTION OPERATIONS  
 \*\* SEE RTE. 22 PROPOSED CROSS SECTIONS FOR LOCATIONS OF TEMPORARY DITCHES

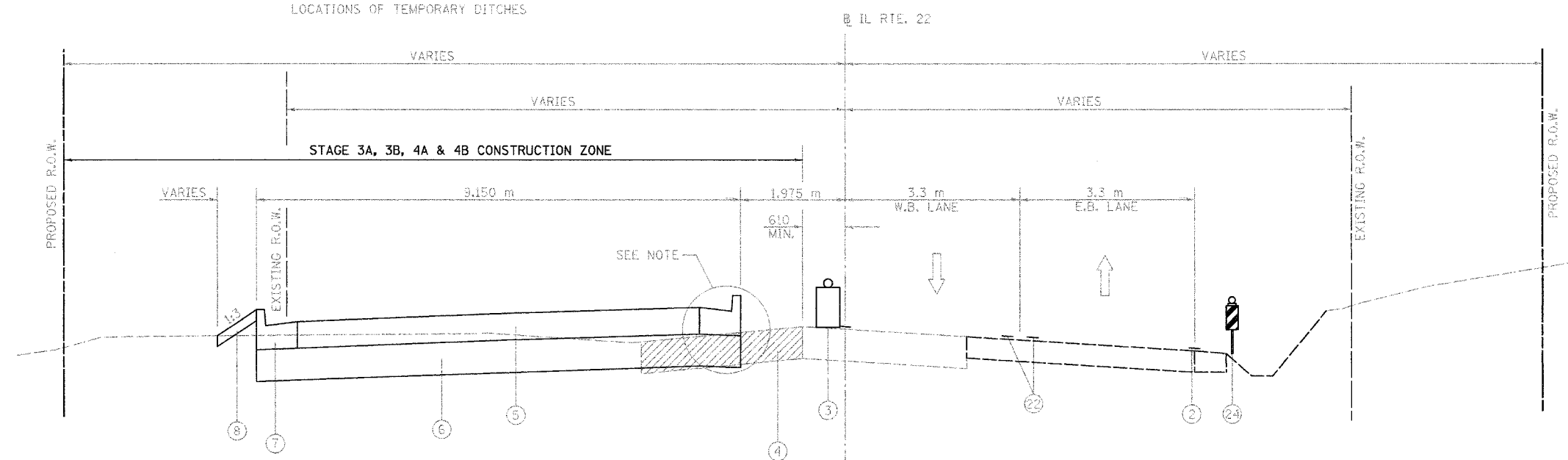

**STAGE 3A, 3B, 4A & 4B**  
(STA. 8+900 TO OLD RAND ROAD)

NOTE:  
 OMIT CURB & GUTTER CONSTRUCTION AT TEMPORARY CROSSOVER ZONES. SEE M.O.T. PLANS.

**LEGEND, TRAFFIC MAINTENANCE**

- |  |  |  |
|--|--|--|
| ① (OPTION 1) PORTLAND CEMENT CONCRETE BASE COURSE 180MM  | ⑧ TOPSOIL, 100 mm                                      | ⑰ BITUMINOUS SHOULDERS SUPERPAVE, 200 mm                                 |
| (OPTION 2) BITUMINOUS BASE COURSE SUPERPAVE, 255MM AND BITUMINOUS CONCRETE SURFACE COURSE, SUPERPAVE, MIX "D",N50 (45MM) | ⑨ SODDING, SALT TOLERANT                               | ⑱ TEMPORARY AGGREGATE SHOULDER   |
| ② TEMPORARY PAVEMENT MARKING, TAPE   | ⑩ CONCRETE MEDIAN SURFACE, 100 mm                      | ⑲ GUARDRAIL TO BE REMOVED  |
| ③ TEMPORARY LIGHTED BARRICADE, DRUM, OR VERTICAL PANEL   | ⑪ STABILIZED SUBBASE, 100 mm                           | ⑳ PORTLAND CEMENT CONCRETE SIDEWALK, 125 mm                              |
| ④ EXISTING PAVEMENT TO BE REMOVED  | ⑫ PORTLAND CEMENT CONCRETE BASE COURSE WIDENING 225 mm | ㉑ TRAFFIC CONTROL BARRIER - SEE MOT PLANS FOR LOCATIONS                  |
| ⑤ PORTLAND CEMENT CONCRETE PAVEMENT 250 mm (JOINTED)   | ⑬ EXISTING CONCRETE CURB AND GUTTER TO BE REMOVED      | ㉒ 100 mm DOUBLE YELLOW TEMPORARY PAVEMENT MARKING TAPE @ 280 mm CC (TYP) |
| ⑥ AGGREGATE SUBGRADE, 300 mm   | ⑭ TEMPORARY PAVEMENT TO BE REMOVED                     | ㉓ EXISTING PAVEMENT MARKINGS   |
| ⑦ COMBINATION CONCRETE CURB AND GUTTER, TYPE B-15.60   |  | ㉔ VERTICAL PANEL POST MOUNTED  |

= REMOVAL

REVISIONS	
NAME	DATE

ILLINOIS DEPARTMENT OF TRANSPORTATION  
 ILLINOIS ROUTE 22  
 FROM US RTE 12 TO BUESCHING RD  
 MAINTENANCE OF TRAFFIC  
 TYPICAL SECTIONS

DATE 7/21/04  
 DRAWN BY BKN  
 CHECKED BY ACW