

F.A. RTE.	SECTION	COUNTY	TOTAL SHEETS	SHEET NO.
337	19R-1	LAKE	800	246J
STA.	TO STA.			
FED. ROAD DIST. NO.	ILLINOIS FED. AID PROJECT			
CONTRACT NO. 60997				

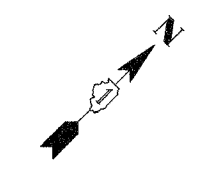

DATE	BY
ORIGINAL SURVEY PLOTTED	
NOTE BOOK TEMPLATE	
AREAS CHECKED	
NO.	

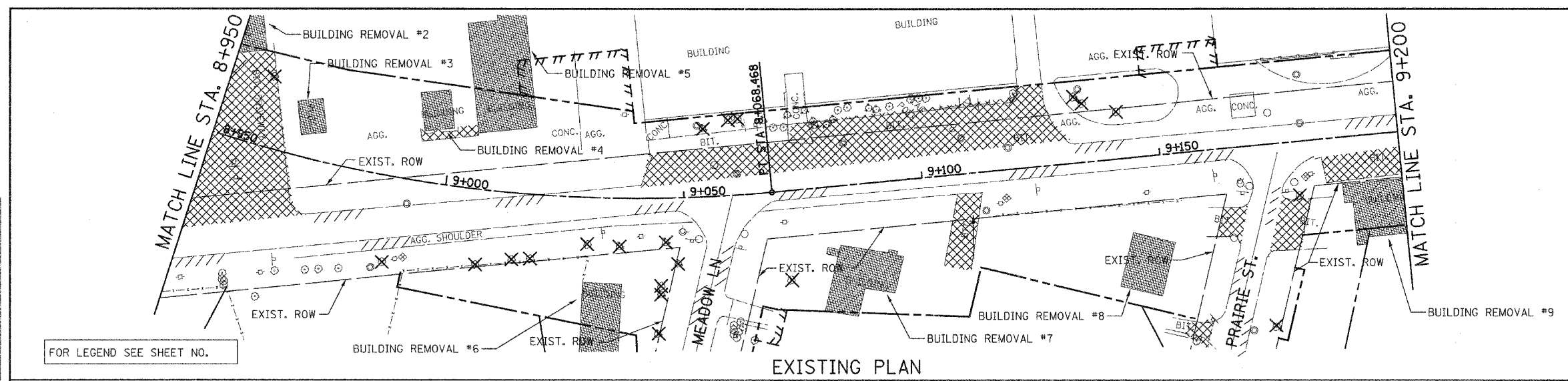

FOR LEGEND SEE SHEET NO.

EXISTING PLAN

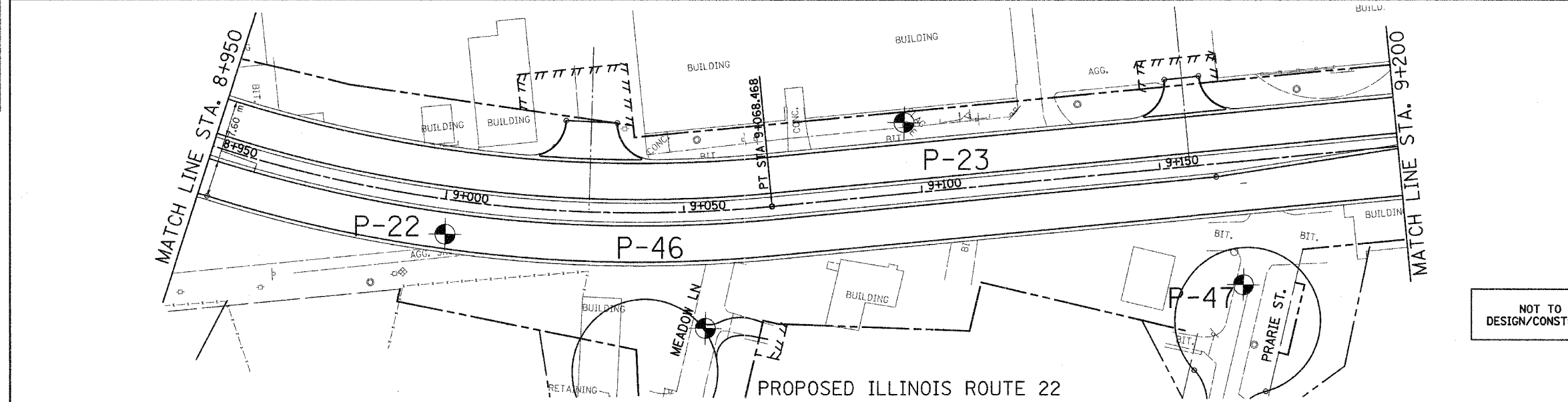

NOT TO BE USED FOR DESIGN/CONSTRUCTION PURPOSES

PROPOSED ILLINOIS ROUTE 22

DATE	BY
ORIGINAL SURVEY PLOTTED	
NOTE BOOK TEMPLATE	
AREAS CHECKED	
NO.	

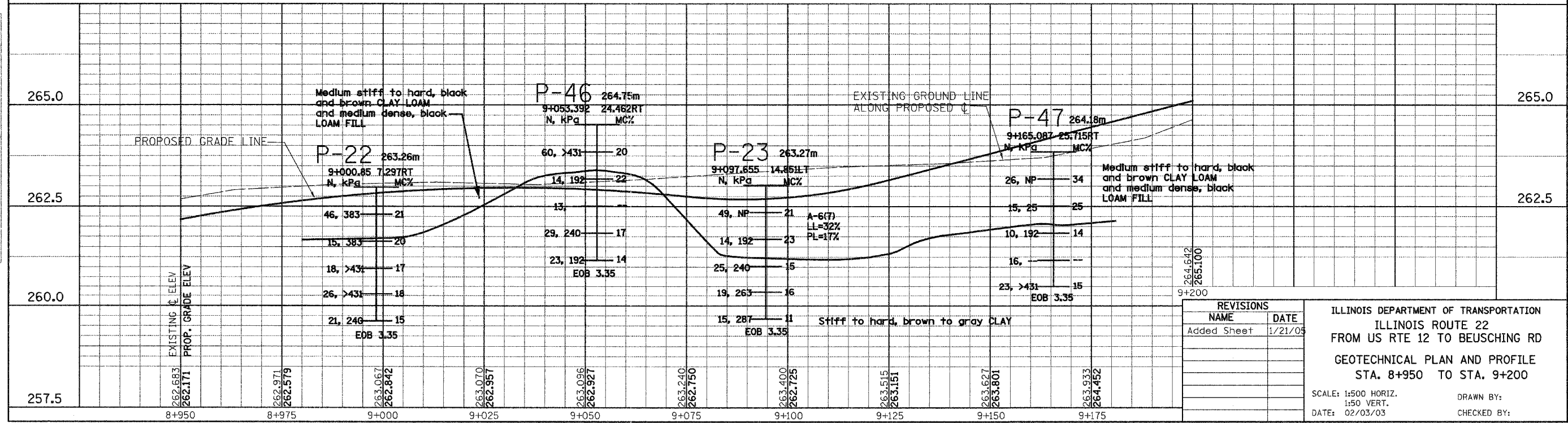

REVISIONS	
NAME	DATE
Added Sheet	1/21/09

ILLINOIS DEPARTMENT OF TRANSPORTATION  
 ILLINOIS ROUTE 22  
 FROM US RTE 12 TO BEUSCHING RD  
 GEOTECHNICAL PLAN AND PROFILE  
 STA. 8+950 TO STA. 9+200

SCALE: 1:500 HORIZ.  
 1:50 VERT.  
 DATE: 02/03/03

DRAWN BY:  
 CHECKED BY: