

F.A. RTE.	SECTION	COUNTY	TOTAL SHEETS	SHEET NO.
337	19R-1	LAKE	800	348
STA.		TO STA.		
FED. ROAD DIST. NO.		ILLINOIS	FED. AID PROJECT	
		60997		

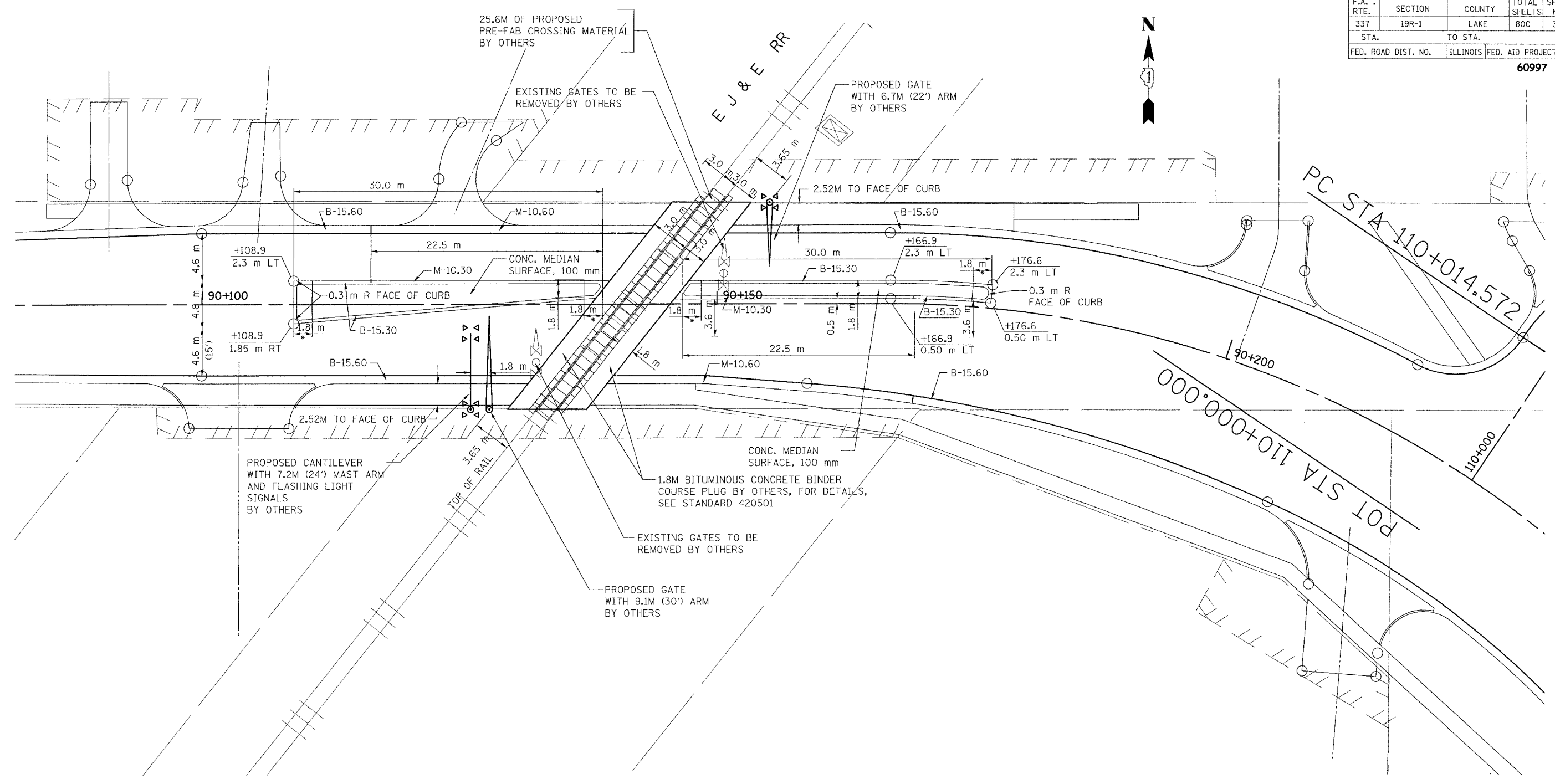

MAIN STREET EAST

* RAMPED NOSE
PAID FOR AS SB-15.30
CONCRETE MEDIAN

REVISIONS	
NAME	DATE

ILLINOIS DEPARTMENT OF TRANSPORTATION
ILLINOIS ROUTE 22
FROM US RTE 12 TO BUESCHING RD
MAIN ST. EAST/ MOHAWK TRAIL RD.
DETAIL PLAN AT INTERSECTION
E J & E R.R. AND MAIN ST. EAST

SCALE: 1:200
DATE: 07/21/04

DRAWN BY SOI
CHECKED BY