

F.A. RTE.	SECTION	COUNTY	TOTAL SHEETS	SHEET NO.
337	19R-1	LAKE	800	367
STA. 10+100		TO STA. 10+200		
FED. ROAD DIST. NO.		ILLINOIS FED. AID PROJECT		

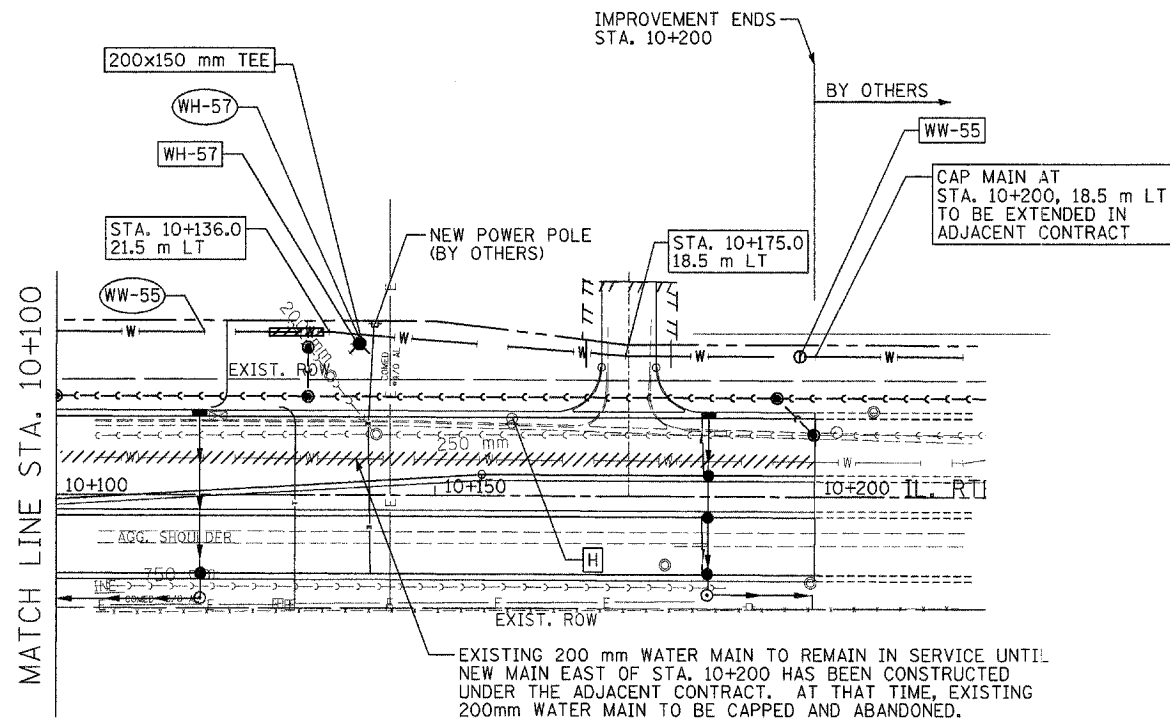
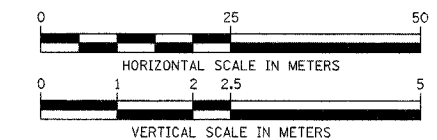

SUGGESTED SEQUENCE OF OPERATIONS
WATER MAIN RELOCATION STA. 9+676.5 TO STA. 10+200

1. INSTALL 300 mm TAPPING VALVE & SLEEVE WW-51 AT STA. 9+676.5
2. CONSTRUCT 300 mm WATER MAIN FROM TAPPING VALVE WW-51 TO WW-53 AT THE EAST PROJECT LIMIT, INCLUDING CROSSING AT 9+965 AND TAPPING VALVES WW-83, WW-57, AND WW-58. CLOSE EXISTING VALVES AS NECESSARY TO INSTALL VALVE WW-54, LEAVE VALVES CLOSED FOLLOWING INSTALLATION.
3. PRESSURE TEST, DISINFECT, AND FLUSH NEW WATER MAIN AS REQUIRED. TRANSFER WATER SERVICES TO NEW 300 mm MAIN EAST OF VALVE WW-51 AND WEST OF VALVE WW-51 TO STA. 9+008 (VALVE WW-81).
4. CLOSE EXISTING 200mm VALVE AT APPROXIMATE STA. 10+020, LT. VALVE TO BE MAINTAINED UNTIL WATER MAIN IS EXTENDED EAST FROM STA. 10+200 IN ADJACENT CONTRACT.
5. CUT, CAP AND ABANDON 300 mm EXISTING WATER MAIN EAST OF TAPPING VALVE WW-51 AT STA. 9+676.5 TO BUESCHING ROAD.
6. CUT, CAP, AND ABANDON EXISTING 150mm WATER SERVICE AT STA 9+925 RT NORTH OF NEW VALVE WW-57.
7. CUT, CAP, AND ABANDON EXISTING 200 mm WATER MAIN AT BUESCHING ROAD FROM SOUTH OF THE NEW 300 mm WATER MAIN TO APPROXIMATELY 31 m RT, NORTH OF NEW VALVE WW-56.
8. CUT, CAP, AND ABANDON EXISTING 150 mm WATER MAIN SOUTH OF VALVE WW-83 AT CAROLYN COURT
9. CLOSE VALVES ON EXISTING EAST-WEST 150 mm WATER MAIN AT STA. 9+690 AND AT STA. 9+940. CLOSE VALVE ON EXISTING SOUTH-NORTH 150 mm WATER MAIN AT STA 9+697±, LT.
10. CONNECT WATER VALVE WW-50 TO EXISTING SOUTH-NORTH 150 mm WATER MAIN WITH 150 mm WATER MAIN.
11. PROVIDE REMAINING CONNECTIONS AT WW-81, WW- 82, AND WW-84, CLOSING EXISTING VALVES AS NECESSARY TO MAKE CONNECTIONS. CAP AND ABANDON REMAINING 150 mm AND 200 mm MAINS.

LEGEND

[H]	FIRE HYDRANT TO BE MOVED
[ADJ]	STRUCTURE TO BE ADJUSTED
[F]	STRUCTURE TO BE FILLED
[R]	STRUCTURE TO BE REMOVED
[REC]	STRUCTURE TO BE RECONSTRUCTED
[---]	PIPE ABANDONMENT (OR REMOVAL WHERE REQ'D)

WH-57
NEW FIRE HYDRANT LOCATION
STA. 10+140.0,
20.0 m LT

WW-55
WATER VALVE 200MM IN VALVE VAULT TY. A,
1.5 m DIA, TY 1 FR & CL
STA. 10+198.0, 18.5 m LT
RIM=267.34

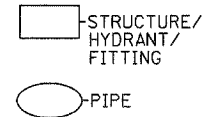

WH-57
1.0 m - 150 mm DUCT. IRON WATER MAIN

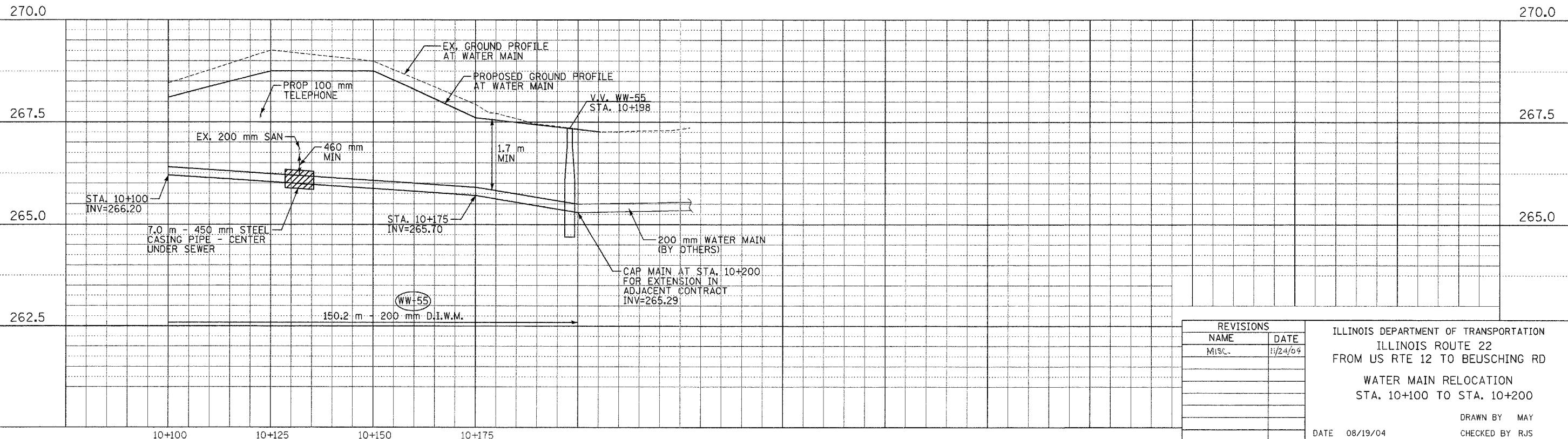

REVISIONS

NAME	DATE
Misc.	1/24/04

ILLINOIS DEPARTMENT OF TRANSPORTATION
ILLINOIS ROUTE 22
FROM US RTE 12 TO BEUSCHING RD
WATER MAIN RELOCATION
STA. 10+100 TO STA. 10+200

DATE 08/19/04

DRAWN BY MAY
CHECKED BY RJS

DATE	
BY	
FINAL SURVEY PLOTTED	
NOTE BOOK TEMPLATE	
AREAS CHECKED	
NO.	

DATE	
BY	
ORIGINAL SURVEY PLOTTED	
NOTE BOOK TEMPLATE	
AREAS CHECKED	
NO.	