

F.A. RTE.	SECTION	COUNTY	TOTAL SHEETS	SHEET NO.
337	19R-1	LAKE	800	384
STA. 10+100		TO STA. 10+200		
FED. ROAD DIST. NO.		ILLINOIS FED. AID PROJECT		

#60997

HORIZONTAL SCALE IN METERS

VERTICAL SCALE IN METERS

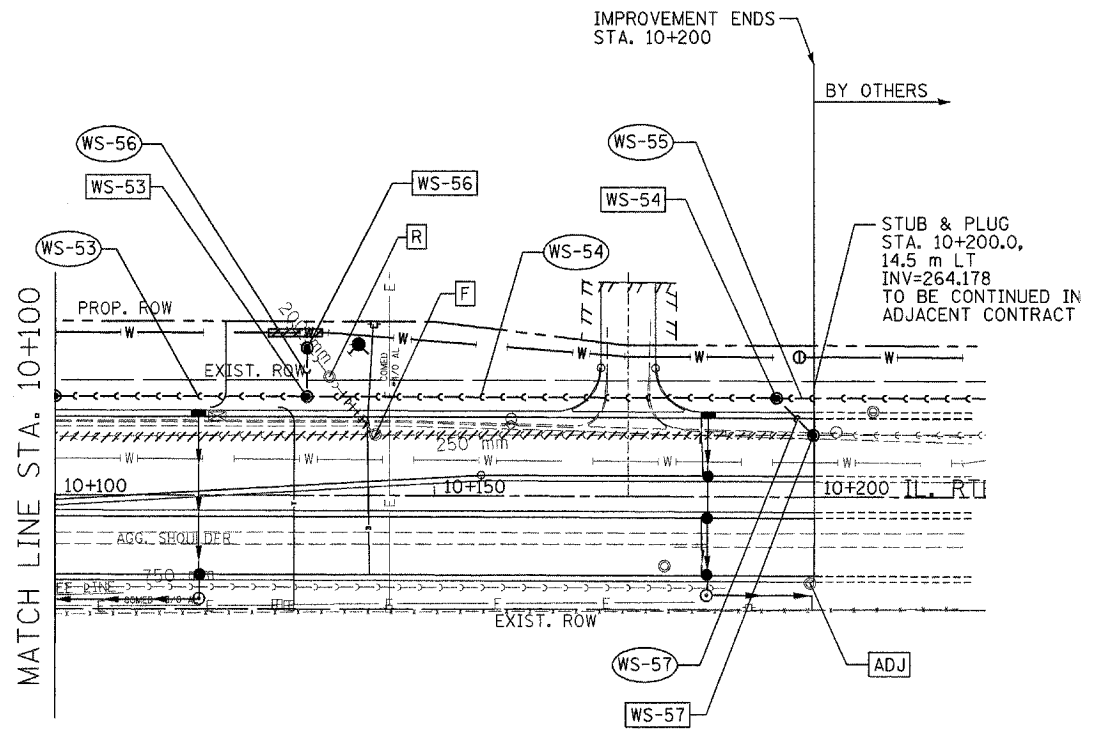

- WS-53**
SAN. MH 1.2M DIA.
W/ FR, LID & CHIMNEY SEAL
STA. 10+133.2
13.0 m LT
RIM=266.98
INV(E,W)= 263.978
INV(N)=264.478
- WS-54**
SAN. MH 1.2M DIA.
W/ FR, LID & CHIMNEY SEAL
STA. 10+195.0,
13.0 m LT
RIM=266.87
INV(SE)=264.173
(TEMP - SEE NOTE 1)
INV(E,W)=264.163
- WS-55**
DIP SAN. MH 1.2M DIA.
W/ FR, LID & CHIMNEY SEAL
STA. 10+133.2,
19.5 m LT
RIM=268.15
INV(N)=266.700 (EX)
(DROP CONN)
INV(S)=264.608
- WS-56**
SAN. MH 1.2M DIA.
W/ FR, LID & CHIMNEY SEAL
STA. 10+200.0
8.2 m LT
RIM=267.00
INV(E,NW)=264.201
TEMP MANHOLE -
SEE NOTE 1
- WS-57**
6.9 m - 200 mm
PVC @ 0.40%
TEMP PIPING -
SEE NOTE 1

LEGEND

- ADJ STRUCTURE TO BE ADJUSTED
- F STRUCTURE TO BE FILLED
- R STRUCTURE TO BE REMOVED
- REC STRUCTURE TO BE RECONSTRUCTED
- PIPE ABANDONMENT (OR REMOVAL WHERE REQ'D)

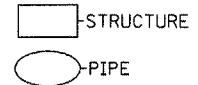

NOTES:

- PROPOSED SEWER AND MANHOLE WS-57 ARE TO SERVE AS A TEMPORARY CONNECTION FROM THE EXISTING SEWER TO THE EAST UNTIL SEWER CONSTRUCTION IS COMPLETED FOR THE ADJACENT CONTRACT. PLUGGING AND ABANDONMENT OF THIS SEWER AND FILLING OF THIS MANHOLE SHALL BE INCLUDED IN THE ADJACENT CONTRACT.

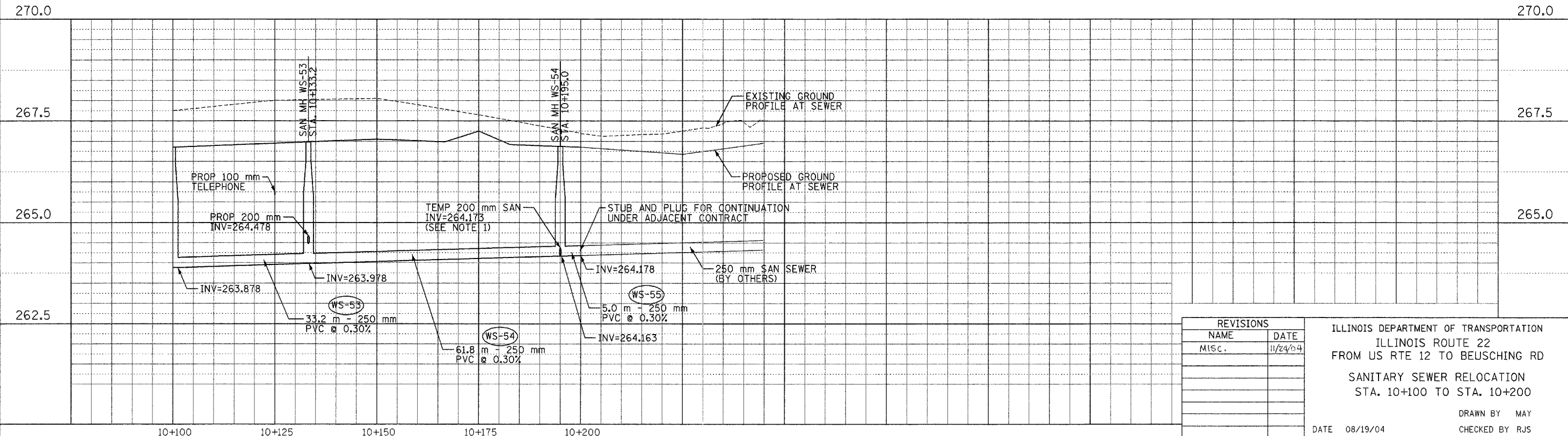

REVISIONS	
NAME	DATE
MISC.	11/24/04

ILLINOIS DEPARTMENT OF TRANSPORTATION
ILLINOIS ROUTE 22
FROM US RTE 12 TO BEUSCHING RD
SANITARY SEWER RELOCATION
STA. 10+100 TO STA. 10+200

DATE 08/19/04

DRAWN BY MAY
CHECKED BY RJS

DATE	
BY	
FINAL SURVEY PLOTTED	
NOTE BOOK TEMPLATE AREAS CHECKED	
NO.	

DATE	
BY	
ORIGINAL SURVEY PLOTTED	
NOTE BOOK TEMPLATE AREAS CHECKED	
NO.	