

F.A. RTE.	SECTION	COUNTY	TOTAL SHEETS	SHEET NO.
337	19R-1	LAKE	800	433
STA. 21+490 TO STA. 22+000				
FED. ROAD DIST. NO.	ILLINOIS	FED. AID PROJECT	60997	

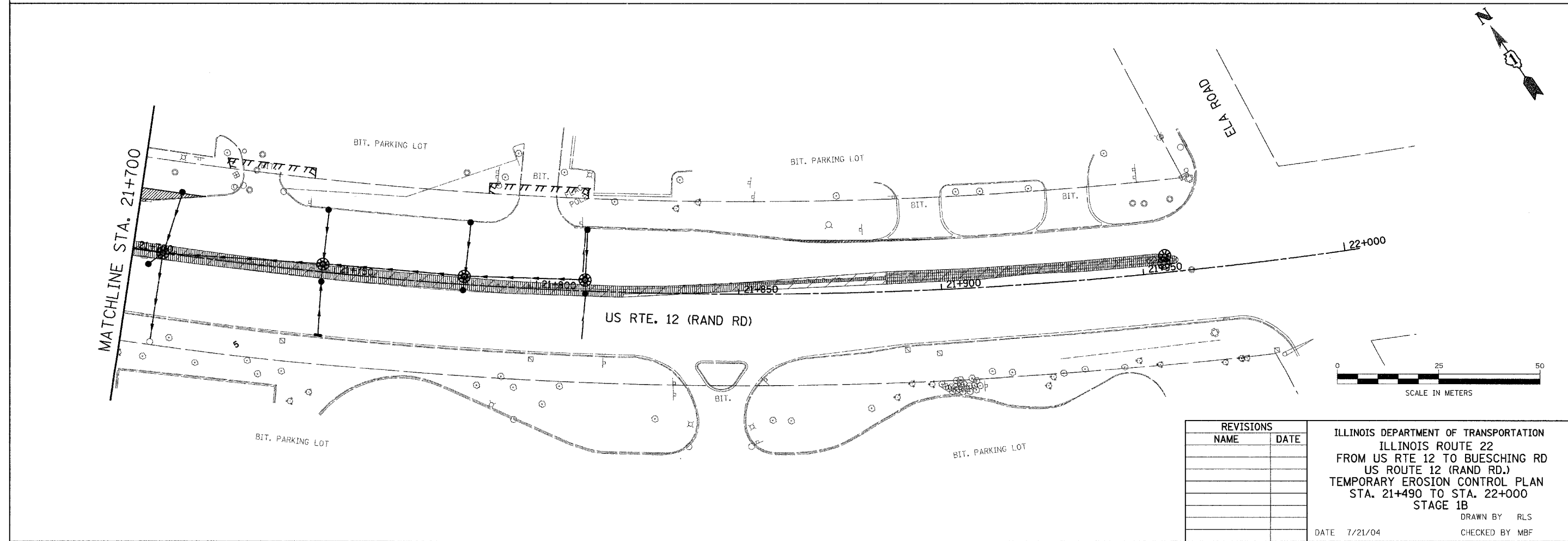
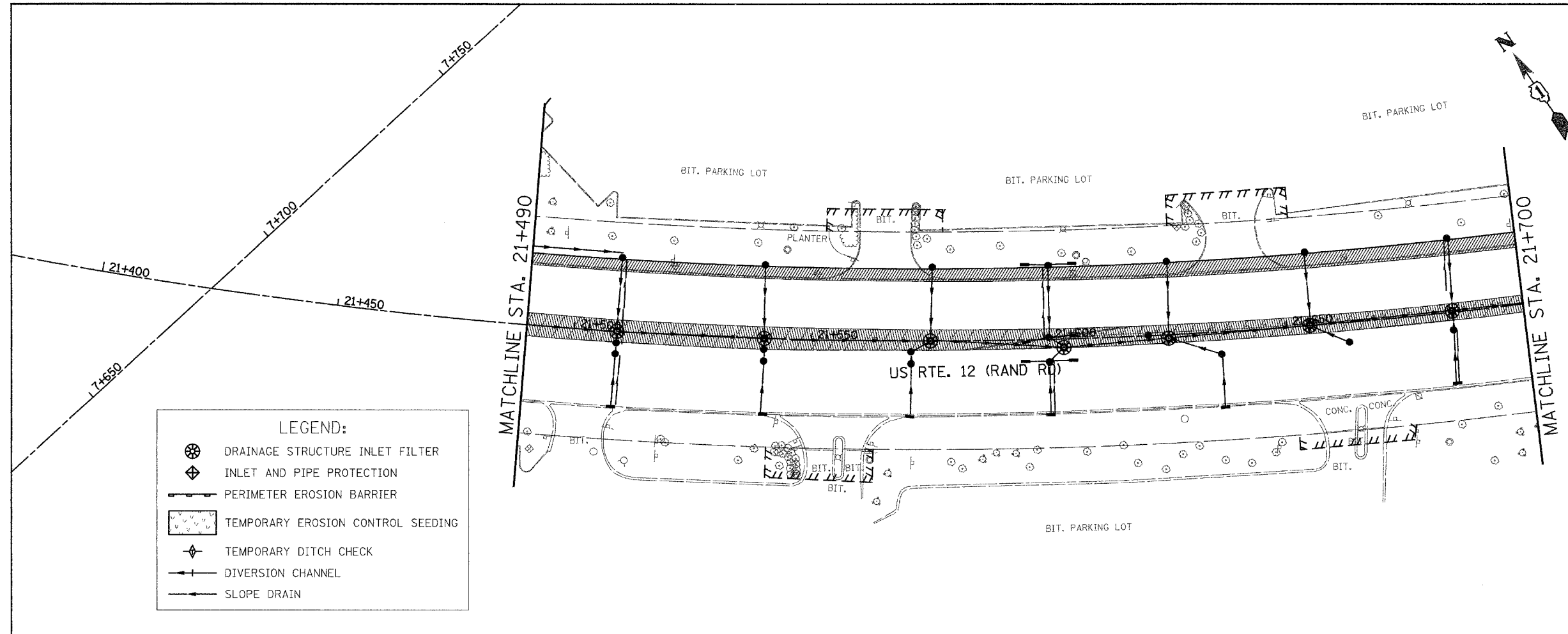

REVISIONS	
NAME	DATE

ILLINOIS DEPARTMENT OF TRANSPORTATION
 ILLINOIS ROUTE 22
 FROM US RTE 12 TO BUESCHING RD
 US ROUTE 12 (RAND RD.)
 TEMPORARY EROSION CONTROL PLAN
 STA. 21+490 TO STA. 22+000
 STAGE 1B
 DRAWN BY RLS
 CHECKED BY MBF
 DATE 7/21/04