

F.A. RTE.	SECTION	COUNTY	TOTAL SHEETS	SHEET NO.
337	19R-1	LAKE	800	488
STA. 70+800		TO STA. 70+960		
FED. ROAD DIST. NO.		ILLINOIS FED. AID PROJECT		

#60997

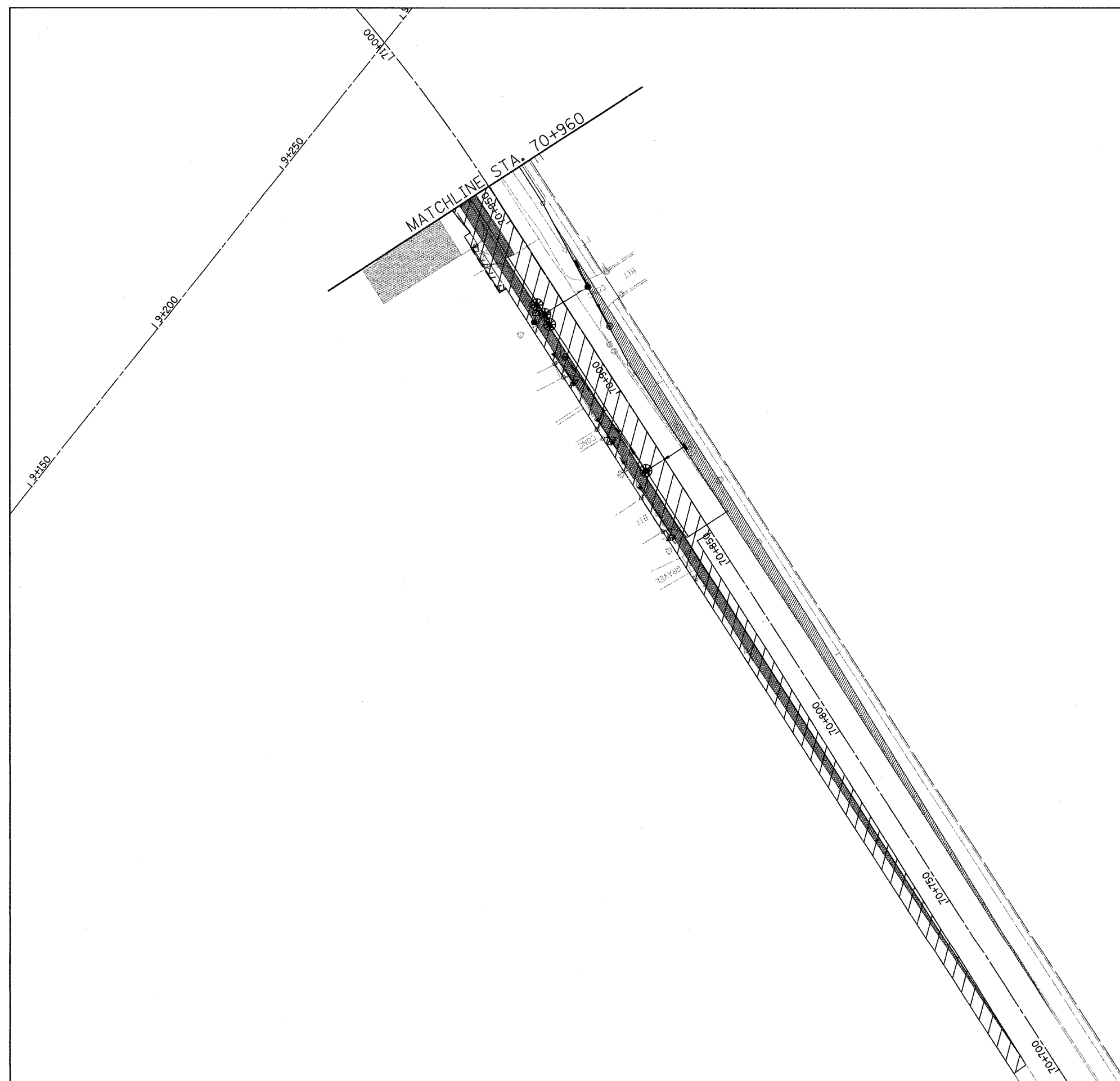

LEGEND:

	DRAINAGE STRUCTURE INLET FILTER
	INLET AND PIPE PROTECTION
	PERIMETER EROSION BARRIER
	TEMPORARY EROSION CONTROL SEEDING
	TEMPORARY DITCH CHECK
	DIVERSION CHANNEL
	SLOPE DRAIN

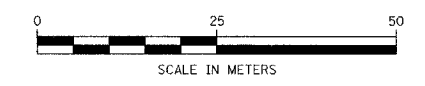

REVISIONS	
NAME	DATE
REVISED DITCH CHECKS	11/24/04

ILLINOIS DEPARTMENT OF TRANSPORTATION  
 ILLINOIS ROUTE 22  
 FROM US RTE 12 TO BUESCHING RD  
 OLD RAND ROAD  
 TEMPORARY EROSION CONTROL PLAN  
 STA. 70+800 TO STA. 70+960  
 STAGE 5A  
 DRAWN BY RLS  
 CHECKED BY MBF  
 DATE 7/21/04