

| ROUTE NO. | SECTION | COUNTY | TOTAL SHEETS | SHEET NO. |
|---------------------|----------|-------------------|--------------|-----------|
| FAP 337 (IL 22) | 19R-1 | LAKE | 800 | 569 |
| FED. ROAD DIST. NO. | ILLINOIS | FED. AID PROJECT- | | |

STATE OF ILLINOIS
DEPARTMENT OF TRANSPORTATION

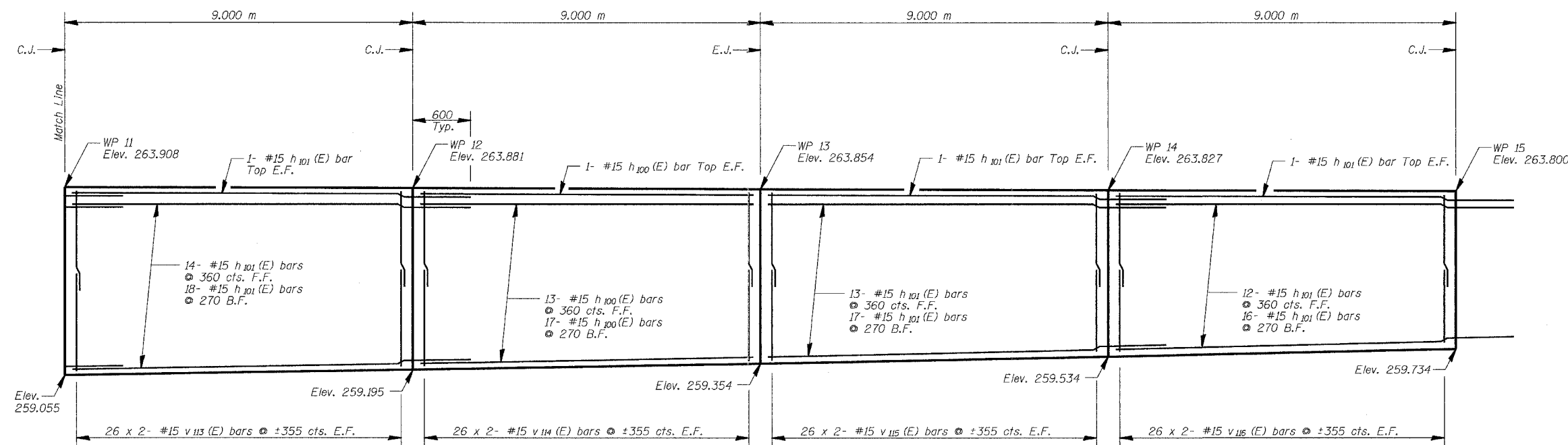

ELEVATION

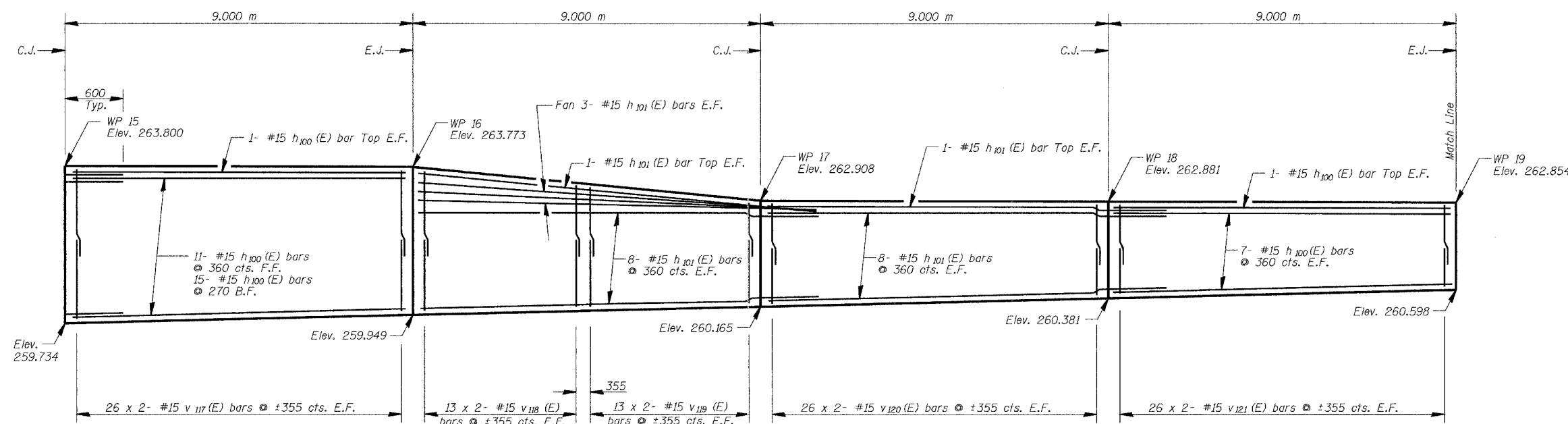

ELEVATION

NOTES

- All dimensions are in millimeters (mm) except as noted.
- Bars indicated thus 26 x 2- #15 etc. indicates 26 lines of bars with 2 lengths per line.

MIN. BAR LAP
#15 = 510

CONCRETE FACING

| | | | |
|-----------|--------------|--|------------------------------|
| Date | Designed TDN | F.A.P. RTE. 337 (IL. RTE. 22) SECTION 19R-1 WEST OF U.S. 12 TO EAST OF BEUSCHING ROAD LAKE COUNTY STATION 8+752.493 TO 8+883.521 STRUCTURE NO. 049-W029 | Sheet No. |
| Revisions | Drawn BKN | | 10 |
| | Checked KWB | | of 23 |
| | Approved KWB | | URS Job No. 2100001385.01 |