

36 34 32 30 28 26 24 22 20 18 16 14 12 10 8 6 4 2 0 2 4 6 8 10 12 14 16 18 20 22 24 26

F.A. RTE. 337	SECTION 19R-1	COUNTY LAKE	TOTAL SHEETS 800	SHEET NO. 738
STA.		TO STA.		
FED. ROAD DIST. NO.		ILLINOIS	FED. AID PROJECT	

U.S. RTE 12
RAND ROAD

RESURFACING ENDS AT STA. 21+ 120.33

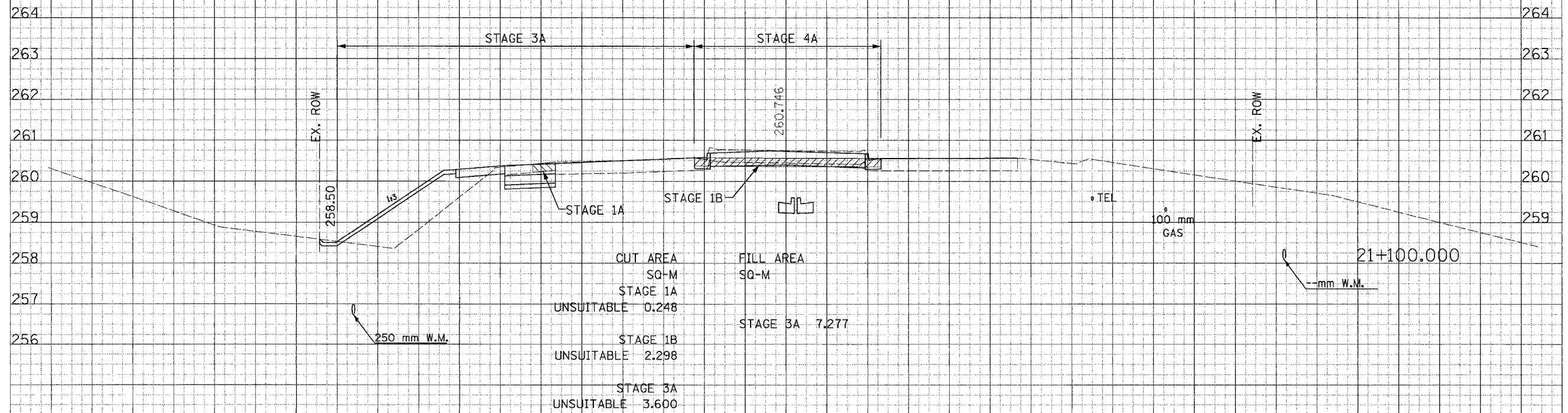
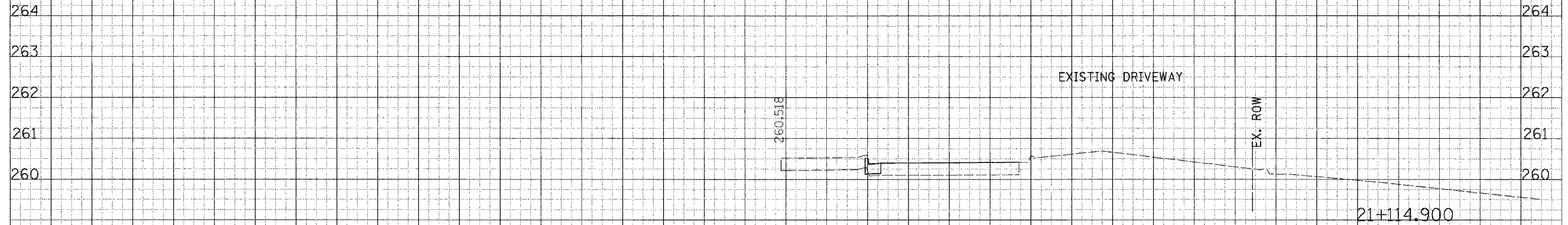

36 34 32 30 28 26 24 22 20 18 16 14 12 10 8 6 4 2 0 2 4 6 8 10 12 14 16 18 20 22 24 26 28 30 32 34 36

CROSS SECTIONS - U.S. RTE 12 / RAND ROAD

REVISIONS AND
 COMMENTS
 DATE
 BY
 CHECKED
 DATE
 BY
 APPROVED
 DATE
 BY

ORIGINAL
 SURVEY
 DATE
 BY
 CHECKED
 DATE
 BY
 APPROVED
 DATE
 BY