

F.A.I. RTE.	SECTION	COUNTY	TOTAL SHEETS	SHEET NO.
55	2002-022 K	WILL	172	45
STA. 10+00		TO STA. 22+96.05		
FED. ROAD DIST. NO.		ILLINOIS FED. AID PROJECT		
CONTRACT NO. 62389				

LEGEND: PROPOSED UTILITIES

- INLET
- o MANHOLE
- CATCHBASIN
- ~ CONCRETE HEADWALL
- ▶ FLARED END SECTION
- ~ DITCH FLOW
- ⊕ DITCH CHECK
- ↔ SUMMIT
- DIRECTION OF WATER
- FIRE HYDRANT
- ⊕ SWALE
- SANITARY SEWER LINE
- STORM SEWER LINE
- CULVERT

PLAN	SURVEYED	BY	DATE
	ALIGNED		
	CHECKED		
	BY		
	NO.		

PROFILE	SURVEYED	BY	DATE
	GRADES		
	CHECKED		
	BY		
	NO.		

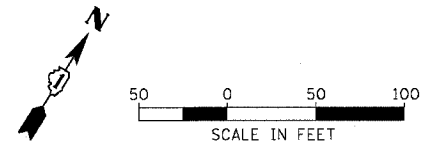
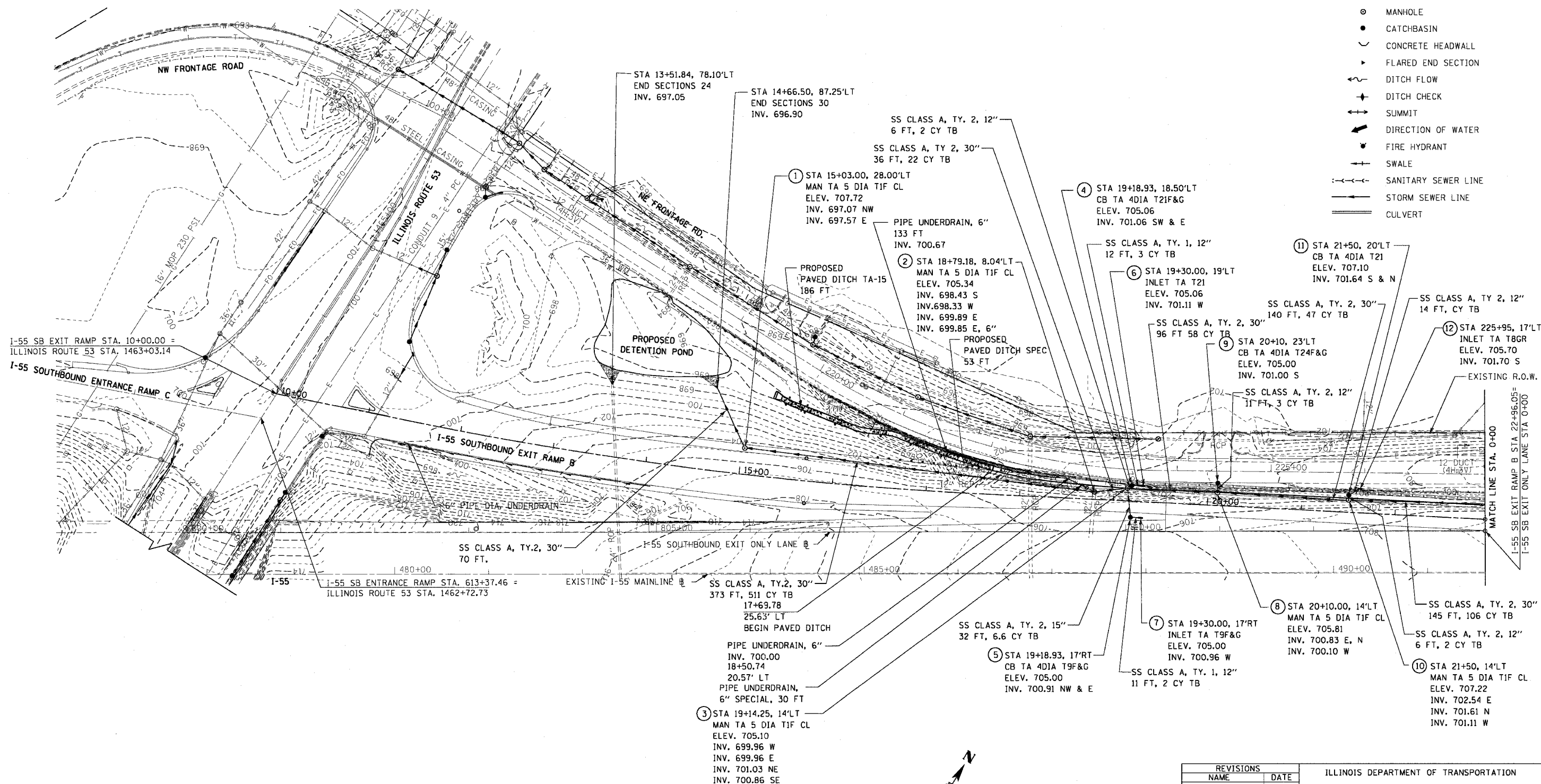

REVISIONS	
NAME	DATE

ILLINOIS DEPARTMENT OF TRANSPORTATION

PROPOSED DRAINAGE PLAN
I-55 SOUTHBOUND EXIT RAMP B
STA 10+00 TO STA 22+96.05

SCALE: 1"=50'
DATE: 12/23/2004

DRAWN BY: CC
CHECKED BY: RI

DMJM HARRIS
303 East Wacker Drive, Suite 600
Chicago, Illinois, 60601 Phone: 312.321.6101 Fax: 312.396.2392