

F.A.L. RTE.	SECTION	COUNTY	TOTAL SHEETS	SHEET NO.
55	27 BR	WILL	29	9
STA.		TO STA.		
FED. AID DIST. NO. 1		ILLINOIS	FED. AID PROJECT	
CONTRACT NO. 62424				

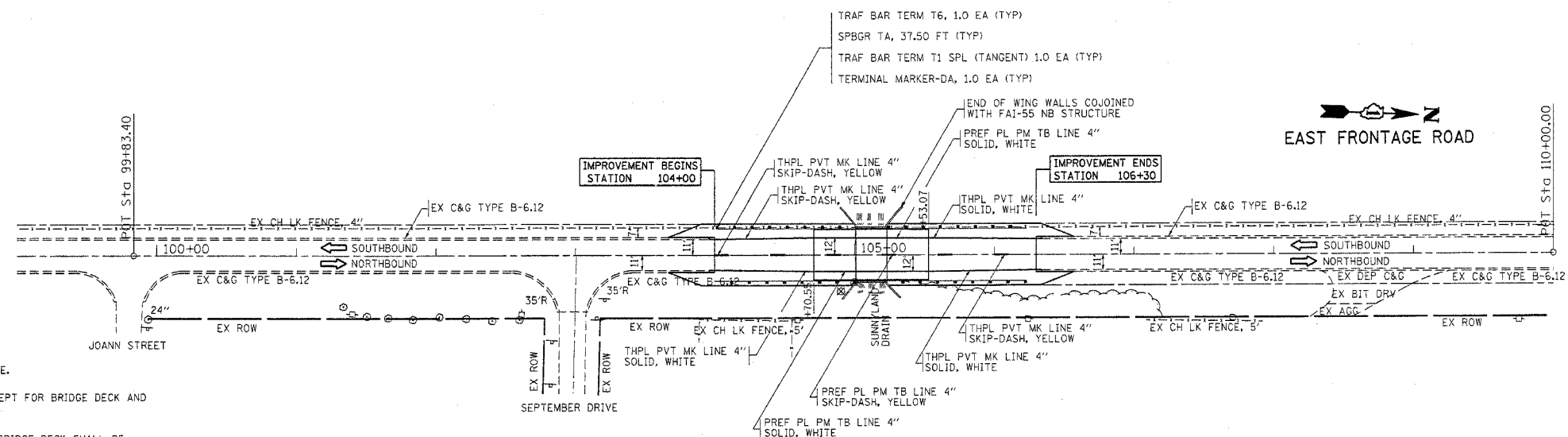

**NOTE:**

ALL DIMENSIONS ARE TO THE EDGE OF PAVEMENT OR LANE.

ALL FINAL PAVEMENT MARKINGS ARE THERMOPLASTIC EXCEPT FOR BRIDGE DECK AND APPROACH PAVEMENT.

PAVEMENT MARKINGS FOR THE APPROACH PAVEMENT AND BRIDGE DECK SHALL BE PREFORMED PLASTIC PAVEMENT MARKING TYPE B.

FOR PAVEMENT MARKING DETAILS, SEE SPECIAL DETAIL SHEETS FOR "DISTRICT ONE PAVEMENT MARKINGS".

FOR DETAILS & SYMBOLS OF RAISED REFLECTIVE PAVEMENT MARKERS, SEE SPECIAL DETAIL SHEETS FOR "DISTRICT ONE TYPICAL APPLICATIONS RAISED REFLECTIVE PAVEMENT MARKERS (SNOW-PLOW RESISTANT)". DUAL ONE-WAY CRYSTAL MARKERS SHALL BE USED ON SKIP-DASH LANE LINES.

THE RESIDENT ENGINEER SHALL VERIFY THE LOCATIONS OF ALL EXISTING PAVEMENT MARKINGS PRIOR TO MILLING OR RESURFACING.

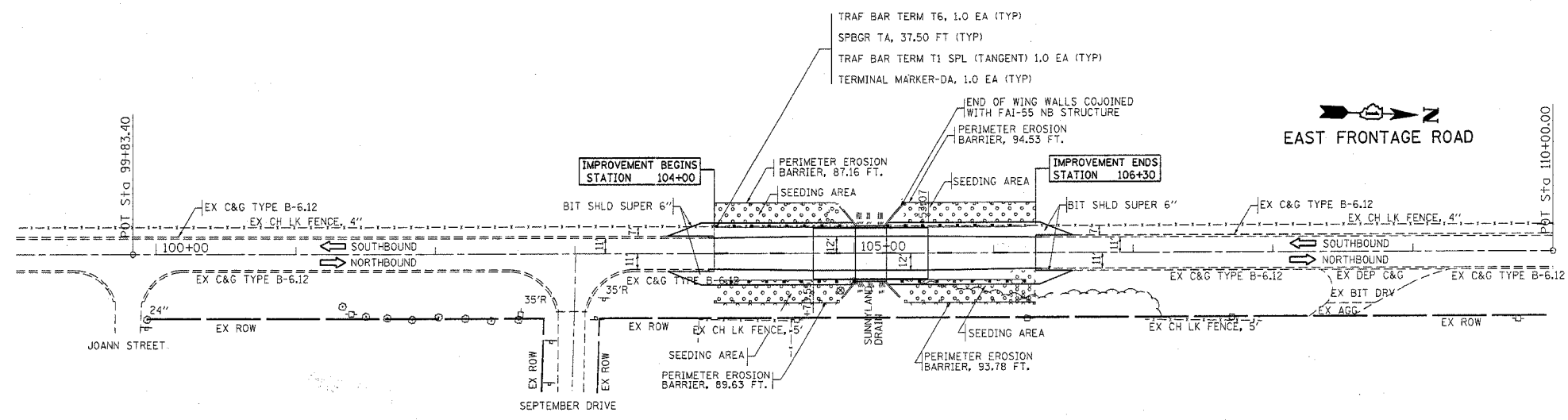

REVISIONS	
NAME	DATE

ILLINOIS DEPARTMENT OF TRANSPORTATION  
 FAI-55 (EAST FRONTAGE ROAD)  
 OVER SUNNYLAND DRAIN

PAVEMENT MARKING AND  
 LANDSCAPING PLANS

SCALE: VERT. 1"=50'  
 HORIZ. 1"=50'  
 DATE 12/16/2004

DRAWN BY  
 CHECKED BY

12/16/2004  
 C:\p\01601\01601.dwg  
 REF-  
 VI-