

F.A.I. SECTION	COUNTY	TOTAL SHEETS	SHEET NO.
90/94 2003-0311	COOK	976	75
STA. 116+00	TO STA. 129+00		
FED. ROAD DIST. NO.	ILLINOIS	FED. AID PROJECT	62583

- NOTES:**
- SEE DRAWINGS ME-01 AND ME-02 FOR ELECTRICAL SYMBOLS AND ABBREVIATIONS.
 - UNLESS NOTED OTHERWISE, ALL ITEMS AND WORK SHOWN IN HEAVY LINE WEIGHT ON THIS DRAWING ARE PROPOSED NEW ITEMS OF WORK.
 - THE EXISTING ROADWAY LIGHTING SYSTEM SHALL REMAIN IN OPERATION UNTIL THE PROPOSED ROADWAY LIGHTING SYSTEM HAS BEEN INSTALLED, ENERGIZED, TESTED, AND ACCEPTED BY THE ENGINEER, UNLESS OTHERWISE DIRECTED BY THE ENGINEER.
 - PROVIDE AERIAL CABLE BETWEEN EXISTING LIGHT POLES TO PERMIT REMOVAL OF SIGN UNDER SEPARATE CONTRACT. REFER TO SHEET ME-16.
 - SIGN SHALL BE DISCONNECTED BACK TO NEXT SPLICE. SIGN STRUCTURE AND LUMINAIRES SHALL BE REMOVED UNDER SEPARATE CONTRACT. COORDINATE WITH CONTRACTS 62694 AND 62695. NOTE: PROPOSED SIGN A3 SHALL BE INSTALLED AND OPERATIONAL BEFORE EXISTING SIGN A4 IS DISCONNECTED.

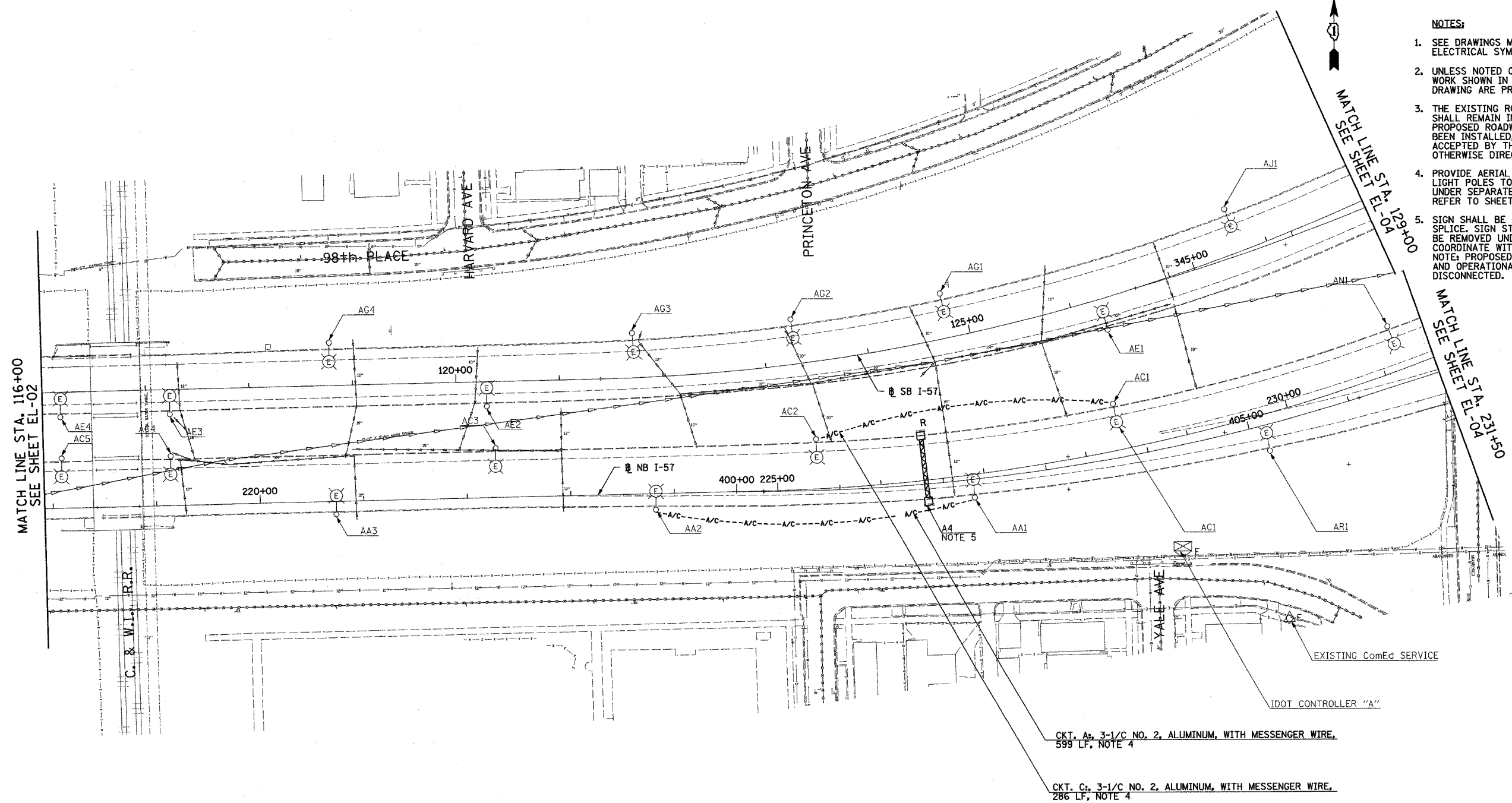

CKT. A: 3-1/C NO. 2, ALUMINUM, WITH MESSENGER WIRE, 599 LF, NOTE 4

CKT. C: 3-1/C NO. 2, ALUMINUM, WITH MESSENGER WIRE, 286 LF, NOTE 4



EL-03

SINGH
SINGH & ASSOCIATES, INC.
CONSULTING ENGINEERS

300 W. ADAMS ST.
CHICAGO, IL 60606
TEL: (312) 629-0240
FAX: (312) 629-8449

REVISIONS		ILLINOIS DEPARTMENT OF TRANSPORTATION F.A.I. 90/94 (DAN RYAN EXPRESSWAY) 31st STREET TO I-57
NAME	DATE	
		ROADWAY LIGHTING PLANS EXISTING CONDITIONS, TEMPORARY AND REMOVAL
SCALE: 1"=50'		DRAWN BY: SP
DATE: OCTOBER 29, 2004		CHECKED BY: TM

10/20/2004 5:13:59 PM