

F.A.I. RTE.	SECTION	COUNTY	TOTAL SHEETS	SHEET NO.
90/94	2003-0311	COOK	976	97
STA. 1388+00.00		TO STA. 1398+00.00		
FED. ROAD DIST. NO. 1		ILLINOIS FED. AID PROJECT		

62583

NOTES:

- SEE DRAWINGS ME-01 AND ME-02 FOR ELECTRICAL SYMBOLS AND ABBREVIATIONS.

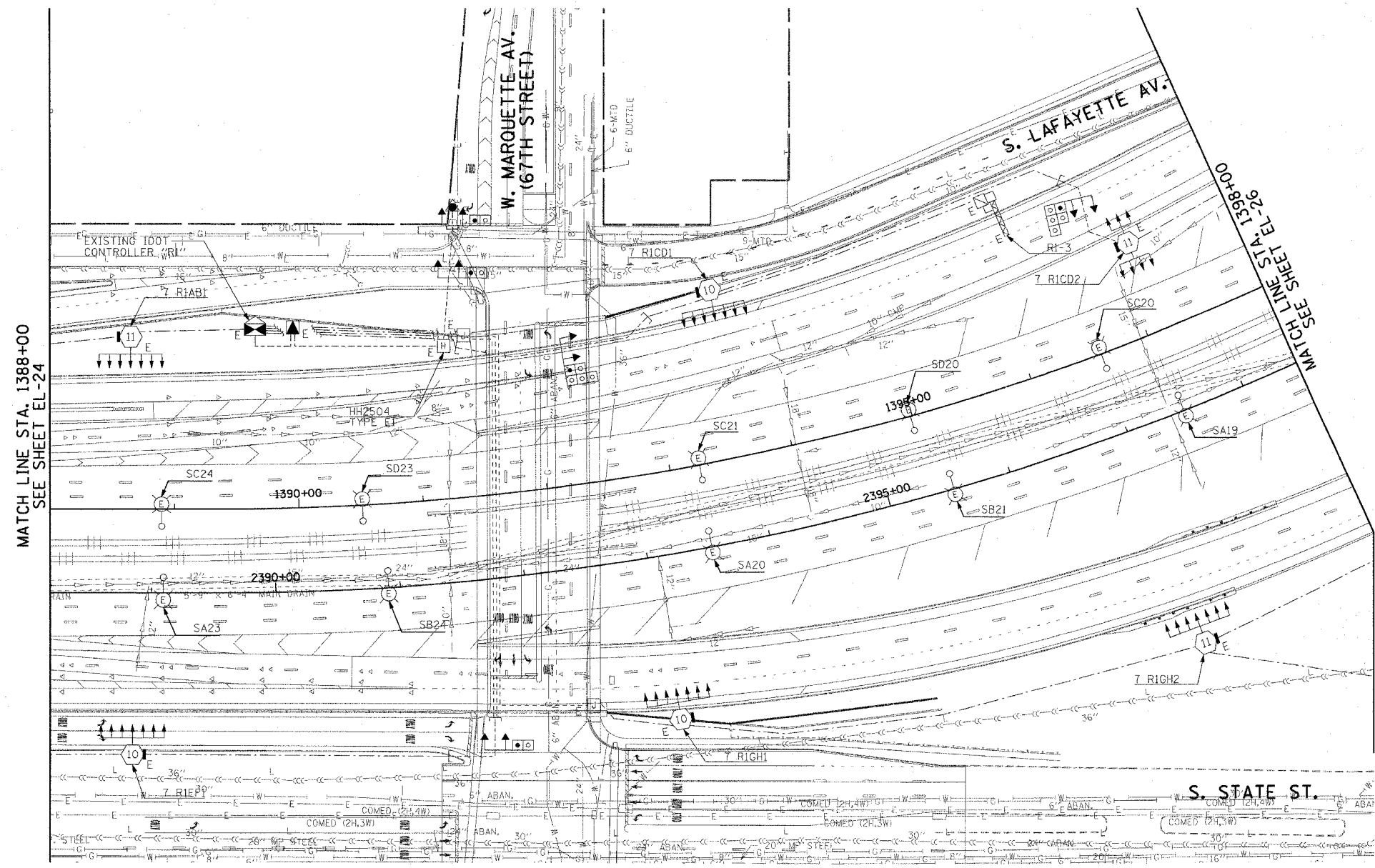

MATCH LINE STA. 1388+00
SEE SHEET EL-24

MATCH LINE STA. 1398+00
SEE SHEET EL-26

THIS SHEET IS FOR INFORMATIONAL PURPOSES ONLY. HIGH MAST LIGHT TOWERS, CONTROLLERS, AND WIRING ARE INSTALLED IN IDOT CONTRACT NO. 62733.



EL-25

REVISIONS	
NAME	DATE

ILLINOIS DEPARTMENT OF TRANSPORTATION
F.A.I. 90/94 (DAN RYAN EXPRESSWAY)
31st STREET TO I-57

**ROADWAY LIGHTING PLANS
EXISTING CONDITIONS AND DEMOLITION**

SCALE: 1"=50' DRAWN BY: CJM
DATE: October 29, 2004 CHECKED BY: WDS

CTE ENGINEERS
CONCER TOWNSEND ENVIRONMENTAL ENGINEERS, INC.
303 EAST WALKER DRIVE, SUITE 600
CHICAGO, ILLINOIS 60601-5202, PHONE: (312) 938-0300

10/15/2004 02:34:05 PM