

|                     |           |                  |              |           |
|---------------------|-----------|------------------|--------------|-----------|
| F.A.I. RTE.         | SECTION   | COUNTY           | TOTAL SHEETS | SHEET NO. |
| 90/94               | 2003-0311 | COOK             | 976          | 129       |
| STA. 142+00         |           | TO STA. 1204+00  |              |           |
| FED. ROAD DIST. NO. | ILLINOIS  | FED. AID PROJECT |              |           |

62583

NOTES:

- SEE DRAWINGS ME-01 AND ME-02 FOR ELECTRICAL SYMBOLS AND ABBREVIATIONS.
- UNLESS NOTED OTHERWISE, ALL ITEMS AND WORK SHOWN IN HEAVY LINE WEIGHT ON THIS DRAWING ARE PROPOSED NEW ITEMS AND WORK.
- SEE DRAWING ES-01 FOR HIGH MAST LIGHT TOWER SCHEDULE.
- THE EXISTING ROADWAY LIGHTING SYSTEM SHALL REMAIN IN OPERATION UNTIL THE PROPOSED ROADWAY LIGHTING SYSTEM HAS BEEN INSTALLED, ENERGIZED, TESTED, AND ACCEPTED BY THE ENGINEER, UNLESS OTHERWISE DIRECTED BY THE ENGINEER.
- REFER SHEET ME-15 AND ME-15A FOR COMED SERVICE DETAILS.
- AERIAL CABLE AND TEMPORARY WOOD POLES SHALL BE REMOVED AFTER HIGH MAST LIGHT TOWERS ARE PERMANENTLY WIRED AND ACCEPTED BY THE ENGINEER.
- TEMPORARY WOOD POLES SHALL BE INSERTED IN GROUND TO ACCOMMODATE PROPOSED GRADING.
- REFER SHEET ME-25 FOR TEMPORARY WIRING TO TOWER DETAIL.
- UNIT DUCT TRENCH DEPTH SHALL BE ADJUSTED TO PERMIT FINAL GRADING WITHOUT DAMAGE TO UNIT DUCT.

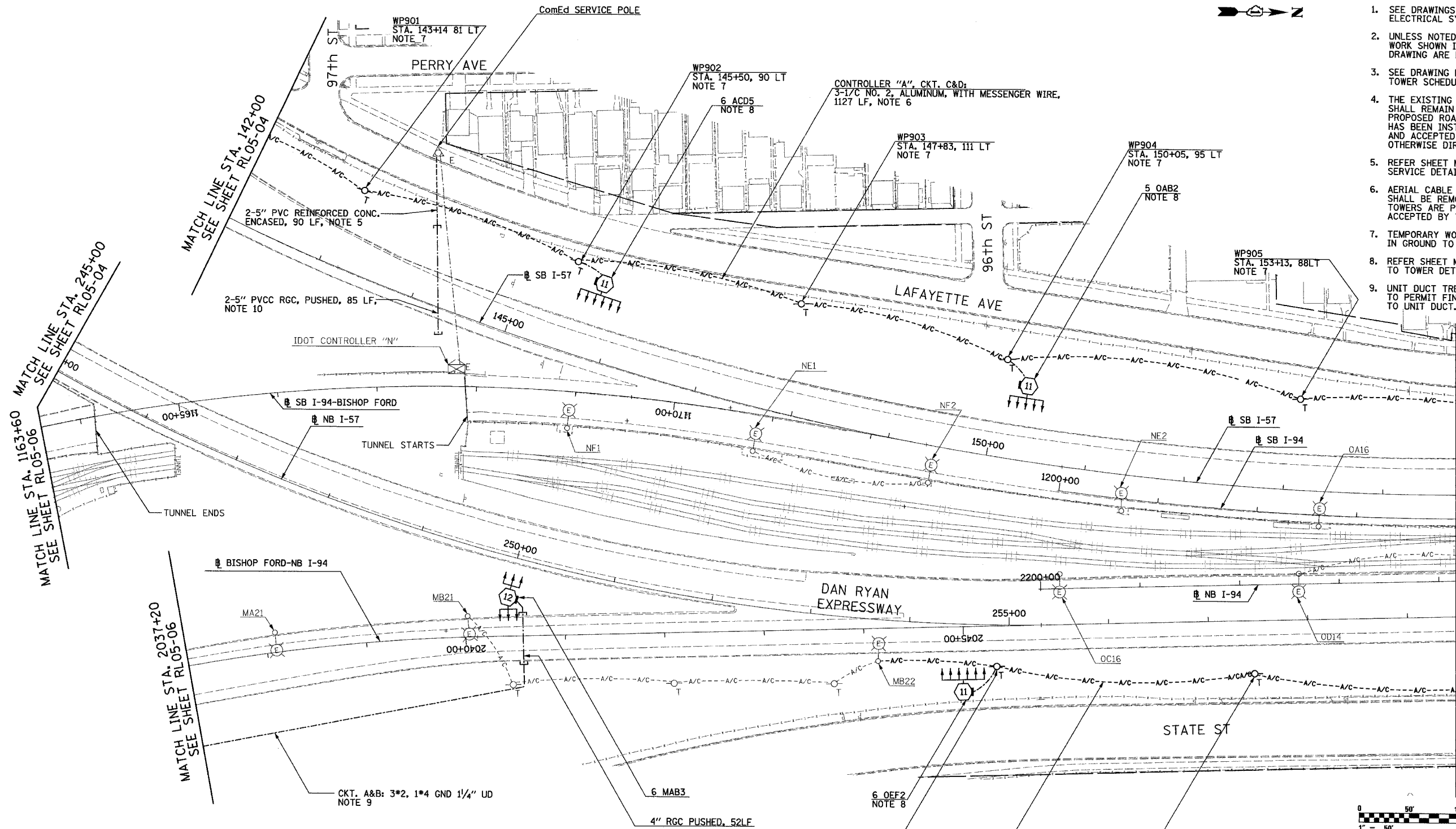
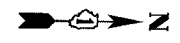

MATCH LINE STA. 1163+60  
MATCH LINE STA. 142+00  
MATCH LINE STA. 245+00  
MATCH LINE STA. 2037+20

MATCH LINE STA. 1204+00  
MATCH LINE STA. 1204+00

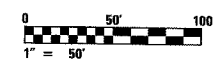

RL05-09

**SINGH**  
SINGH & ASSOCIATES, INC.  
CONSULTING ENGINEERS  
300 W. ADAMS ST.  
CHICAGO, IL 60606  
TEL: (312) 629-0240  
FAX: (312) 629-8449

| REVISIONS |      |
|-----------|------|
| NAME      | DATE |
|           |      |
|           |      |
|           |      |
|           |      |
|           |      |
|           |      |
|           |      |
|           |      |
|           |      |
|           |      |

ILLINOIS DEPARTMENT OF TRANSPORTATION  
F.A.I. 90/94 (DAN RYAN EXPRESSWAY)  
31st STREET TO I-57  
ROADWAY LIGHTING PLANS  
PROPOSED IMPROVEMENTS 2005  
SCALE: 1"=50'  
DATE: OCTOBER 29, 2004  
DRAWN BY: VRK  
CHECKED BY: TM

WP906  
STA. 254+86, 41 RT  
NOTE 7  
CKT. A&B. FROM CONTROLLER "M":  
3-1/2" NO. 2, ALUMINUM, WITH MESSENGER WIRE,  
379 LF, NOTE 6

WP907  
STA. 257+45, 53 RT  
NOTE 7

NOTES CONTINUED:  
10. CAP CONDUITS FOR EXTENSION UNDER  
SEPARATE CONTRACT. CONDUIT TO BE  
MINIMUM 66" BELOW FINAL GRADE.