

F.A.I. RTE.	SECTION	COUNTY	TOTAL SHEETS	SHEET NO.
90/94	2003-0311	COOK	976	136
STA. 1282+00		TO STA. 1295+00		
FED. ROAD DIST. NO.	ILLINOIS	FED. AID PROJECT		

62583

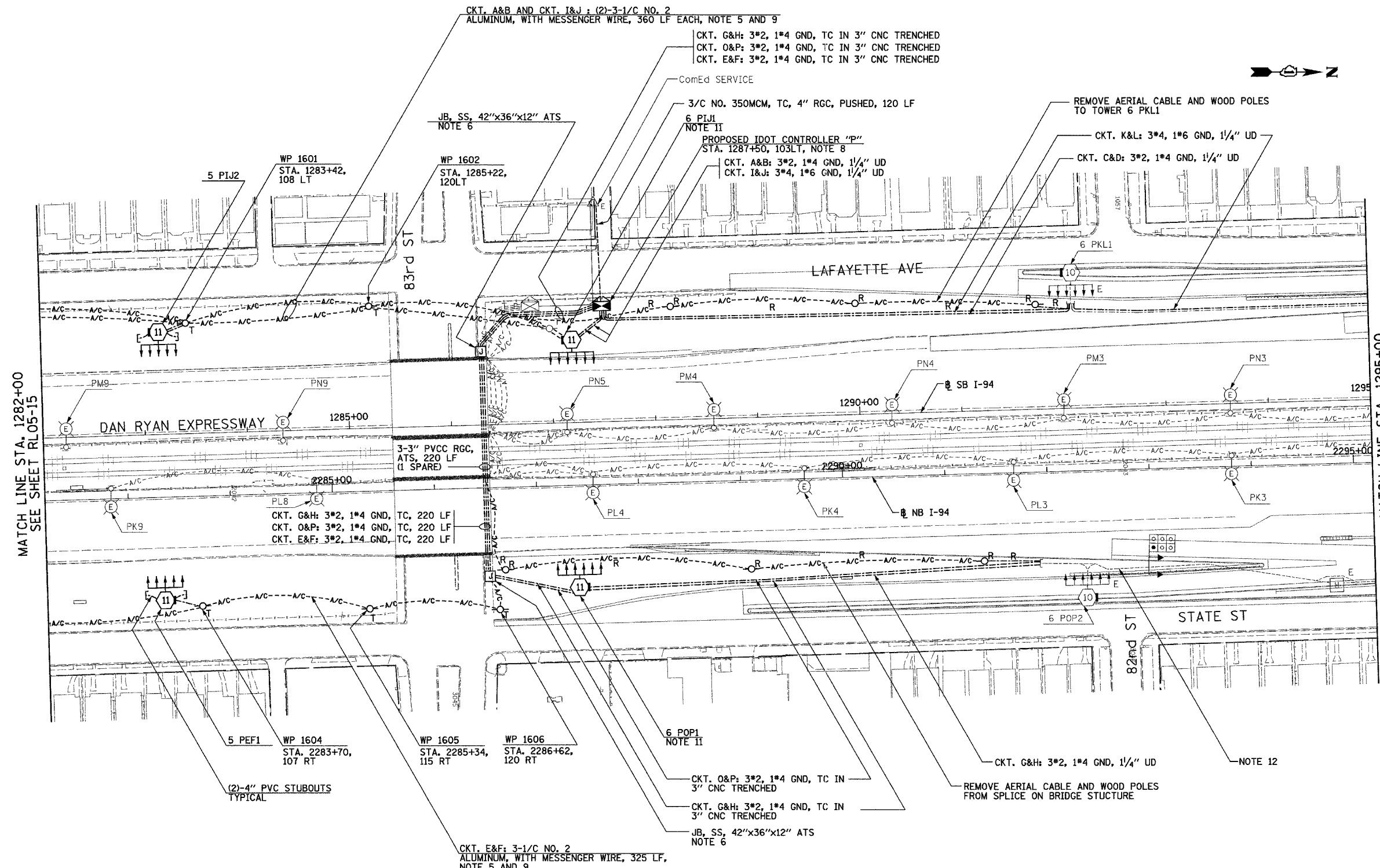

- NOTES:**
- SEE DRAWINGS ME-01 AND ME-02 FOR ELECTRICAL SYMBOLS AND ABBREVIATIONS.
 - UNLESS NOTED OTHERWISE, ALL ITEMS AND WORK SHOWN IN HEAVY LINE WEIGHT ON THIS DRAWING ARE PROPOSED NEW ITEMS OF WORK.
 - SEE SHEET ES-02 FOR HIGH MAST LIGHT TOWER SCHEDULE.
 - THE EXISTING ROADWAY LIGHTING SYSTEM SHALL REMAIN IN OPERATION UNTIL THE PROPOSED ROADWAY LIGHTING SYSTEM HAS BEEN INSTALLED, ENERGIZED, TESTED, AND ACCEPTED BY THE ENGINEER, UNLESS OTHERWISE DIRECTED BY THE ENGINEER.
 - REFER SHEET ME-16 FOR TEMPORARY AERIAL CABLE CONNECTION.
 - ALL JUNCTION BOXES MOUNTED ON BRIDGE STRUCTURES SHALL BE INSTALLED AS SHOWN ON DRAWING ME-05, UNLESS OTHERWISE NOTED.
 - DISCONNECT EXISTING MEDIAN LIGHTING BETWEEN 83RD STREET AND 79TH STREET AFTER HIGH MAST LIGHTING IS IN OPERATION. MEDIAN POLES AND LUMINAIRES TO BE REMOVED UNDER SEPARATE CONTRACT. MEDIAN LIGHTING AND HIGH MAST LIGHTING SHOULD NOT BE IN OPERATION AT SAME TIME.
 - LIGHTING CONTROLLER SHALL BE INSTALLED AS SHOWN ON ME-18, ME-19, ME-20, AND BE-205 SHEET 4 OF 4.
 - AERIAL CABLE AND TEMPORARY WOOD POLES SHALL BE REMOVED AFTER HIGH MAST LIGHT TOWERS ARE PERMANENTLY WIRED AND ACCEPTED BY THE ENGINEER.
 - REMOVE 3*4, 1*6 GND CABLE INSTALLED UNDER CONTRACT 62594 PRIOR TO INSTALLING CKT. G&H AND O&P.
 - FOUNDATIONS SHALL BE PROVIDED UNDER CONTRACT 62594. CONTRACTOR TO INSTALL TOWER AND LUMINAIRES ONLY.
 - CONCRETE ENCASED DUCTBANK SHALL BE PROVIDED UNDER SEPARATE CONTRACT. UNIT DUCT SHALL BE PULLED THROUGH DUCTBANK TO HIGH MAST TOWERS IN CONTINUOUS LENGTHS WITHOUT SPLICES. REFER TO SHEET ME-11 FOR DUCTBANK DEPTH UNDER ROAD.

MATCH LINE STA. 1282+00
SEE SHEET RLO5-15

MATCH LINE STA. 1295+00
SEE SHEET RLO5-17

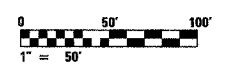

RLO5-16

REVISIONS	
NAME	DATE

ILLINOIS DEPARTMENT OF TRANSPORTATION
 F.A.I. 90/94 (DAN RYAN EXPRESSWAY)
 31st STREET TO I-57
 ROADWAY LIGHTING PLANS
 PROPOSED IMPROVEMENTS 2005

SCALE: 1"=50'
 DATE: OCTOBER 29, 2004

DRAWN BY: VRK
 CHECKED BY: TM

SINGH
 SINGH & ASSOCIATES, INC.
 CONSULTING ENGINEERS

300 W. ADAMS ST.
 CHICAGO, IL 60606
 TEL: (312) 629-0240
 FAX: (312) 629-8449

11/22/2004 6:20:31 PM