

F.A.I. RTE.	SECTION	COUNTY	TOTAL SHEETS	SHEET NO.
90/94	2003-0311	COOK	976	191
STA. 1436+00.00 TO STA. 1446+50.00		FED. ROAD DIST. NO. 1 ILLINOIS FED. AID PROJECT		

62583

NOTES:

- SEE DRAWINGS ME-01 AND ME-02 FOR ELECTRICAL SYMBOLS AND ABBREVIATIONS.
- COORDINATE ALL WORK WITH IDOT CONTRACT NOS. 62300 AND 62302.
- UNLESS NOTED OTHERWISE, ALL ITEMS AND WORK SHOWN IN HEAVY LINE WEIGHT ON THIS DRAWING ARE PROPOSED ITEMS AND WORK.
- SEE IDOT STANDARD DRAWINGS FOR ELECTRIC CONNECTION TO SIGN STRUCTURE DETAILS.
- PROVIDE A TEMPORARY POWER FEED TO THE PROPOSED SIGN TRUSS STRUCTURE T-2 LIGHTING UNITS. SEE DRAWING ME-25 FOR TEMPORARY POWER FEED TO SIGN STRUCTURE DETAILS.
- DETACH THE EXISTING TEMPORARY AERIAL CABLES FROM THE EXISTING LIGHTING UNIT TO BE REMOVED AND REATTACH TO THE NEW TEMPORARY WOOD POLE AS SHOWN. THIS WILL BE INCLUDED FOR PAYMENT WITH THE "REMOVAL OF EXISTING LIGHTING UNIT, SALVAGE" PAY ITEM.
- EXISTING TEMPORARY AERIAL CABLES TO BE REMOVED WILL BE INCLUDED FOR PAYMENT WITH THE "REMOVAL OF EXISTING LIGHTING UNIT, SALVAGE" PAY ITEM.
- REMOVE EXISTING SIGN LUMINAIRES, DISCONNECT THE EXISTING SIGN LIGHTING ELECTRIC SERVICE, AND REMOVE CABLES BACK TO THE NEAREST SPLICE. STRUCTURE AND FOUNDATION WILL BE REMOVED BY OTHERS.

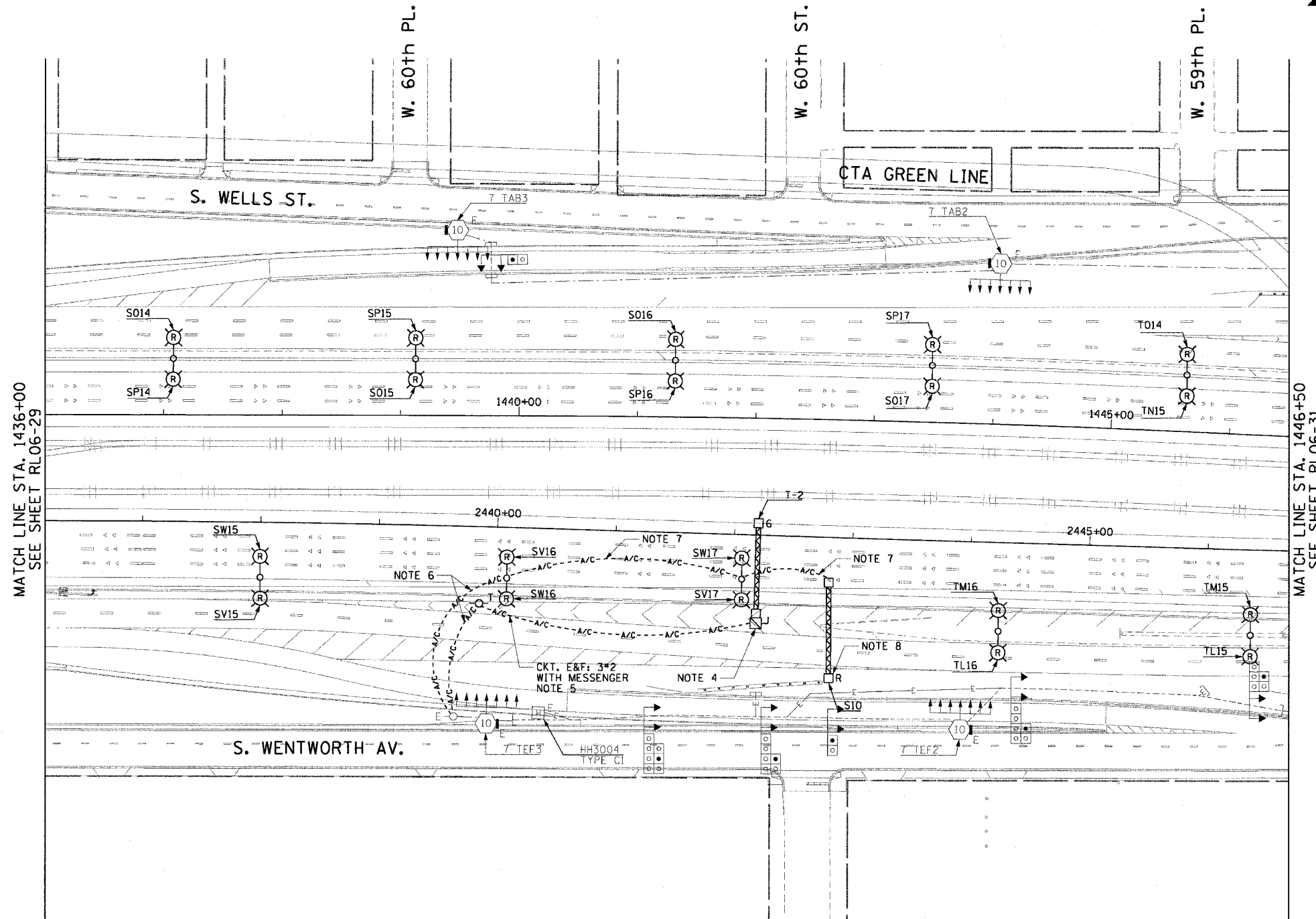
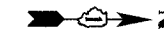

MATCH LINE STA. 1436+00
SEE SHEET RL06-29

MATCH LINE STA. 1446+50
SEE SHEET RL06-31

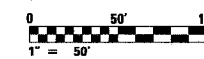

RL06-30

REVISIONS	
NAME	DATE

ILLINOIS DEPARTMENT OF TRANSPORTATION
F.A.I. 90/94 (DAN RYAN EXPRESSWAY)
31st STREET TO I-57

**ROADWAY LIGHTING PLANS
PROPOSED IMPROVEMENTS 2006**

SCALE: 1"=50' DRAWN BY: CJM
DATE: October 29, 2004 CHECKED BY: WDS

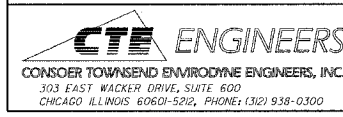

11/23/2004 11:09:43 AM m:\040465\elect\16-entr\20\slm\contract 2\2006\1020302c_06.dwg