

F.A.I. RTE. 90/94	SECTION 2003-0311	COUNTY COOK	TOTAL SHEETS 976	SHEET NO. 435
STA. 7196+00		TO STA. 7191+00		
FED. ROAD DIST. NO.		ILLINOIS FED. AID PROJECT 62583		

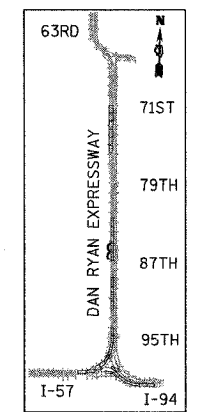

LOCATION MAP

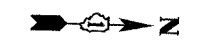
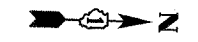
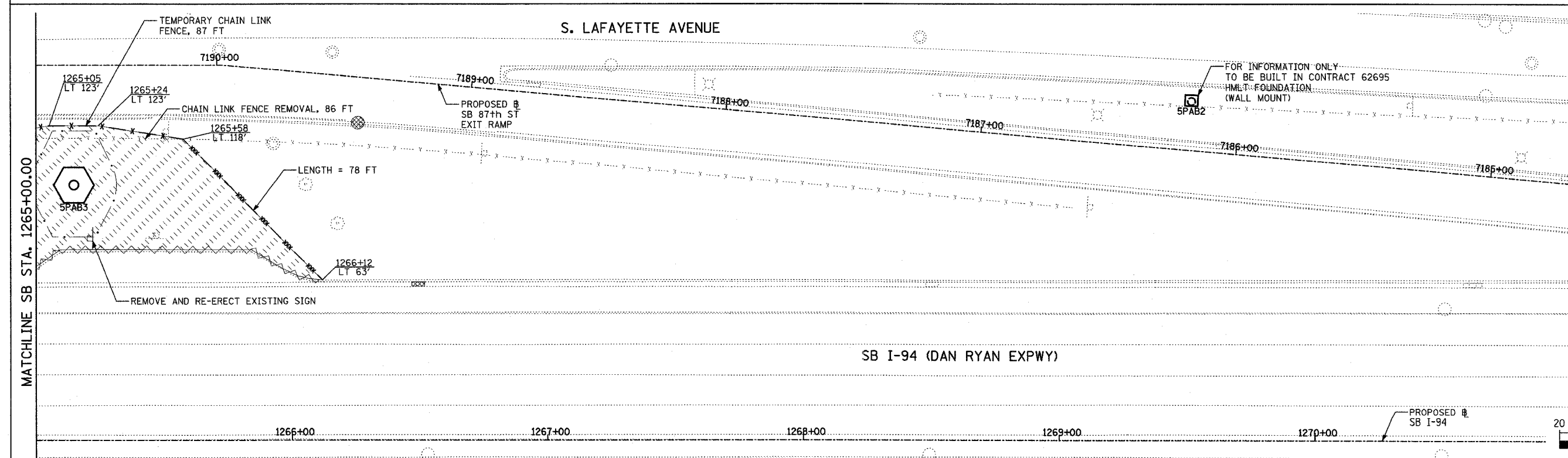
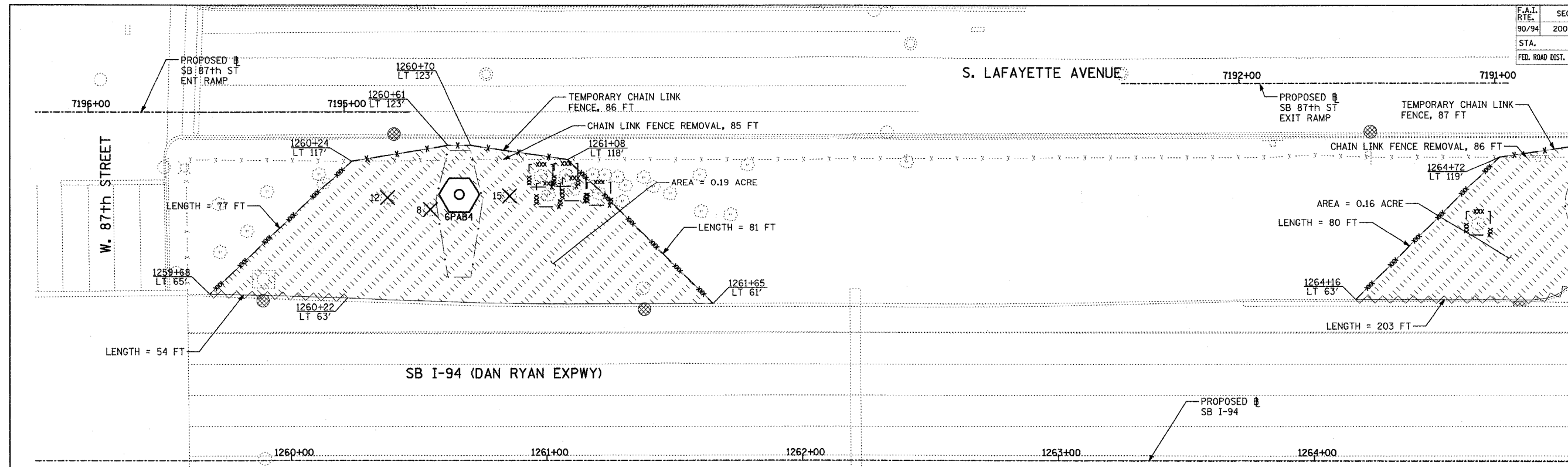

- LEGEND:**
- TEMPORARY EROSION CONTROL SEEDING
  - PERIMETER EROSION BARRIER
  - INLET FILTER, TO BE INSTALLED IN OFF PROJECT DRAINAGE STRUCTURES ACCEPTING STORMWATER RUNOFF
  - TEMPORARY FENCE (60' PER TREE)
  - LIMITS OF GRADING
  - TREE REMOVAL (UNIT) (NO UNIT SHOWN = <6)

REVISIONS	
NAME	DATE

ILLINOIS DEPARTMENT OF TRANSPORTATION  
 F.A.I. 90/94 (DAN RYAN EXPRESSWAY)  
 31st STREET TO I-57  
 EROSION CONTROL PLAN  
 SB 87th STREET EXIT RAMP  
 SB I-94 STA. 1259+00.00 TO 1271+00.00

SCALE: 1"=20'  
 DATE: OCTOBER 29, 2004  
 DRAWN BY: RTM, JPA  
 CHECKED BY: JPM, MAG

SHEET 24 OF 41

**TYLIN** INTERNATIONAL

10/29/2004 10:58:00 AM