

F.A.I. RTE.	SECTION	COUNTY	TOTAL SHEETS	SHEET NO.
90/94	2003-0311	COOK	476	480
STA.	TO STA.			
FED. ROAD DIST. NO.	ILLINOIS	FED. AID PROJECT	62583	

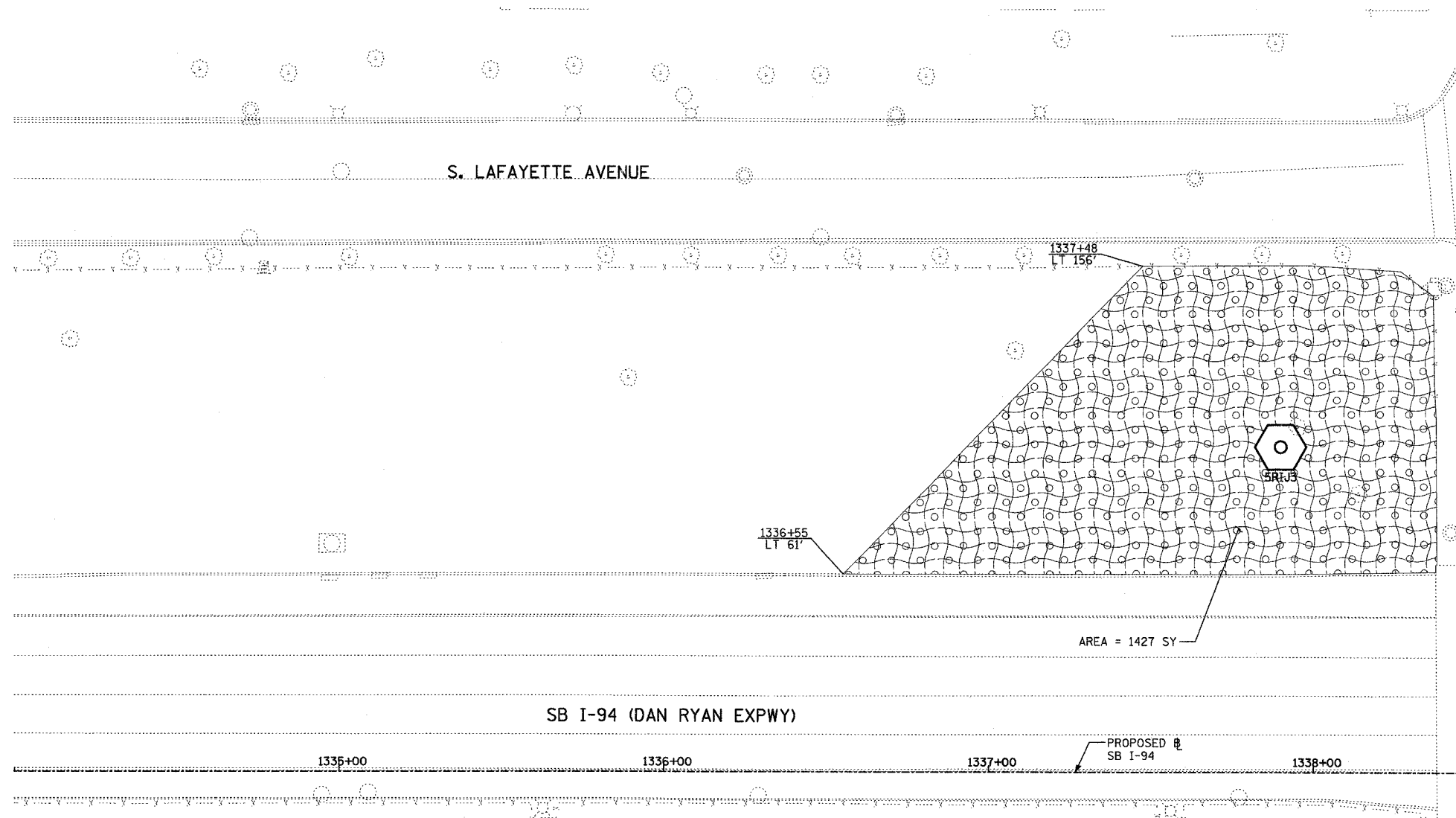
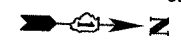

MATCHLINE SB STA. 1338+50.00

AREA = 1427 SY

SB I-94 (DAN RYAN EXPWY)

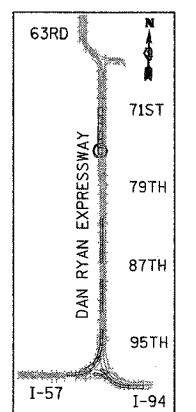

LOCATION MAP



SCALE: 1" = 20'-0"

TYLIN INTERNATIONAL

LEGEND:

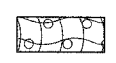

EROSION CONTROL BLANKET,
SEEDING, CLASS 2A, NITROGEN,
PHOSPHORUS, AND POTASSIUM
FERTILIZER NUTRIENTS,
TOPSOIL FURNISH AND PLACE, 4"

REVISIONS	
NAME	DATE

ILLINOIS DEPARTMENT OF TRANSPORTATION
F.A.I. 90/94 (DAN RYAN EXPRESSWAY)
31st STREET TO I-57
RESTORATION PLAN
SB I-94 (DAN RYAN EXPRESSWAY)
SB I-94 STA. 1334+00.00 TO 1338+50.00

SCALE: 1"=20'
DATE: OCTOBER 29, 2004

DRAWN BY: RTM, JPA
CHECKED BY: JPM, MAG

10/15/2004 04:04:32 PM