

PROFILE SURVEYED
 GRADES CHECKED
 ELEM. NOTED
 STRUCTURE NOTATIONS CHNG
 NO.

F.A.I. RTE.	SECTION	COUNTY	TOTAL SHEETS	SHEET NO.
90/94	2003-031I	COOK	976	496
STA. 2200+00.00		TO STA. 2362+00.00		
FED. ROAD DIST. NO.		ILLINOIS FED. AID PROJECT		
		62583		

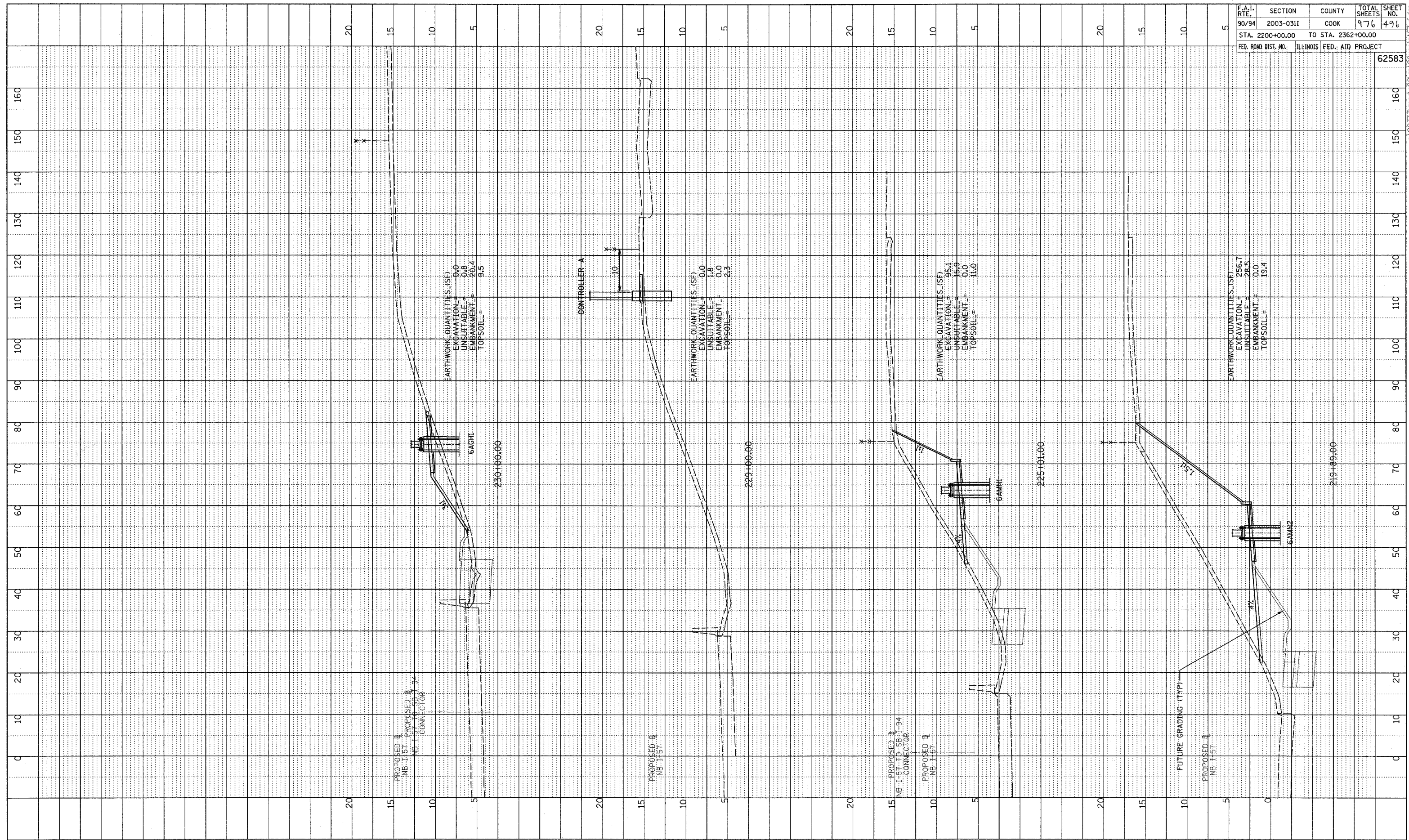

TYLIN INTERNATIONAL

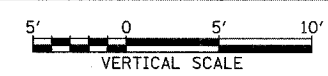
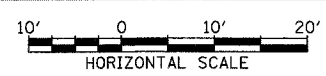

STA. 219+89 TO STA. 230+00
 NB I-57

P:\0237\3\road\c02\gpk02\ss\mb51_1.dgn