

PROF: ILL SURVEYED
 ILL. STATE HIGHWAY DEPT.
 GRADES CHECKED
 BEAM NOTED
 NO. STRUCTURE NOTATIONS CHFD

F.A.I. RTE.	SECTION	COUNTY	TOTAL SHEETS	SHEET NO.
90/94	2003-0311	COOK	976	501
STA. 2200+00.00 TO STA. 2362+00.00				
FED. ROAD DIST. NO.		ILLINOIS FED. AID PROJECT	62583	

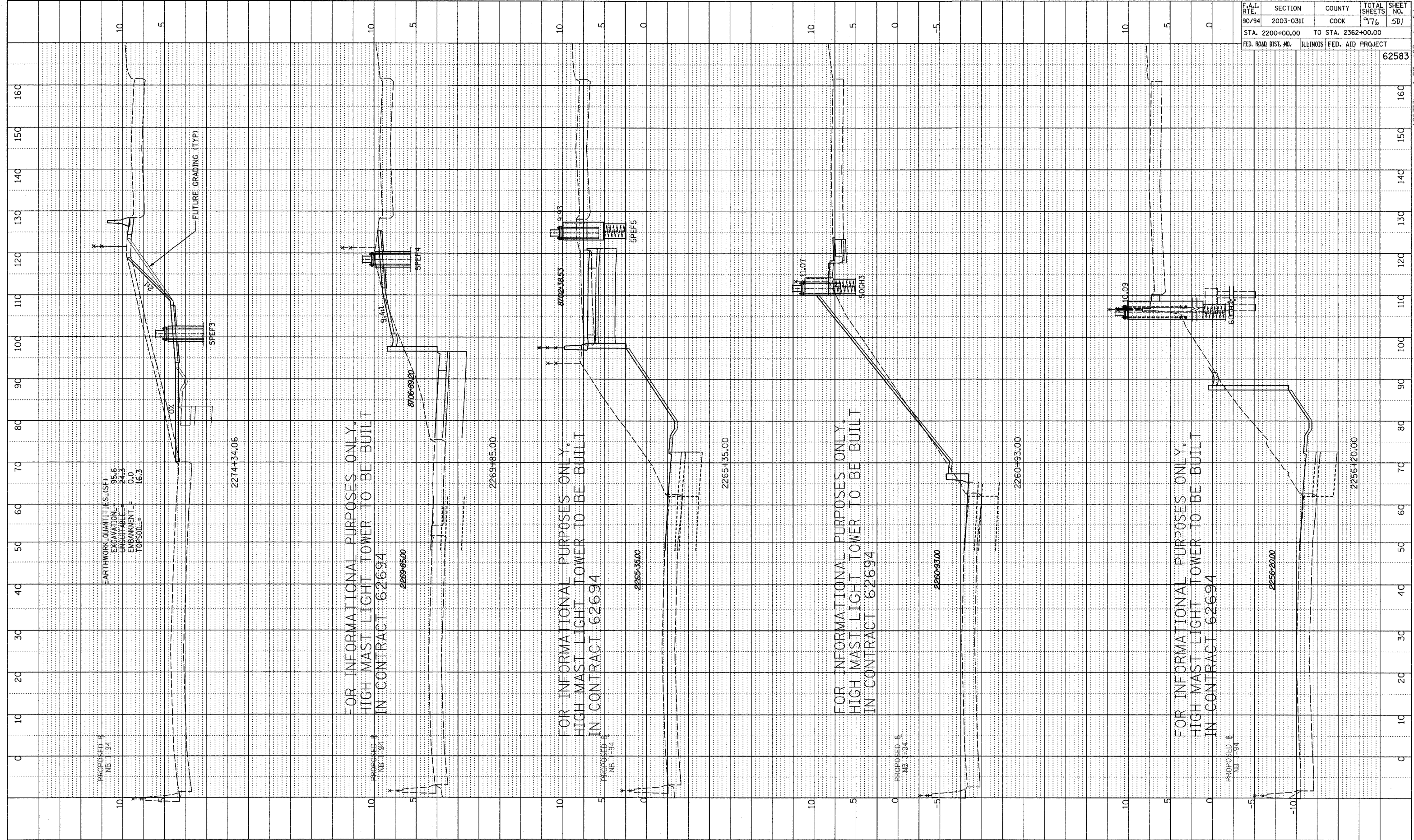

TYLIN INTERNATIONAL

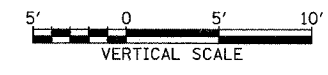
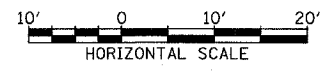

NB I-94 (DAN RYAN EXPRESSWAY)
 STA. 2256+20 TO 2274+34.06

PA02313\road\02\gpk02\ssshp_1.dgn