

PROFILE
 SURVEYED
 GRADES CHECKED
 NOTE BOOK
 NO.

F.A.I. RTE.	SECTION	COUNTY	TOTAL SHEETS	SHEET NO.
90/94	2003-0311	COOK	976	502
STA. 2200+00.00 TO STA. 2362+00.00		ILLINOIS FED. AID PROJECT		
FED. ROAD DIST. NO.		62583		

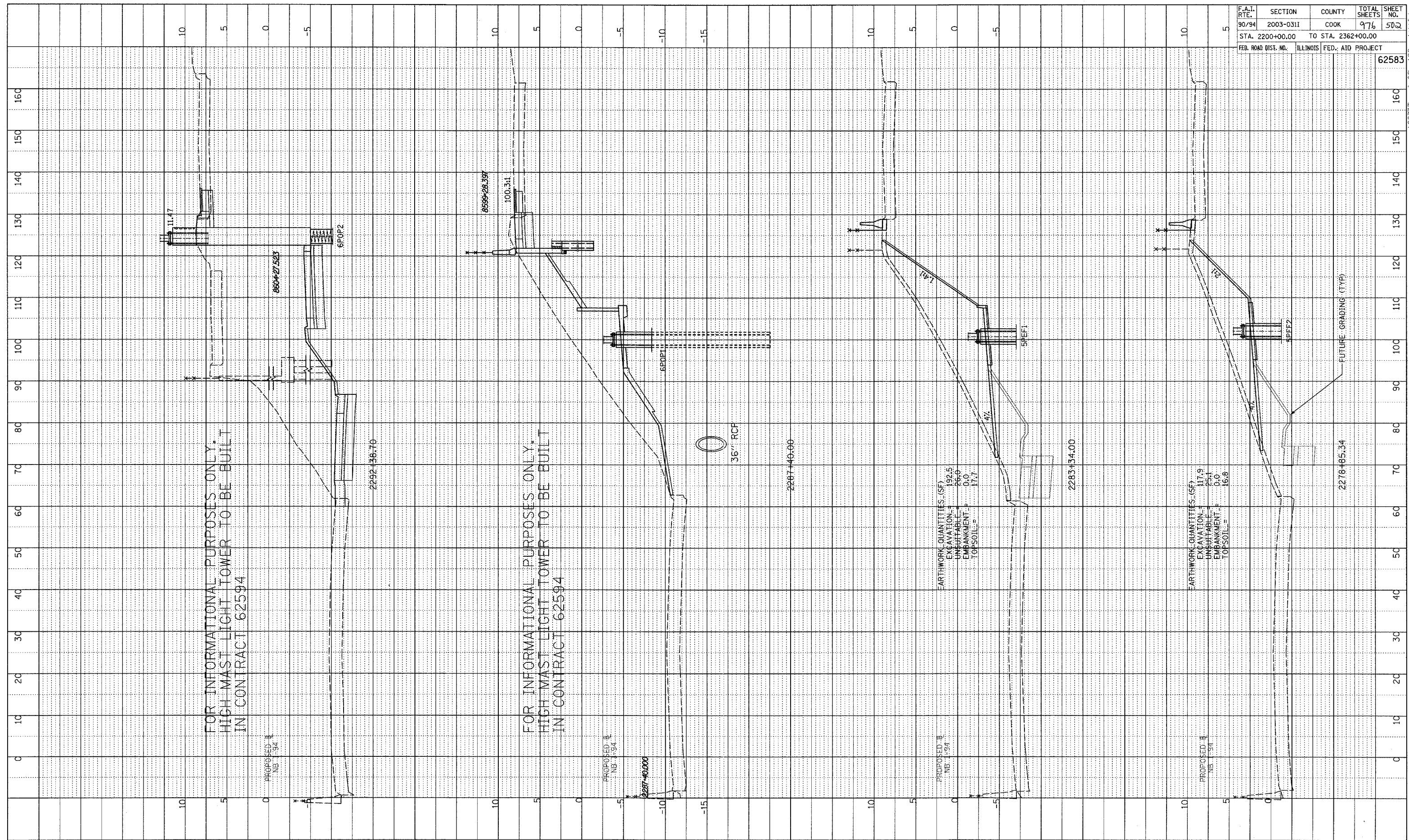

TYLIN INTERNATIONAL

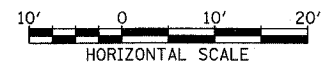

NB I-94 (DAN RYAN EXPRESSWAY)
 STA. 2278+85.34 TO 2292+38.70

I:\0231\3\road\02\gpk02\ss\hpb-1.dgn