

PROFILE SURVEYER
 NOTE BOOK NO. _____
 GRADES CHECKED BY: _____
 STRUCTURE NOTATIONS: _____

F.A.I. RTE.	SECTION	COUNTY	TOTAL SHEETS	SHEET NO.
90/94	2003-0311	COOK	976	572
STA. 2200+00.00 TO STA. 2362+00.00		FED. ROAD DIST. NO. ILLINOIS FED. AID PROJECT		
				62583

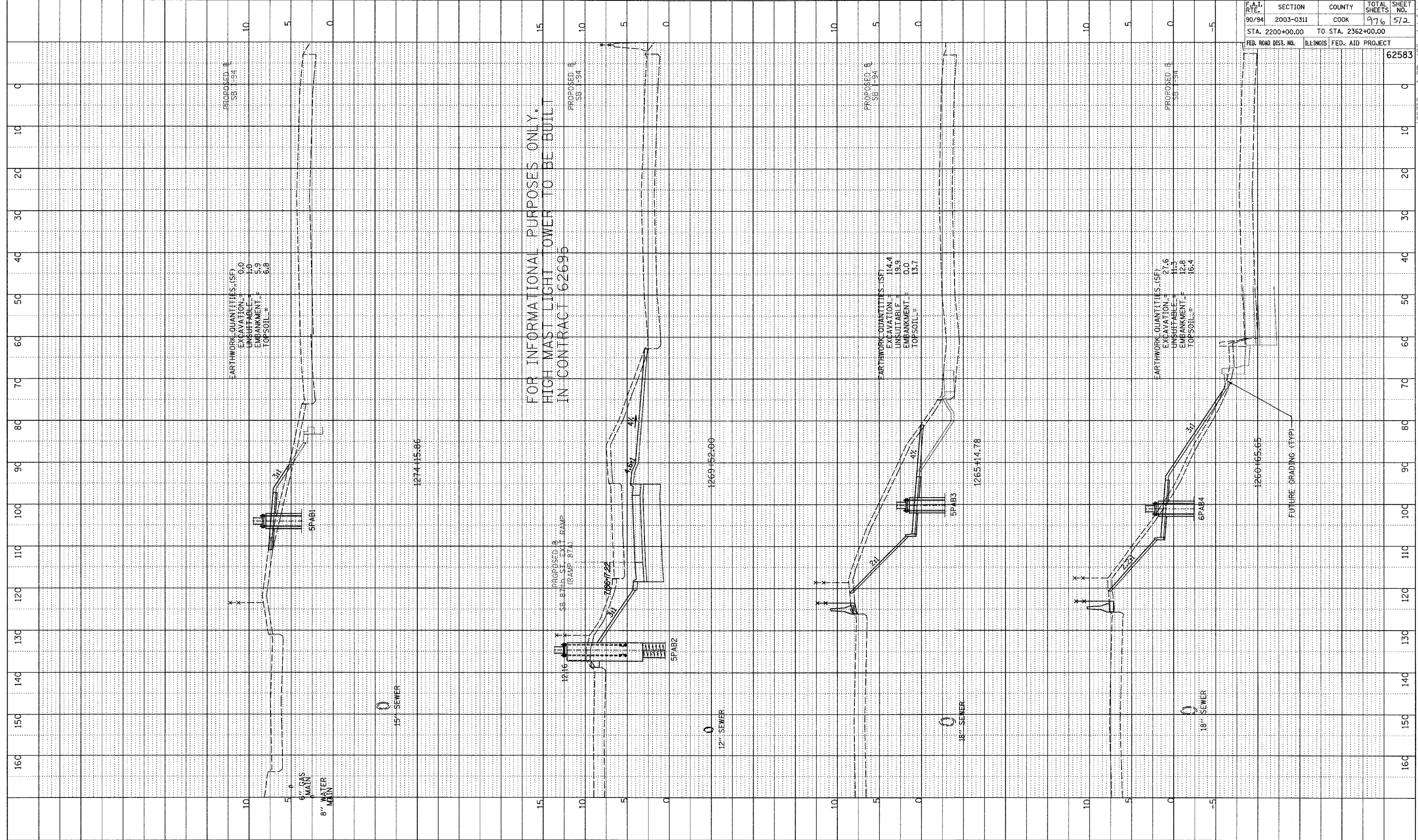

TYLIN INTERNATIONAL

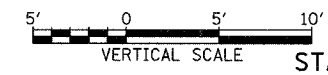
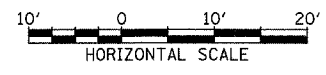

SB I-94 (DAN RYAN EXPRESSWAY)
 STA. 1260+65.65 TO STA. 1274+15.86

PA:02373yroad\02\p02\02\sshsb.f.dgn