

SURVEYED
 CHECKED
 GRADES CHECKED
 NOTE BOOK
 E.M. NOTED
 NO. STRUCTURE NOTATIONS CIPFD

F.A.I. RTE.	SECTION	COUNTY	TOTAL SHEETS	SHEET NO.
90/94	2003-0311	COOK	976	513
STA. 2200+00.00		TO STA. 2362+00.00		
FED. ROAD DIST. NO.	ILLINOIS FED. AID PROJECT		62583	

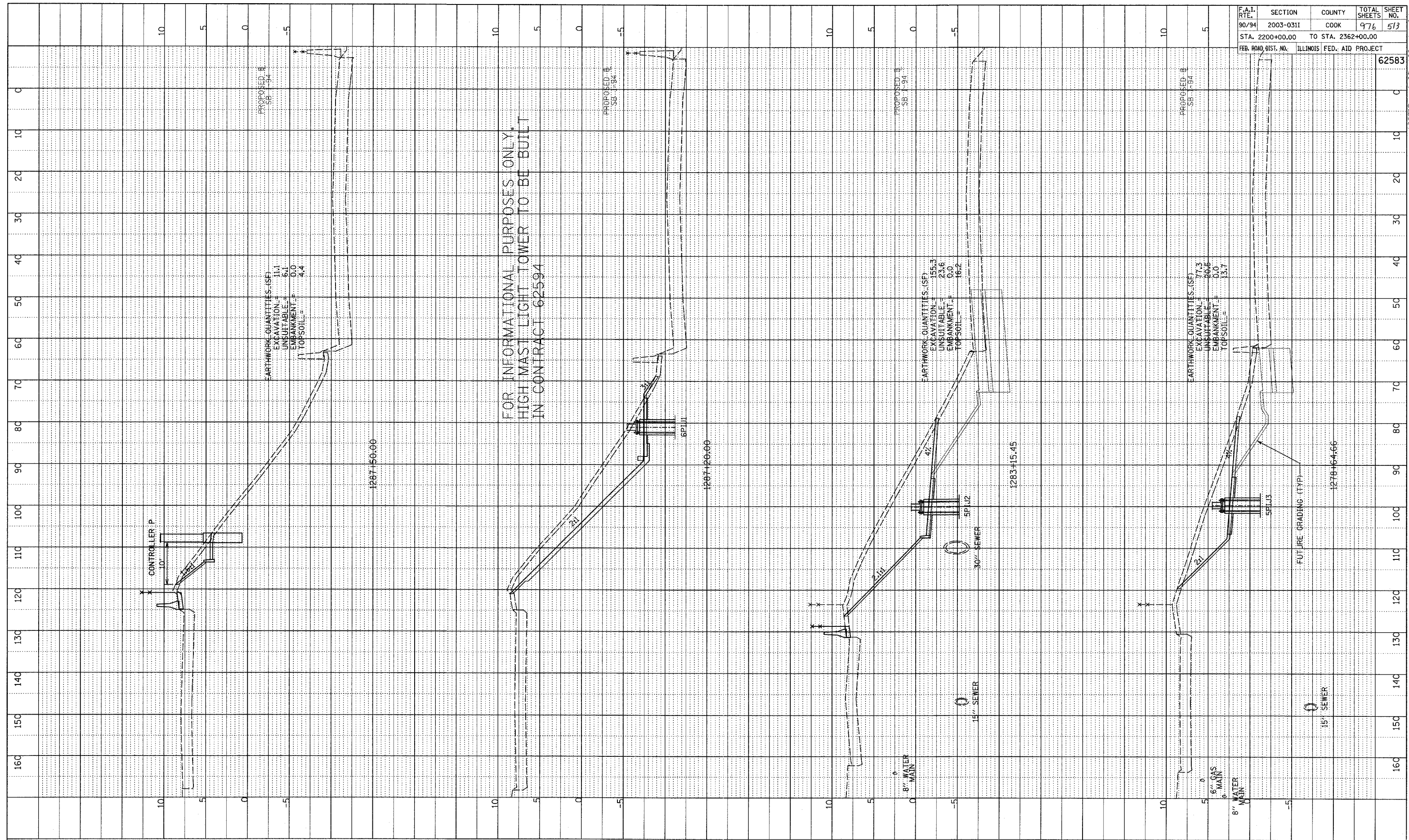

TYLIN INTERNATIONAL

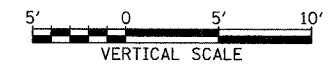
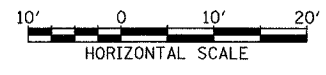

SB I-94 (DAN RYAN EXPRESSWAY)
 STA. 1278+64.66 TO STA. 1287+50

P:\2027\3\road\602\gpk02\sshsb_1.dgn