

PROFILE SURVEYED
 GRADES CHECKED
 ELEV. NOTED
 STRUCTURE NOTATIONS COR'D

F.A.I. RTE.	SECTION	COUNTY	TOTAL SHEETS	SHEET NO.
90/94	2003-031I	COOK	976	529
STA. 2200+00.00 TO STA. 2362+00.00		519		
FED. ROAD DIST. NO.		ILLINOIS FED. AID PROJECT		62583

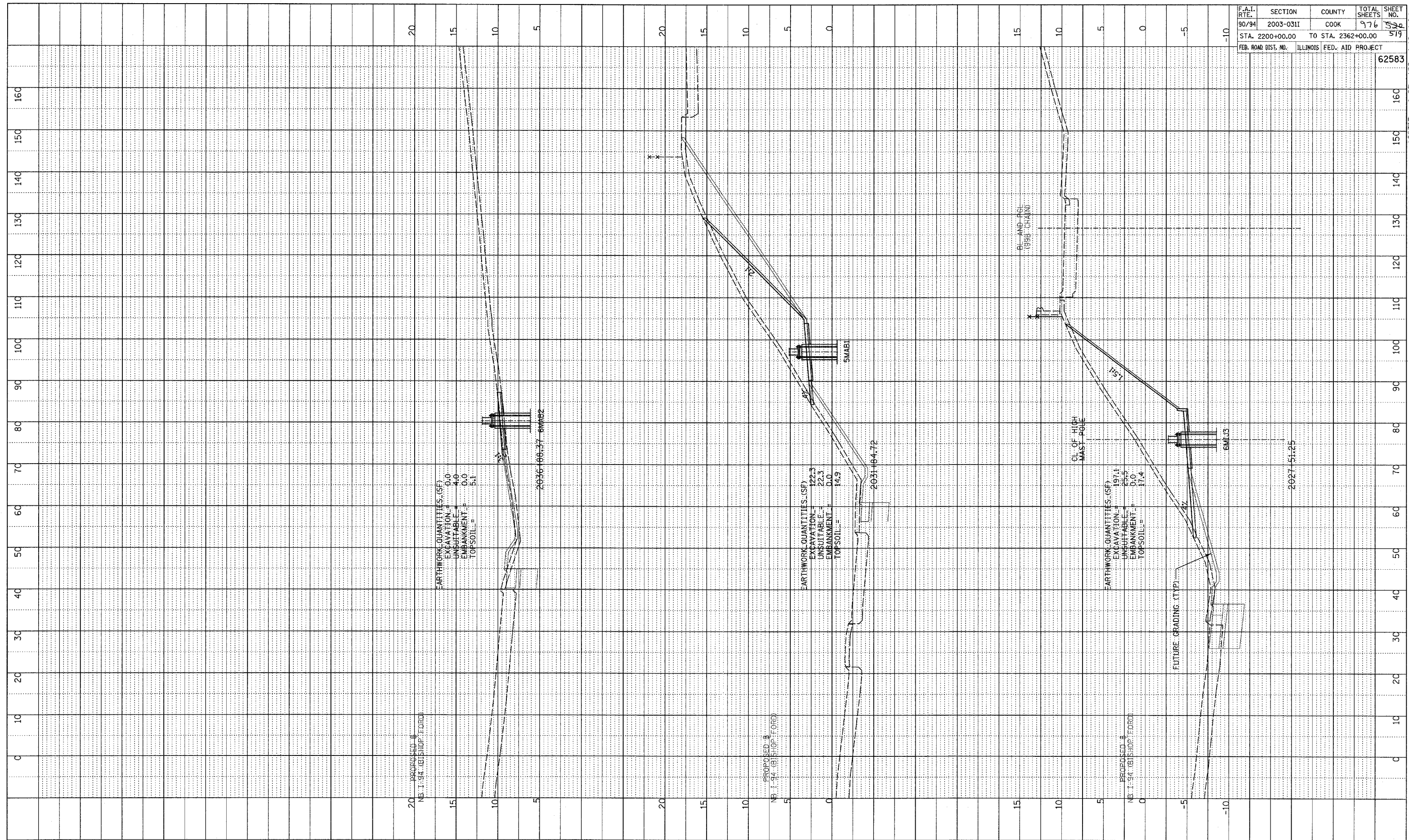

TYLIN INTERNATIONAL

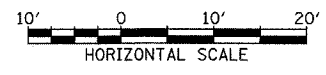

NB I-94 (BISHOP FORD FREEWAY)
 STA. 2027+51.25 TO STA. 2036+88.37

P:\0231\Road\02\gpk02\assembly\ord_1.dgn