

SURVEYED  
 GRADES CHECKED  
 B.M. NOTED  
 STRUCTURE NOTATIONS CIPRO  
 NOTE BOOK NO.

F.A.I. RTE.	SECTION	COUNTY	TOTAL SHEETS	SHEET NO.
90/94	2003-0311	COOK	976	523
STA. 2200+00.00 TO STA. 2362+00.00		ILLINOIS FED. AID PROJECT		
FED. ROAD DIST. NO.		62583		

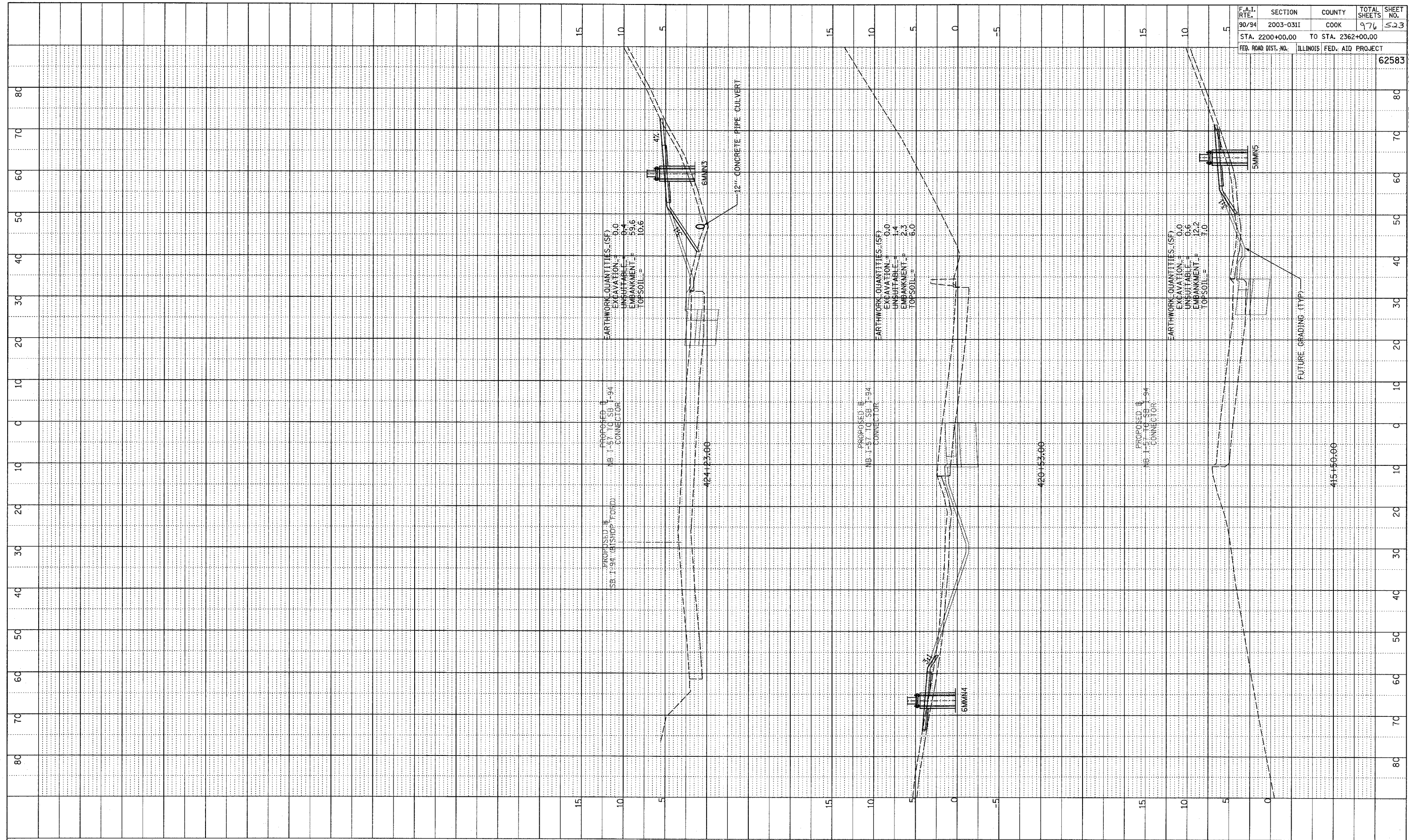

TYLIN INTERNATIONAL

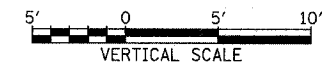
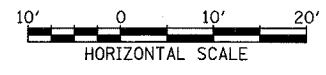

NB I-57 TO SB I-94 CONNECTOR  
 STA. 415+50 TO STA. 424+23

P:\023731\road\002\gpk02\ss\repx\_1.dgn