

SECTION	COUNTY	TOTAL SHEETS	SHEET NO.
2003-03II	COOK	976	802
STA. 1506+50 TO STA. 1518+00			
FED. ROAD DIST. NO.	ILLINOIS FED. AID PROJECT		
62583			

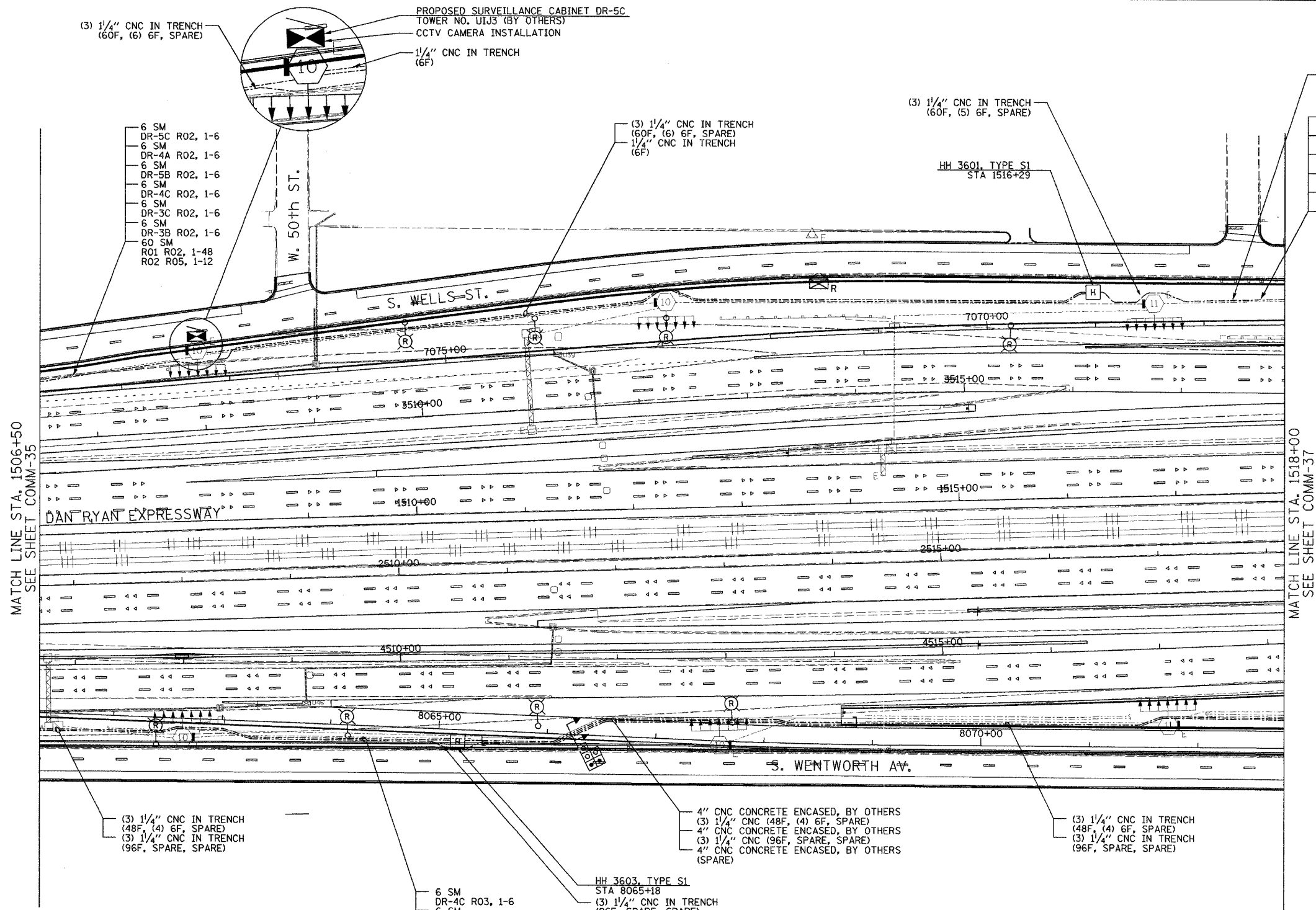

PROPOSED SURVEILLANCE CABINET DR-5C  
TOWER NO. U1J3 (BY OTHERS)  
CCTV CAMERA INSTALLATION

(3) 1/4" CNC IN TRENCH  
(60F, (6) 6F, SPARE)

6 SM  
DR-5C R02, 1-6  
6 SM  
DR-4A R02, 1-6  
6 SM  
DR-5B R02, 1-6  
6 SM  
DR-4C R02, 1-6  
6 SM  
DR-3C R02, 1-6  
6 SM  
DR-3B R02, 1-6  
60 SM  
R01 R02, 1-48  
R02 R05, 1-12

(3) 1/4" CNC IN TRENCH  
(60F, (6) 6F, SPARE)  
1/4" CNC IN TRENCH  
(6F)

(3) 1/4" CNC IN TRENCH  
(60F, (5) 6F, SPARE)

(3) 1/4" CNC IN TRENCH  
(60F, (5) 6F, SPARE)

6 SM  
DR-4A R02, 1-6  
6 SM  
DR-5B R02, 1-6  
6 SM  
DR-4C R02, 1-6  
6 SM  
DR-3C R02, 1-6  
6 SM  
DR-3B R02, 1-6  
60 SM  
R01 R02, 1-48  
R02 R05, 1-12

MATCH LINE STA. 1506+50  
SEE SHEET COMM-35

MATCH LINE STA. 1518+00  
SEE SHEET COMM-37

(3) 1/4" CNC IN TRENCH  
(48F, (4) 6F, SPARE)  
(3) 1/4" CNC IN TRENCH  
(96F, SPARE, SPARE)

4" CNC CONCRETE ENCASED, BY OTHERS  
(3) 1/4" CNC (48F, (4) 6F, SPARE)  
4" CNC CONCRETE ENCASED, BY OTHERS  
(3) 1/4" CNC (96F, SPARE, SPARE)  
4" CNC CONCRETE ENCASED, BY OTHERS  
(SPARE)

(3) 1/4" CNC IN TRENCH  
(48F, (4) 6F, SPARE)  
(3) 1/4" CNC IN TRENCH  
(96F, SPARE, SPARE)

6 SM  
DR-4C R03, 1-6  
6 SM  
DR-2B R03, 1-6  
6 SM  
DR-4B R03, 1-6  
6 SM  
DR-3D R03, 1-6  
48 SM  
R01 R03, 1-48  
96 SM  
R01 R03, 1-96

HH 3603, TYPE S1  
STA 8065+18  
(3) 1/4" CNC IN TRENCH  
(96F, SPARE, SPARE)

NOTES:

- SEE DRAWING ME-01 AND ME-02 FOR ELECTRICAL SYSTEMS AND ABBREVIATIONS.
- UNLESS OTHERWISE STATED, ALL NOTED CABLE AND CONDUIT TO BE FURNISHED AND INSTALLED UNDER THIS CONTRACT.
- TRENCHED CONDUITS INSTALLED IN PARALLEL ARE TO BE INSTALLED IN COMMON TRENCH.
- THIS SHEET ONLY DEPICTS INSTALLATION OF COMMUNICATIONS ELEMENTS. REFER TO SHEETS FOR OTHER SUBSYSTEMS FOR ADDITIONAL ELEMENTS IN THE AREA SHOWN.
- CONTRACTOR TO ROD AND CLEAN EXISTING CONDUITS PRIOR TO INSTALLING AND PULLING INNERDUCTS AND CABLES IN CONDUITS.
- COMMUNICATIONS CONDUIT SHALL NOT BE INSTALLED IN ELECTRIC HANDHOLES (SEE DETAIL SHEET DT-45).
- FOR HANDHOLE DETAILS, SEE SHEET DT-44 AND DT-46.

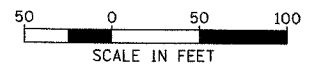

SCALE IN FEET COMM-36

REVISIONS	
NAME	DATE

ILLINOIS DEPARTMENT OF TRANSPORTATION  
F.A.I. 94/90 (DAN RYAN EXPRESSWAY)  
31st STREET TO I-57

COMMUNICATIONS BACKBONE CONDUIT  
AND CABLE LAYOUT

SCALE: 1"=50'  
DATE: October 29, 2004

DRAWN BY: DHI  
CHECKED BY: BA

**Edwards  
AND  
Kelcey**

ONE NORTH FRANKLIN  
CHICAGO, IL 60606  
PHONE: (312) 251-3000  
FAX: (312) 251-3015  
WEB: WWW.EKCORP.COM

10/14/2004 04:13:38 PM