

SECTION	COUNTY	TOTAL SHEETS	SHEET NO.
2003-0311	COOK	976	851
STA.	TO STA.		
FED. ROAD DIST. NO.	ILLINOIS	FED. AID PROJECT	
62583			

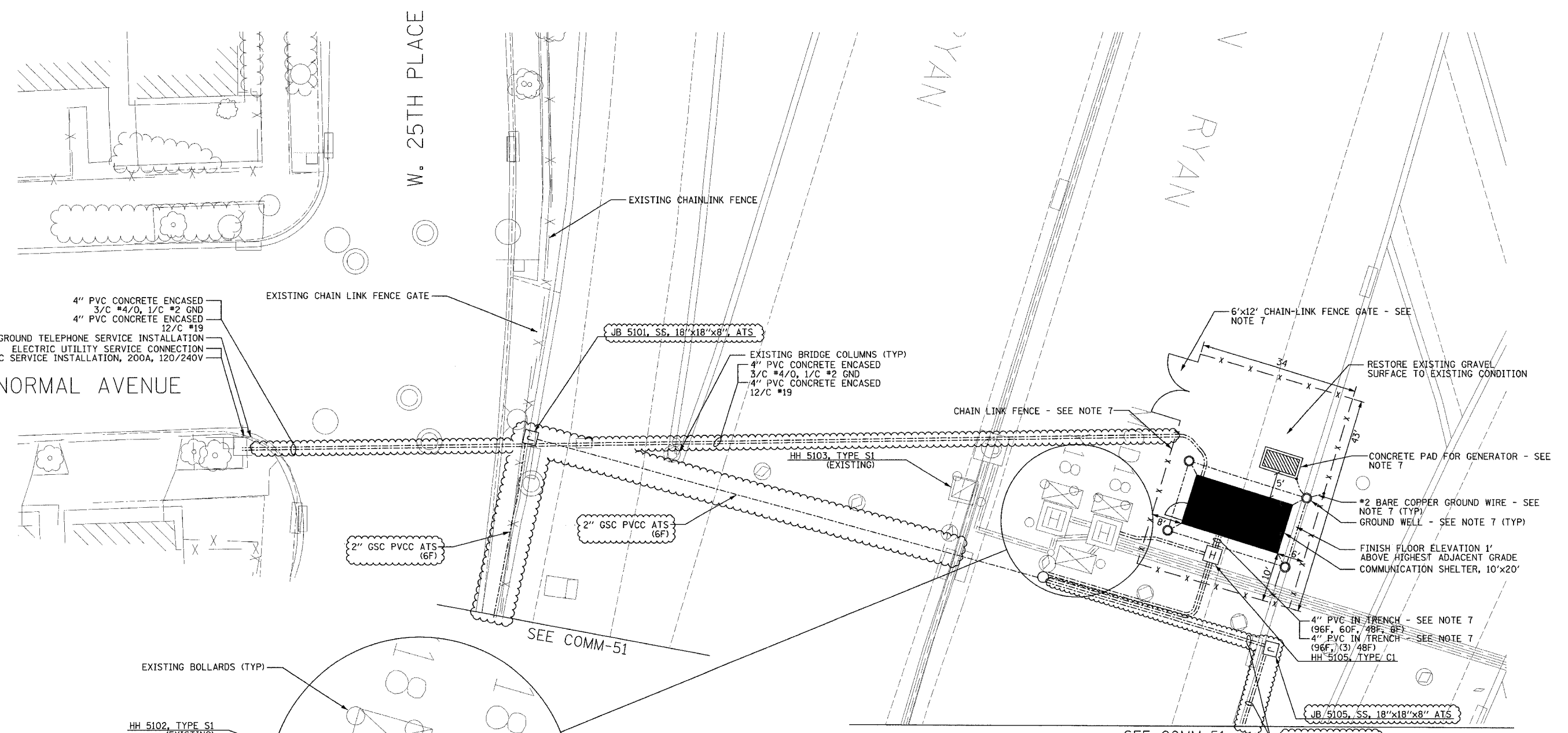

- NOTES:**
- UNLESS OTHERWISE NOTED, ALL NOTED CONDUIT AND CABLE TO BE INSTALLED UNDER THIS CONTRACT.
  - SHELTER INSTALLED AT GRADE UNDERNEATH EXISTING DAN RYAN BRIDGE STRUCTURE.
  - FOR SHELTER FENCE AND GROUND DETAILS, SEE SHEET COMM-93 AND COMM-94.
  - FOR SHELTER FOUNDATION AND CONDUIT ENTRANCE DETAILS, SEE SHEET COMM-91 AND COMM-92.
  - FOR SHELTER EQUIPMENT AND ELECTRICAL LAYOUT DETAILS, SEE SHEET COMM-86.
  - FOR ELECTRIC SERVICE INSTALLATION DETAILS, SEE SHEET ESD-01.
  - WORK MATERIALS PAID FOR AS PART OF SHELTER.
  - CONDUIT TO BE INSTALLED ATTACHED TO EXISTING BRIDGE PIER WITH A MINIMUM BENDING RADIUS OF 24" AT EITHER END. SEE DETAIL ME-07C FOR CLAMP DETAIL.
  - SEE SHEET DT-52 FOR ATTACHED CONDUIT AND JUNCTION BOX INSTALLATION DETAILS.
  - PAVEMENT AND SIDEWALK REPLACEMENT SHALL BE CONSIDERED INCLUDED IN THE COST OF THE CONCRETE ENCASED CONDUIT INSTALLATION.

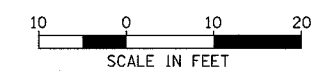

COMM-85

REVISIONS	
NAME	DATE
REVISION 1	12/17/04

ILLINOIS DEPARTMENT OF TRANSPORTATION  
F.A.I. 94/90 (DAN RYAN EXPRESSWAY)  
31st STREET to I-57

I-55 SHELTER (R01)  
SITE PLAN

SCALE: 1"=10'  
DATE: October 29, 2004

DRAWN BY: DHI  
CHECKED BY: MJL

**Edwards AND Kelcey**

ONE NORTH FRANKLIN  
CHICAGO, IL 60606  
PHONE: (312) 251-3000  
FAX: (312) 251-3015  
WEB: WWW.EDKORP.COM

P:\0300190.95\15e\road\pp0200328e.rvt 12/15/2004 01:51:01 PM