

FAP RTE.	SECTION	COUNTY	TOTAL SHEETS	SHEET NO.
866	1181	LAKE	17	17
STA.		TO STA.		
FED. ROAD DIST. NO. - ILLINOIS FED. AID PROJECT				

CONTRACT NO.: 62606

**ROUTE MARKERS**

FOR U.S. ROUTES MI-40-2424

FOR ILLINOIS ROUTES MI-50-2424

R.R. UNMARKED ROUTES SPECIAL 24" x 18" VARIABLE 4" BLACK LETTERS ON WHITE REFLECTIVE BACKGROUND

**ARROWS SIGNS**

M5-1L-2115

M5-1R-2115

M6-1L-2115

M6-1R-2115

M6-3-2115

**CARDINAL DIRECTION & DETOUR SIGNS**

NORTH M3-1-219

EAST M3-2-219

SOUTH M3-3-219

WEST M3-4-219

DETOUR M1-7-219

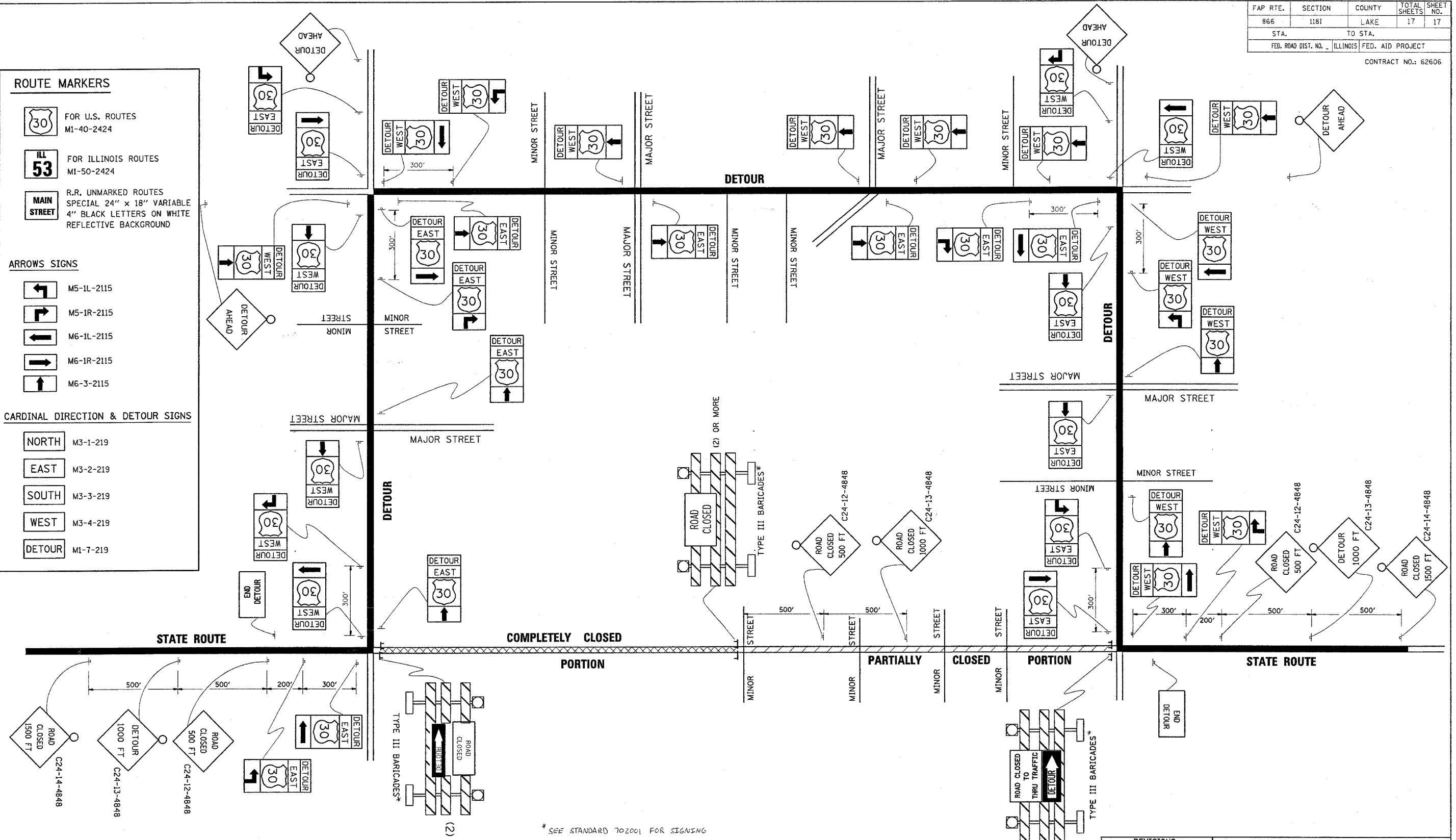

\* SEE STANDARD 702001 FOR SIGNING

REVISIONS	
NAME	DATE

ILLINOIS DEPARTMENT OF TRANSPORTATION

**TYPICAL MARKING FOR CLOSING STATE HIGHWAYS**

SCALE: NONE

DATE: 12/30/2004

DRAWN BY

CHECKED BY

TC-21

REVISION DATE: