

F.A.U. RTE.	SECTION	COUNTY	TOTAL SHEETS	SHEET NO.
1504	0104 RS-3	COOK	28	8
STA. 112+00		TO STA. 124+44.8		
FED. ROAD DIST. NO. 1		ILLINOIS FED. AID PROJECT		

CONTRACT NO. 62716

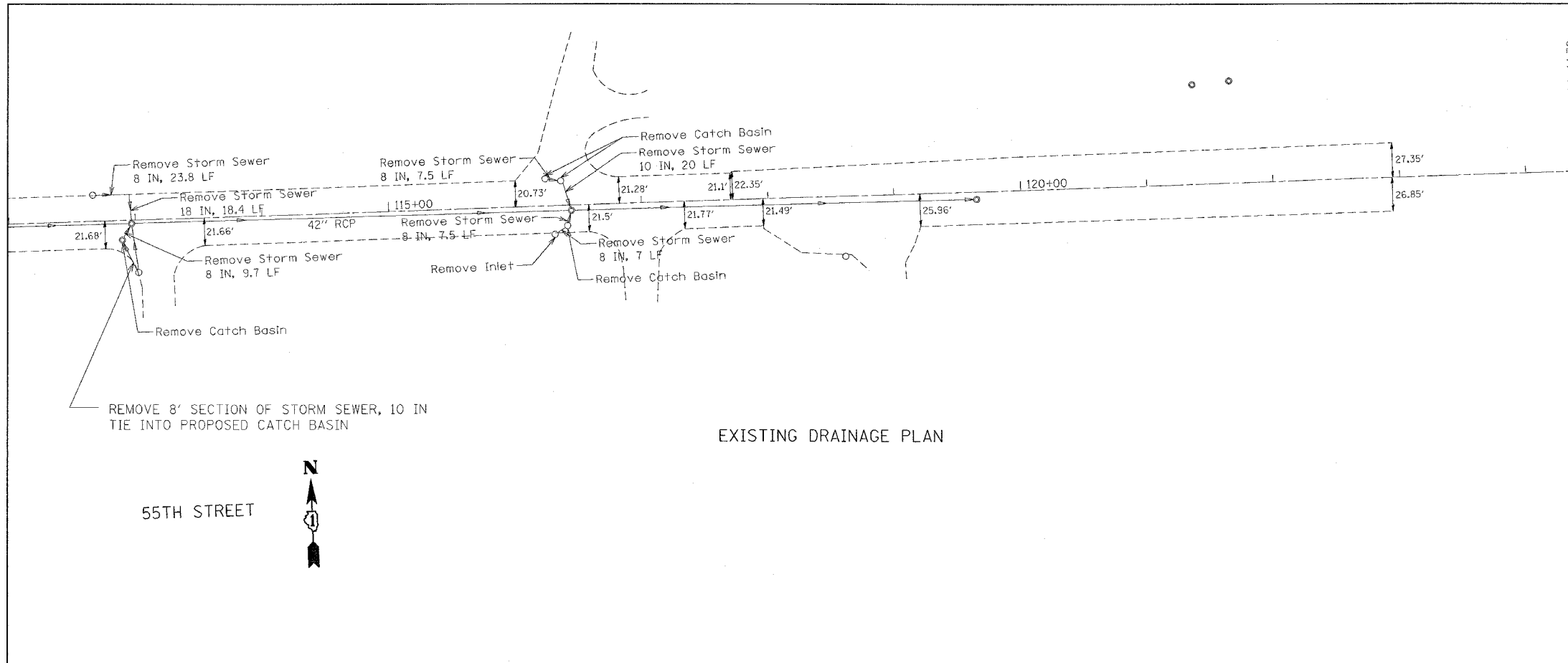

EXISTING DRAINAGE PLAN

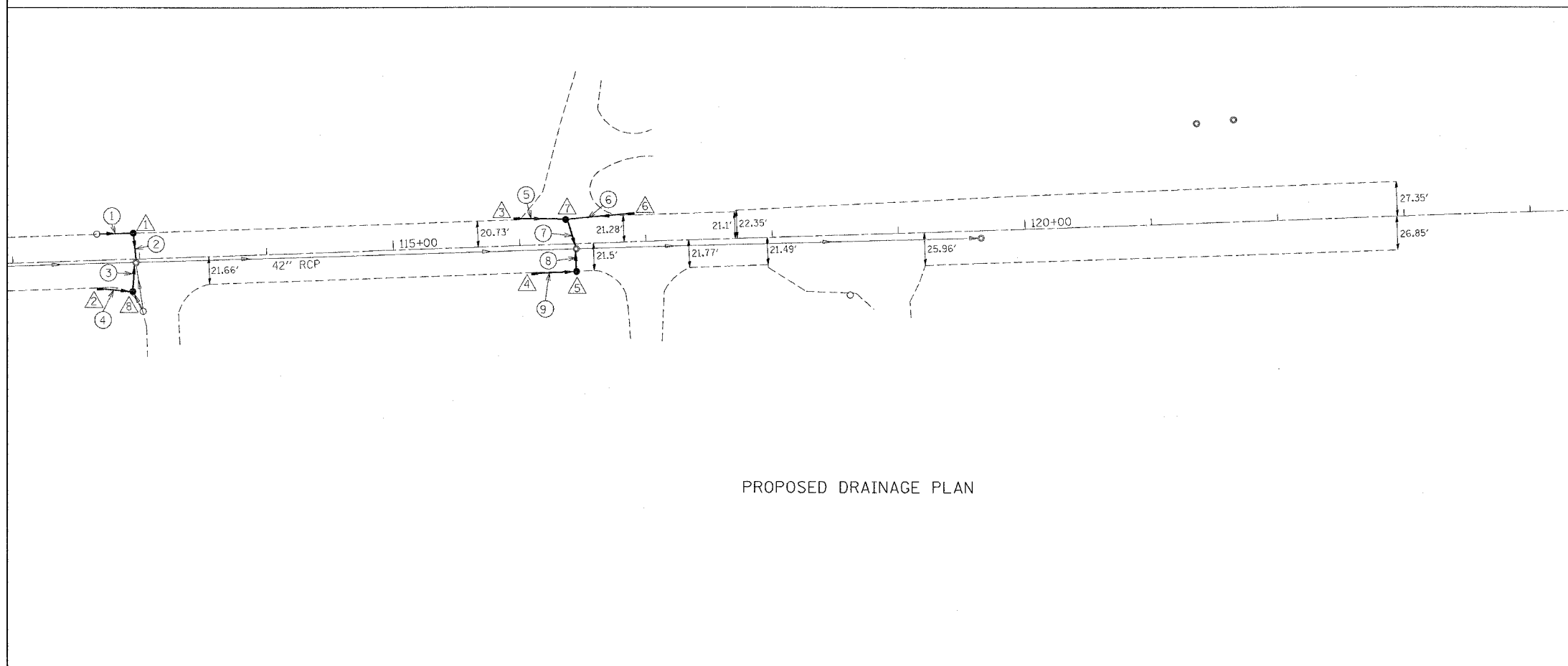

PROPOSED DRAINAGE PLAN

PROPOSED DRAINAGE PIPE TABLE

No.	Di.	Length	Slope
1	Proposed Storm Sewer Class A Type I	12	21.6
2	Proposed Storm Sewer Class A Type II	12	21.6
3	Proposed Storm Sewer Class A Type II	12	21.6
4	Proposed Storm Sewer Class A Type I	12	20.6
5	Proposed Storm Sewer Class A Type I	12	20.6
6	Proposed Storm Sewer Class A Type I	12	21.5
7	Proposed Storm Sewer Class A Type II	18	21
8	Proposed Storm Sewer Class A Type II	15	21.8
9	Proposed Storm Sewer Class A Type I	12	22.2

* Match Existing Slope

PROPOSED DRAINAGE STRUCTURE TABLE

1	STA 112+97.1 LT. EOP Catch Basin Type A, 4' Dia w/Type 24 Frame and Grate D/W: 8' TSD in the Field S Match Existing	5	STA 116+44.3 RT. EOP Catch Basin Type A, 4' Dia w/Type 24 Frame and Grate D/W: 8' TSD in the Field (should be approx. 3'-4')
2	STA 112+65.7 RT. EOP Inlet Type A w/ Type 24 Frame and Grate D/W: 7SD in the Field (should be approx. 3'-4')	6	STA 116+82.2 LT. EOP Inlet Type A w/ Type 24 Frame and Grate D/W: 7SD in the Field (should be approx. 3'-4')
3	STA 115+90 LT. EOP Inlet Type A w/ Type 24 Frame and Grate D/W: 7SD in the Field (should be approx. 3'-4')	7	STA 116+37 LT. EOP Catch Basin Type A, 4' Dia w/Type 1 Frame, Open D/W: 6' TSD in the Field S Match Existing
4	STA 115+80 RT. EOP Inlet Type A w/ Type 24 Frame and Grate D/W: 7SD in the Field (should be approx. 3'-4')	8	STA 112+82.6 RT. EOP Catch Basin Type A, 4' Dia w/Type 24 Frame and Grate D/W: 6' TSD in the Field S Match Existing

REVISIONS	
NAME	DATE

ILLINOIS DEPARTMENT OF TRANSPORTATION

55TH STREET
EXISTING DRAINAGE PLAN
PROPOSED DRAINAGE PLAN

SCALE: VERT. 50
HORIZ. 50
DATE 9/16/2004

DRAWN BY ELG
CHECKED BY CJM

14:13:28 09/16/2004