

F.A.U. RTE.	SECTION	COUNTY	TOTAL SHEETS	SHEET NO.
1504	0104 RS-3	COOK	28	12
STA. 170+00		TO STA. 185+00		
FED. ROAD DIST. NO. 1		ILLINOIS FED. AID PROJECT		

CONTRACT NO. 62716

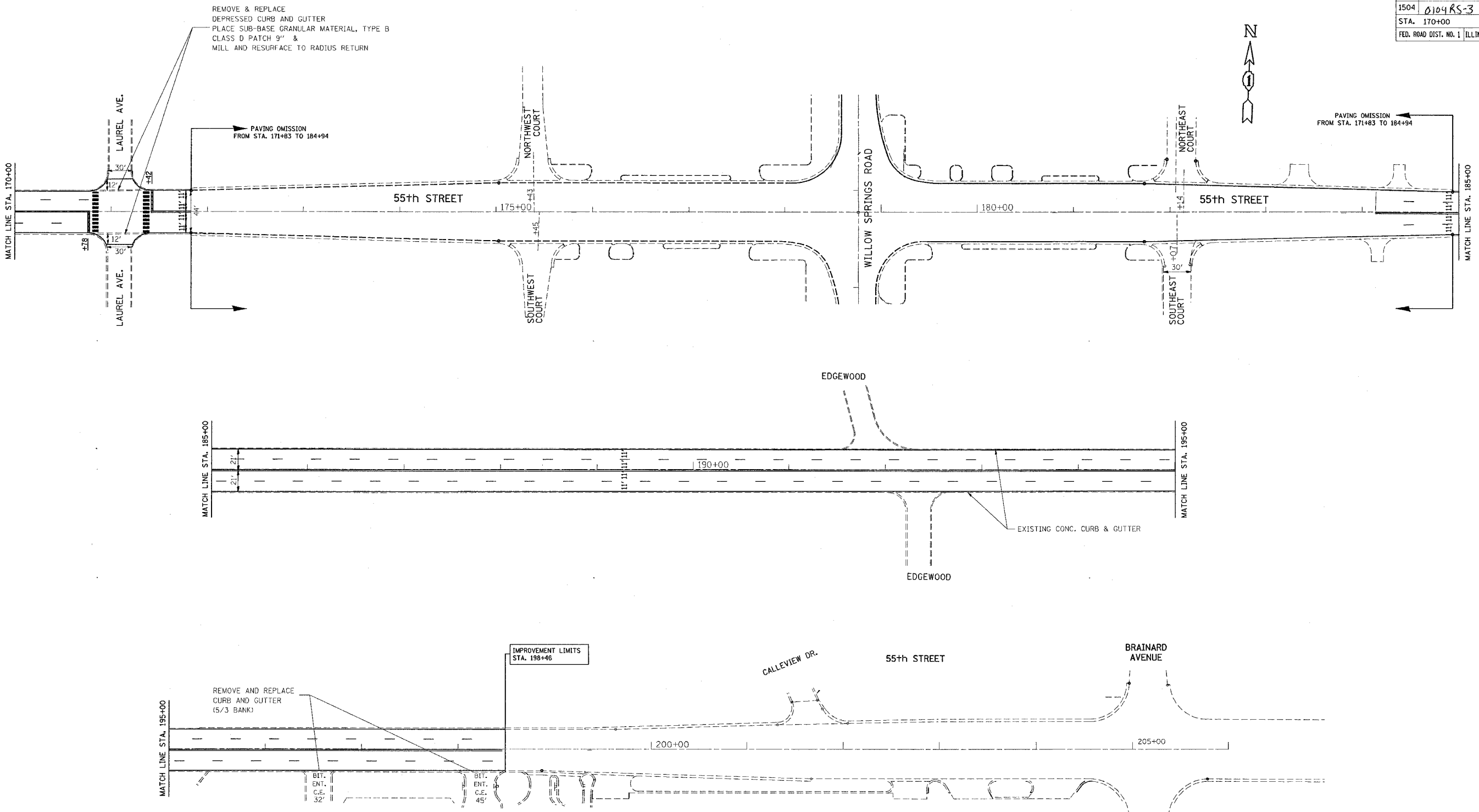

REMOVE & REPLACE
DEPRESSED CURB AND GUTTER
PLACE SUB-BASE GRANULAR MATERIAL, TYPE B
CLASS D PATCH 9" &
MILL AND RESURFACE TO RADIUS RETURN

PAVING OMISSION
FROM STA. 171+83 TO 184+94

PAVING OMISSION
FROM STA. 171+83 TO 184+94

MATCH LINE STA. 185+00

MATCH LINE STA. 195+00

EXISTING CONC. CURB & GUTTER

IMPROVEMENT LIMITS
STA. 198+46

REMOVE AND REPLACE
CURB AND GUTTER
(5/3 BANK)

BIT.
ENT.
C.E.
32'

BIT.
ENT.
C.E.
45'

NOTE:

ALL RAISED REFLECTIVE PAVEMENT MARKERS SHALL BE INSTALLED USING TC-11

REVISIONS	
NAME	DATE

ILLINOIS DEPARTMENT OF TRANSPORTATION
55TH ST.
COUNTY LINE RD TO BRAINARD AVE
PAVEMENT MARKING AND PLAN SHEET

SCALE: VERT. NONE
HORIZ.
DATE 12/22/2004
DRAWN BY S.E.S.
CHECKED BY