

SECTION	COUNTY	TOTAL SHEETS	SHEET NO.
VAR 0104RS-3	COOK	28	15
STA. TO STA.		# 12716	
FED. ROAD DIST. NO. 7		ILLINOIS	
FED. AID PROJECT			

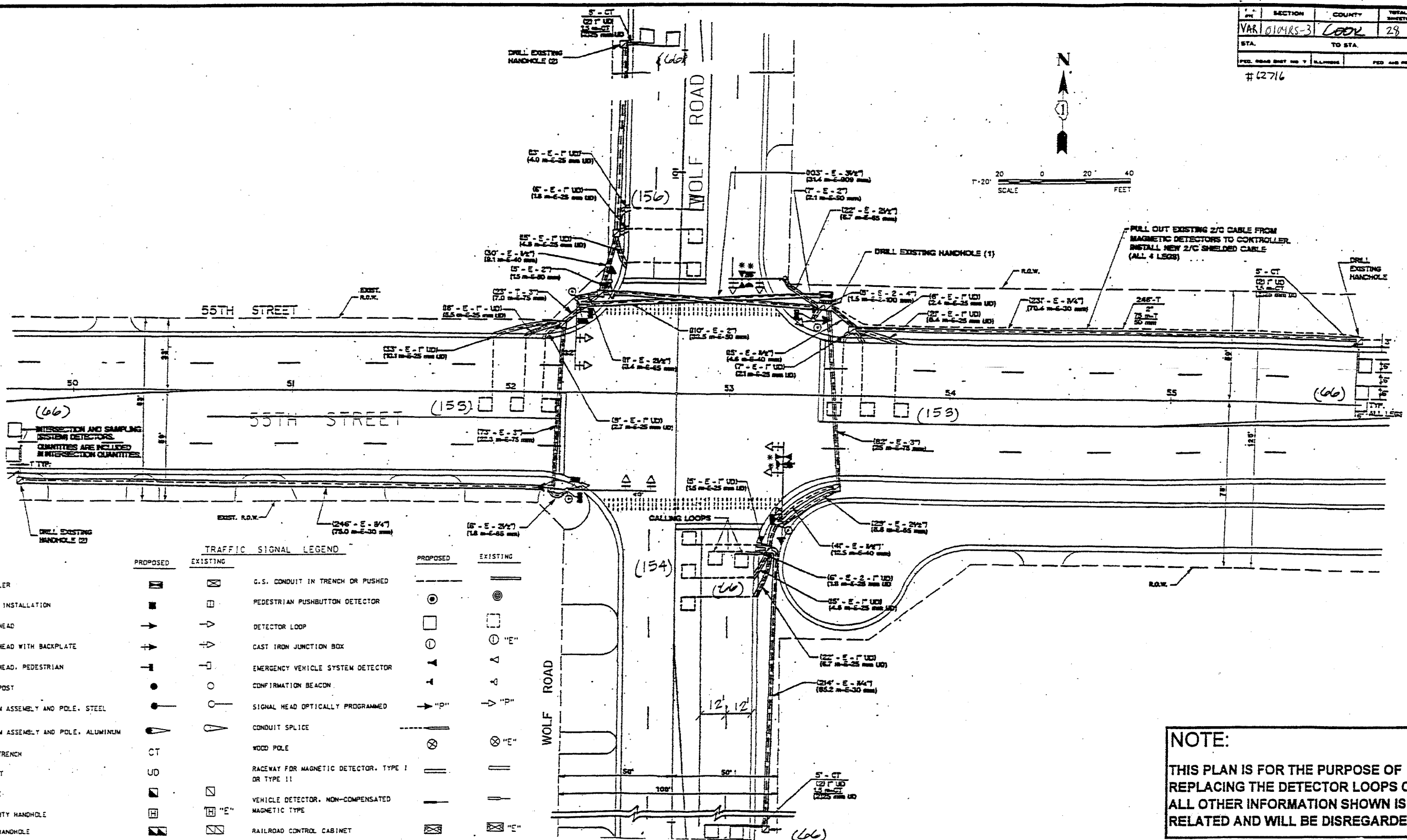
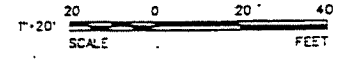

(66)
INTERSECTION AND SAMPLING SYSTEM DETECTORS. QUANTITIES ARE INCLUDED IN INTERSECTION QUANTITIES.

TRAFFIC SIGNAL LEGEND

PROPOSED		EXISTING	
	CONTROLLER		G.S. CONDUIT IN TRENCH OR PUSHED
	SERVICE INSTALLATION		PEDESTRIAN PUSHBUTTON DETECTOR
	SIGNAL HEAD		DETECTOR LOOP
	SIGNAL HEAD WITH BACKPLATE		CAST IRON JUNCTION BOX
	SIGNAL HEAD, PEDESTRIAN		EMERGENCY VEHICLE SYSTEM DETECTOR
	SIGNAL POST		CONFIRMATION BEACON
	MAST ARM ASSEMBLY AND POLE, STEEL		SIGNAL HEAD OPTICALLY PROGRAMMED
	MAST ARM ASSEMBLY AND POLE, ALUMINUM		CONDUIT SPLICE
	COMMON TRENCH		WOOD POLE
	UNIT DUCT		RACEWAY FOR MAGNETIC DETECTOR, TYPE I OR TYPE II
	HANDBOLE		VEHICLE DETECTOR, NON-COMPENSATED MAGNETIC TYPE
	HEAVY DUTY HANDBOLE		RAILROAD CONTROL CABINET
	DOUBLE HANDBOLE		

REPLACE ALL DETECTOR LOOPS AS SHOWN
(WITHIN THE RESURFACING LIMITS)

CODE NO.	QUANTITY	UNIT	ITEM
86600600	946	Foot	Detector Loop Replacement

NOTE:
THIS PLAN IS FOR THE PURPOSE OF REPLACING THE DETECTOR LOOPS ONLY. ALL OTHER INFORMATION SHOWN IS NOT RELATED AND WILL BE DISREGARDED.

ILLINOIS DEPARTMENT OF TRANSPORTATION
DETECTOR LOOP REPLACEMENT
55TH STREET @ WOLF ROAD

SCALE: 1"=20'
DATE: MAR. 04

DRAWN BY: _____
DESIGNED BY: _____
CHECKED BY: _____

REVISIONS	
NAME	DATE