

F.A.I. RTE.	SECTION	COUNTY	TOTAL SHEETS	SHEET NO.
90/94	2004-073RS	COOK	74	10
STA.		TO STA.		
FED. ROAD DIST. NO. 1		ILLINOIS FED. AID PROJECT		

62812

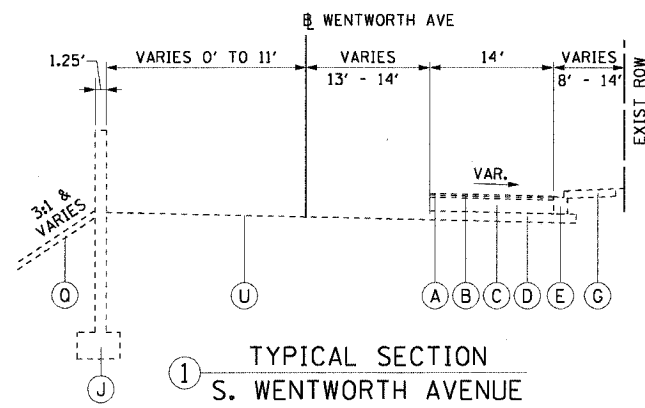

① TYPICAL SECTION
S. WENTWORTH AVENUE

STA 183+35.83 TO STA 189+00.00

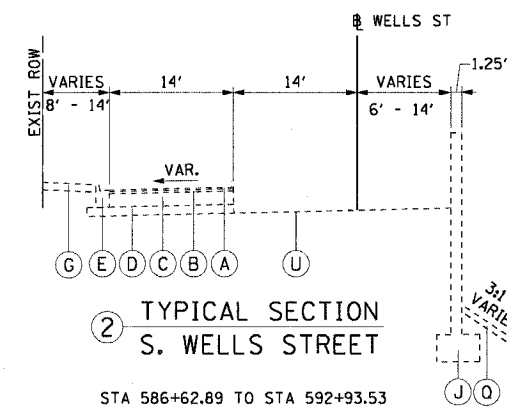

② TYPICAL SECTION
S. WELLS STREET

STA 586+62.89 TO STA 592+93.53

EXISTING LEGEND:

- Ⓐ BIT. CONC. SURFACE COURSE, 1"
- Ⓑ BIT. CONC. BINDER COURSE, 1 1/2"
- Ⓒ P.C.C. BASE COURSE, 9"
- Ⓓ SUB-BASE GRANULAR MATERIAL, TYPE A, 6"
- Ⓔ COMB. CONC. CURB AND GUTTER, TYPE 3
- Ⓖ P.C.C. SIDEWALK, 5"
- Ⓙ RETAINING WALL BUILT IN CONTRACT 62586
- ⓪ GRASS AREA
- Ⓛ BACKFILL INSTALLED BY CONTRACT 62586

- NOTES:
- THE DEPTHS OF MATERIALS SHOWN WERE TAKEN FROM AS-BUILT PLANS.
 - TYPICAL SECTIONS ARE NOT PROVIDED THROUGH THE 51ST STREET INTERSECTION.

REVISIONS	
NAME	DATE

ILLINOIS DEPARTMENT OF TRANSPORTATION
F.A.I. 90/94 (DAN RYAN EXPRESSWAY)
51st ST (WENTWORTH AVE AND WELLS ST)

EXISTING TYPICAL SECTIONS
S. WENTWORTH AVE AND S. WELLS ST

SCALE: H:1"=10' V:1"=5'
DATE: December 23, 2004

DRAWN BY: LC
CHECKED BY: JAL



12/21/2004 3:16:23 PM