

CONTRACT 62829	F.A.P. RTE.	SECTION	COUNTY	TOTAL SHEETS	SHEET NO.
	305	2004-088B	COOK	145	30
	STA.	TO STA.			

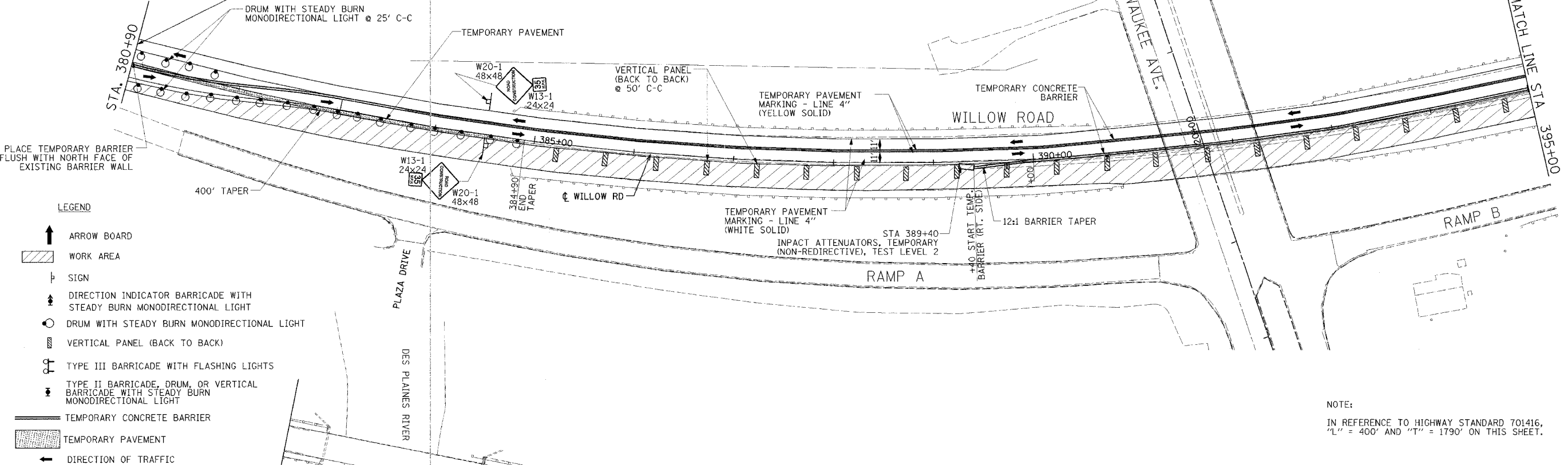

SEE STANDARD 701416 AND STANDARD 701400 FOR SIGNING DETAILS



- LEGEND**
- ↑ ARROW BOARD
 - ▨ WORK AREA
 - ⊥ SIGN
 - ⊥ DIRECTION INDICATOR BARRICADE WITH STEADY BURN MONODIRECTIONAL LIGHT
 - DRUM WITH STEADY BURN MONODIRECTIONAL LIGHT
 - ▨ VERTICAL PANEL (BACK TO BACK)
 - ⊥ TYPE III BARRICADE WITH FLASHING LIGHTS
 - ⊥ TYPE II BARRICADE, DRUM, OR VERTICAL BARRICADE WITH STEADY BURN MONODIRECTIONAL LIGHT
 - ▬ TEMPORARY CONCRETE BARRIER
 - ▨ TEMPORARY PAVEMENT
 - ↑ DIRECTION OF TRAFFIC

NOTE:
IN REFERENCE TO HIGHWAY STANDARD 701416, "L" = 400' AND "T" = 1790' ON THIS SHEET.

SEE STANDARD 701416 AND STANDARD 701400 FOR SIGNING DETAILS

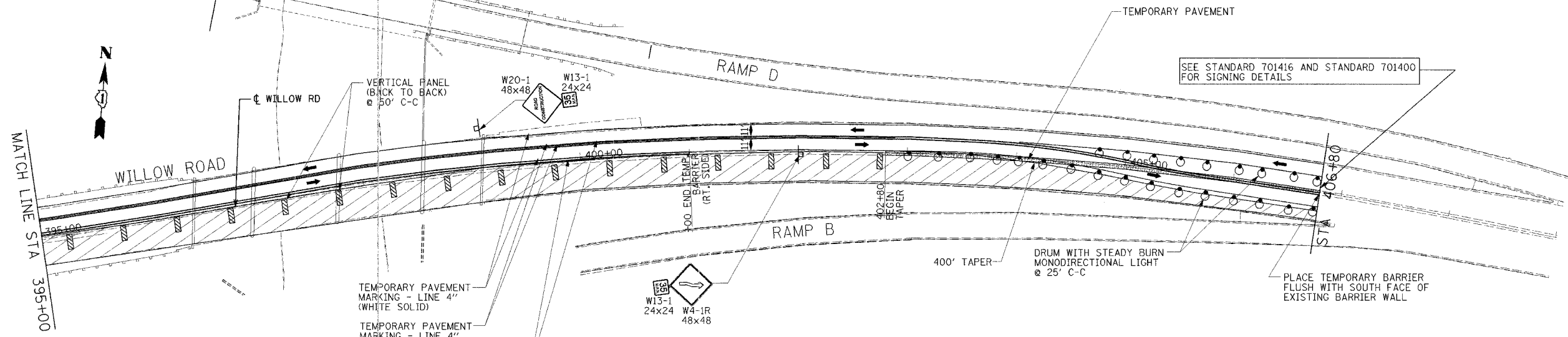

		ILLINOIS DEPARTMENT OF TRANSPORTATION	
		SUGGESTED CONSTRUCTION STAGING	
REVISIONS		STAGE 1	
NAME	DATE	WILLOW ROAD	
		OVER US 45/IL 21 (MILWAUKEE AVE)	
		AND OVER DES PLAINES RIVER	
		DATE JANUARY 2005	
		DRAWN BY CADD	
		CHECKED BY PJM	

MOT-3
03/20/05 03:50:55 PM