

CONTRACT 62829	F.A.P. RTE.	SECTION	COUNTY	TOTAL SHEETS	SHEET NO.
	305	2004-088B	COOK	145	31A
STA.		TO STA.			

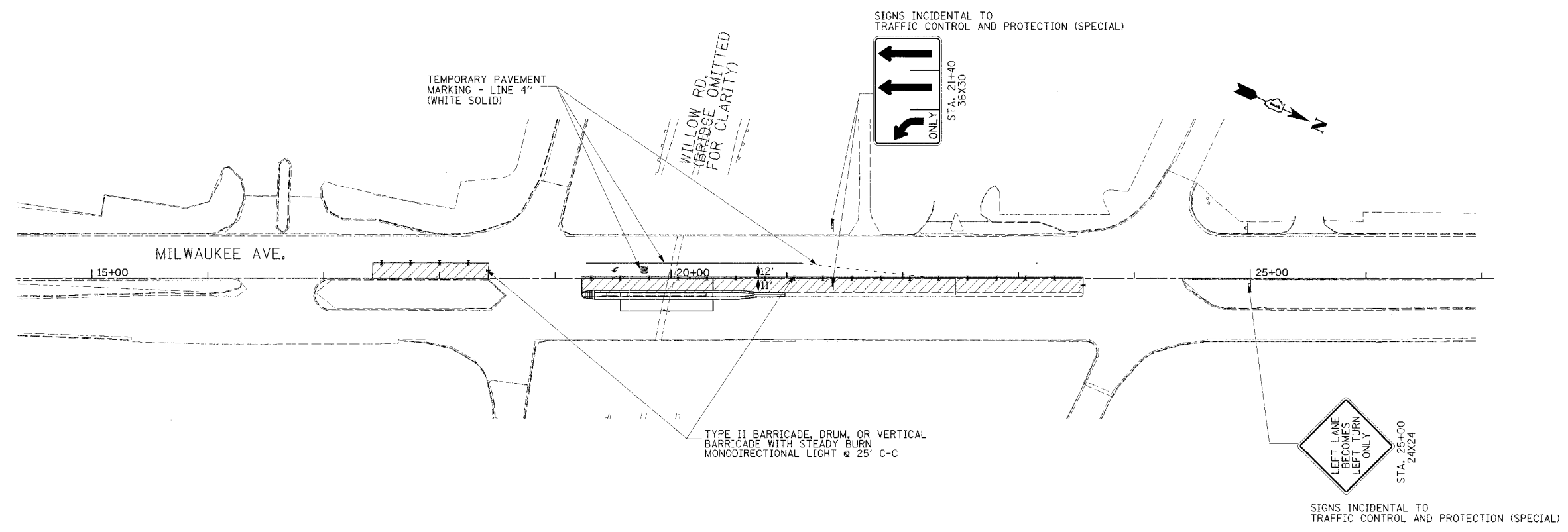

LEGEND

- ARROW BOARD
- WORK AREA
- SIGN
- DIRECTION INDICATOR BARRICADE WITH STEADY BURN MONODIRECTIONAL LIGHT
- DRUM WITH STEADY BURN MONODIRECTIONAL LIGHT
- VERTICAL PANEL (BACK TO BACK)
- TYPE III BARRICADE WITH FLASHING LIGHTS
- TYPE II BARRICADE, DRUM, OR VERTICAL BARRICADE WITH STEADY BURN MONODIRECTIONAL LIGHT
- TEMPORARY CONCRETE BARRIER
- TEMPORARY PAVEMENT
- DIRECTION OF TRAFFIC

<b>Edwards and Kelcey</b>	
REVISIONS	
NAME	DATE

MOT-4A

ILLINOIS DEPARTMENT OF TRANSPORTATION

**SUGGESTED CONSTRUCTION STAGING**

**MILWAUKEE AVENUE**

**FOR CENTER PIER CONSTRUCTION**

WILLOW ROAD  
OVER US 45/IL 21 (MILWAUKEE AVE)  
AND OVER DES PLAINES RIVER

0 50 100  
DATE JANUARY 2005

DRAWN BY CADD  
CHECKED BY PJM

P:\0000019101\A\2004\088B\Advance Contract\07121005.dwg 07/12/2005 04:49:55 PM