

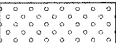

CONTRACT 62829	F.A.P. RTE.	SECTION	COUNTY	TOTAL SHEETS	SHEET NO.
	305	2004-088B	COOK	145	36
STA.	TO STA.				

**LEGEND**

	SEEDING CLASS 2A
	SEEDING CLASS 4A
	EROSION CONTROL BLANKET

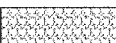

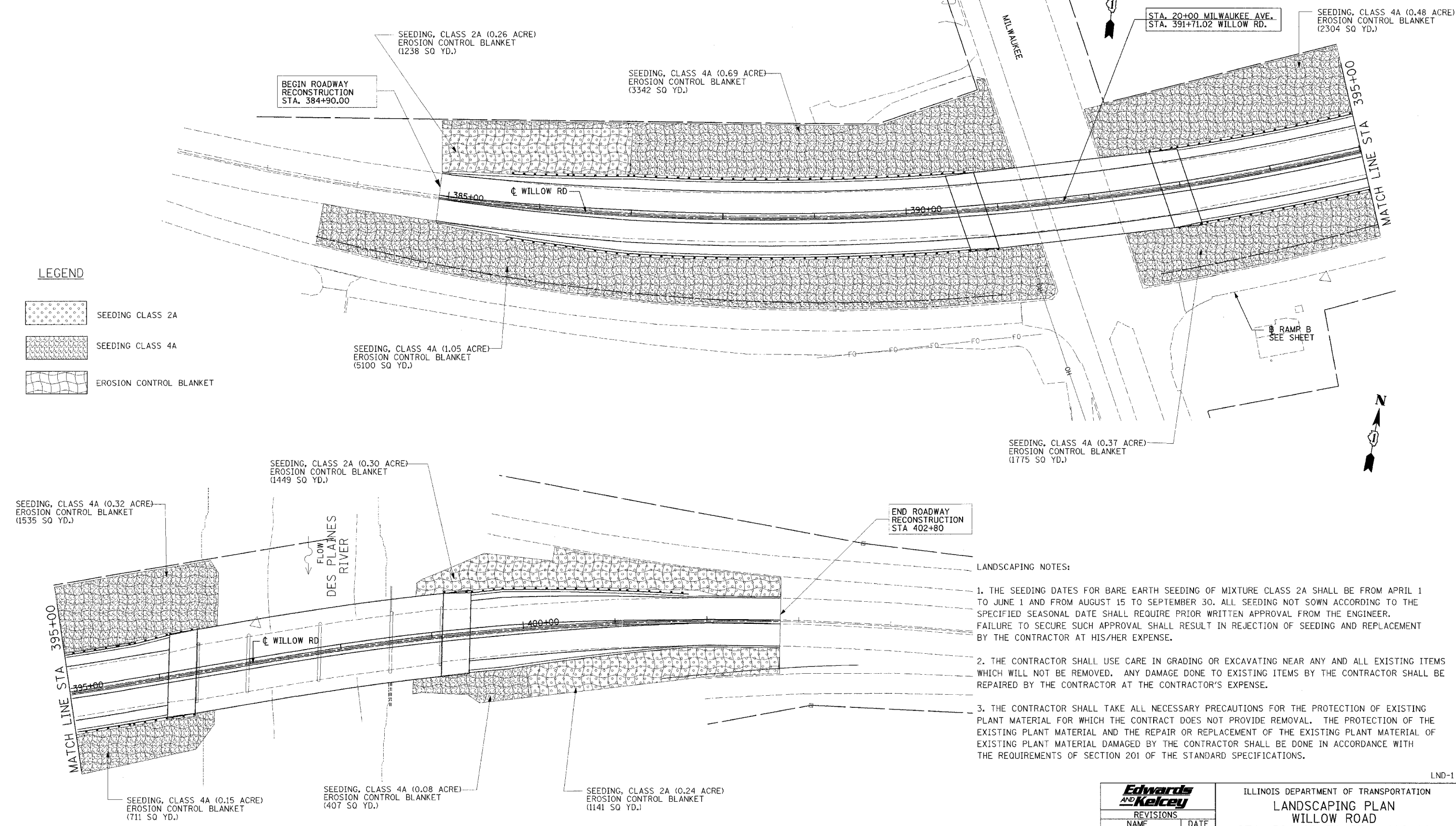
- LANDSCAPING NOTES:**
1. THE SEEDING DATES FOR BARE EARTH SEEDING OF MIXTURE CLASS 2A SHALL BE FROM APRIL 1 TO JUNE 1 AND FROM AUGUST 15 TO SEPTEMBER 30. ALL SEEDING NOT SOWN ACCORDING TO THE SPECIFIED SEASONAL DATE SHALL REQUIRE PRIOR WRITTEN APPROVAL FROM THE ENGINEER. FAILURE TO SECURE SUCH APPROVAL SHALL RESULT IN REJECTION OF SEEDING AND REPLACEMENT BY THE CONTRACTOR AT HIS/HER EXPENSE.
  2. THE CONTRACTOR SHALL USE CARE IN GRADING OR EXCAVATING NEAR ANY AND ALL EXISTING ITEMS WHICH WILL NOT BE REMOVED. ANY DAMAGE DONE TO EXISTING ITEMS BY THE CONTRACTOR SHALL BE REPAIRED BY THE CONTRACTOR AT THE CONTRACTOR'S EXPENSE.
  3. THE CONTRACTOR SHALL TAKE ALL NECESSARY PRECAUTIONS FOR THE PROTECTION OF EXISTING PLANT MATERIAL FOR WHICH THE CONTRACT DOES NOT PROVIDE REMOVAL. THE PROTECTION OF THE EXISTING PLANT MATERIAL AND THE REPAIR OR REPLACEMENT OF THE EXISTING PLANT MATERIAL OF EXISTING PLANT MATERIAL DAMAGED BY THE CONTRACTOR SHALL BE DONE IN ACCORDANCE WITH THE REQUIREMENTS OF SECTION 201 OF THE STANDARD SPECIFICATIONS.

<b>Edwards and Kelcey</b>	
REVISIONS	
NAME	DATE

ILLINOIS DEPARTMENT OF TRANSPORTATION

**LANDSCAPING PLAN**

**WILLOW ROAD**

**STA. 384+90 TO STA. 402+80**

WILLOW ROAD  
OVER US 45/IL 21 (MILWAUKEE AVE)  
AND OVER DES PLAINES RIVER

0 50' 100'

DATE JANUARY 2005

DRAWN BY CADD  
CHECKED BY PJM

LND-1

05/27/05 PJM