

CONTRACT 62829	F.A.P. RTE.	SECTION	COUNTY	TOTAL SHEETS	SHEET NO.
	305	2004-088B	COOK	145	48
	STA.	TO STA.			

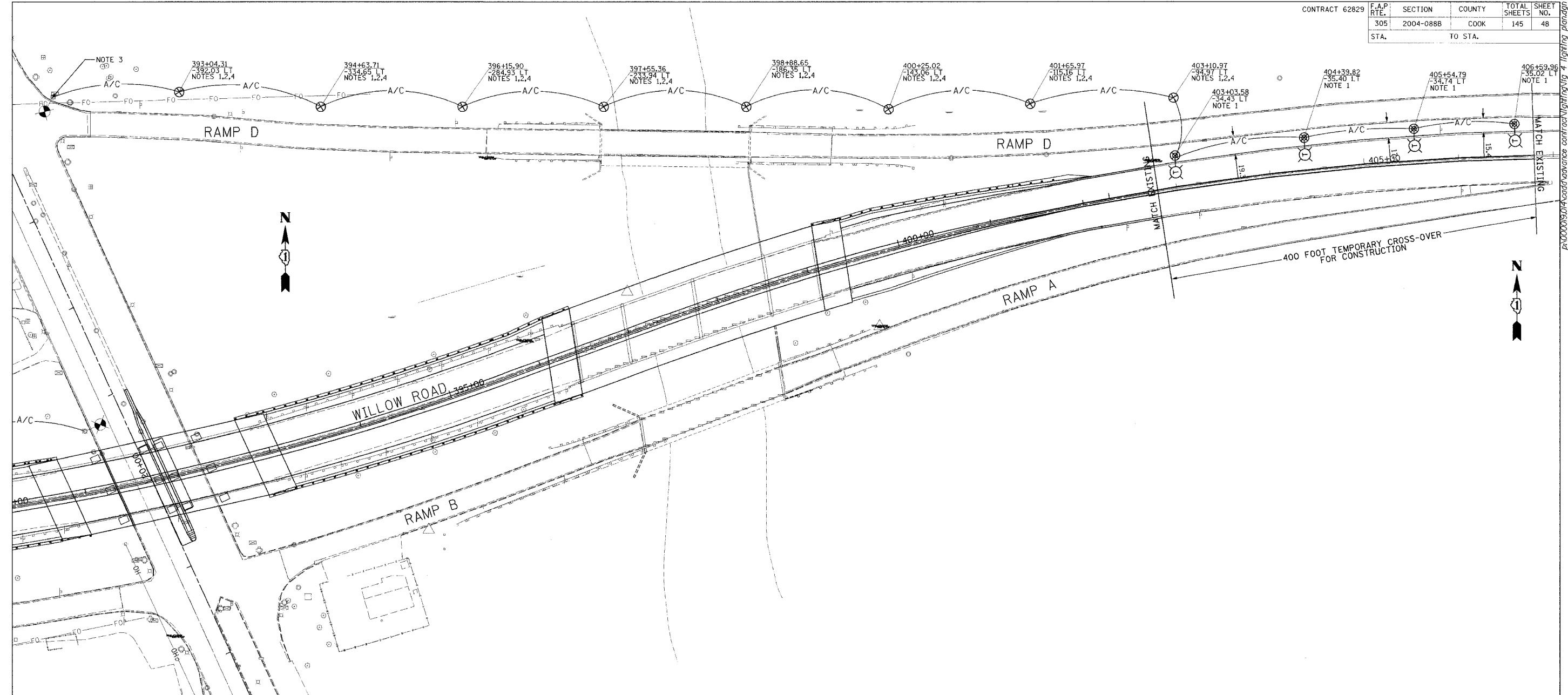

- SEE DWG. NO. LTG-9 FOR TEMPORARY LIGHTING UNIT INSTALLATION DETAILS.
- MAINTAIN AN ELEVATION OF 30' ABOVE THE ROADWAY TO BOTTOM OF TEMPORARY LIGHTING FIXTURES.
- THE CONTRACTOR SHALL MAKE ALL THE NECESSARY CONNECTIONS AND MODIFICATIONS TO THE EXISTING LIGHT UNIT TO FEED THE TEMPORARY LIGHTS FOR THE PROPOSED CROSSOVER.
- TEMPORARY LUMINAIRE, STREET LIGHT, 250 WATT HPS, 240 VOLT, HORIZONTAL MOUNT, TYPE II, MEDIUM, SEMI-CUTOFF.
- TEMPORARY LIGHTING TO BE REMOVED AND SALVAGED AS DIRECTED BY IDOT WHEN ROADWAY CONSTRUCTION IS COMPLETE.
- THE DRAWINGS ATTEMPT TO IDENTIFY ALL ELECTRICAL COMPONENTS THAT ARE NEEDED TO PROVIDE A COMPLETE AND WORKABLE LIGHTING SYSTEM. HOWEVER, ALL SYSTEMS THAT ARE TO REMAIN OPERATIONAL DURING PHASED CONSTRUCTION AND ARE TO BE MODIFIED AS REQUIRED TO KEEP ROADWAY LIGHTING FUNCTIONING.

TEMPORARY CROSSOVER LIGHTING

LEGEND

- EXISTING LIGHTING UNIT TO REMAIN IN PLACE AND SERVE AS TEMPORARY LIGHTING. AFTER INSTALLATION OF PROPOSED LIGHTING SYSTEM REMOVE EXISTING LIGHT POLE, LUMINAIRE, CONCRETE FOUNDATION, ABANDON UNDERGROUND ELECTRICAL CABLE.
- PROPOSED WOOD POLE WITH DESIGNATED LENGTH ABOVE GROUND
- PROPOSED TEMPORARY LIGHTING WITH WOOD POLE TO PROVIDE LIGHTING UNIT WITH DESIGNATED MOUNTING HEIGHT.
- AREAL ELECTRIC CABLE: 2-1/C #4 ALUMINUM W/ MESSENGER WIRE.

<b>Edwards AND Kelcey</b>	
REVISIONS	
NAME	DATE

ILLINOIS DEPARTMENT OF TRANSPORTATION  
**WILLOW RD. & MILWAUKEE AVE  
 TEMPORARY LIGHTING PLAN**  
 WILLOW ROAD  
 OVER US 45/IL 21 (MILWAUKEE AVE)  
 AND OVER DES PLAINES RIVER  
 SCALE 1"=50' DRAWN BY CADD SC  
 DATE JANUARY 2005 CHECKED BY CDS

LTG-4

2/28/2004 08:04 PM