

F.A. RTE.	SECTION	COUNTY	TOTAL SHEETS	SHEET NO.
*	0913.1	COOK	61	20
STA.		TO STA.		
FED. ROAD DIST. NO. 1		ILLINOIS FED. AID PROJECT		

* FAP 305/ FAU 1285

CONTRACT NO. 62849

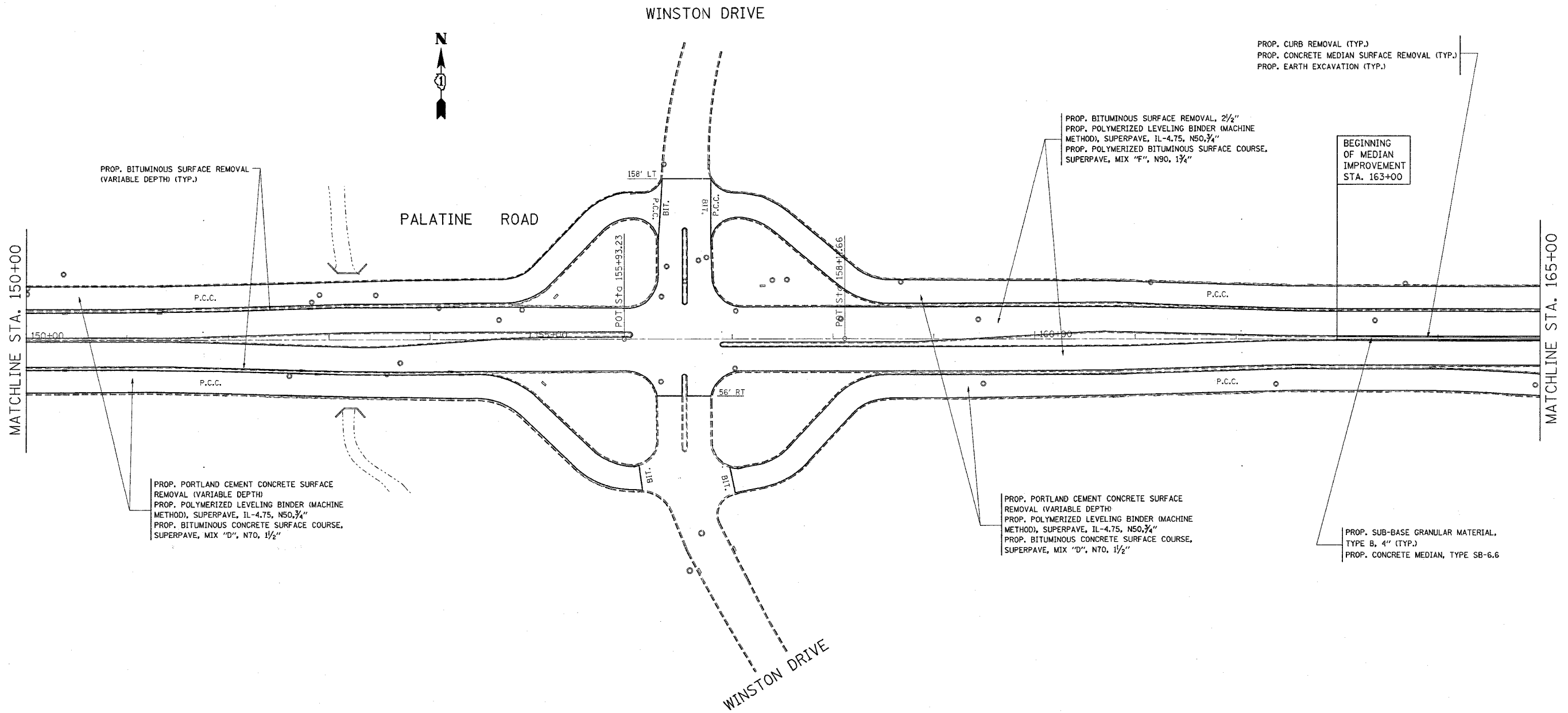

PROP. BITUMINOUS SURFACE REMOVAL (VARIABLE DEPTH) (TYP.)

PROP. BITUMINOUS SURFACE REMOVAL, 2 1/2"
 PROP. POLYMERIZED LEVELING BINDER (MACHINE METHOD), SUPERPAVE, IL-4.75, NS0.7/4"
 PROP. POLYMERIZED BITUMINOUS SURFACE COURSE, SUPERPAVE, MIX "F", N90, 1 3/4"

PROP. CURB REMOVAL (TYP.)
 PROP. CONCRETE MEDIAN SURFACE REMOVAL (TYP.)
 PROP. EARTH EXCAVATION (TYP.)

BEGINNING OF MEDIAN IMPROVEMENT STA. 163+00

PROP. PORTLAND CEMENT CONCRETE SURFACE REMOVAL (VARIABLE DEPTH)
 PROP. POLYMERIZED LEVELING BINDER (MACHINE METHOD), SUPERPAVE, IL-4.75, NS0.7/4"
 PROP. BITUMINOUS CONCRETE SURFACE COURSE, SUPERPAVE, MIX "D", N70, 1 1/2"

PROP. PORTLAND CEMENT CONCRETE SURFACE REMOVAL (VARIABLE DEPTH)
 PROP. POLYMERIZED LEVELING BINDER (MACHINE METHOD), SUPERPAVE, IL-4.75, NS0.7/4"
 PROP. BITUMINOUS CONCRETE SURFACE COURSE, SUPERPAVE, MIX "D", N70, 1 1/2"

PROP. SUB-BASE GRANULAR MATERIAL, TYPE B, 4" (TYP.)
 PROP. CONCRETE MEDIAN, TYPE SB-6.6

REVISIONS	
NAME	DATE

ILLINOIS DEPARTMENT OF TRANSPORTATION
 FAP 305/ FAU 1285
 (PALATINE ROAD)
 CEDAR STREET TO EAST OF US 12
 EXISTING/ PROPOSED
 ROADWAY PLANS

SCALE: VERT. _____
 HORIZ. _____
 DATE 12/15/2004
 DRAWN BY _____
 CHECKED BY _____