

F.A.P. DIST.	SECTION	COUNTY	TOTAL SHEETS	SHEET NO.
305	0913.1 RS-1	COOK	52	15
STA. 259+37		TO STA. 284+00		
FED. ROAD DIST. NO. 1	ILLINOIS	FED. AID PROJECT		
CONTRACT NO.: 62850				

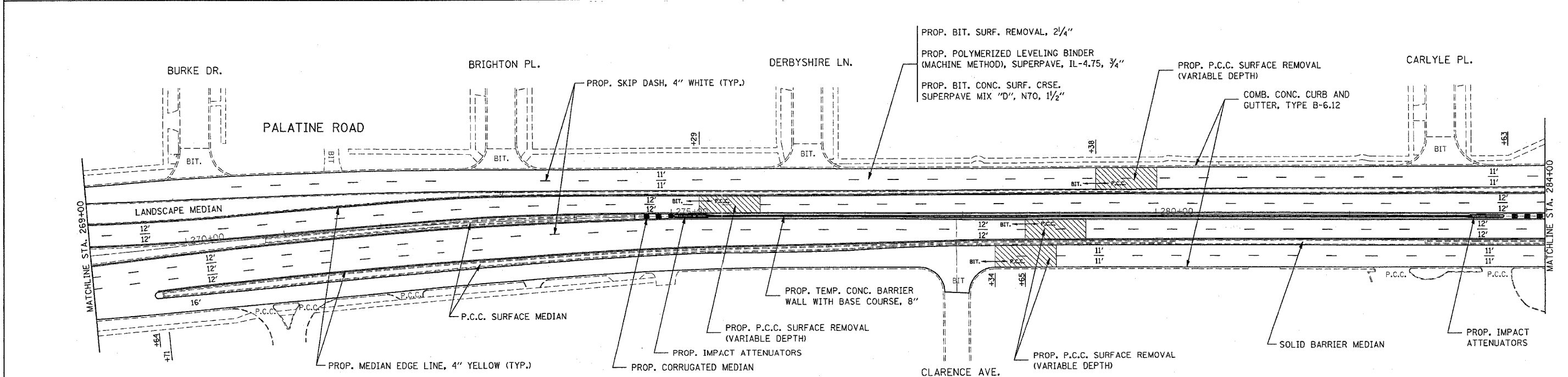
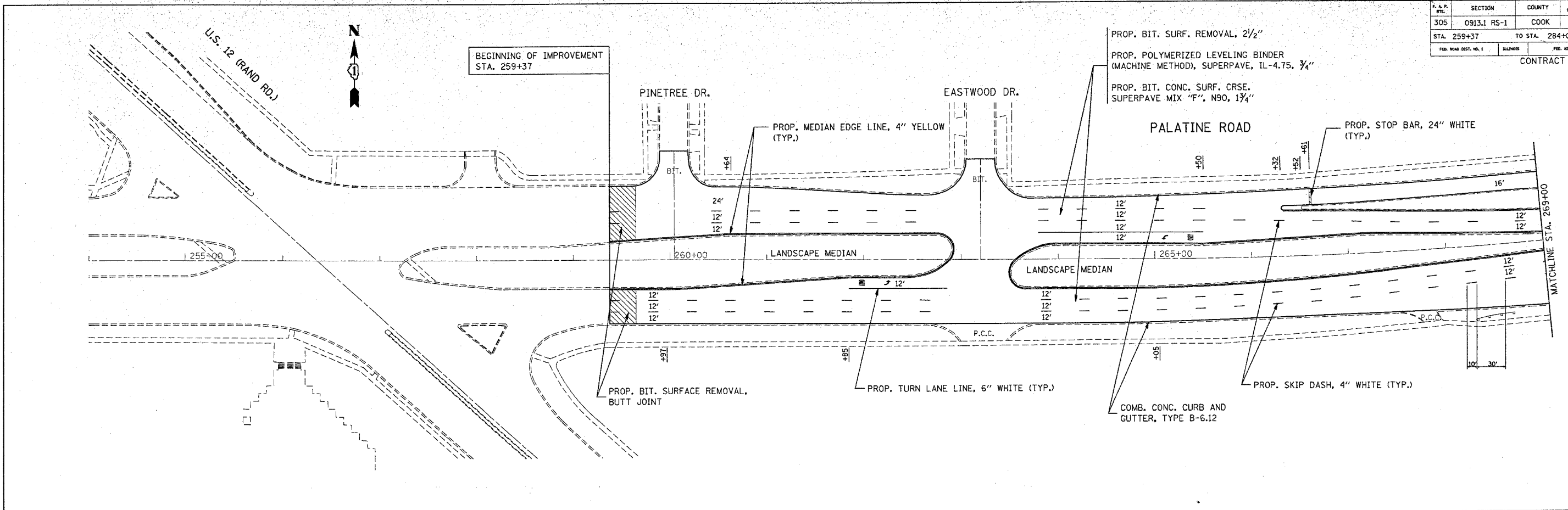

NOTES:
 PERMANENT PAVEMENT MARKINGS SHALL BE THERMOPLASTIC (OF THE EXTRUDED TYPE) AND SHOULD BE PLACED IN ACCORDANCE WITH "DISTRICT ONE TYPICAL PAVEMENT MARKINGS" DETAIL. (TC-13)
 RAISED REFLECTIVE PAVEMENT MARKERS SHALL BE IN ACCORDANCE WITH THE DISTRICT ONE "TYPICAL APPLICATION RAISED REFLECTIVE PAVEMENT MARKERS DETAIL."
 THE RESIDENT ENGINEER SHOULD CONTACT MR. WALTER CZARNY, AREA TRAFFIC ENGINEER, AT (773) 685-8386 AT LEAST (2) WEEKS PRIOR TO PLACING ANY PAVEMENT MARKINGS.

REVISIONS	
NAME	DATE

ILLINOIS DEPARTMENT OF TRANSPORTATION
 F.A.P. 305 (PALATINE RD.)
 US 12 (RAND RD.) TO IL 21 (MILWAUKEE AVE.)
 ROADWAY AND PAVEMENT MARKING PLANS
 SCALE: VERT. 1"=50'
 HORIZ. 1"=50'
 DATE 12/21/2004
 DRAWN BY
 CHECKED BY

12/21/2004
 c:\projects\0101805\0101805000.m32
 *REF-
 *REF-
 VI=