

EXISTING

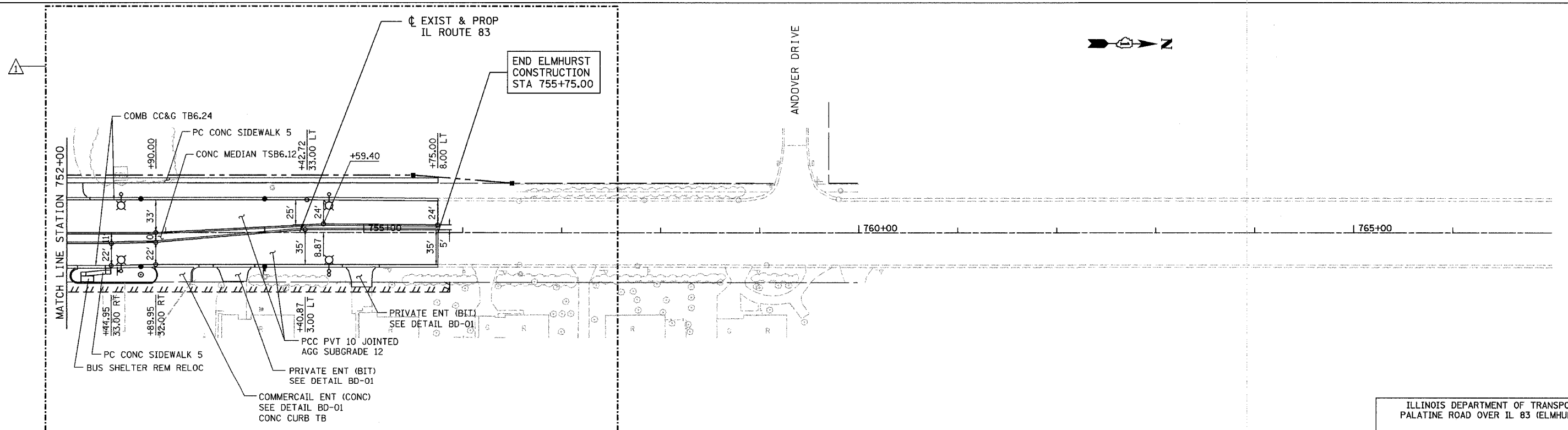

PROPOSED

REVISIONS	
NAME	DATE
REVISED - JBS	2/17/05

ILLINOIS DEPARTMENT OF TRANSPORTATION
PALATINE ROAD OVER IL 83 (ELMHURST RD.)

**ELMHURST ROAD
EXISTING AND PROPOSED
ROADWAY PLAN**

SCALE: 1"=50'
DATE 12/04

DRAWN BY ACE/CAD
CHECKED BY TAE

