

**GENERAL NOTES - TRAFFIC CONTROL**

TEMPORARY PAVEMENT PLACED ADJACENT TO PROPOSED PAVEMENT WILL BE PITCHED TO DRAIN TOWARD THE EXISTING OR PROPOSED DRAINAGE STRUCTURES.

THE CONTRACTOR IS ADVISED THAT IN THE EVENT OF SNOW, HE/SHE WILL BE RESPONSIBLE FOR THE IMMEDIATE REMOVAL OF ANY MAINTENANCE OF TRAFFIC PROTECTION DEVICES REQUIRED FOR HIS/HER OPERATIONS THAT WOULD INTERFERE WITH SNOW REMOVAL OPERATIONS PERFORMED BY THE STATE OR LOCAL AGENCY.

THE CONTRACTOR SHALL NOT MOUNT SIGNS ON EXISTING SIGNS.

TYPE II BARRICADES WHEN USED FOR APPROACH TAPERS, AS INDICATED ON THE STATE STANDARDS OR SHOWN ON THE PLANS SHALL BE **DIRECTION INDICATOR BARRICADES.**

CHANGEABLE MESSAGE SIGNS AND/OR STATIC SIGNS ARE REQUIRED AS 2 WEEK NOTICE FOR THE FOLLOWING LOCATIONS: WHERE A RAMP IS CLOSED FOR MORE THAN 1 DAY, A ROAD IS CLOSED FOR MORE THAN 1 DAY, OR A LANE IS CLOSED FOR MORE THAN 1 DAY (SUCH AS FOR BRIDGE RECONSTRUCTIONS OR OTHER WORK WHERE TEMPORARY CONCRETE BARRIER IS USED.) THE SIGNS WILL BE PAID AS "TEMPORARY INFORMATION SIGNING" AND "CHANGEABLE MESSAGE SIGN".

CONTRACTOR WILL CONTACT RICHARD GLENZ (847-459-2985) AT VILLAGE OF WHEELING AT LEAST ONE WEEK PRIOR TO TRAFFIC / SIGNAL STAGING AT WHEELING ROAD.

CONTRACTOR WILL CONTACT JAMES SHERIDAN (847-398-6070) AT CITY OF PROSPECT HEIGHTS AT LEAST ONE WEEK PRIOR TO TRAFFIC / SIGNAL STAGING AT SCHOENBECK AND ELMHURST ROAD.

**PRE-STAGE**

INSTALL STORM SEWERS AND PATCH IN LOCATIONS SHOWN ON PLANS. REMOVE PALATINE MEDIANS AND CONSTRUCT TEMPORARY PAVEMENT AS NEEDED. INSTALL TEMPORARY SIGNAL AT SCHOENBECK ROAD INTERSECTION. INSTALL TEMPORARY SIGNAL AT ELMHURST ROAD INTERSECTION. CHANGE PHASING OF SIGNAL AT WHEELING ROAD INTERSECTION.

**STAGE 1A**

**PALATINE ROAD**  
 DIVERT ALL EXPRESS TRAFFIC TO FRONTAGE ROADS. CLOSE INSIDE LANE ON FRONTAGE ROAD AS NEEDED. DEMOLISH BRIDGE OVER ELMHURST ROAD. INSTALL TEMPORARY SHEET PILING & TEMPORARY CONCRETE BARRIER AT BRIDGE. CONSTRUCT NEW PALATINE BRIDGE OVER ELMHURST ROAD.

**ELMHURST ROAD**

SET UP DETOUR SIGNING AND DETOUR TRAFFIC. CLOSE ELMHURST ROAD AT PALATINE ROAD FOR DURATION OF BRIDGE DEMOLITION ONLY. FOR REMAINDER OF STAGE MAINTAIN TRAFFIC ON WEST HALF OF EXISTING ELMHURST ROADWAY. CONSTRUCT EAST LANES OF PROPOSED ROADWAY.

**STAGE 1B**

**PALATINE ROAD**  
 CONTINUE BRIDGE CONSTRUCTION. CONSTRUCT BITUMINOUS PAVEMENT AND OVERLAY TO MATCH EXISTING PAVEMENT.

**ELMHURST ROAD**

MAINTAIN TRAFFIC ON EAST HALF OF PROPOSED ROADWAY. CONSTRUCT WEST LANES OF ROADWAY.

**STAGE 2A**

**PALATINE ROAD**  
 RESTORE EXPRESS TRAFFIC TO EXPRESS LANES. RESTORE SCHOENBECK AND WHEELING SIGNALS TO NORMAL OPERATION. MAINTAIN FRONTAGE ROAD TRAFFIC ON INSIDE LANES AND TEMPORARY PAVEMENT. CONSTRUCT OUTSIDE LANE OF FRONTAGE ROADS AND TEMPORARY PAVEMENT. RESTORE PALATINE SLIP RAMPS TO ORIGINAL CONFIGURATION.

**ELMHURST ROAD**

MAINTAIN TRAFFIC IN SAME CONFIGURATION AS STAGE 1B.

**STAGE 2B**

**PALATINE ROAD**  
 MAINTAIN EXPRESS TRAFFIC ON PROPOSED MAINLINE. MAINTAIN FRONTAGE ROAD TRAFFIC ON OUTSIDE LANES AND TEMPORARY PAVEMENT. CONSTRUCT INSIDE LANE OF FRONTAGE ROAD.

**ELMHURST ROAD**

MAINTAIN TRAFFIC ON WEST HALF OF PROPOSED ROADWAY.







**STAGE 3**

**PALATINE ROAD**  
 MAINTAIN EXPRESS TRAFFIC ON PROPOSED MAINLINE. MAINTAIN FRONTAGE ROAD TRAFFIC ON INSIDE PROPOSED LANES. CONSTRUCT OUTSIDE CURB & GUTTER, SIDEWALK, AND GRADING. INSTALL PROPOSED TRAFFIC SIGNAL & REMOVE TEMPORARY SIGNAL.

**ELMHURST ROAD**

MAINTAIN TRAFFIC ON FAR OUTSIDE LANES. CONSTRUCT MEDIAN.

**MOT LEGEND**

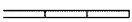
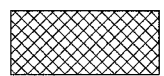
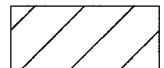
-  TRAFFIC SIGN (AS NOTED)
-  DRUMS W/STEADY BURN LIGHTS
-  VERTICAL PANELS
-  TYPE III BARRICADE WITH FLASHING LIGHT
-  TRAFFIC LANE
-  TEMPORARY SHEET PILING
-  TEMPORARY CONCRETE BARRIER
-  TEMPORARY PAVEMENT
-  WORK ZONE

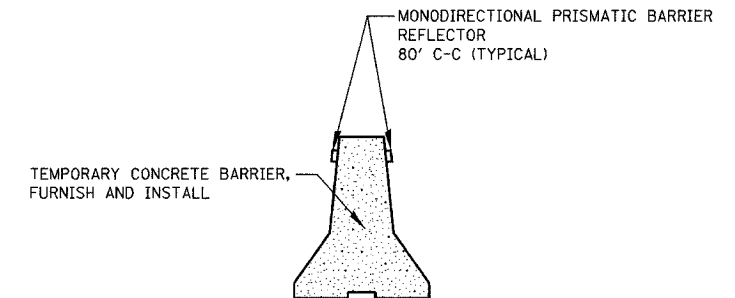

**SECTION FACING TRAFFIC**

TEMPORARY CONCRETE BARRIER, FURNISH AND INSTALL

NOTE: BARRIER MUST BE PINNED TO PAVEMENT

REVISIONS	
NAME	DATE

ILLINOIS DEPARTMENT OF TRANSPORTATION  
 PALATINE ROAD OVER IL 83 (ELMHURST RD.)

**MAINTENANCE OF TRAFFIC  
 AND STAGING  
 GENERAL NOTES & LEGEND**

SCALE: NONE  
 DATE 12/04

DRAWN BY ACE/CAD  
 CHECKED BY TAE

