

F.A. RTE.	SECTION	COUNTY	TOTAL SHEETS	SHEET NO.
*	**	WINNEBAGO		82
STA.		TO STA.		
FED. ROAD DIST. NO.	ILLINOIS	FED. AID PROJECT		

DETOUR ROUTE FOR RAMP BD CLOSURE

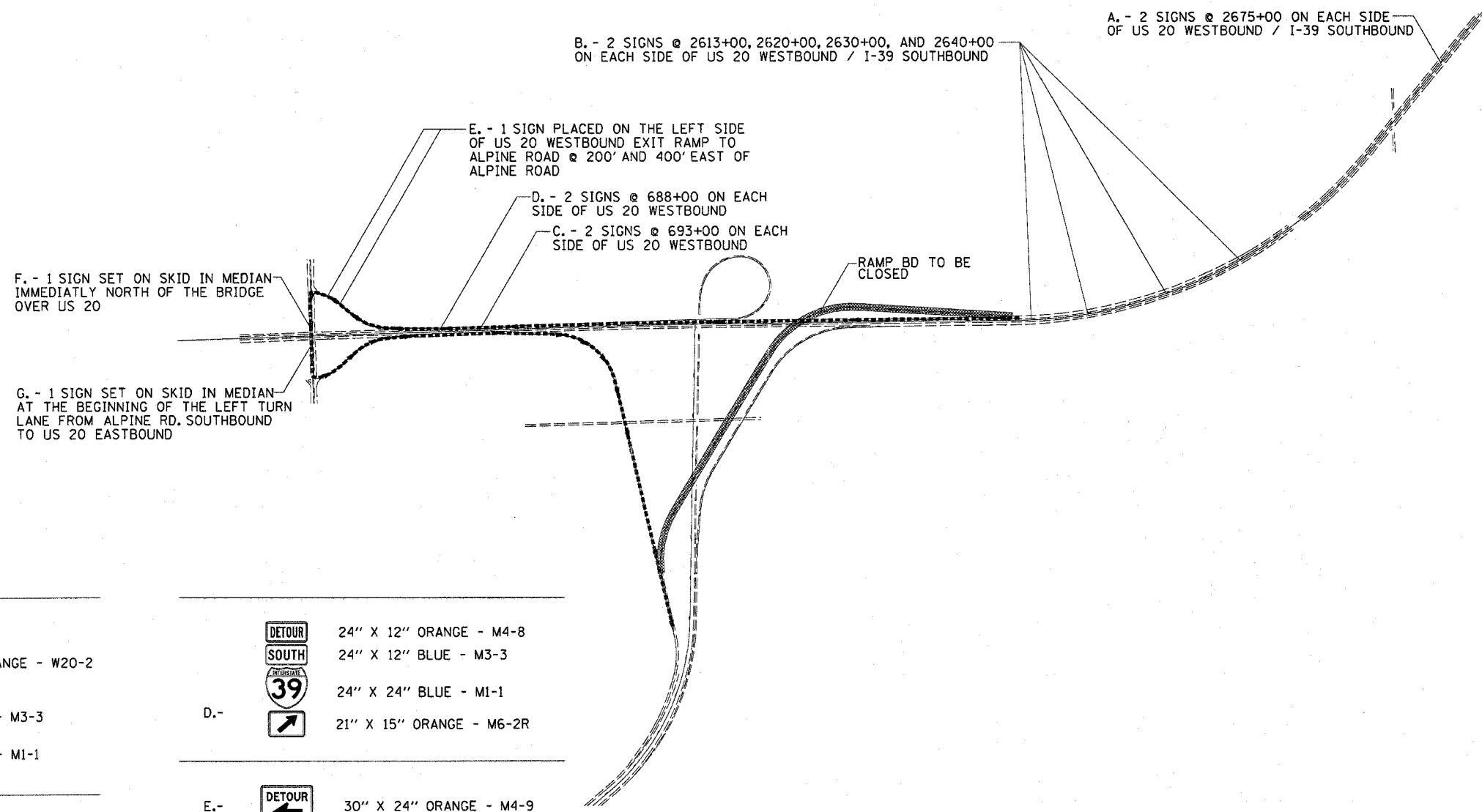

B. - 2 SIGNS @ 2613+00, 2620+00, 2630+00, AND 2640+00 ON EACH SIDE OF US 20 WESTBOUND / I-39 SOUTHBOUND

A. - 2 SIGNS @ 2675+00 ON EACH SIDE OF US 20 WESTBOUND / I-39 SOUTHBOUND

E. - 1 SIGN PLACED ON THE LEFT SIDE OF US 20 WESTBOUND EXIT RAMP TO ALPINE ROAD @ 200' AND 400' EAST OF ALPINE ROAD

D. - 2 SIGNS @ 688+00 ON EACH SIDE OF US 20 WESTBOUND

C. - 2 SIGNS @ 693+00 ON EACH SIDE OF US 20 WESTBOUND

F. - 1 SIGN SET ON SKID IN MEDIAN IMMEDIATELY NORTH OF THE BRIDGE OVER US 20

G. - 1 SIGN SET ON SKID IN MEDIAN AT THE BEGINNING OF THE LEFT TURN LANE FROM ALPINE RD. SOUTHBOUND TO US 20 EASTBOUND

RAMP BD TO BE CLOSED

- A.-
- 48" X 48" ORANGE - W20-2
 - 24" X 12" BLUE - M3-3
 - 24" X 24" BLUE - M1-1

- B.-
- 24" X 12" ORANGE - M4-8
 - 24" X 12" BLUE - M3-3
 - 24" X 24" BLUE - M1-1
 - 21" X 15" ORANGE - M6-3

- C.-
- 24" X 12" ORANGE - M4-8
 - 24" X 12" BLUE - M3-3
 - 24" X 24" BLUE - M1-1
 - 21" X 15" ORANGE - M5-2R

- D.-
- 24" X 12" ORANGE - M4-8
 - 24" X 12" BLUE - M3-3
 - 24" X 24" BLUE - M1-1
 - 21" X 15" ORANGE - M6-2R

- E.-
- 30" X 24" ORANGE - M4-9

- F.-
- 24" X 12" ORANGE - M4-8
 - 24" X 12" BLUE - M3-3
 - 24" X 24" BLUE - M1-1
 - 24" X 24" WHITE - M-SPC

- G.-
- 24" X 12" ORANGE - M4-8
 - 24" X 12" BLUE - M3-3
 - 24" X 24" BLUE - M1-1
 - 21" X 15" ORANGE - M6-1L

NOTE:
 I-39 TELES PAR MOUNTED SIGNS IN MEDIAN BETWEEN STA. 2606+00 TO STA. 2665+00 SHALL BE TURNED WHILE DETOUR FOR RAMP BD CLOSURE IS IN EFFECT

REVISIONS	
NAME	DATE

ILLINOIS DEPARTMENT OF TRANSPORTATION

SCALE: VERT. _____
 HORIZ. _____

DATE _____

DRAWN BY _____
 CHECKED BY _____

PLOT DATE = Thu Dec 23 10:26:51 2004
 FILE NAME = C:\projects\64596\2252508\ref\2252508.dgn
 PLOT SCALE = 1" = 400'
 REFERENCE = #REF#

DETOUR ROUTE FOR RAMP BD CLOSURE