

F.A.P. RTE.	SECTION	COUNTY	TOTAL SHEETS	SHEET NO.
595	1-3-K	ROCK ISLAND	476	132
STA. 12+80		TO STA. 14+27.05		
FED. ROAD DIST. NO.		ILLINOIS FED. AID PROJECT		

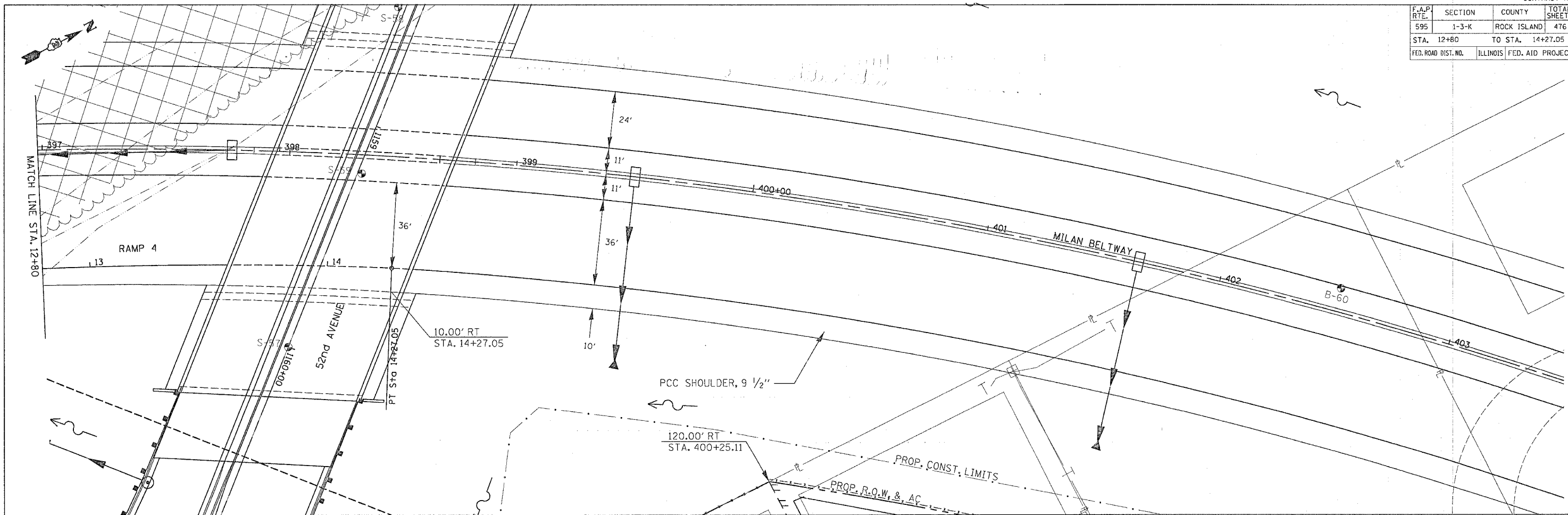

PLAN

DESIGNED	DATE
PLOTTED	
ALIGNED	
CHECKED	
NO. _____	

PROFILE

DESIGNED	DATE
PLOTTED	
GRADES CHECKED	
STRUCTURE NOTATIONS OK'D	
NO. _____	

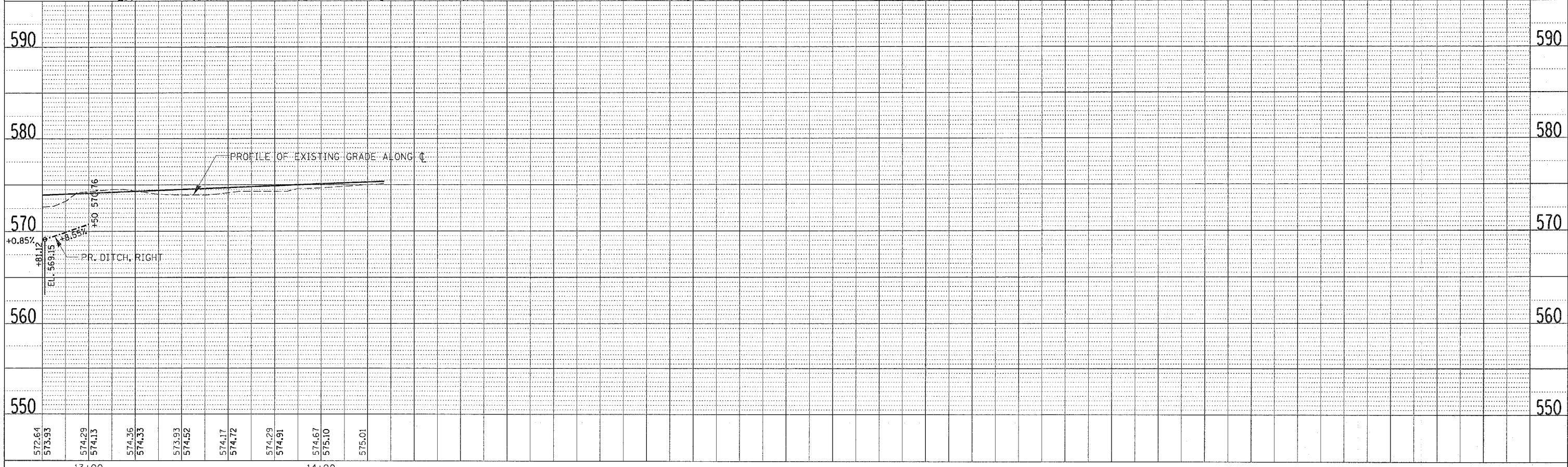

52ND AVENUE RAMP 4 - STA. 12+80 TO STA. 14+27.05