

F.A.P. RTE.	SECTION	COUNTY	TOTAL SHEETS	SHEET NO.
595	1-3-K	ROCK ISLAND	476	227
STA.		TO STA.		
FED. ROAD DIST. NO.		ILLINOIS FED. AID PROJECT		

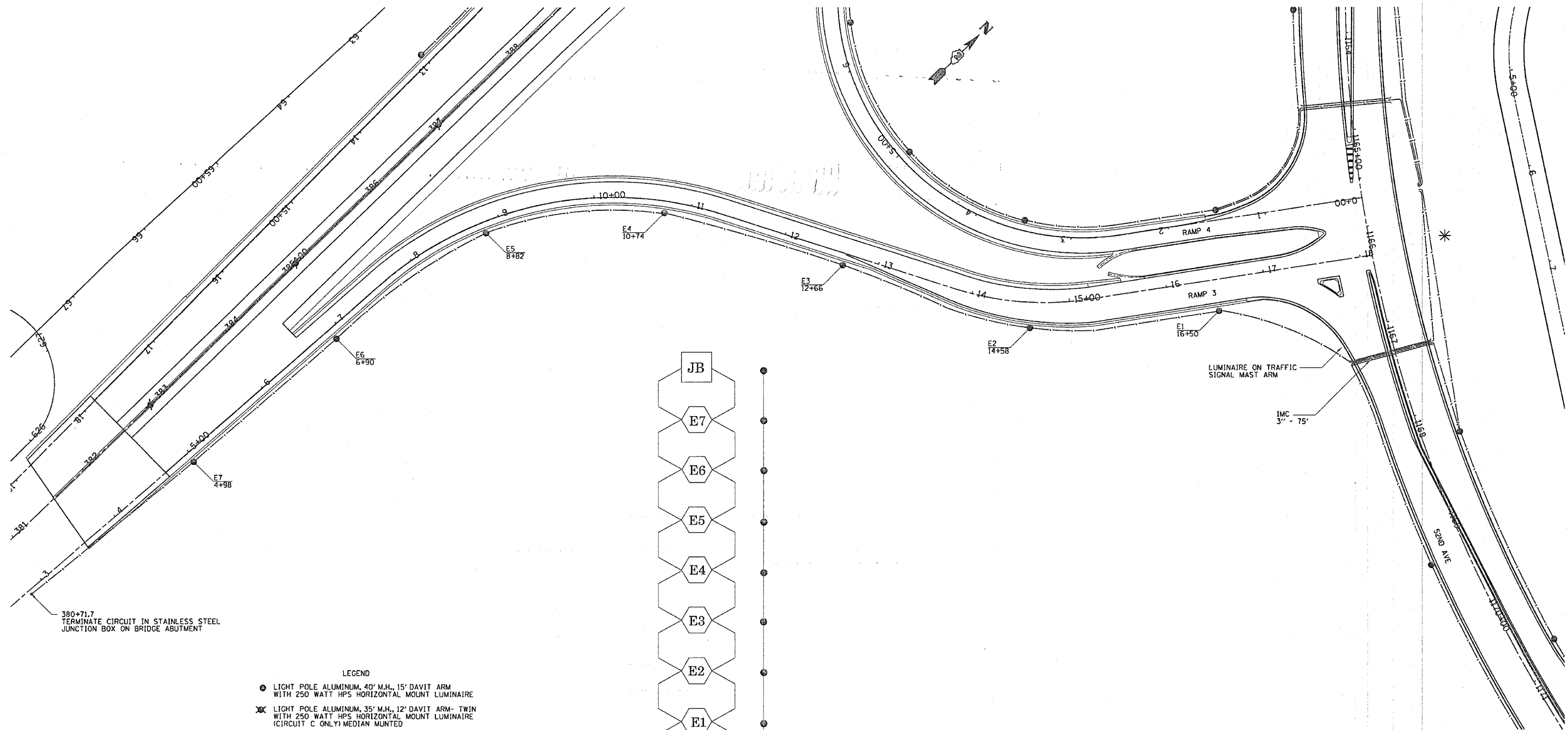

380+71.7
TERMINATE CIRCUIT IN STAINLESS STEEL
JUNCTION BOX ON BRIDGE ABUTMENT

- LEGEND
- LIGHT POLE ALUMINUM, 40' M.H., 15' DAVIT ARM WITH 250 WATT HPS HORIZONTAL MOUNT LUMINAIRE
 - ✱ LIGHT POLE ALUMINUM, 35' M.H., 12' DAVIT ARM- TWIN WITH 250 WATT HPS HORIZONTAL MOUNT LUMINAIRE (CIRCUIT C ONLY) MEDIAN MOUNTED
 - || CONDUIT PUSHED, INTERMEDIATE METAL (SIZE AND LENGTH AS SHOWN)
 - UNIT DUCT, 2 *8XLP & 1 *8XLP IN 3/4" POLYETHYLENE (UNLESS OTHERWISE SHOWN)
 - LIGHTING CONTROLLER CB-RCS-100-480 & ELECTRIC SERVICE INSTALLATION
 - ✱ ALL PARALLEL RUNS OF UNIT DUCT ARE IN THE SAME TRENCH

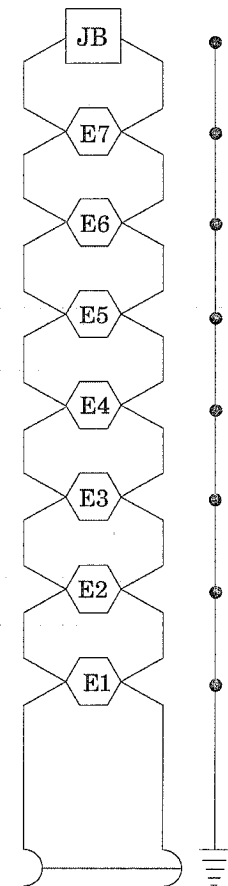

CIRCUIT E

NOTE:
OFFSET PLACEMENT OF LIGHT POLES SHALL BE AS A RESULT OF THE LUMINAIRE BEING IN LINE WITH THE EDGE OF PAVEMENT OR AS DIRECTED BY THE ENGINEER.
QUANTITY OF THE "BREAKAWAY DEVICE, COUPLING, SS SCREEN" MAY BE REDUCED WHERE LIGHT POLES ARE PLACED BEHIND GUARDRAIL OR AS DIRECTED BY THE ENGINEER.

PLOT DATE = Wed, Dec 22, 12:59:39, 2004
 PLOT SCALE = 50.000000 / 1.00
 REFERENCE = RREF\$