

SCALES:
PLAN: 1"=20'

US BUS 20

**TRAFFIC SIGNAL SCHEDULE OF QUANTITIES
WALNUT/S. 3RD/KISHWAUKEE ST. INTERSECTIONS**

28/18
64A38

CONDUIT SPLICES:
STA. 61+04.95, 28.45' LT.
STA. 61+09.59, 30.80' LT.
STA. 61+10.38, 25.91' LT.
STA. 61+18.82, 27.51' LT.

**KISHWAUKEE ST./
IL 251**

CODE NO.	PAY ITEM	QUANTITY	UNIT
81012500	CONDUIT IN TRENCH, 1 1/2" DIA., PVC	11	FOOT
81018600	CONDUIT PUSHED, 2 1/2" DIA., GALVANIZED STEEL	83	FOOT
81030100	CONDUIT SPLICE	4	EACH
81400400	CONCRETE HANDHOLE	1	EACH
81400500	CONCRETE HEAVY-DUTY HANDHOLE	1	EACH
81500200	TRENCH AND BACKFILL FOR ELECTRICAL WORK	11	FOOT
87301225	ELECTRIC CABLE IN CONDUIT, SIGNAL NO. 14 3C	44	FOOT
87301245	ELECTRIC CABLE IN CONDUIT, SIGNAL NO. 14 5C	240	FOOT
87502440	TRAFFIC SIGNAL POST, 10' GALVANIZED STEEL	1	EACH
87502480	TRAFFIC SIGNAL POST, 14' GALVANIZED STEEL	1	EACH
87800100	CONCRETE FOUNDATION, TYPE A	6.2	FOOT
87800415	CONCRETE FOUNDATION, TYPE E 36-INCH DIAMETER	30	FOOT
87900200	DRILL EXISTING HANDHOLE	1	EACH
89501300	RELOCATE EXISTING MAST ARM ASSEMBLY AND POLE	1	EACH
89502200	MODIFY EXISTING CONTROLLER	1	EACH
89502300	REMOVE ELECTRIC CABLE FROM CONDUIT	1,923	FOOT
89502375	REMOVE EXISTING TRAFFIC SIGNAL EQUIPMENT	7	EACH
89502380	REMOVE EXISTING HANDHOLE	3	EACH
89502385	REMOVE EXISTING CONCRETE FOUNDATION	7	EACH
X8801300	SIGNAL HEAD, POLYCARBONATE, LET, 1-FACE, 3-SECTION, BRACKET MOUNTED	1	EACH
X8810395	PEDESTRIAN SIGNAL HEAD, POLYCARBONATE, LED, 1-FACE, BRACKET MOUNTED	1	EACH
XX002180	ERECT MAST ARM ASSEMBLIES	1	EACH

PROJECT NO.	86438
DISTRICT	1
COUNTY	WINNEBAGO
SHEET NO.	28
TOTAL SHEETS	18

TRAFFIC SIGNAL LEGEND

■	SERVICE INSTALLATION	○	EXISTING SIGNAL POST
□	HANDHOLE	⊕	EXISTING COMBINATION MAST ARM AND POLE
●	SIGNAL POST	⊙	EXISTING SIGNAL FACE
—	COMBINATION MAST ARM AND POLE	⊞	EXISTING PEDESTRIAN HEAD
⊗	HIGH PRESSURE SODIUM LUMINAIRE (400 WATTS)	—	EXISTING CONDUIT
→	SIGNAL FACE	55'	MAST ARM LENGTH
→	SIGNAL FACE WITH BACKPLATE	PVC	POLYVINYL CHLORIDE PIPE
⊞	PEDESTRIAN HEAD	GS	GALVANIZED STEEL PIPE
—	CONDUIT	T	TRENCHED
□	6' X 20' DETECTOR LOOP	P	PUSHED
■	CONTROLLER CABINET TYPE IV	STA	STATION
⊞	EXISTING CONTROLLER CABINET	LENGTH	STATION OFFSET
⊞	EXISTING HANDHOLE	LENGTH	CONDUIT LENGTH (PUSH, TRENCH)
■	EXISTING SERVICE INSTALLATION	SIZE	CONDUIT SIZE (TYPE)

S. 3RD STREET

S. 3RD STREET

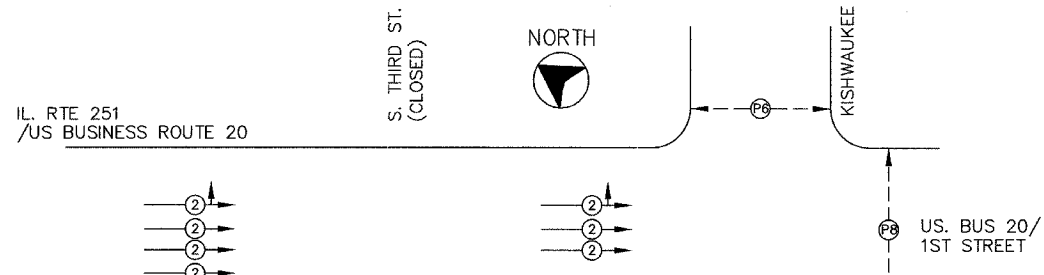
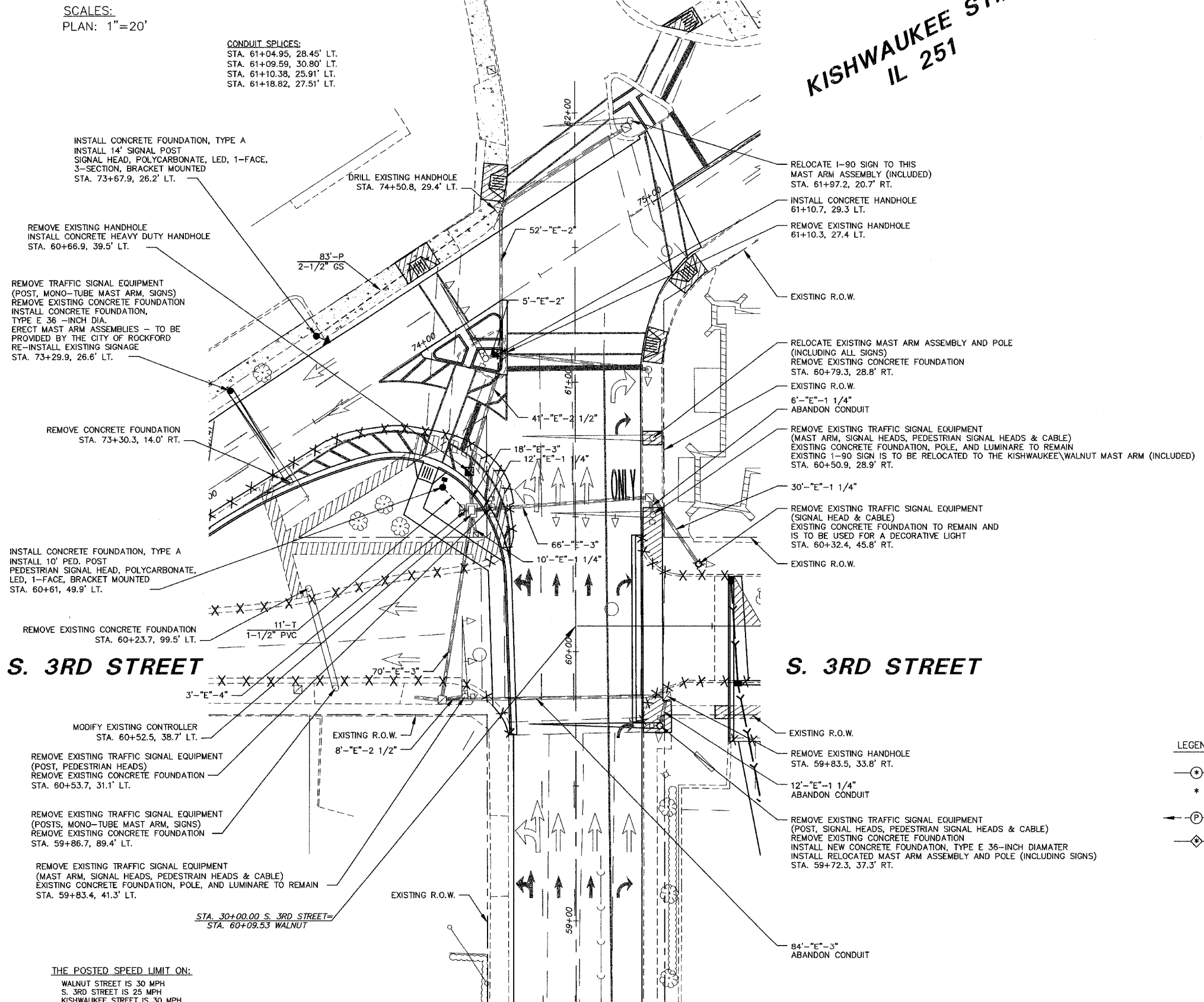

PHASE DESIGNATION DIAGRAM

No Scale REFER TO IDOT STANDARD 857001

GENERAL NOTES

- ALL SIGNING, STRIPING, TRAFFIC SIGNALS, AND TRAFFIC CONTROL DEVICES DURING CONSTRUCTION SHALL CONFORM TO THE MANUAL ON UNIFORM TRAFFIC CONTROL DEVICES (M.U.T.C.D.) CURRENT EDITION.
- ALL NEW CONSTRUCTION SHALL CONFORM TO THE "STANDARD SPECIFICATIONS FOR ROAD AND BRIDGE CONSTRUCTION", ADOPTED JANUARY 1, 2002 AND TO THE SPECIFICATIONS OF THE CITY OF ROCKFORD DEPARTMENT OF PUBLIC WORKS.
- MATERIAL TYPES SHALL BE AS FOLLOWS: SIGNAL POSTS SHALL BE GALVANIZED STEEL, SIGNAL HEADS SHALL BE POLYCARBONATE, BRACKET MOUNTED. ALL TRAFFIC SIGNAL EQUIPMENT IS TO BE SPUN ALUMINUM OR GALVANIZED FINISH EXCEPT FOR THE SIGNAL HEADS.
- ALL EXISTING CONDUITS WHICH WILL BE ABANDONED AND LEFT IN PLACE SHALL BE PLUGGED AT ALL OPEN ENDS WITH CONCRETE OR OTHER APPROVED MEANS. THE COST OF PLUGGING THESE CONDUITS SHALL BE CONSIDERED TO BE INCIDENTAL TO CONSTRUCTION.

THE POSTED SPEED LIMIT ON:
WALNUT STREET IS 30 MPH
S. 3RD STREET IS 25 MPH
KISHWAUKEE STREET IS 30 MPH

**ILLINOIS ROUTE 251/
US BUS. RTE 20**

<p>REVISIONS</p> <table border="1"> <tr><th>NO.</th><th>ITEM</th><th>DATE</th></tr> <tr><td> </td><td> </td><td> </td></tr> <tr><td> </td><td> </td><td> </td></tr> </table>	NO.	ITEM	DATE							<p>PLOTTING SCALE: 1"=1'</p> <p>DRAWN BY: BSL</p> <p>CHECKED BY: JWH</p> <p>DATE: DECEMBER 1, 2004</p>	<p>McCLURE ENGINEERING ASSOCIATES, INC.</p> <p>7282 Argus Drive Rockford, Illinois 61107 (815) 398-2332 FAX (815) 398-2496 Design Firm License: Illinois #184-000816</p>	<p>SOUTH 3RD STREET SIGNAL PLAN</p> <p>CITY OF ROCKFORD</p> <p>WALNUT STREET (H&B) ROCKFORD, ILLINOIS</p> <p>FILE NAME: H:\SecondSt-2004\HES\3rdSt-SigPlan.dwg SEC. 140CS-TS-3 JOB NUMBER: 04-28-04-045</p> <p>SHEET NO. 18 OF 28</p>
NO.	ITEM	DATE										